

* NOT FOUND IN THE FIELD AND DRAWN IN PER AS-BUILT DRAWINGS

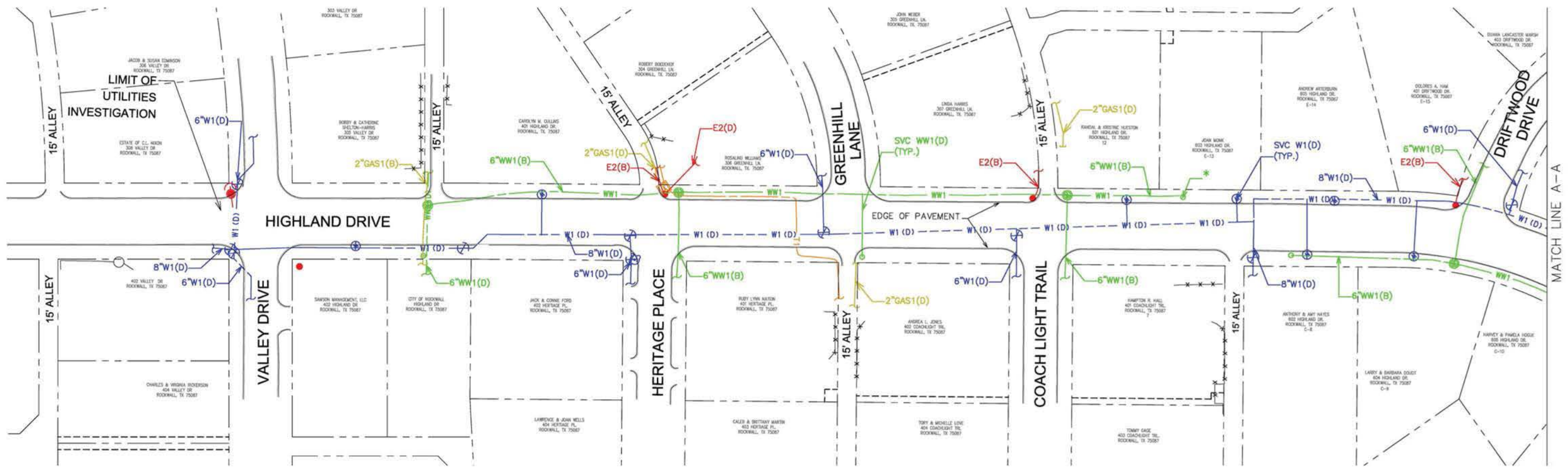
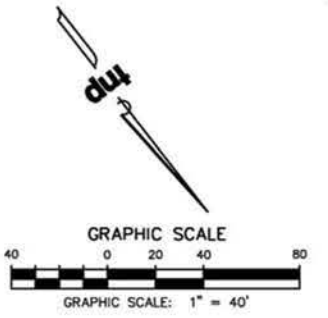

Drawing: N:\PROJETS\RWL18219\02-PLAN\02-PLAN.dwg - Highways Plans.dwg at Sep 21, 2018 - 10:57am by jdoe001
 Project: RWL18219 - PAVING, DRAINAGE, WATER AND WASTEWATER IMPROVEMENTS FOR HIGHLAND DRIVE
 Title: City of Rockwall, Texas
 Date: 09/21/2018
 Scale: 1"=40'
 Author: JDOE001
 Checker: JDOE001
 Plotter: HPGL
 Plot Date: 09/21/2018
 Plot Time: 10:57:00 AM
 Plot Scale: 1"=40'
 Plot Size: 11.00 x 17.00
 Plot Orientation: Landscape
 Plot Path: N:\PROJETS\RWL18219\02-PLAN\02-PLAN.dwg

no.	revision	by	date

teague nall and perkins, inc
 825 Watters Creek Blvd., Suite M300
 Allen, Texas 75013
 214.461.9867 ph 214.461.9864 fx
 www.tnpsc.com
 TBPE: F-230; TBPIS: 10011600, 10011601, 10194381

scale
 when bar is
 1 inch long
 horiz
 1"=40'
 vert
 N/A
 SEP 2018

RECORD DOCUMENTS
 THESE PLANS ARE FOR THE OWNER'S USE AS RECORD SET OF THE CONSTRUCTED PROJECT, AND REFLECT REVISIONS AND CONSTRUCTION RELATED CHANGES AS RECORDED BY THE CONTRACTOR. CHANGES MADE FROM THE ORIGINAL CONSTRUCTION DOCUMENTS DO NOT DEPICT ENGINEERING AND ARE NOT THE RESPONSIBILITY OF TEAGUE NALL & PERKINS, INC. OR THE ENGINEER OF RECORD ON THE ORIGINAL DOCUMENTS. ORIGINAL PLANS RELEASED FOR CONSTRUCTION WERE SEALED BY LINA NAJEEB OBEIDAT, P.E. NO. 123510 ON 09/21/2018.

CITY OF ROCKWALL, TEXAS
 PAVING, DRAINAGE, WATER AND WASTEWATER IMPROVEMENTS FOR
HIGHLAND DRIVE
 Existing Utilities from
 Beginning to Match Line A-A

tnp project
 RWL18219
 sheet
08