

Landscape Architects · Planners
 302 North Market, Suite 450
 Dallas, Texas 75202
 214/744-0757 Fax: 214/744-6785
 Austin · Dallas · Houston · McAllen

Project:
 City of Rockwall

The Harbor
 Phase I
 Public Improvements

Rockwall, Texas

Project Number:
 D03991

BROCKETTE · DAVIS · DRAKE, INC.
 consulting engineers
 4144 North Central Expressway, Suite 1100 • Dallas, Texas 75204
 (214) 824-3647 • fax: (214) 824-7064

Designed:

Drawn:

Reviewed:

Date Issued:
 13 July 2005

Revisions:

Sheet Title:
DRAINAGE PLAN

Sheet Number:
DR2

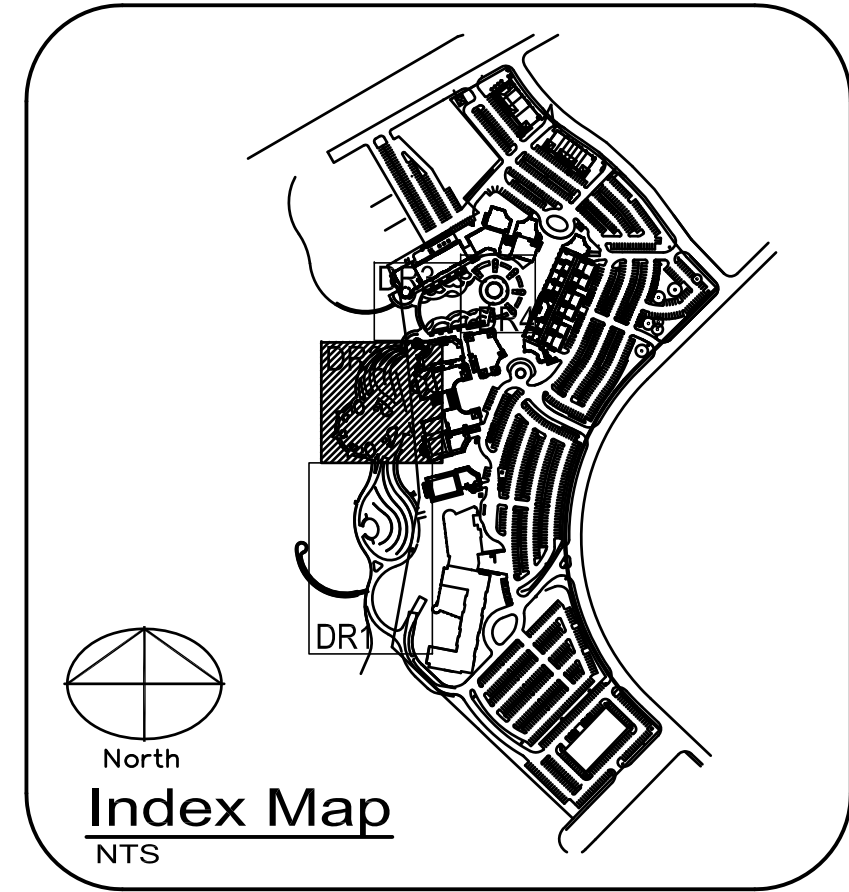
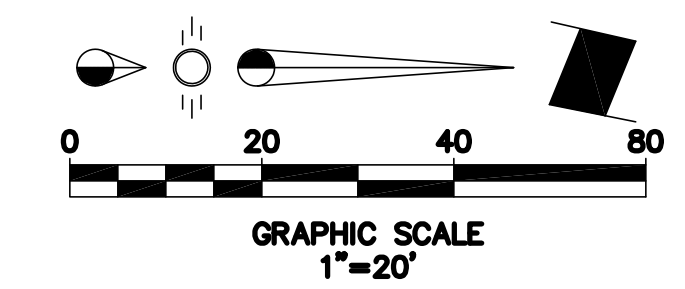

- GENERAL NOTES**
- ALL MATERIALS AND CONSTRUCTION SHALL CONFORM TO THE CITY STANDARDS AND SPECIFICATIONS.
 - ALL STORM SEWER PIPE 18" AND LARGER SHALL BE CLASS III RCP. ALL STORM SEWER PIPE 15" AND SMALLER SHALL BE ADS WATER TIGHT N-12 PIPE OR APPROVED EQUAL.
 - LAWN DRAINS SHALL NDS CATCH BASIN SERIES 12" OR 9" AS INDICATED WITH CAST IRON GRATES.
 - TRENCH DRAINS SHALL BE NDS DURASLOPE CHANNEL DRAINS DS-101 AND DS-102 AS REQUIRED WITH CATCH BASINS (6" NDS OUTLET) WITH CAST IRON GRATES. (ADA COMPLIANT)
 - ALL STORM PIPING SHALL BE INSTALLED ON A MIN. 1% GRADE.
 - CONTRACTOR SHALL BE RESPONSIBLE FOR MAINTAINING TRENCH SAFETY REQUIREMENTS IN ACCORDANCE WITH CITY STANDARDS, TEXAS STATE LAW, AND O.S.H.A. STANDARDS FOR ALL EXCAVATION IN EXCESS OF FIVE FEET.
 - CONCRETE FOR INLETS AND DRAINAGE STRUCTURES EASMENTS SHALL BE MIN. 4200 PSI AT 28 DAYS.
 - CONTRACTOR SHALL PROTECT ALL PUBLIC UTILITIES IN THE CONSTRUCTION OF THIS PROJECT.
 - THE LOCATION OF ALL UTILITIES INDICATED ON THESE PLANS ARE TAKEN FROM EXISTING PUBLIC RECORDS. THE EXACT LOCATION AND ELEVATION OF ALL PUBLIC UTILITIES MUST BE DETERMINED BY THE CONTRACTOR. IT SHALL BE THE DUTY OF THE CONTRACTOR TO ASCERTAIN WHETHER ANY ADDITIONAL FACILITIES OTHER THAN THOSE SHOWN ON THE PLANS MAY BE PRESENT.
 - SEE WATER AND WASTEWATER PLAN FOR ADDITIONAL INFORMATION RELATED TO OTHER UTILITY CONSTRUCTION.
 - ALL TRENCH BACKFILL FOR STORM SEWER SHALL BE COMPACTED AS REQUIRED BY CITY.
 - ALL EARTHWORK OPERATIONS SHALL CONFORM TO THE GEOTECHNICAL INVESTIGATION.
 - THIS PLAN SHOWS ELEV. CONTOURS FOR REFERENCE ONLY. SEE LANDSCAPE PLANS FOR GRADING.
 - Y-INLET SHALL BE PRECAST CONC. WITH CAST IRON GRATES, AS MANF. BY HUGHES SUPPLY OR APPROVED EQUAL.

- LEGEND**
- PROPOSED CONTOUR
 - SOLID PVC PIPE LATERAL - TIE INTO STORM DRAIN - SIZE AS NOTED
 - EXISTING STORM DRAIN - BY OTHERS
 - PROPOSED LAWN DRAIN
 - PEDESTRIAN AREA DRAIN
 - 4" VERTICAL RISER
 - 4" PERFORATED PIPE
 - TRENCH DRAIN - REF. LGD.01 LIMIT OF WORK
 - LIMIT OF WORK
 - ROCK RIP-RAP (REF DETAIL SHEET DT1)
 - CLEANOUT-SEE DETAIL SHT. DT2

MATCHLINE SHEET DR3

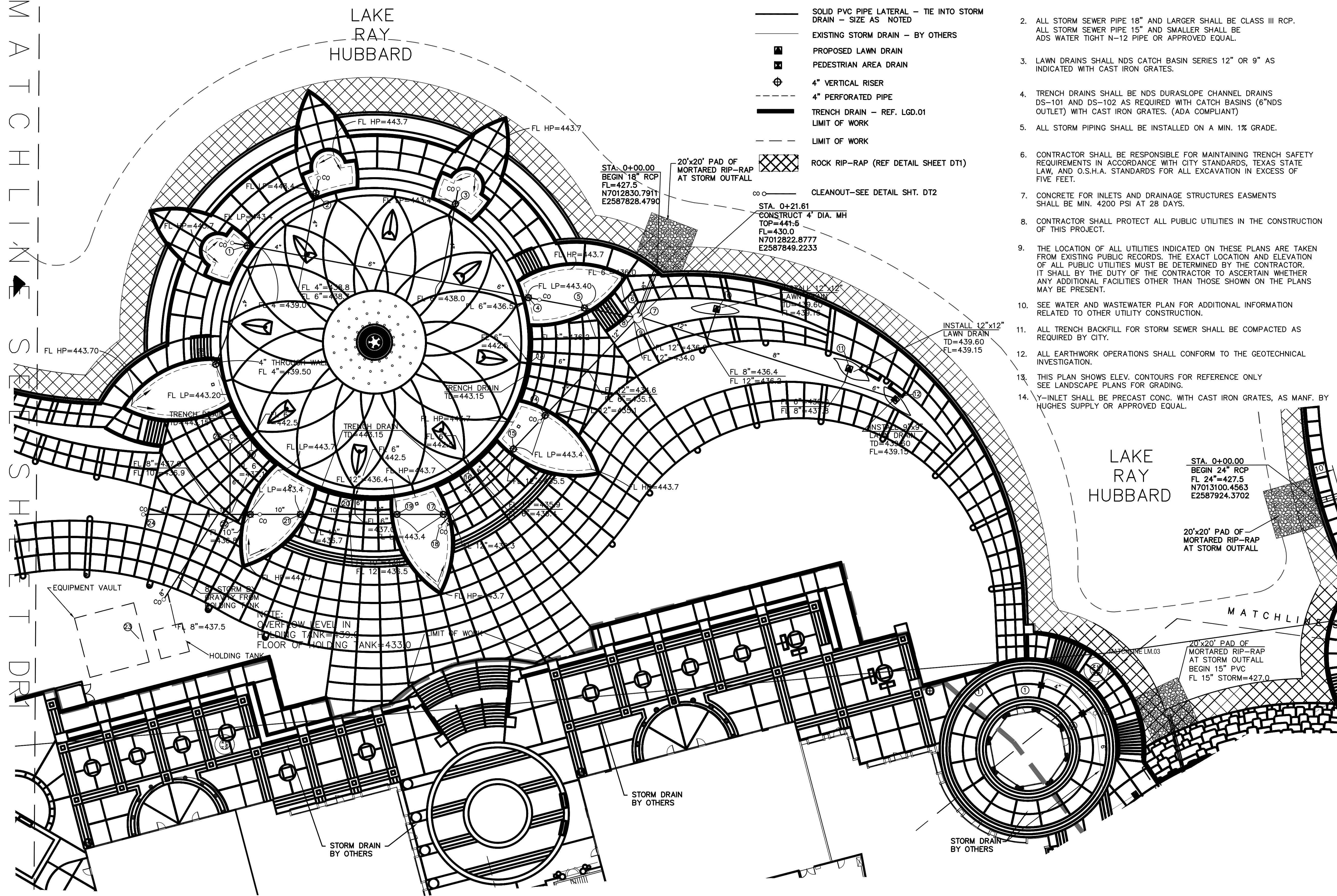

COORDINATE CONTROL POINTS

NO.	NORTHING	EASTING	NO.	NORTHING	EASTING
1	7012863.2481	2587819.7263	15	7012772.0663	2587902.8021
2	7012891.3944	2587798.1865	16	7012754.5523	2587908.7203
3	7012748.3798	2587802.6288	17	7012743.4313	2587928.5327
4	7012778.2295	2587840.9731	18	7012732.0145	2587945.0357
5	7012801.1161	2587845.2022	19	7012724.5195	2587929.5325
6	7012823.5901	2587847.3546	20	7012707.3666	2587922.5872
7	7012824.8771	2587849.2027	21	7012685.0414	2587929.5327
8	7012820.9105	2587848.8599	22	7012664.5612	2587929.5327
9	7012821.5010	2587850.6745	23	7012619.0032	2587980.3036
10	7012854.8497	2587846.8030	24	7012621.6049	2587929.5327
11	7012910.3017	2587869.2627	25	7012650.4336	2587868.2067
12	7012927.3002	2587881.8706	26	7012656.3049	2587895.3568
13	7012778.7535	2587867.5621	27	7012664.9585	2587898.6759
14	7012785.0450	2587889.0859			

BENCHMARK:
 National Geodetic Survey Control, Designation: Q 1498, PID: C52517,
 Monumented in 1986, NAD 83: 32 53 24 (N) / 096 29 22 (W).
 3.1 Miles SW from Rockwall, 1.7 Miles southerly along State Highway 205 from
 its junction with State Highway 66 in Rockwall, thence 1.45 Miles
 southerly along Interstate Highway 30, set vertically in the north face of
 the most northerly 1 of 3 columns of the first pier east of the west
 abutment of the southwest bound highway overpass of Farm Road 740 (exit
 67), and 20.7 feet west of the center of the Farm Road. The Mark is 1.4
 meters above the Farm Road. ELEVATION = 445.31 feet (NAVD 88)

DRAINAGE PLAN
 ROCKWALL WATERFRONT PARK PACKAGE 2
 ROCKWALL, TEXAS

BROCKETTE · DAVIS · DRAKE, INC.
 consulting engineers
 Civil & Structural Engineering · Surveying
 4144 North Central Expressway, Suite 1100 • Dallas, Texas 75204
 (214) 824-3647 • fax: (214) 824-7064

RECORD DRAWING

NOTE: THESE PLANS HAVE BEEN REVISED TO CONFORM WITH CONSTRUCTION RECORDS PROVIDED BY THE CONTRACTOR.

DESIGNED	DRAWN	DATE	SCALE	NOTES	FILE	NO.
TNA	BDD	7/13/05	1"=20'	BDD	C03360	DR2

© Copyright 2005 BroCKETTE · DAVIS · DRAKE, Inc. All Rights Reserved. This drawing is the property of BroCKETTE · DAVIS · DRAKE, Inc. Any modification or use of this drawing without the express written authorization of BroCKETTE · DAVIS · DRAKE, Inc. is prohibited.