

NO.	DESCRIPTION

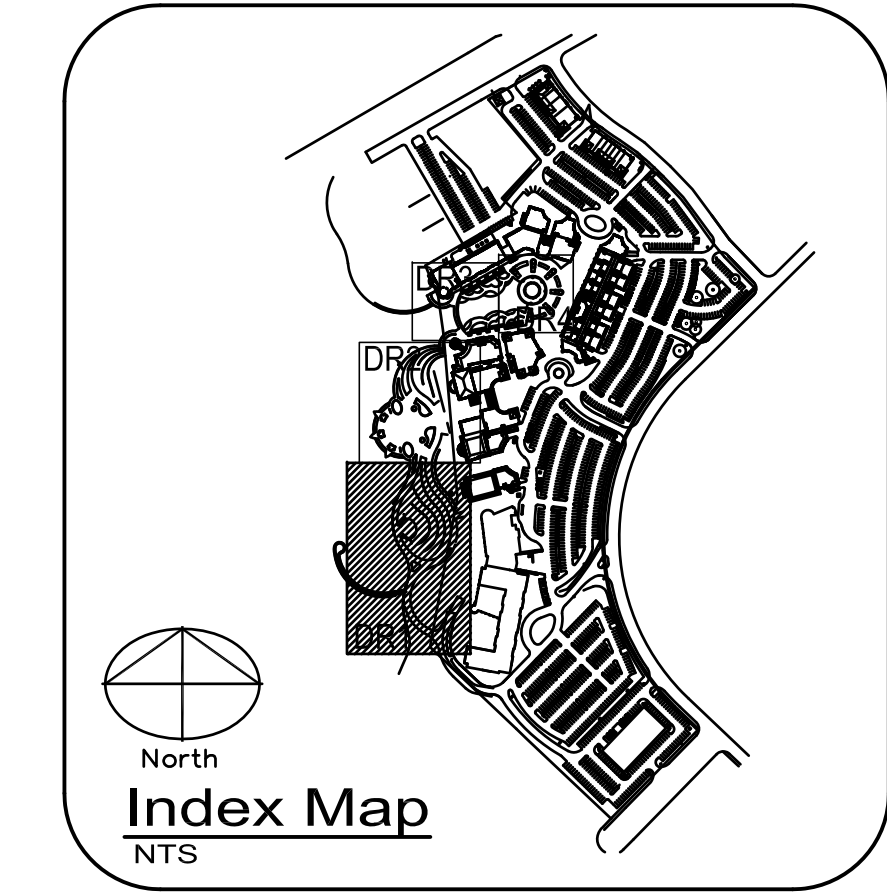
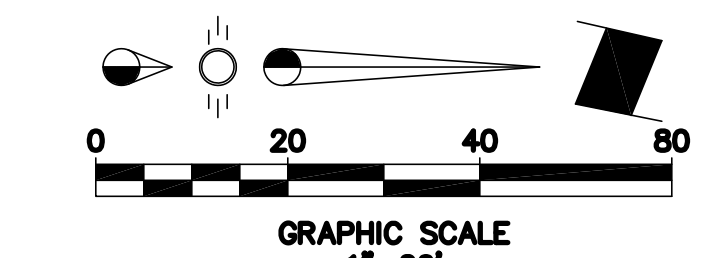

NO.	NORTHING	EASTING
1	7012322.0648	2587889.2668
2	7012322.0648	2587889.2668
3	7012340.0655	2587873.2883
4	7012360.5218	2587860.1965
5	7012387.6223	2587849.2065
6	7012393.0731	2587848.2713
7	7012413.0458	2587846.6561
8	7012437.9225	2587849.4943
9	7012461.1287	2587853.9978
10	7012464.9181	2587857.7313
11	7012358.2124	2587899.7683
12	7012372.2555	2587913.1508
13	7012368.9734	2587927.6041
14	7012392.5472	2587916.5100
15	7012406.0299	2587917.2468
16	7012410.6914	2587915.9421
17	7012412.2206	2587911.3587
18	7012439.1175	2587907.4557
19	7012428.2622	2587898.4859
20	7012433.7706	2587880.0638
21	7012177.8469	2587953.4121
22	7012267.4850	2587898.2153

- LEGEND**
- PROPOSED CONTOUR
  - SOLID PVC PIPE LATERAL - TIE INTO STORM DRAIN - SIZE AS NOTED
  - EXISTING STORM DRAIN - BY OTHERS
  - PROPOSED LAWN DRAIN
  - PROPOSED AREA DRAIN
  - ROCK RIP-RAP (REF DETAIL SHEET DT1)
  - LIMIT OF WORK
  - CLEANOUT PLACE AS SHOWN AND WHEN POSSIBLE, CLEANOUT SHALL BE PLACED IN LAWN OR LANDSCAPE AREAS, NOT IN PAVEMENT-SEE DETAIL SHT. DT2

MATCHLINE SEE DR2

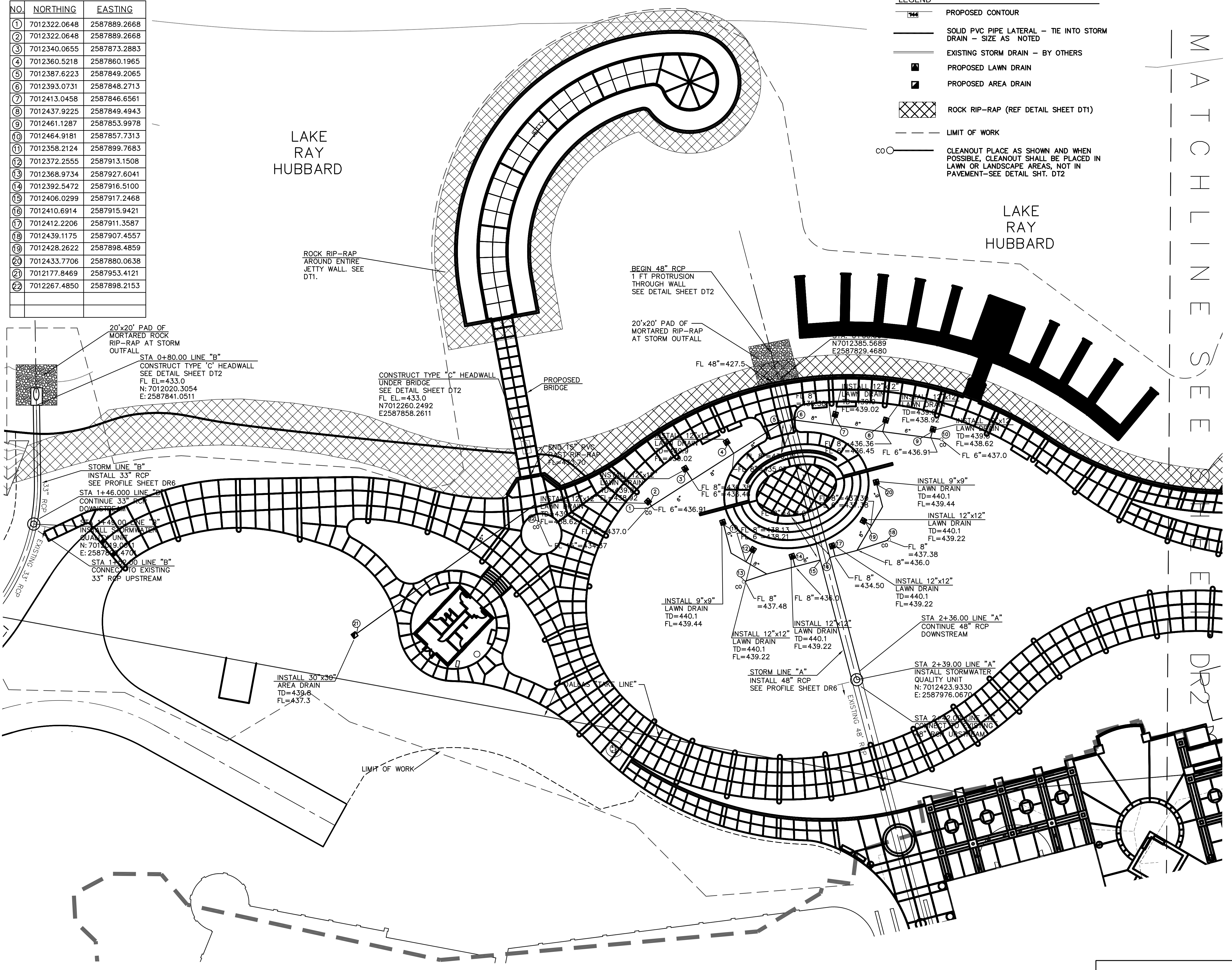

- GENERAL NOTES**
- ALL MATERIALS AND CONSTRUCTION SHALL CONFORM TO THE CITY STANDARDS AND SPECIFICATIONS.
  - ALL STORM SEWER PIPE 18" AND LARGER SHALL BE CLASS III RCP. ALL STORM SEWER PIPE 15" AND SMALLER SHALL BE ADS WATER TIGHT N-12 PIPE OR APPROVED EQUAL.
  - AREA DRAIN SHALL BE PRECAST CONC. WITH CAST IRON GRATES, AS MANF. BY HUGHES SUPPLY OR APPROVED EQUAL.
  - LAWN DRAINS SHALL NDS CATCH BASIN SERIES 12" OR 9" AS INDICATED WITH CAST IRON GRATES.
  - ALL STORM PIPING SHALL BE INSTALLED ON A MIN. 1% GRADE.
  - CONTRACTOR SHALL BE RESPONSIBLE FOR MAINTAINING TRENCH SAFETY REQUIREMENTS IN ACCORDANCE WITH CITY STANDARDS, TEXAS STATE LAW, AND O.S.H.A. STANDARDS FOR ALL EXCAVATION IN EXCESS OF FIVE FEET.
  - CONCRETE FOR INLETS AND DRAINAGE STRUCTURES SHALL BE MIN. 4200 PSI AT 28 DAYS.
  - CONTRACTOR SHALL PROTECT ALL PUBLIC UTILITIES IN THE CONSTRUCTION OF THIS PROJECT.
  - THE LOCATION OF ALL UTILITIES INDICATED ON THESE PLANS ARE TAKEN FROM EXISTING PUBLIC RECORDS. THE EXACT LOCATION AND ELEVATION OF ALL PUBLIC UTILITIES MUST BE DETERMINED BY THE CONTRACTOR. IT SHALL BE THE DUTY OF THE CONTRACTOR TO ASCERTAIN WHETHER ANY ADDITIONAL FACILITIES OTHER THAN THOSE SHOWN ON THE PLANS MAY BE PRESENT.
  - SEE WATER AND WASTEWATER PLAN FOR ADDITIONAL INFORMATION RELATED TO OTHER UTILITY CONSTRUCTION.
  - ALL TRENCH BACKFILL FOR STORM SEWER SHALL BE COMPACTED AS REQUIRED BY CITY.
  - ALL EARTHWORK OPERATIONS SHALL CONFORM TO THE GEOTECHNICAL INVESTIGATION.
  - THIS PLAN SHOWS ELEV. CONTOURS FOR REFERENCE ONLY SEE LANDSCAPE PLANS FOR GRADING.
  - AS SHOWN & WHEN POSSIBLE, ALL CLEANOUTS SHALL BE PLACED IN LAWN/LANDSCAPE AREAS AND NOT IN PAVEMENT.
  - STORMWATER QUALITY UNIT SHALL BE STORMCEPTOR MODEL STC900 FOR 48" RCP AND MODEL STC900 FOR 33" RCP, OR APPROVED EQUAL.

**BENCHMARK:**  
National Geodetic Survey Control, Designation: Q 1498, PID: C52517,  
Monumented in 1986. NAD 83: 32 53 24 (N) / 096 29 22 (W).  
3.1 Miles SW from Rockwall, 1.7 Miles southerly along State Highway 205 from its junction with State Highway 66 in Rockwall, thence 1.45 Miles southerly along Interstate Highway 30, set vertically in the north face of the most northerly 1 of 3 columns of the first pier east of the west abutment of the southwest bound highway overpass of Farm Road 740 (exit 67), and 20.7 feet west of the center of the Farm Road. The Mark is 1.4 meters above the Farm Road.  
ELEVATION = 445.31 feet (NAVD 88)

**DRAINAGE PLAN**  
ROCKWALL WATERFRONT PARK PACKAGE 2  
ROCKWALL, TEXAS

**BROCKETTE · DAVIS · DRAKE, INC.**  
consulting engineers  
Civil & Structural Engineering · Surveying  
4144 North Central Expressway, Suite 1100 • Dallas, Texas 75204  
(214) 824-3647 • Fax: (214) 824-7064

**RECORD DRAWING**

NOTE: THESE PLANS HAVE BEEN REVISED TO CONFORM WITH CONSTRUCTION RECORDS PROVIDED BY THE CONTRACTOR.

DESIGNED	DRAWN	DATE	SCALE	NOTES	FILE	NO.
TNA	BDD	7/13/05	1"=20'	BDD	C03360	<b>DR1</b>

© Copyright 2005 Brockette/Davis/Drake, Inc. All Rights Reserved. This drawing is the property of Brockette/Davis/Drake, Inc. Any modification or use of this drawing without the express written authorization of Brockette/Davis/Drake, Inc. is prohibited.

X:\DWG\2005\03\0390 - ROCKWALL WATERFRONT PARK\PACKAGE 2\DRAINAGE\DRAINAGE-RWP.dwg, 11/10/05 1:48:53 PM