

EXISTING MANHOLE
N 7025559.24
E 2592992.09
RIM 496.07
FL (S) = 485.78
FL (E) = 486.11
FL (W) = 485.71

306 GLENN AVE.
ROCKWALL, TX. 75087

EXISTING 6" SAN.
SEWER TO BE
GROUTED AND
ABANDONED IN
PLACE

CONTROL VALVE

MAILBOX

MAILBOX

MAILBOX

MAILBOX

MAILBOX

MAILBOX

MAILBOX

MAILBOX

MAILBOX

MAILBOX

MAILBOX

MAILBOX

MAILBOX

MAILBOX

MAILBOX

MAILBOX

MAILBOX

MAILBOX

MAILBOX

MAILBOX

MAILBOX

MAILBOX

MAILBOX

MAILBOX

MAILBOX

EXISTING MANHOLE
N 7024779.43
E 2592994.26
RIM 492.51
FL (N) = 487.39
FL (E) = 487.45

303 GLENN AVE.
ROCKWALL, TX. 75087

PROPOSED 8" SANITARY
SEWER LINE B; REF. TO
SHEET 07 FOR PLANS

8" SS PVC

8" SS PVC

8" SS PVC

8" SS PVC

8" SS PVC

8" SS PVC

8" SS PVC

8" SS PVC

8" SS PVC

8" SS PVC

8" SS PVC

8" SS PVC

8" SS PVC

8" SS PVC

8" SS PVC

8" SS PVC

8" SS PVC

8" SS PVC

8" SS PVC

8" SS PVC

8" SS PVC

STA 0+00.00 LINE "SS-A"
CONNECT TO
EXISTING SSMH &
REHABILITATE EXISTING MH
CONSTRUCT:
1-INTERNAL DROP CONNECTION
CUT & PLUG EX. 6" SS (W & E)
RIM=501.48'
FL PROP. 8" IN =495.85 (E)
FL EX. 10" IN=486.97
FL EX. 10" OUT=486.76
N=7,025,094.6623
E=2,592,992.4295

301 GLENN AVE.
ROCKWALL, TX. 75087

PROPOSED 8" WATER;
REF. TO SHEET 15 FOR
PLAN

8" WATER

8" WATER

8" WATER

8" WATER

8" WATER

8" WATER

8" WATER

8" WATER

8" WATER

8" WATER

8" WATER

8" WATER

8" WATER

8" WATER

8" WATER

8" WATER

8" WATER

STA 0+46.75 LINE "SS-A"
CONSTRUCT:
1-STD. 4" DIA. SSMH
RIM=504.85'
FL 8" IN =498.38 (E)
FL 8" OUT =498.28 (W)
N=7,025,077.9188
E=2,593,036.0796

302 GLENN AVE.
ROCKWALL, TX. 75087

PROPOSED 8" WATER;
REF. SHEET 12

8" WATER

8" WATER

8" WATER

8" WATER

8" WATER

8" WATER

8" WATER

8" WATER

8" WATER

8" WATER

8" WATER

8" WATER

8" WATER

8" WATER

8" WATER

8" WATER

8" WATER

PREDETERMINED SERVICE CONNECTIONS:

No.	Station	Size	Length (ft)
9	0+62.91	4" Service (by bore)	38
10	0+73.66	4" Service (by open cut)	11.5
11	1+83.83	4" Service (by bore)	38

NOTE: SERVICE INFORMATION SHOWN FOR INFORMATIONAL PURPOSES ONLY. CONTRACTOR SHALL CONFIRM SERVICE CONNECTION LOCATION, SIZE, AND LENGTH PRIOR TO CONSTRUCTION.

LEGEND

CONCRETE PAVEMENT W/ CURB REMOVAL AND REPLACEMENT

- NOTES:
- ALL EXISTING FRANCHISE UTILITIES SHALL BE PROTECTED AND REMAIN IN SERVICE THROUGHOUT CONSTRUCTION UNLESS OTHERWISE NOTED ON PLANS. CONTRACTOR SHALL VERIFY LOCATIONS AND DEPTHS. EXISTING WATER AND SANITARY SEWER LINES SHALL BE KEPT IN SERVICE UNTIL NEW LINES ARE CONSTRUCTED, TESTED, AND OPERATIONAL.
 - ALL DIMENSIONS ARE TO BACK OF CURB UNLESS NOTED OTHERWISE.
 - CONTRACTOR SHALL VERIFY LOCATIONS AND DEPTH OF EXISTING SANITARY SEWER SERVICES.
 - ALL MANHOLES TO BE RAVEN LINED OR APPROVED EQUAL. IF LINED, THE MANHOLE TO BE SPARK TESTED AS WELL AS PRESSURE TESTED.
 - INSTALL GREEN EMS DISKS ON ALL SEWER LINES AT EVERY MANHOLE, SERVICE CONNECTION, CLEANOUT, AND CHANGE IN DIRECTION.

CAUTION!!!
UNDERGROUND FRANCHISE UTILITIES IN THE AREA. CONTRACTOR TO VERIFY EXACT DEPTH AND LOCATION OF EXISTING UTILITIES 48 HOURS PRIOR TO CONSTRUCTION.

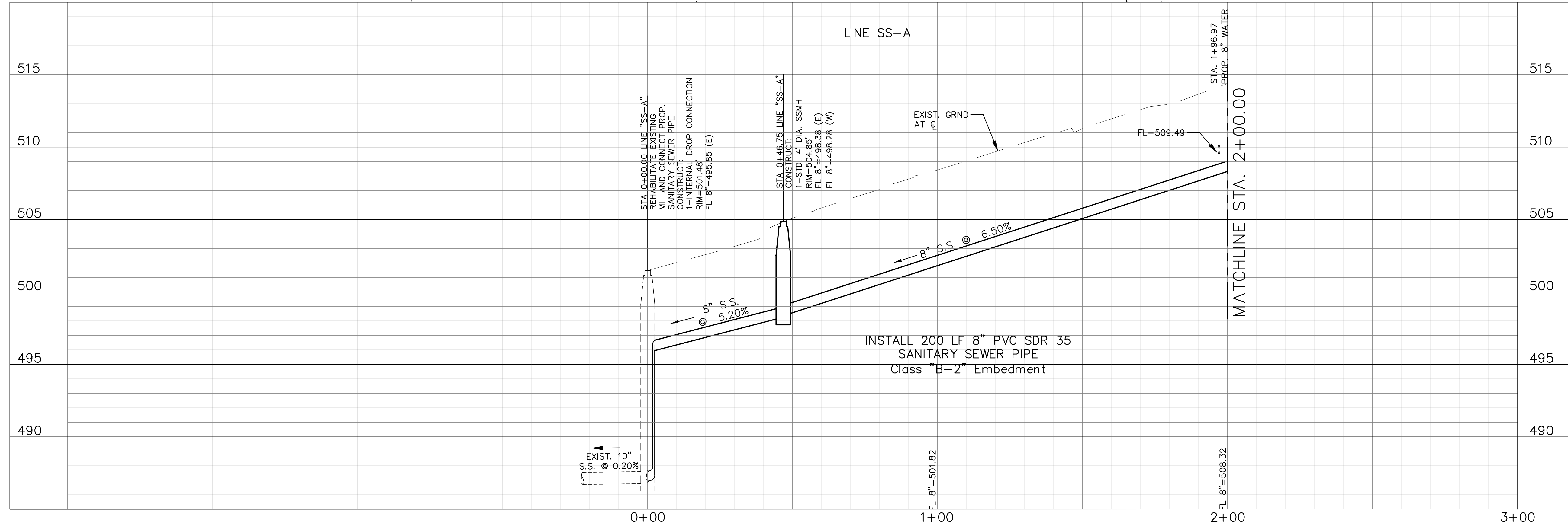

BENCHMARKS

BENCHMARK #1
SQUARE CUT ON TOP OF CURB NEAR SOUTHWEST CORNER OF 310 GLENN AVENUE.
ELEVATION=484.21

BENCHMARK #2
SQUARE CUT ON TOP OF CURB AT THE SOUTHEAST CORNER OF THE INTERSECTION OF GLENN AVENUE AND SPRING CREEK DRIVE.
ELEVATION=513.68

BENCHMARK #3
SQUARE CUT ON TOP OF CURB AT THE SOUTHEAST CORNER OF THE INTERSECTION OF GLENN AVENUE AND SOUTH ALAMO ROAD.
ELEVATION=584.00

VERDUNITY
A better future, by design.

17000 Preston Road, Suite 110, Dallas TX. 75248
(214)425-6720
www.verdunity.com
Texas P.E. Firm Registration No. F-13496

RECORD DRAWINGS

ISSUE	DATE	DESCRIPTION
1	12/17/14	RECORD DRAWINGS

DESIGNED BY: E. MAGEE
DRAWN BY: E. MAGEE
CHECKED BY: K. SHEPHERD
DATE: 12/16/2014
JOB NUMBER: 004-002

RECORD DRAWINGS
THESE PLANS ARE A RECORD SET OF THE CONSTRUCTED PROJECT, AND REFLECT REVISIONS AND CONSTRUCTION-RELATED CHANGES AS MADE BY THE CONTRACTOR. CHANGES MADE FROM THE ORIGINAL CONSTRUCTION DOCUMENTS DO NOT DEPICT ENGINEERING AND ARE NOT THE RESPONSIBILITY OF VERDUNITY, INC. OR THE ENGINEER ON RECORD ON THE ORIGINAL DOCUMENTS. ORIGINAL PLANS RELEASED FOR CONSTRUCTION WERE SEALED BY KEVIN M. SHEPHERD, PE NO. 88642

GLENN AVE. UTILITY REHABILITATION

City of Rockwall
The New Horizon

SAN. SEWER PLAN & PROFILE
S.S. LINE 'A' STA. 0+00 TO 2+00

SHEET **08**