

REVISIONS: 4/28/09 - GDAVIS
 C:\Acad_Jobs\Rockwall\2005111\Sheets\2005111-060_LIGHTING01.dwg
 PLOT STYLE: 22X34.ctb
 PLOTTED BY: GDAVIS ON 4/30/2009

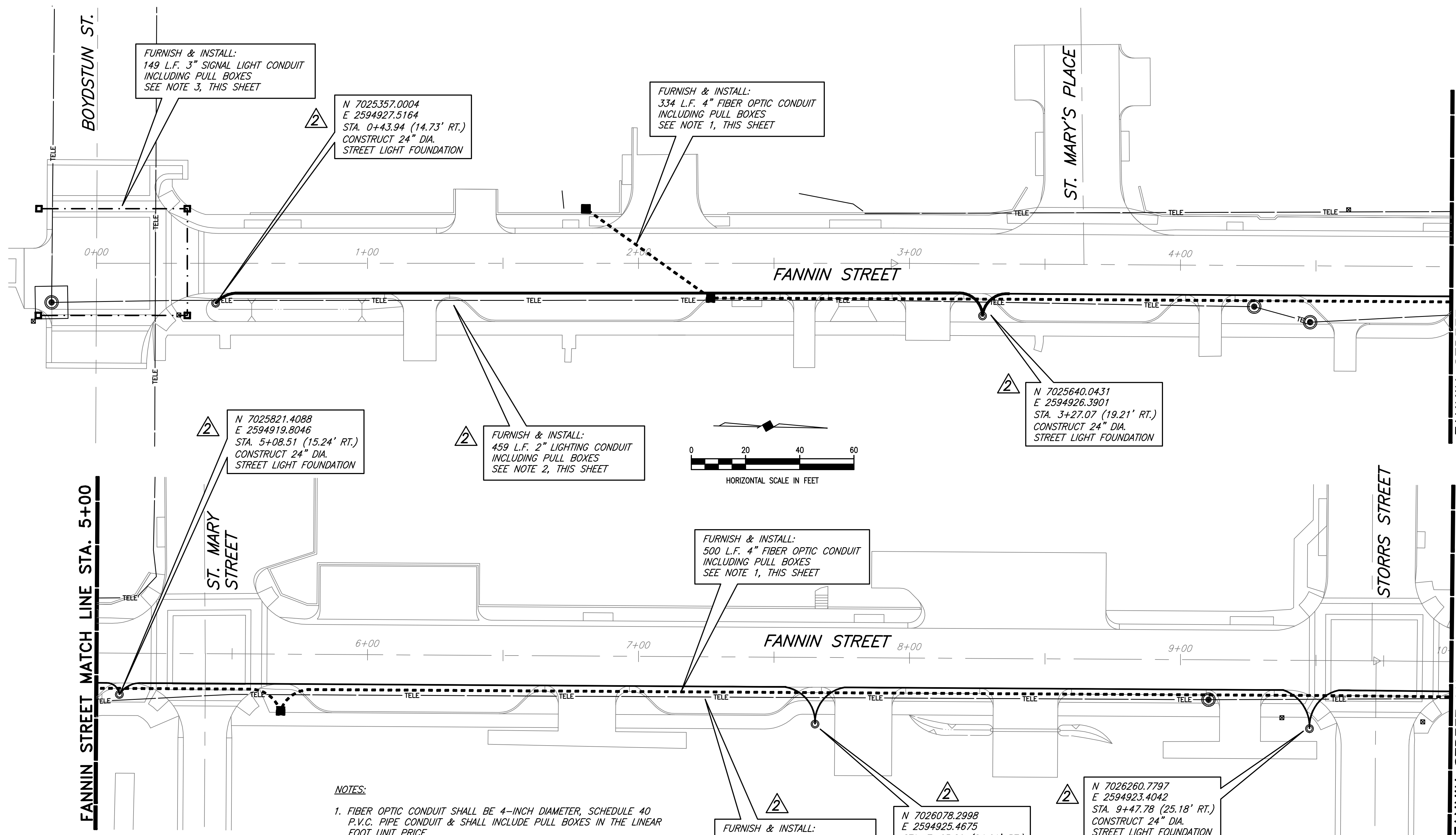

LEGEND

- — □ PROPOSED 2" STREET LIGHT CONDUIT AND PULL BOX
- — □ PROPOSED 3" SIGNAL LIGHT CONDUIT AND PULL BOX
- — ■ PROPOSED 4" FIBER OPTIC CONDUIT AND PULL BOX
- ⊙ PROPOSED 24" STREET LIGHT FOUNDATION

FURNISH & INSTALL:
 149 L.F. 3" SIGNAL LIGHT CONDUIT
 INCLUDING PULL BOXES
 SEE NOTE 3, THIS SHEET

N 7025357.0004
 E 2594927.5164
 STA. 0+43.94 (14.73' RT.)
 CONSTRUCT 24" DIA.
 STREET LIGHT FOUNDATION

FURNISH & INSTALL:
 334 L.F. 4" FIBER OPTIC CONDUIT
 INCLUDING PULL BOXES
 SEE NOTE 1, THIS SHEET

N 7025821.4088
 E 2594919.8046
 STA. 5+08.51 (15.24' RT.)
 CONSTRUCT 24" DIA.
 STREET LIGHT FOUNDATION

FURNISH & INSTALL:
 459 L.F. 2" LIGHTING CONDUIT
 INCLUDING PULL BOXES
 SEE NOTE 2, THIS SHEET

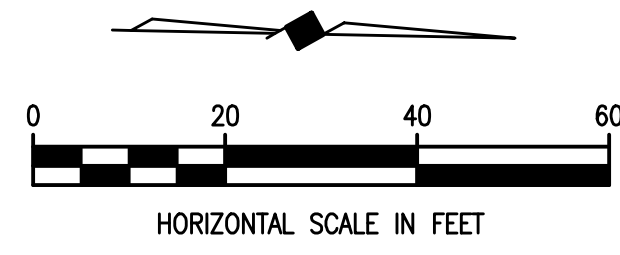

N 7025640.0431
 E 2594926.3901
 STA. 3+27.07 (19.21' RT.)
 CONSTRUCT 24" DIA.
 STREET LIGHT FOUNDATION

FURNISH & INSTALL:
 500 L.F. 4" FIBER OPTIC CONDUIT
 INCLUDING PULL BOXES
 SEE NOTE 1, THIS SHEET

FURNISH & INSTALL:
 500 L.F. 2" LIGHTING CONDUIT
 INCLUDING PULL BOXES
 SEE NOTE 2, THIS SHEET

N 7026078.2998
 E 2594925.4675
 STA. 7+65.29 (24.61' RT.)
 CONSTRUCT 24" DIA.
 STREET LIGHT FOUNDATION

N 7026260.7797
 E 2594923.4042
 STA. 9+47.78 (25.18' RT.)
 CONSTRUCT 24" DIA.
 STREET LIGHT FOUNDATION

NOTES:

1. FIBER OPTIC CONDUIT SHALL BE 4-INCH DIAMETER, SCHEDULE 40 P.V.C. PIPE CONDUIT & SHALL INCLUDE PULL BOXES IN THE LINEAR FOOT UNIT PRICE.
2. STREET LIGHT CONDUIT FOR FUTURE STREET LIGHTS SHALL BE 2-INCH DIAMETER, SCHEDULE 40 P.V.C. PIPE CONDUIT (GRAY IN COLOR) & SHALL INCLUDE PULL BOXES IN THE LINEAR FOOT UNIT PRICE.
3. SIGNAL LIGHT CONDUIT FOR FUTURE STREET LIGHTS SHALL BE 3-INCH DIAMETER, SCHEDULE 40 P.V.C. PIPE CONDUIT (GRAY IN COLOR) & SHALL INCLUDE PULL BOXES IN THE LINEAR FOOT UNIT PRICE.
4. PULL BOXES FOR FIBER OPTIC CONDUIT SHALL BE SYNERTECH QUAZITE 17"x30"x36" OR APPROVED EQUAL.
5. PULL BOXES FOR SIGNAL LIGHT CONDUIT AND STREET LIGHT CONDUIT SHALL BE IN ACCORDANCE WITH TXDOT TYPE 'D'.

This record drawing is a compilation of the sealed engineering drawing for this project; modified by addenda, change orders and information furnished by the contractor. The information shown on the record drawings that was provided by the contractor or others not associated with the design engineer cannot be verified for accuracy or completeness. This original sealed drawings are on file at the offices of Birkhoff, Hendricks & Conway, L.L.P.
 BY MH DATE 4/25/09

THESE DOCUMENTS ARE FOR
 BIDDING, CONSTRUCTION,
 AND PERMIT PURPOSES.
 Matthew Hickey
 DATE: 4/19/09



△ CHANGE ORDER NO. 2 - MARCH 28, 2008

These plans and related specifications were prepared for construction of this specific project only. Reuse of these documents is not permitted without written authorization of Birkhoff, Hendricks, & Conway, L.L.P.

CITY OF ROCKWALL, TEXAS

FANNIN STREET IMPROVEMENTS
 STREET LIGHTING, SIGNAL LIGHTING &
 FIBER OPTIC CONDUIT PLAN

BIRKHOFF, HENDRICKS & CONWAY, L.L.P.
 CONSULTING ENGINEERS
 Dallas, Texas

PROJECT ENGINEER: M.H.	PROJECT: 2005-111	SHEET NO. 60
PROJECT TECHNICIAN: K.A.B.	DATE: April, 2008	