

REVISION: 4/29/09 - GDAVIS
C:\Acad\Jobs\Rockwall\2005111\Sheets\2005111-057_LATERALS-PP2.dwg
PLOT SCALE: 1:20
PLOT STYLE: 22X34.ctb
PLOTTED BY: GDAVIS ON 4/30/2009

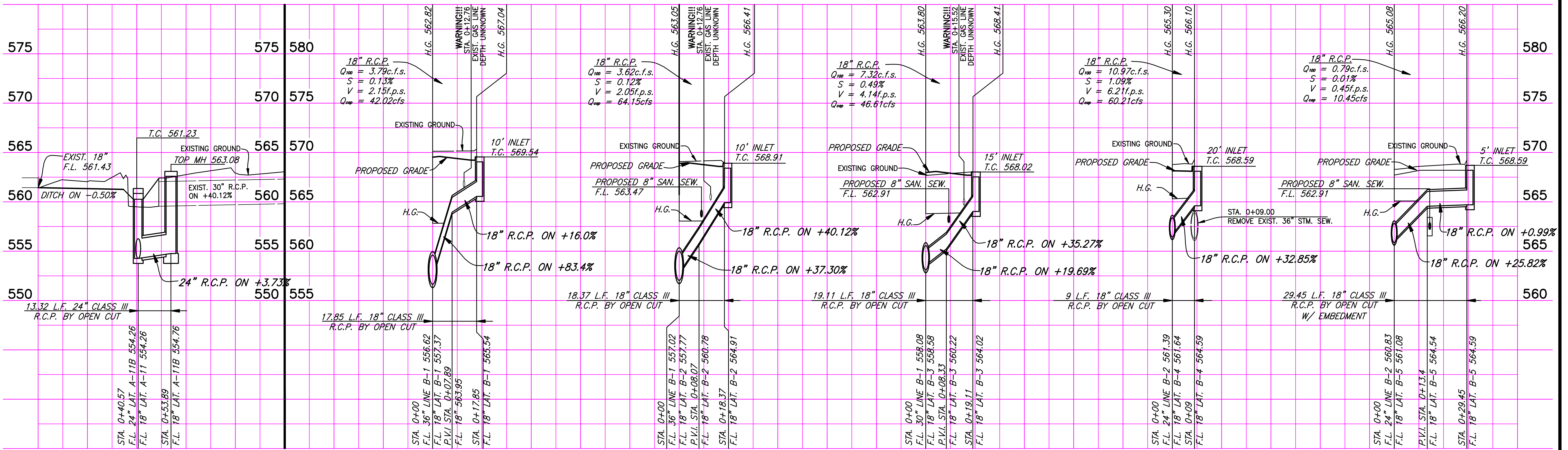

LATERAL A-11B

LATERAL B-1

LATERAL B-2

LATERAL B-3

LATERAL B-4

LATERAL B-5

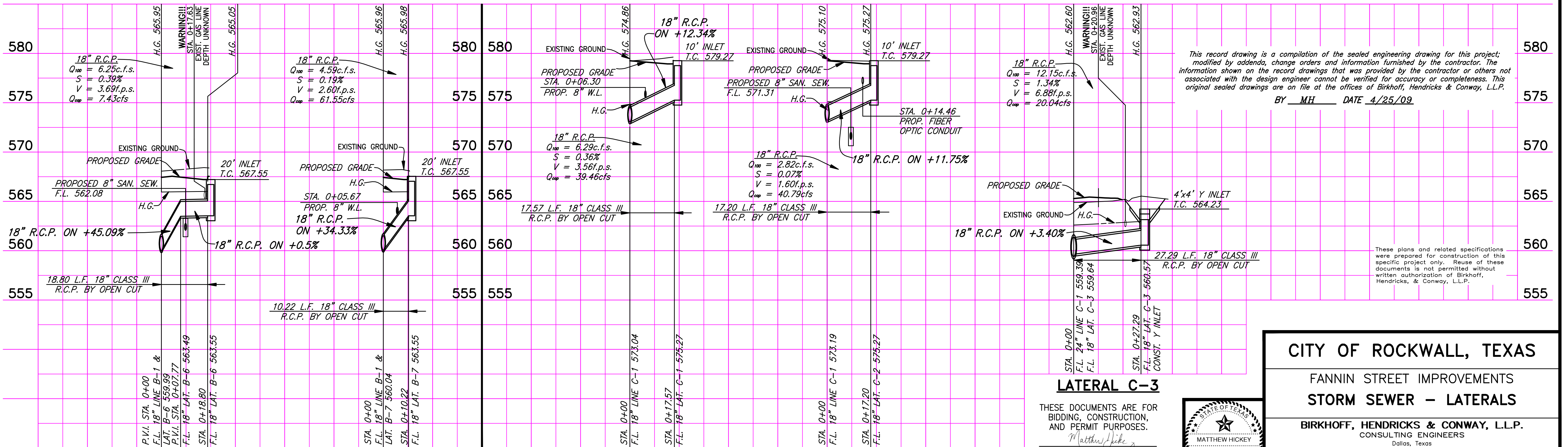

LATERAL B-6

LATERAL B-7

LATERAL C-1

LATERAL C-2

LATERAL C-3

This record drawing is a compilation of the sealed engineering drawing for this project, modified by addenda, change orders and information furnished by the contractor. The information shown on the record drawings that was provided by the contractor or others not associated with the design engineer cannot be verified for accuracy or completeness. This original sealed drawings are on file at the offices of Birkhoff, Hendricks & Conway, L.L.P.
BY MH DATE 4/25/09

These plans and related specifications were prepared for construction of this specific project only. Reuse of these documents is not permitted without written authorization of Birkhoff, Hendricks, & Conway, L.L.P.

THESE DOCUMENTS ARE FOR BIDDING, CONSTRUCTION, AND PERMIT PURPOSES.

DATE: 4/29/09



CITY OF ROCKWALL, TEXAS
FANNIN STREET IMPROVEMENTS
STORM SEWER - LATERALS

BIRKHOFF, HENDRICKS & CONWAY, L.L.P.
CONSULTING ENGINEERS
Dallas, Texas

PROJECT ENGINEER:	M.H.	PROJECT:	2005111	SHEET NO.	57
PROJECT TECHNICIAN:	M.V.O.	DATE:	June, 2006		