

REVISED: 4/29/09 — GDAVIS  
 C:\Acad\_Jobs\Rockwall\2005111\Sheets\2005111-052-STMSEW-PPB1.dwg  
 PLOT SCALE: 1:20  
 PLOT STYLE: 22X34.ctb  
 PLOTTED BY: GDAVIS ON 4/30/2009

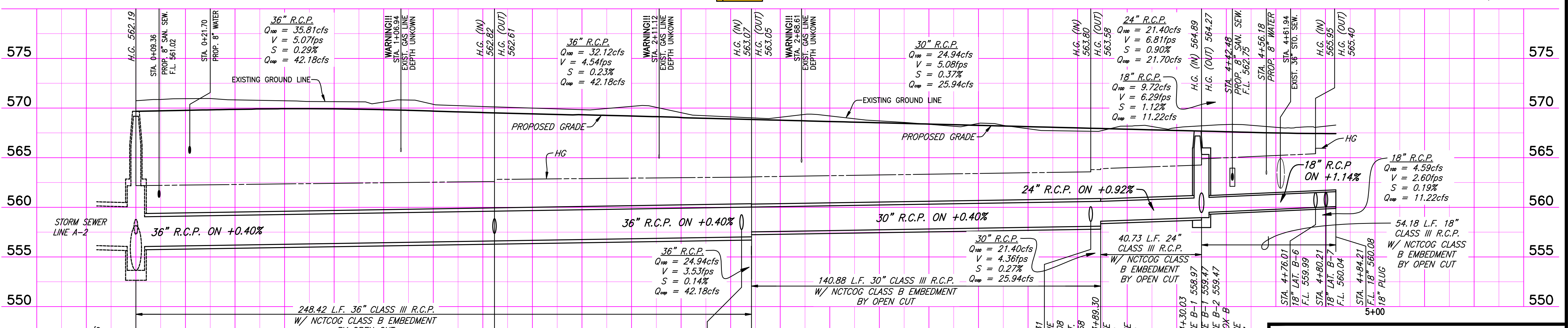
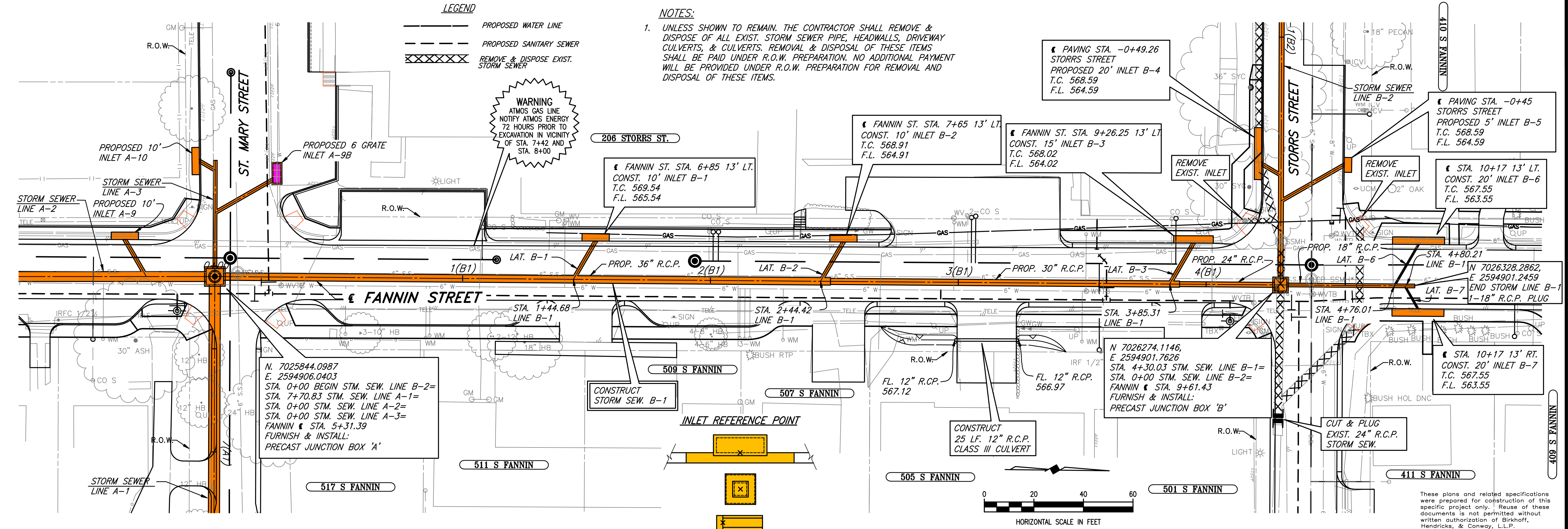

These plans and related specifications were prepared for construction of this specific project only. Reuse of these documents is not permitted without written authorization of Birkhoff, Hendricks, & Conway, L.L.P.

**CITY OF ROCKWALL, TEXAS**

**FANNIN STREET IMPROVEMENTS**  
**STM. SEW. "LINE B-1" - PLAN & PROFILE**  
**STA. 0+00 TO STA. 4+84.21**

**BIRKHOFF, HENDRICKS & CONWAY, L.L.P.**  
 CONSULTING ENGINEERS  
 Dallas, Texas

PROJECT ENGINEER: M.H. PROJECT: 2005111 SHEET NO. 52  
 PROJECT TECHNICIAN: M.V.O. DATE: June, 2006

THESE DOCUMENTS ARE FOR BIDDING, CONSTRUCTION, AND PERMIT PURPOSES.  
 DATE: 6/19/09

85480  
 LICENSED PROFESSIONAL ENGINEER  
 MATTHEW HICKEY

ST. MARY STREET  
 STORRS STREET  
 FANNIN STREET  
 206 STORRS ST.  
 509 S FANNIN  
 507 S FANNIN  
 511 S FANNIN  
 505 S FANNIN  
 501 S FANNIN  
 411 S FANNIN  
 409 S FANNIN

WARNING: ATMOSPHERIC GAS LINE NOTIFY ATMOSPHERIC ENERGY 72 HOURS PRIOR TO EXCAVATION IN VICINITY OF STA. 7+42 AND STA. 8+00

LEGEND:  
 - - - - - PROPOSED WATER LINE  
 - - - - - PROPOSED SANITARY SEWER  
 X X X X X REMOVE & DISPOSE EXIST. STORM SEWER

NOTES:  
 1. UNLESS SHOWN TO REMAIN, THE CONTRACTOR SHALL REMOVE & DISPOSE OF ALL EXIST. STORM SEWER PIPE, HEADWALLS, DRIVEWAY CULVERTS, & CULVERTS. REMOVAL & DISPOSAL OF THESE ITEMS SHALL BE PAID UNDER R.O.W. PREPARATION. NO ADDITIONAL PAYMENT WILL BE PROVIDED UNDER R.O.W. PREPARATION FOR REMOVAL AND DISPOSAL OF THESE ITEMS.

PAVING STA. -0+49.26 STORRS STREET PROPOSED 20' INLET B-4 T.C. 568.59 F.L. 564.59  
 FANNIN ST. STA. 7+65 13' LT. CONST. 10' INLET B-2 T.C. 568.91 F.L. 564.91  
 FANNIN ST. STA. 9+26.25 13' LT. CONST. 15' INLET B-3 T.C. 568.02 F.L. 564.02  
 PAVING STA. -0+45 STORRS STREET PROPOSED 5' INLET B-5 T.C. 568.59 F.L. 564.59  
 STA. 10+17 13' LT. CONST. 20' INLET B-6 T.C. 567.55 F.L. 563.55  
 STA. 10+17 13' RT. CONST. 20' INLET B-7 T.C. 567.55 F.L. 563.55

STORM SEWER LINE A-2  
 STORM SEWER LINE A-3  
 STORM SEWER LINE B-1  
 STORM SEWER LINE B-2  
 STORM SEWER LINE B-6  
 STORM SEWER LINE B-7

PROPOSED 10' INLET A-10  
 PROPOSED 10' INLET A-9  
 PROPOSED 6 GRATE INLET A-9B

CONSTRUCT STORM SEW. B-1  
 CONSTRUCT 25 LF. 12" R.C.P. CLASS III CULVERT  
 CUT & PLUG EXIST. 24" R.C.P. STORM SEW.

PRECISE JUNCTION BOX 'A'  
 PRECAST JUNCTION BOX 'B'

INLET REFERENCE POINT

HORIZONTAL SCALE IN FEET

EXISTING GROUND LINE  
 PROPOSED GRADE

36" R.C.P. ON +0.40%  
 30" R.C.P. ON +0.40%  
 24" R.C.P. ON +0.92%  
 18" R.C.P. ON +1.14%

248.42 L.F. 36" CLASS III R.C.P. W/ NCTCOG CLASS B EMBEDMENT BY OPEN CUT  
 140.88 L.F. 30" CLASS III R.C.P. W/ NCTCOG CLASS B EMBEDMENT BY OPEN CUT  
 40.73 L.F. 24" CLASS III R.C.P. W/ NCTCOG CLASS B EMBEDMENT BY OPEN CUT  
 54.18 L.F. 18" CLASS III R.C.P. W/ NCTCOG CLASS B EMBEDMENT BY OPEN CUT

ST. 0+00  
 F.L. 562.66  
 F.L. 563.66  
 F.L. 556.04  
 F.L. 557.29  
 F.L. 556.04

STA. 1+44.68  
 F.L. 556.62  
 F.L. 557.37

STA. 2+44.42  
 F.L. 557.02  
 F.L. 557.77

STA. 2+48.42  
 F.L. 557.04  
 F.L. 557.54

STA. 3+85.31  
 F.L. 558.08  
 F.L. 558.58  
 P.V.I. STA. 3+89.30  
 F.L. 558.10  
 F.L. 558.60

P.V.I. STA. 4+30.03  
 F.L. 559.47  
 F.L. 559.47  
 F.L. 559.47  
 F.L. 559.47

STA. 4+84.21  
 F.L. 559.99  
 STA. 4+80.21  
 F.L. 560.04  
 STA. 4+84.21  
 F.L. 560.08  
 F.L. 560.08

STA. 0+00 BEGIN STM. SEW. LINE B-2=  
 STA. 7+70.83 STM. SEW. LINE A-1=  
 STA. 0+00 STM. SEW. LINE A-2=  
 STA. 0+00 STM. SEW. LINE A-3=  
 FANNIN @ STA. 5+31.39  
 FURNISH & INSTALL:  
 PRECAST JUNCTION BOX 'A'

STA. 0+00 BEGIN STM. SEW. LINE B-1=  
 STA. 4+30.03 STM. SEW. LINE B-2=  
 FANNIN @ STA. 9+61.43  
 FURNISH & INSTALL:  
 PRECAST JUNCTION BOX 'B'