

REVISION: 4/23/09 - GDAVIS  
 C:\Acad\_Jobs\Rockwall\2005111\Sheets\2005111-020\_PP9.dwg  
 PLOT SCALE: 1:20  
 PLOT STYLE: 22x34.ctb  
 PLOTTED BY: GDAVIS ON 4/30/2009

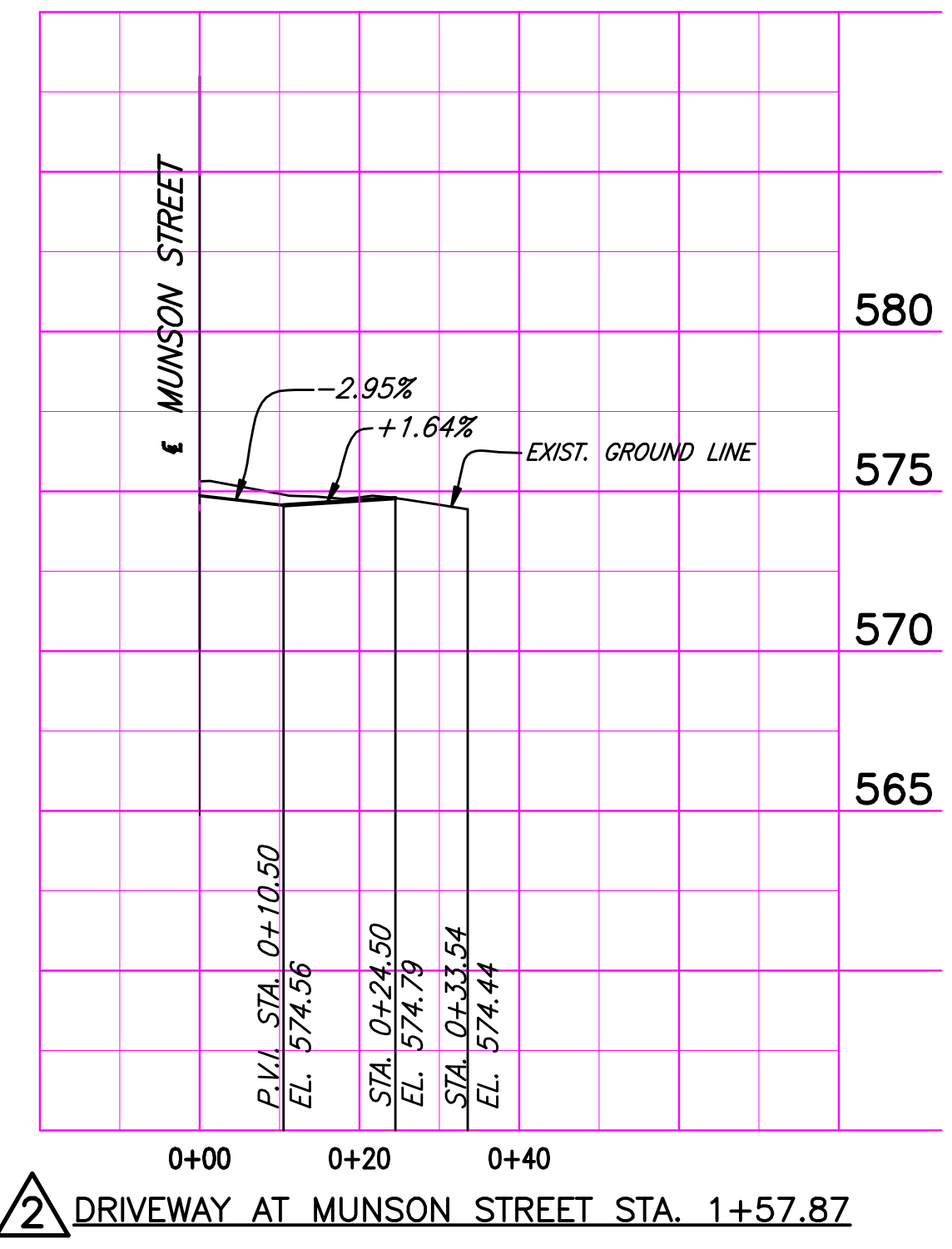
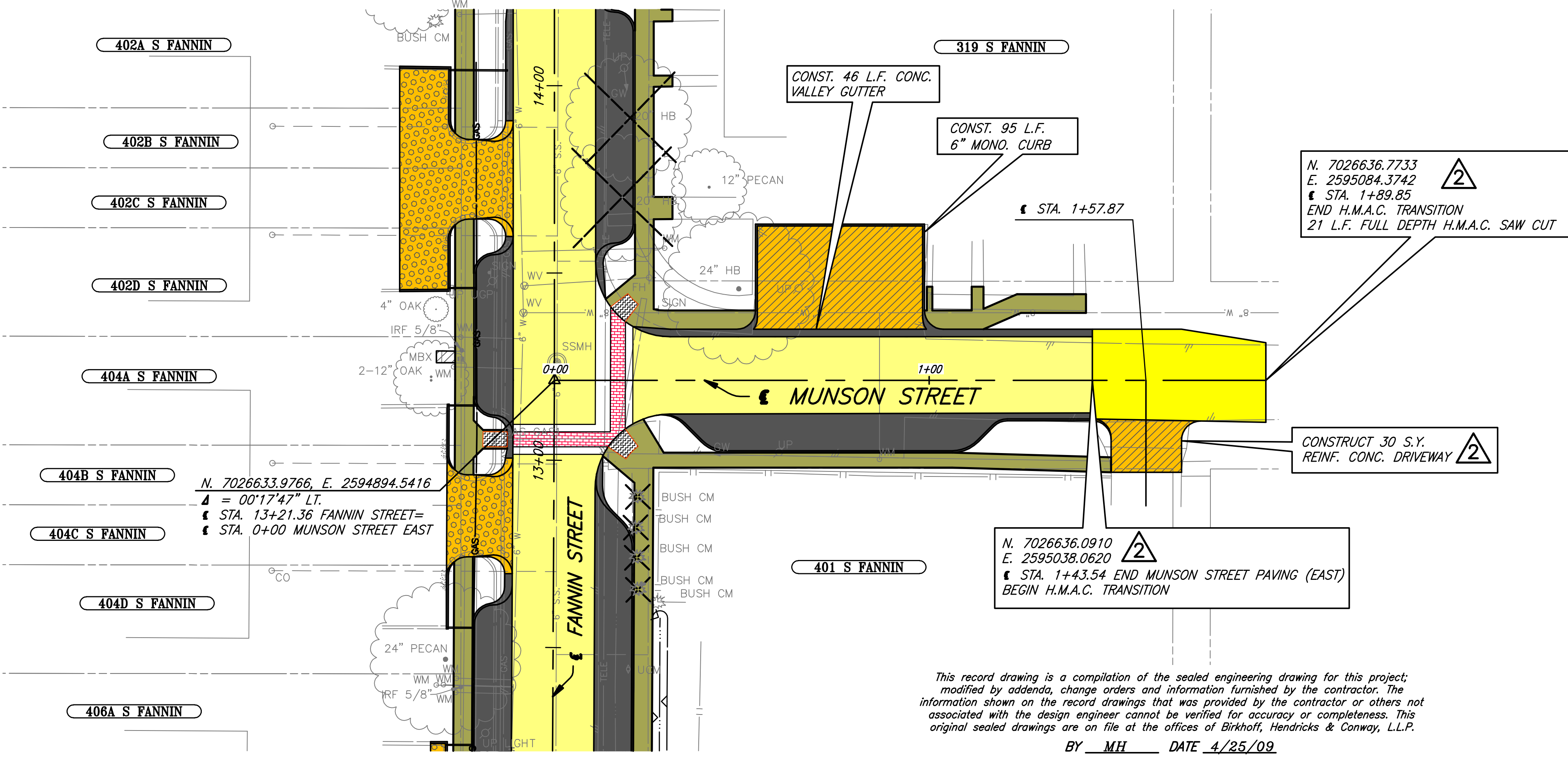

- LEGEND**
- CONSTRUCT H.M.A.C. PAVEMENT
  - CONST. REINF. CONC. CURB & GUTTER OR CONCRETE PARKING NICHE W/ VALLEY GUTTER & MONO. CONC. CURB
  - CONSTRUCT REINF. CONC. SIDEWALK
  - CONSTRUCT H.M.A.C. TRANSITION
  - CONSTRUCT BARRIER FREE RAMP
  - CONSTRUCT BRICK PAVERS
  - CONSTRUCT REINF. CONC. DRIVEWAY
  - CONSTRUCT EXPOSED AGGREGATE CONCRETE DRIVEWAY
  - CONSTRUCT 8" REINF. CONC. PVMT.
  - PROPOSED TREE REMOVAL

This record drawing is a compilation of the sealed engineering drawing for this project; modified by addenda, change orders and information furnished by the contractor. The information shown on the record drawings that was provided by the contractor or others not associated with the design engineer cannot be verified for accuracy or completeness. This original sealed drawings are on file at the offices of Birkhoff, Hendricks & Conway, L.L.P.  
 BY MH DATE 4/25/09

CHANGE ORDER NO. 2 - MARCH 28, 2008

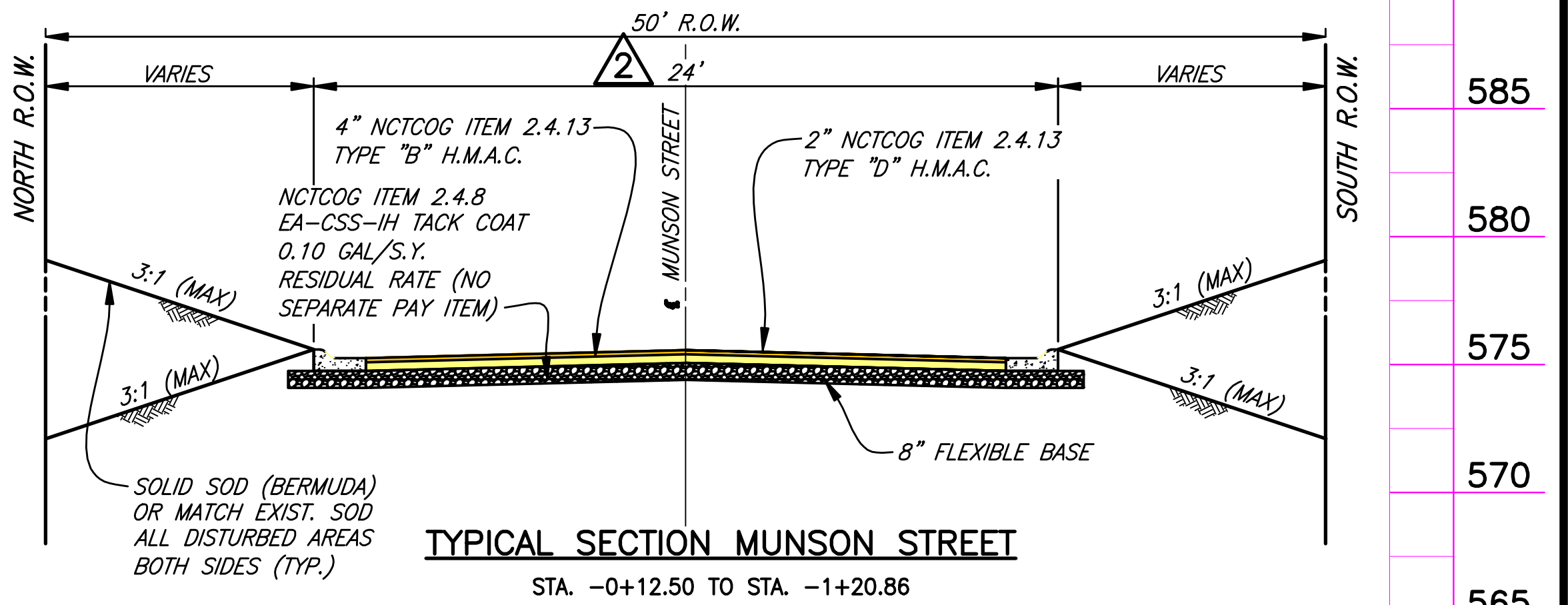
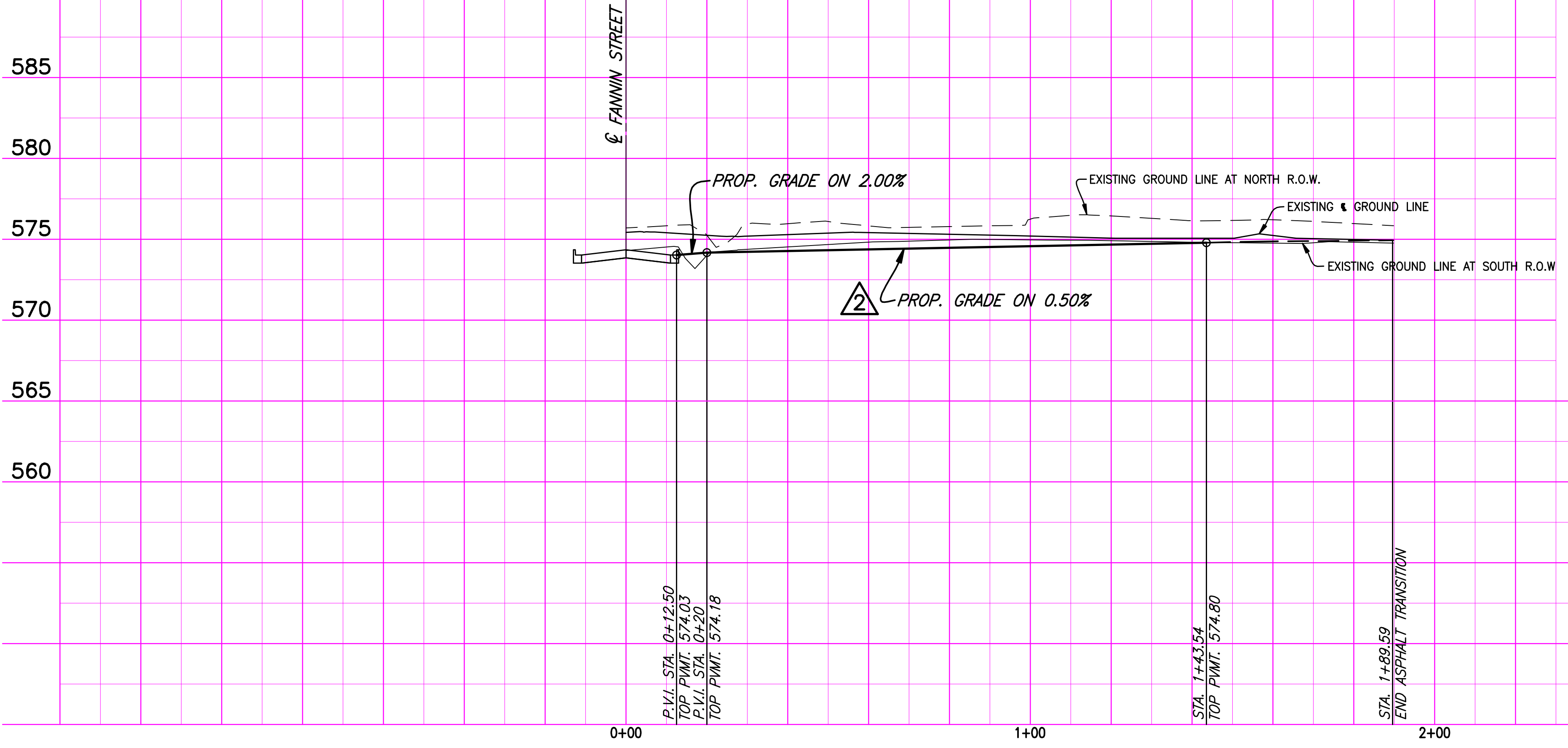

**CITY OF ROCKWALL, TEXAS**

**MUNSON STREET IMPROVEMENTS  
 PAVING - PLAN & PROFILE  
 STA. 0+00 TO STA. 1+20.86**

**BIRKHOFF, HENDRICKS & CONWAY, L.L.P.**  
 CONSULTING ENGINEERS  
 Dallas, Texas

THESE DOCUMENTS ARE FOR BIDDING, CONSTRUCTION, AND PERMIT PURPOSES.  
 Matthew Hickey  
 DATE: 4/19/09



PROJECT ENGINEER:	M.H.	PROJECT:	2005111	SHEET NO.	20
PROJECT TECHNICIAN:	J.M.	DATE:	March, 2008		