

**LEGEND**

- CONSTRUCT H.M.A.C. PAVEMENT
- CONST. REINF. CONC. CURB & GUTTER OR CONCRETE PARKING NICHE W/ VALLEY GUTTER & MONO. CONC. CURB
- CONSTRUCT REINF. CONC. SIDEWALK
- CONSTRUCT H.M.A.C. TRANSITION
- CONSTRUCT BARRIER FREE RAMP
- CONSTRUCT BRICK PAVERS
- CONSTRUCT REINF. CONC. DRIVEWAY
- CONSTRUCT 8" REINF. CONC. P.V.M.T.
- X PROPOSED TREE REMOVAL

0 20 40 60  
HORIZONTAL SCALE IN FEET

These plans and related specifications were prepared for construction of this specific project only. Reuse of these documents is not permitted without written authorization of Birkhoff, Hendricks, & Conway, L.L.P.

- NOTES:**
1. PROP. CONCRETE SIDEWALKS & DRIVEWAYS ALONG THE WEST SIDE OF FANNIN, BETWEEN STA. 10+50 TO STA. 14+50 SHALL HAVE AN EXPOSED AGGREGATE CONCRETE FINISH MATCHING THE EXISTING EXPOSED AGGREGATE FINISH FROM ADDRESS 402A S. FANNIN TO 408D S. FANNIN.
  2. THE CONTRACTOR SHALL TRANSPLANT & RELOCATE FOUR EXISTING CRAPE MYRTLE TREES LOCATED ALONG THE EAST SIDE OF FANNIN ST. ON 401 S. FANNIN, IN A LOCATION ACCEPTABLE TO THE OWNER. PAYMENT FOR RELOCATION SHALL BE SUBSIDIARY TO ROW PREPARATION.
  3. PROPOSED 4" P.V.C. DRAINS—CONTRACTOR SHALL CONSTRUCT 78 LF. 4" P.V.C. DRAINS FROM THE BACK OF PARKING LOT CURBS BETWEEN 402A & 408D S. FANNIN INTO THE PROPOSED FANNIN CURB. P.V.C. DRAINS SHALL BE GRADED TO DRAIN.
  4. CONTRACTOR SHALL REMOVE EXIST PARKING LOT P.V.C. DRAINS AND REPLACE WITH NEW 4" P.V.C. DRAINS. DRAINS SHALL DAY LIGHT TO CURB & PROVIDE POSITIVE DRAINAGE.

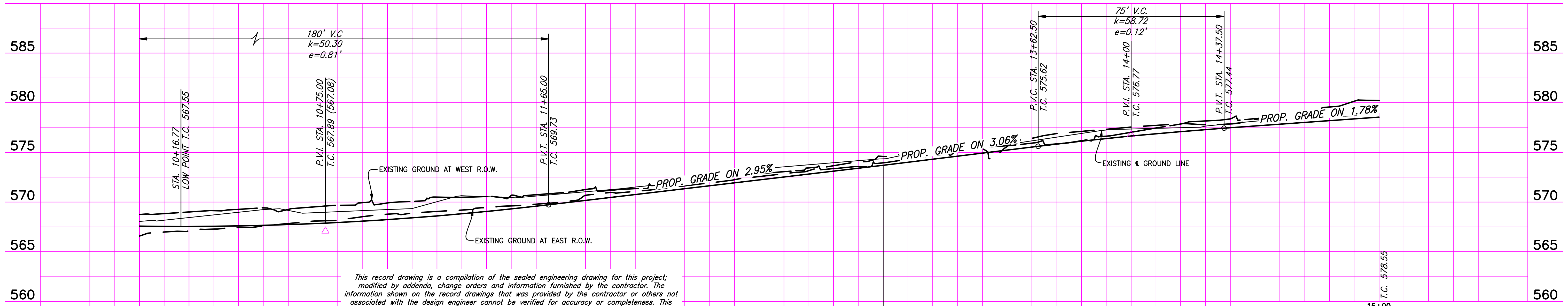

This record drawing is a compilation of the sealed engineering drawing for this project, modified by addenda, change orders and information furnished by the contractor. The information shown on the record drawings that was provided by the contractor or others not associated with the design engineer cannot be verified for accuracy or completeness. This original sealed drawings are on file at the offices of Birkhoff, Hendricks & Conway, L.L.P.  
 BY MH DATE 4/25/09

THESE DOCUMENTS ARE FOR BIDDING, CONSTRUCTION, AND PERMIT PURPOSES.  
 DATE: 01/19/09



**CITY OF ROCKWALL, TEXAS**

FANNIN STREET IMPROVEMENTS  
 PAVING – PLAN & PROFILE  
 STA. 10+00 TO STA. 15+00

**BIRKHOFF, HENDRICKS & CONWAY, L.L.P.**  
 CONSULTING ENGINEERS  
 Dallas, Texas

PROJECT ENGINEER: M.H.	PROJECT: 2005111	SHEET NO. 13
PROJECT TECHNICIAN: J.M.	DATE: June, 2006	