

REVISION: 4/24/09 - GDAVIS
 C:\Acad_Jobs\Rockwall\2005111\Sheets\2005111-008_COORD-05.dwg
 PLOT SCALE: 1:20
 PLOT STYLE: 22X34.ctb
 PLOTTED BY: GDAVIS ON 4/30/2009

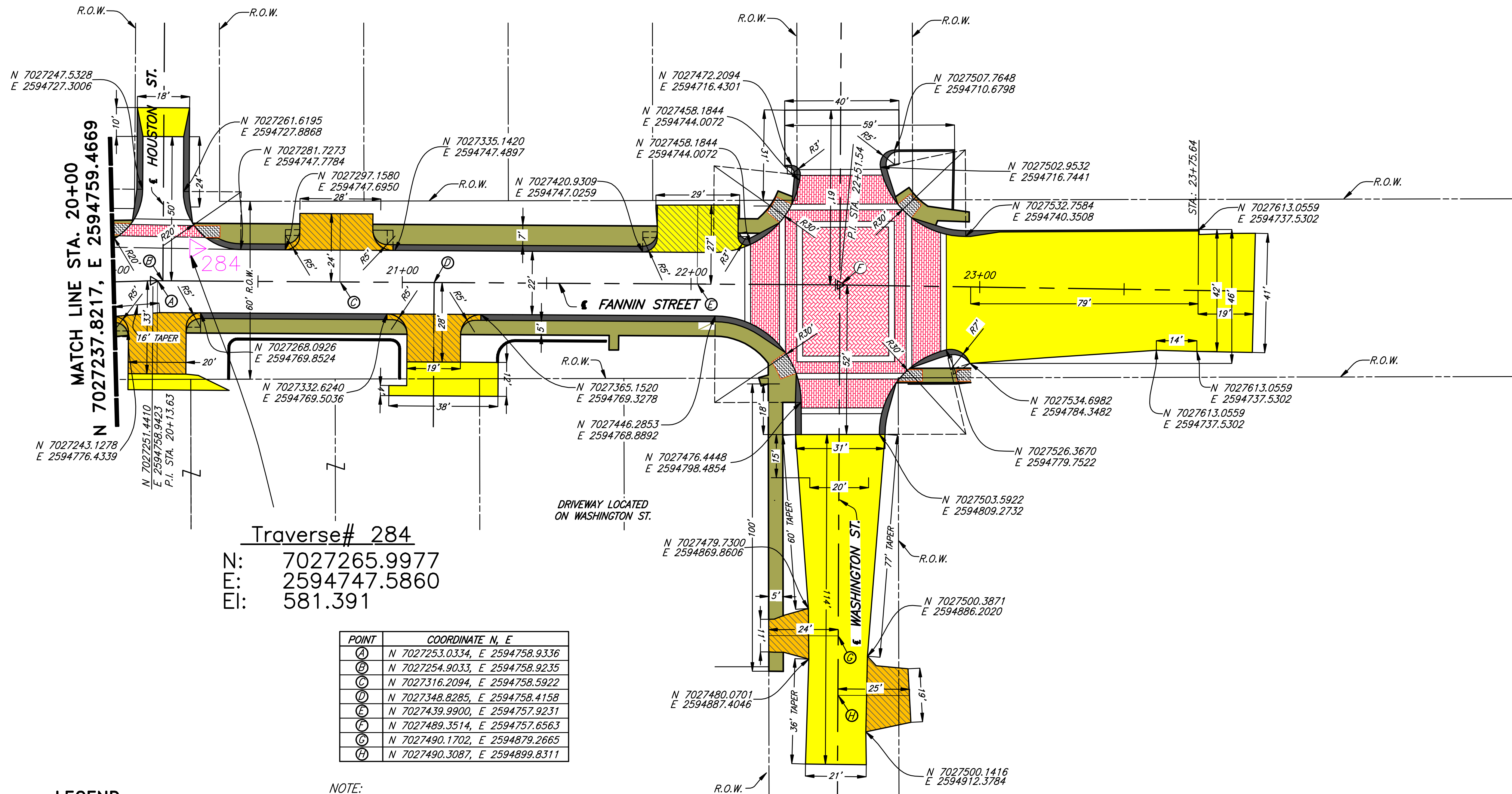

Traverse# 284
 N: 7027265.9977
 E: 2594747.5860
 El: 581.391

POINT	COORDINATE N, E
(A)	N 7027253.0334, E 2594758.9336
(B)	N 7027254.9033, E 2594758.9235
(C)	N 7027316.2094, E 2594758.5922
(D)	N 7027348.8285, E 2594758.4158
(E)	N 7027439.9900, E 2594757.9231
(F)	N 7027489.3514, E 2594757.6563
(G)	N 7027490.1702, E 2594879.2665
(H)	N 7027490.3087, E 2594899.8311

NOTE:
 UNLESS OTHERWISE SHOWN, ALL DRIVEWAY FACE OF CURB RADIUS ARE 7' AND BACK OF CURB RADIUS IS 5'.

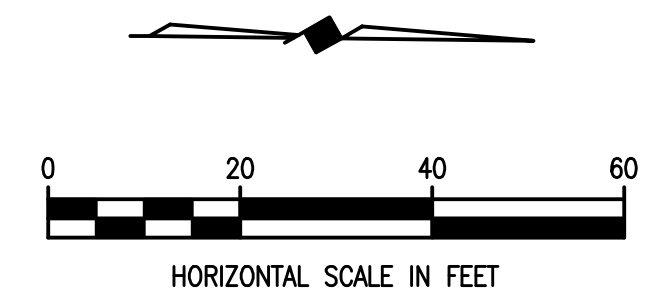

- LEGEND**
- PROPOSED CONCRETE DRIVE
 - PROPOSED BRICK PAVERS
 - PROPOSED CONCRETE CURB AND GUTTER OR PROPOSED CONCRETE PARKING NICHE W/ VALLEY GUTTER & MONOLITHIC CONCRETE CURB
 - PROPOSED CONCRETE SIDEWALK
 - PROPOSED CONCRETE DRIVEWAY
 - PROPOSED ASPHALT OVERLAY

This record drawing is a compilation of the sealed engineering drawing for this project; modified by addenda, change orders and information furnished by the contractor. The information shown on the record drawings that was provided by the contractor or others not associated with the design engineer cannot be verified for accuracy or completeness. This original sealed drawings are on file at the offices of Birkhoff, Hendricks & Conway, L.L.P.
 BY MH DATE 4/25/09

THESE DOCUMENTS ARE FOR BIDDING, CONSTRUCTION, AND PERMIT PURPOSES.
 DATE: 4/19/09

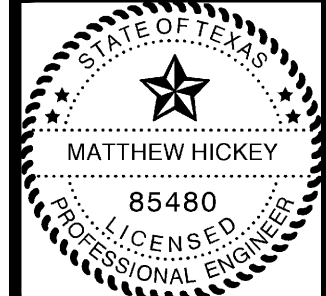

CITY OF ROCKWALL, TEXAS

FANNIN STREET IMPROVEMENTS
 COORDINATE/DIMENSION - PLAN
 STA. 20+00 TO STA. 23+75.64

BIRKHOFF, HENDRICKS & CONWAY, L.L.P.
 CONSULTING ENGINEERS
 Dallas, Texas

PROJECT ENGINEER: M.H.	PROJECT: 2005111	SHEET NO. 8
PROJECT TECHNICIAN: J.M.	DATE: June, 2006	

These plans and related specifications were prepared for construction of this specific project only. Reuse of these documents is not permitted without written authorization of Birkhoff, Hendricks, & Conway, L.L.P.