

REVISION: 4/22/09 - GDAVIS
 C:\Acad\Jobs\Rockwall\2005111\Sheets\2005111-103_DPW2.dwg
 PLOT SCALE: 1:10
 PLOT STYLE: 22X34.ctb
 PLOTTED BY: GDAVIS ON 5/4/2009

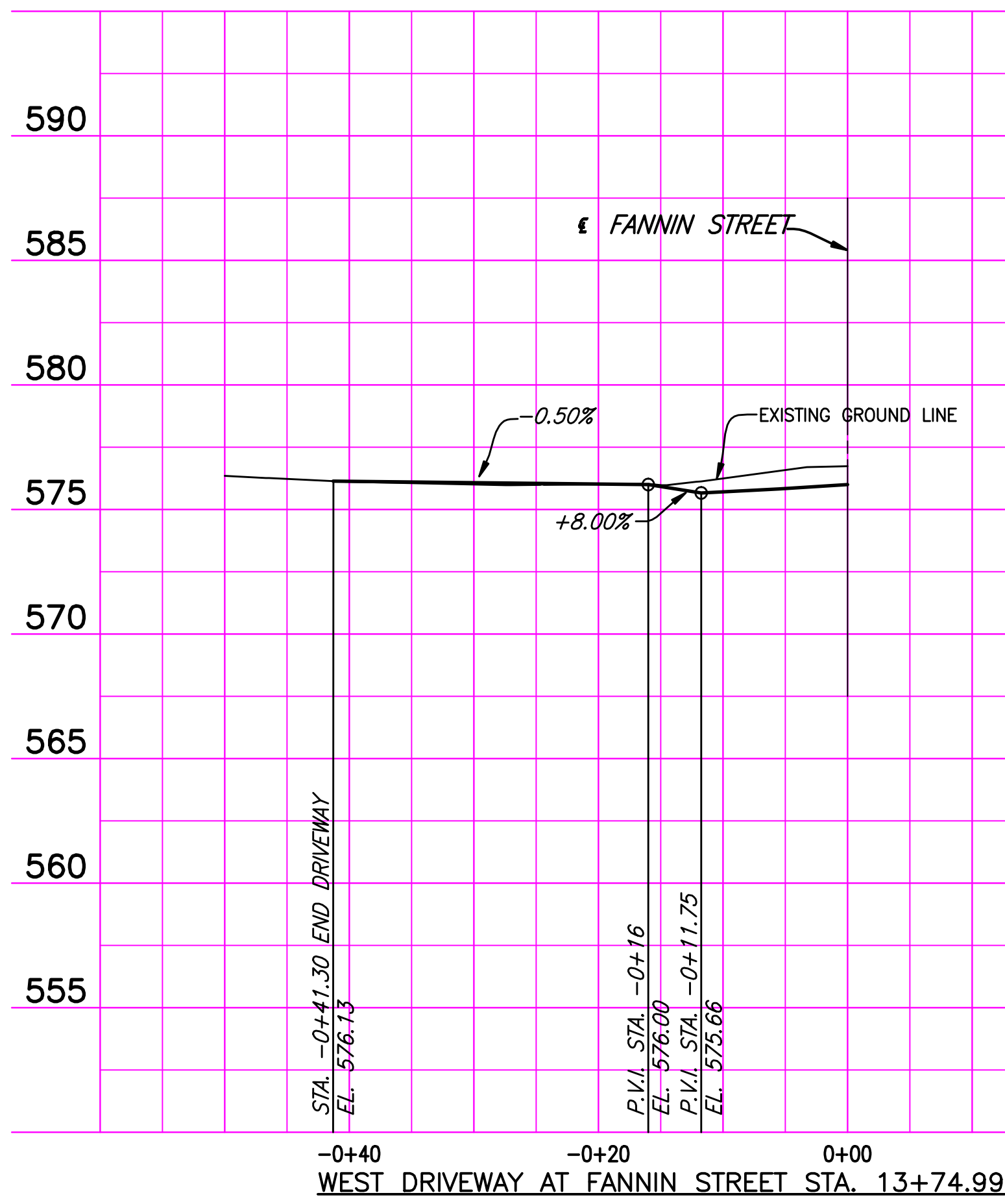

WEST DRIVEWAY AT FANNIN STREET STA. 13+74.99

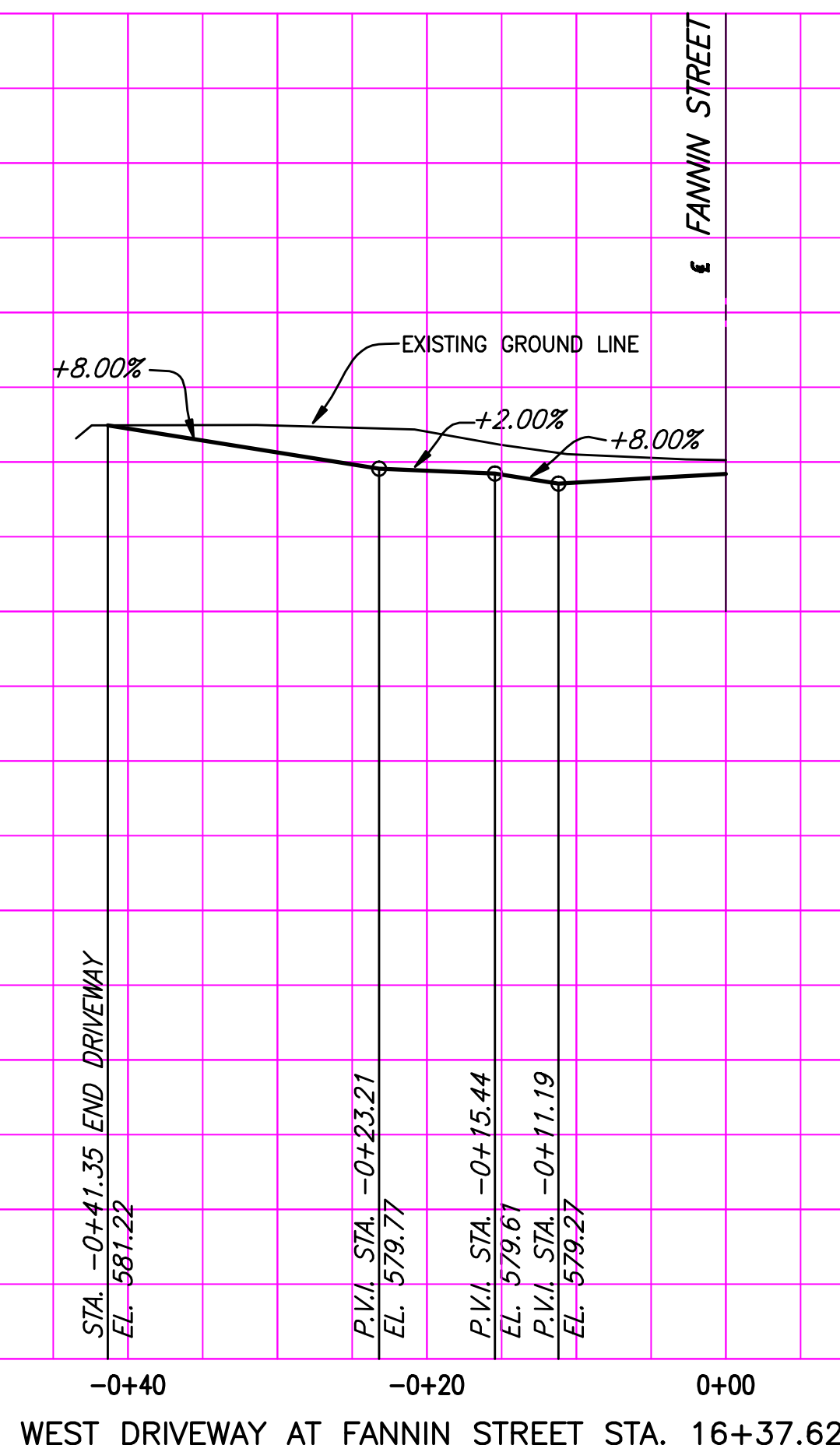

WEST DRIVEWAY AT FANNIN STREET STA. 16+37.62

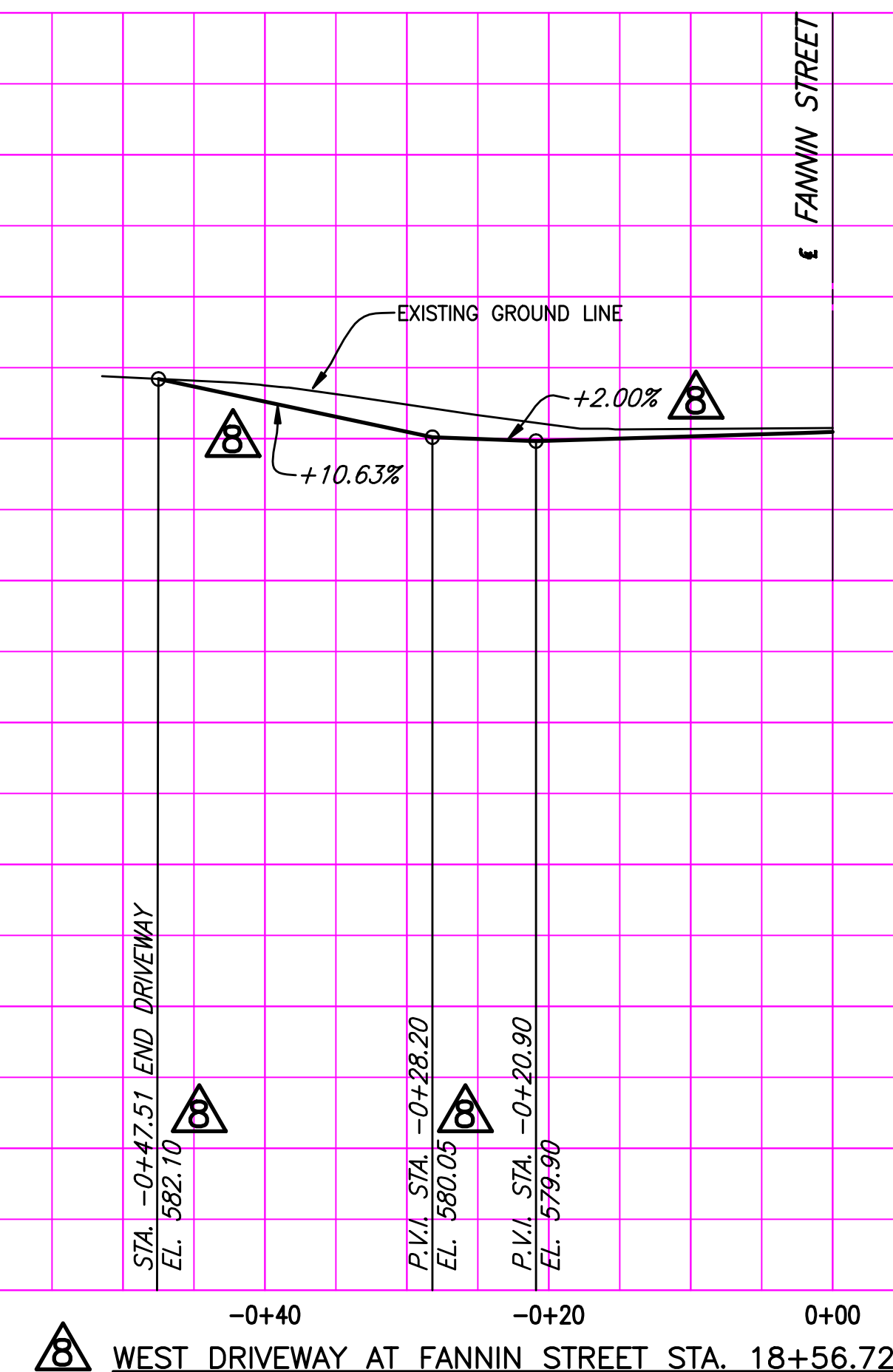

WEST DRIVEWAY AT FANNIN STREET STA. 18+56.72

These plans and related specifications were prepared for construction of this specific project only. Reuse of these documents is not permitted without written authorization of Birkhoff, Hendricks, & Conway, L.L.P.

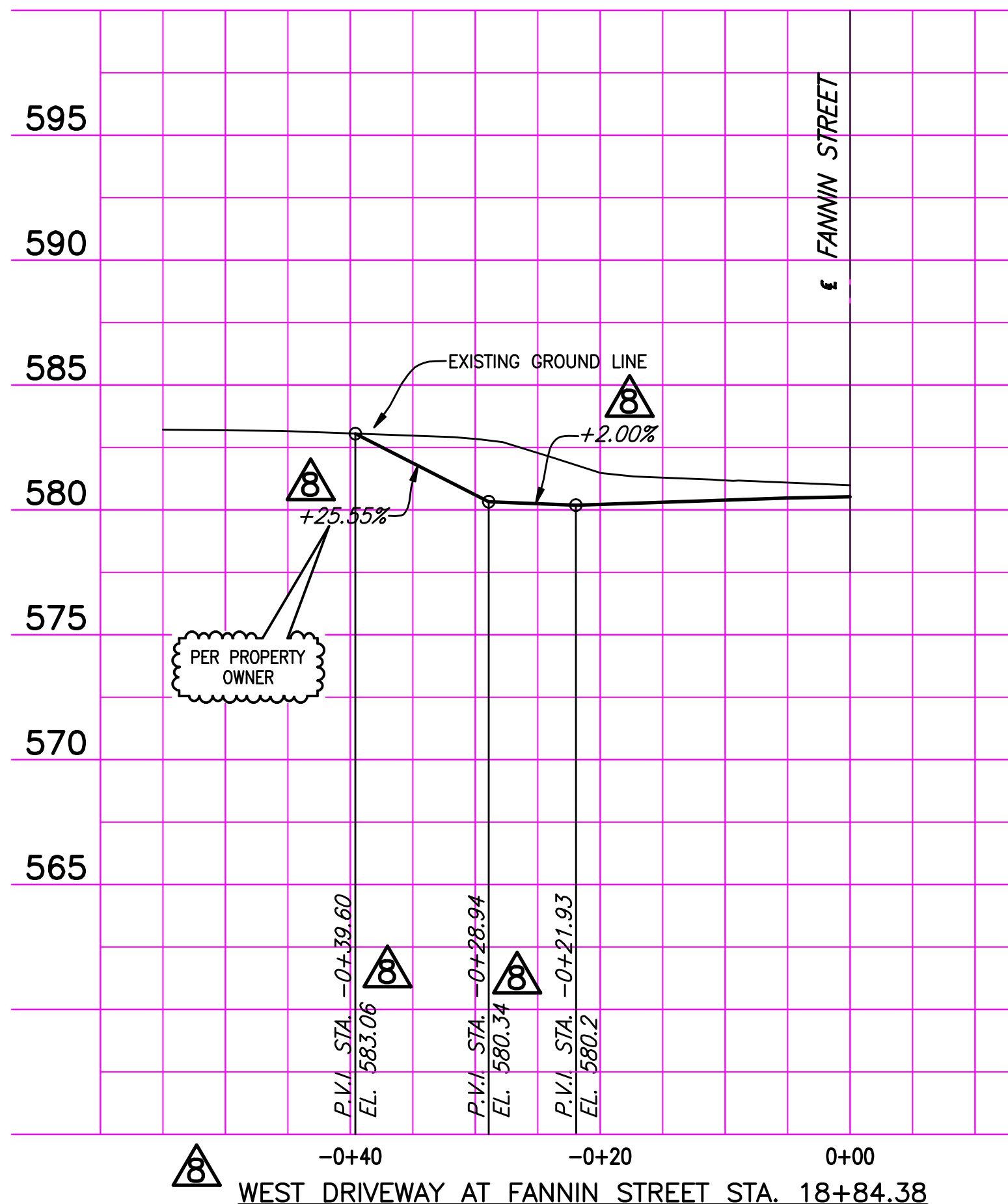

WEST DRIVEWAY AT FANNIN STREET STA. 18+84.38

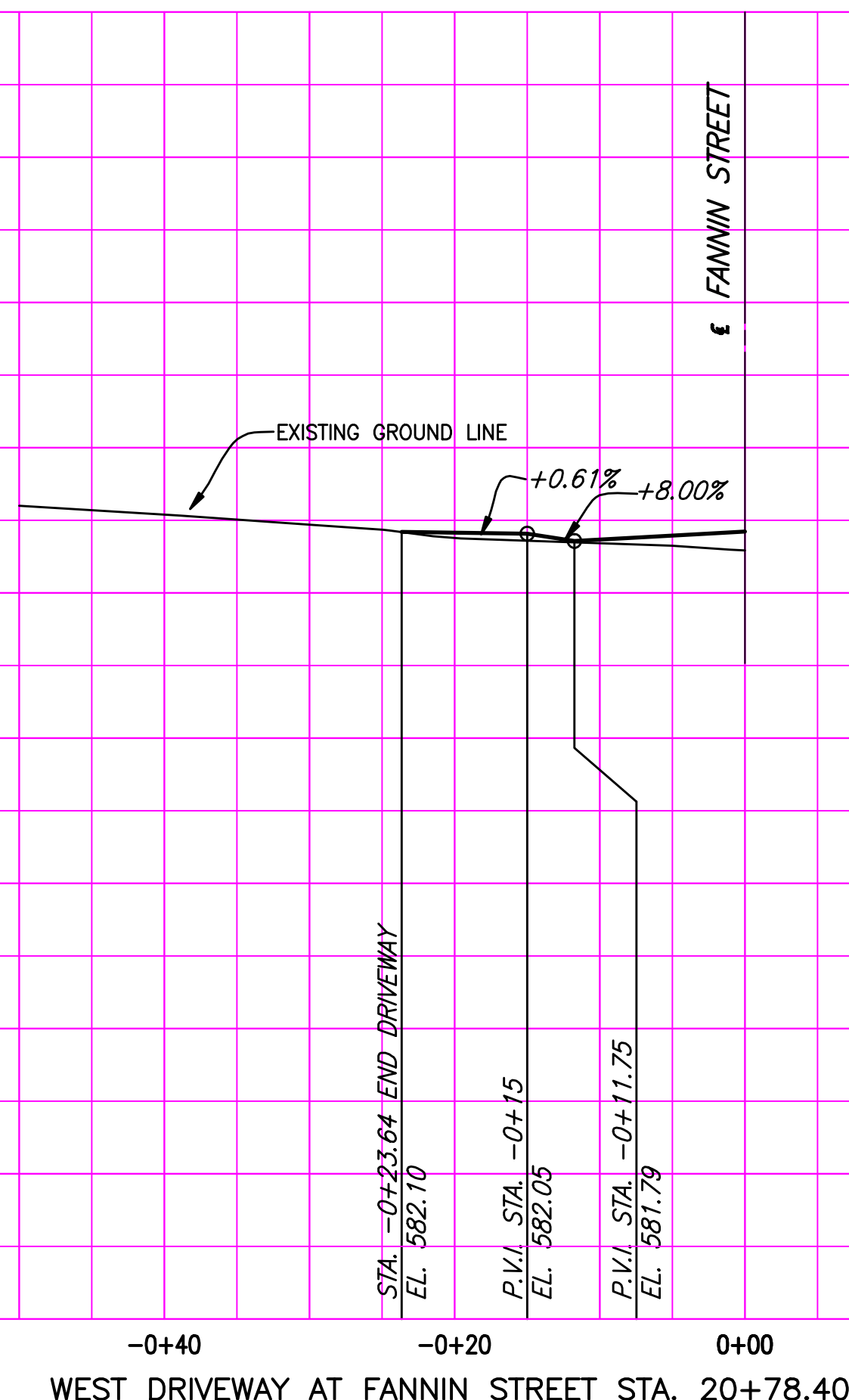

WEST DRIVEWAY AT FANNIN STREET STA. 20+78.40

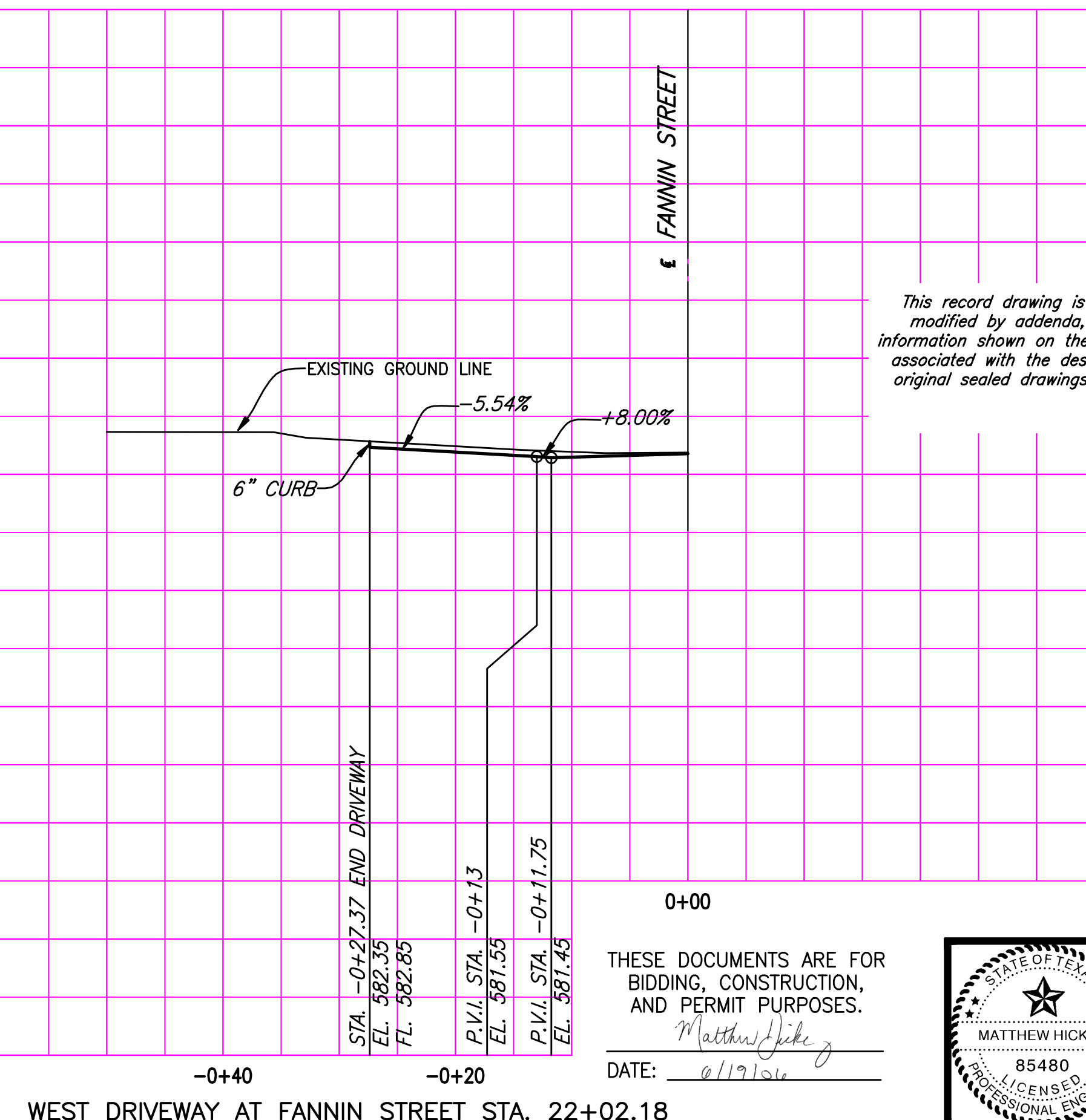

WEST DRIVEWAY AT FANNIN STREET STA. 22+02.18

This record drawing is a compilation of the sealed engineering drawing for this project; modified by addenda, change orders and information furnished by the contractor. The information shown on the record drawings that was provided by the contractor or others not associated with the design engineer cannot be verified for accuracy or completeness. This original sealed drawings are on file at the offices of Birkhoff, Hendricks & Conway, L.L.P.
 BY MH DATE 4/25/09

THESE DOCUMENTS ARE FOR BIDDING, CONSTRUCTION, AND PERMIT PURPOSES.

DATE: 8/19/08

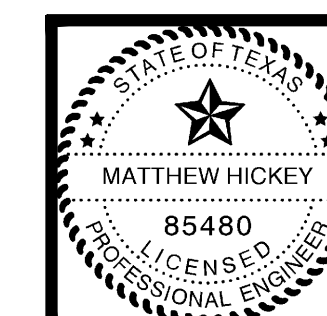

| | | | |
|--|--------------------|---------------|--|
| CITY OF ROCKWALL, TEXAS | | | |
| FANNIN STREET IMPROVEMENTS DRIVEWAY PROFILE - WEST STA. 13+00 TO STA. 22+20 | | | |
| BIRKHOFF, HENDRICKS & CONWAY, L.L.P. CONSULTING ENGINEERS Dallas, Texas | | | |
| PROJECT ENGINEER: M.H. | PROJECT: 2005111 | SHEET NO. 103 | |
| PROJECT TECHNICIAN: M.V.O. | DATE: August, 2008 | | |

FIELD CHANGE NO. 8 (8/5/2008)