

MATCH LINE STA 190+00

MATCH LINE STA 200+00

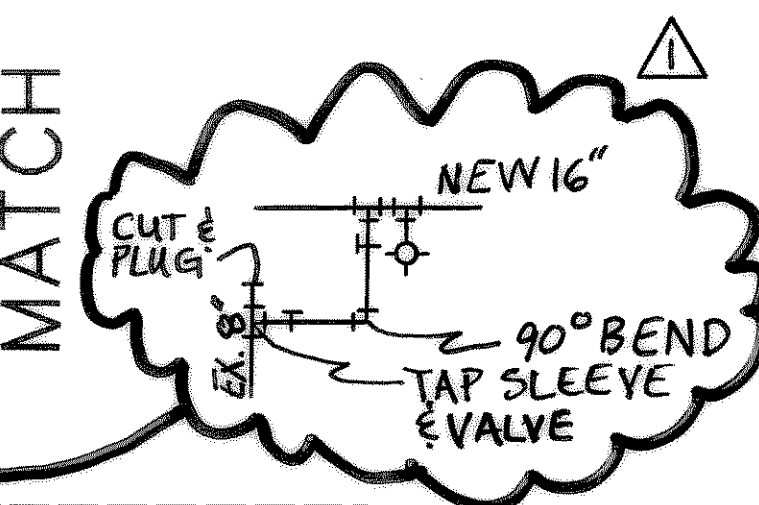
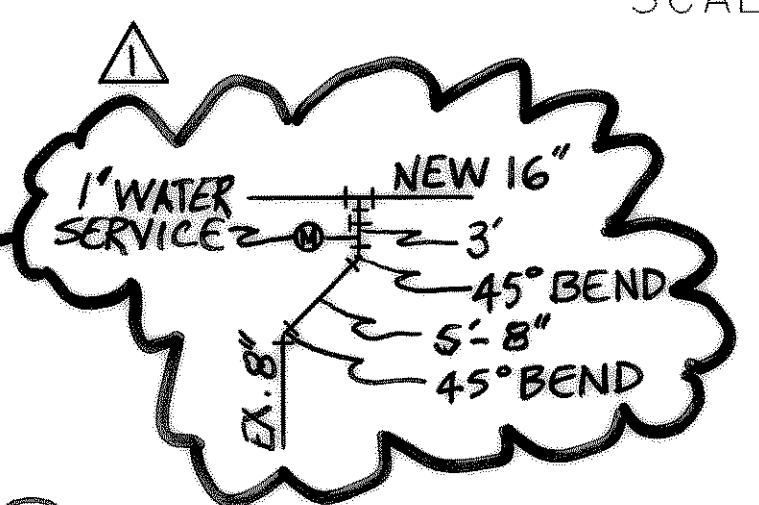
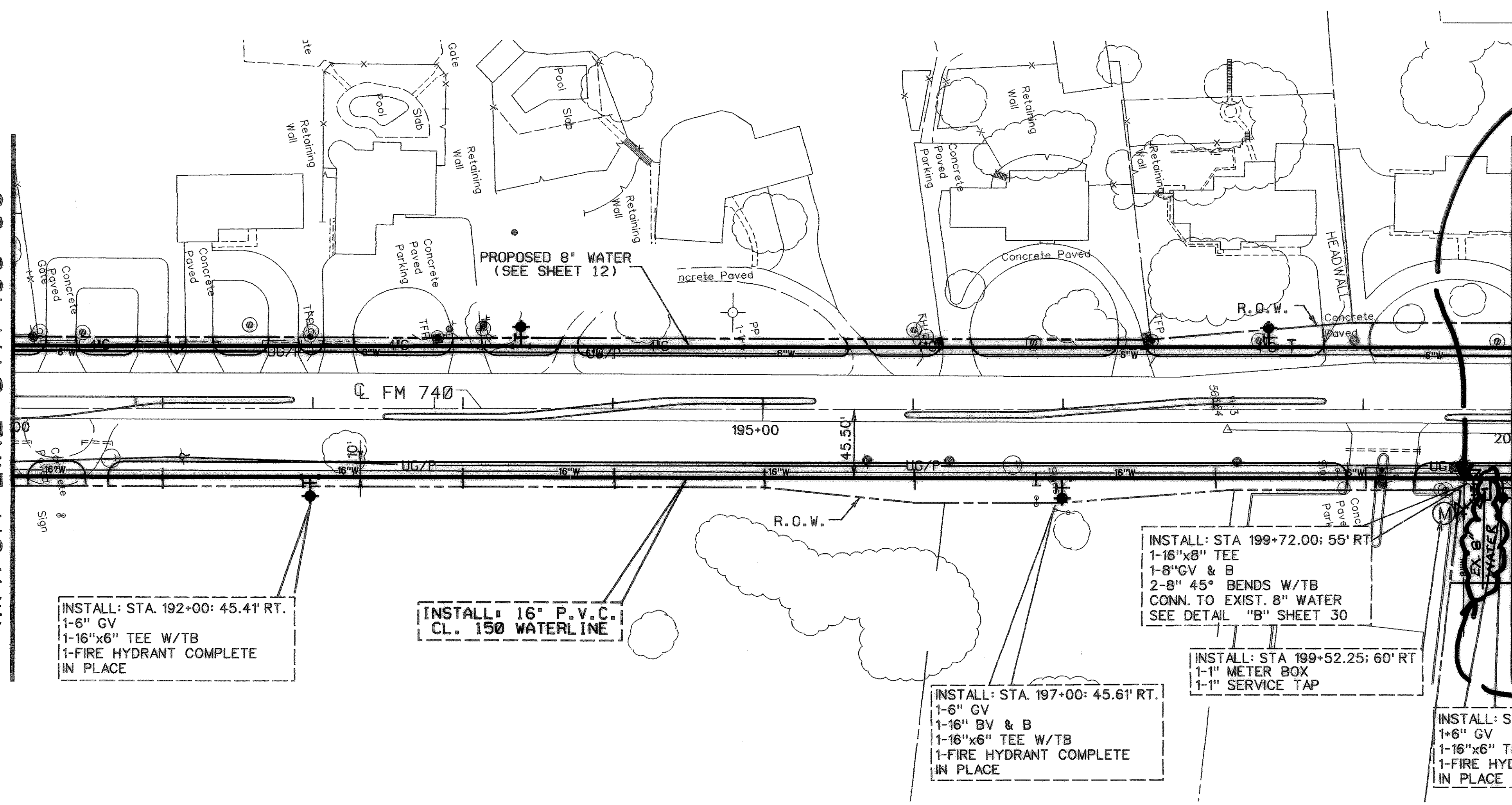

**RECORD DRAWING**  
 VERIFIED BY *Voronica Sain*  
 DATE 4-20-08

NOTE:  
 ABANDON EXISTING 16" WATERLINE IN PLACE.  
 FROM STA 190+00 TO STA 200+00

△ RECORD DRAWING

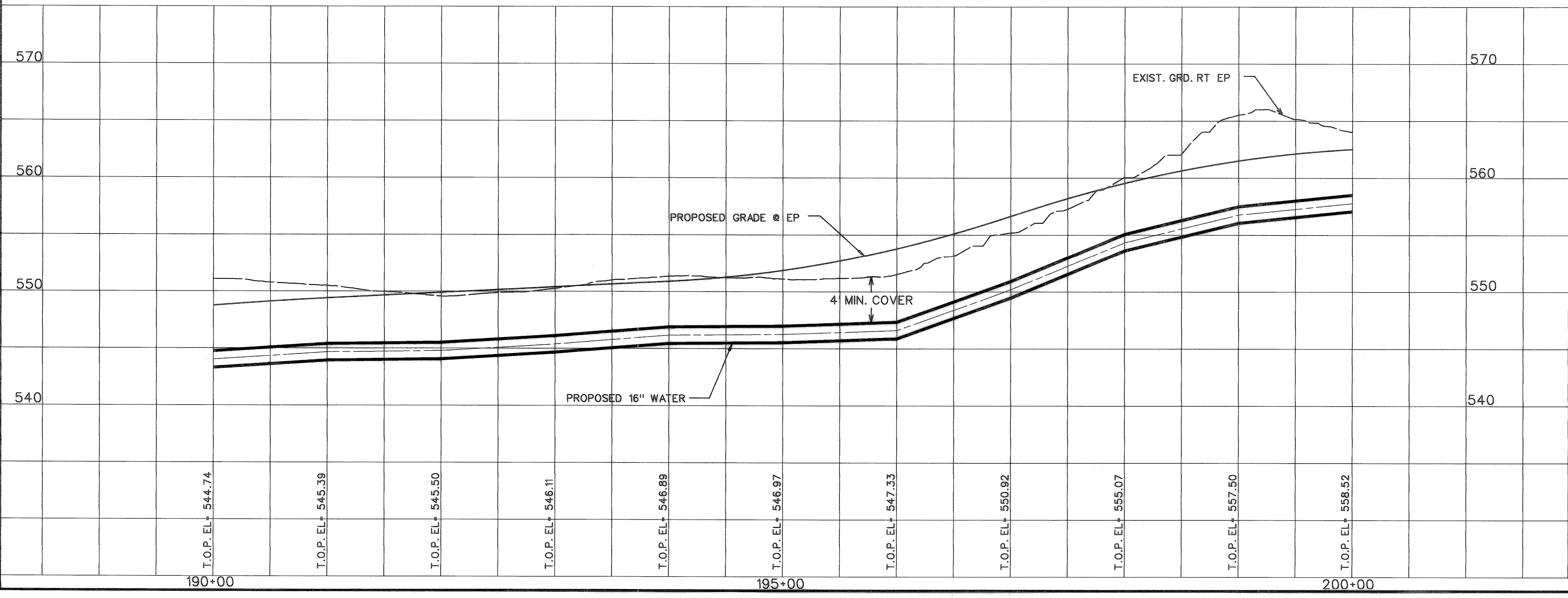

STATE OF TEXAS  
 VORONIQUE V. SIMON  
 LICENSED PROFESSIONAL ENGINEER  
*Voronica Sain*  
 4-19-00

STATE OF TEXAS  
 ROBERT C. REACH  
 LICENSED PROFESSIONAL ENGINEER  
*Robert C. Reach*  
 1-14-99

**CITY OF ROCKWALL**  
 "THE NEW HORIZON"

UTILITY RELOCATIONS  
 FOR FM 740 WIDENING

UTILITY PLAN AND PROFILE  
 PROPOSED 16" WATER LINE  
 STA. 190+00 TO STA. 200+00

**TurnerCollie & Braden Inc.**  
 ENGINEERS • PLANNERS • PROJECT MANAGERS

Unit	A103	Scale:	Horz. 1"=50' Vert. 1"=5'	Date	JANUARY 1999
Designed	TCB	Checked	V.S.	Job No.	15-97925-100
Drawn	TCB	Approved	<i>TCB</i>		SHEET 19 OF 31