

GRAPHIC SCALE

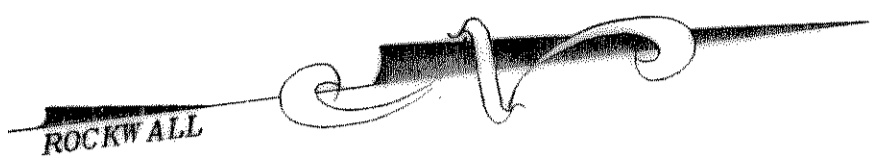
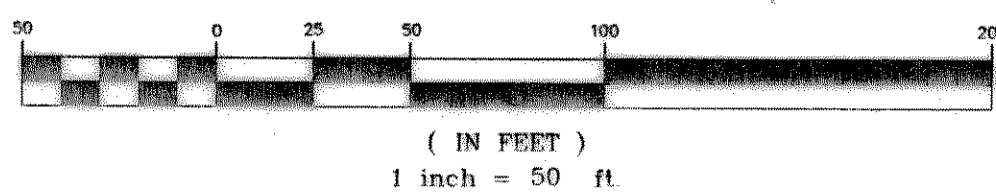

GENERAL NOTES

1. ALL CONSTRUCTION IS TO CONFORM WITH THE CITY OF ROCKWALL STANDARDS OF DESIGN AND STANDARD SPECIFICATIONS FOR CONSTRUCTION.
2. PROPOSED 8" P.V.C. C-900 CL 150 WATER LINE TO BE INSTALLED AT A MINIMUM OF 5.0' (60") BELOW EXISTING GROUND LINE.
3. EXISTING 8" WATER LINE TO REMAIN IN OPERATION UNTIL PROPOSED WATER LINE IS IN PLACE AND TESTED.
4. THE CONTRACTOR IS TO VERIFY IN THE FIELD THE LOCATION OF ALL EXISTING UTILITIES PRIOR TO CONSTRUCTION. INFORMATION PROVIDED ON THIS PLAN DOES NOT RELIEVE THE CONTRACTOR OF THE FULL AND TOTAL RESPONSIBILITY FOR THE PROTECTION OF EXISTING UTILITIES NOR ANY DAMAGES CAUSED BY SAID CONTRACTOR DURING THE CONSTRUCTION THIS PROJECT.

**NOTE :**  
**F.M. 740 TO BE 4 LANE DIVIDED ROADWAY**  
**F.M. 740 TO BE CONSTRUCTED BY TEXAS**  
**DEPARTMENT OF TRANSPORTATION.**  
**(CONTROL # 1014-03-041)**

**INSTALL :**  
**575 LIN. FT. OF**  
**8" P.V.C. WATER LINE**

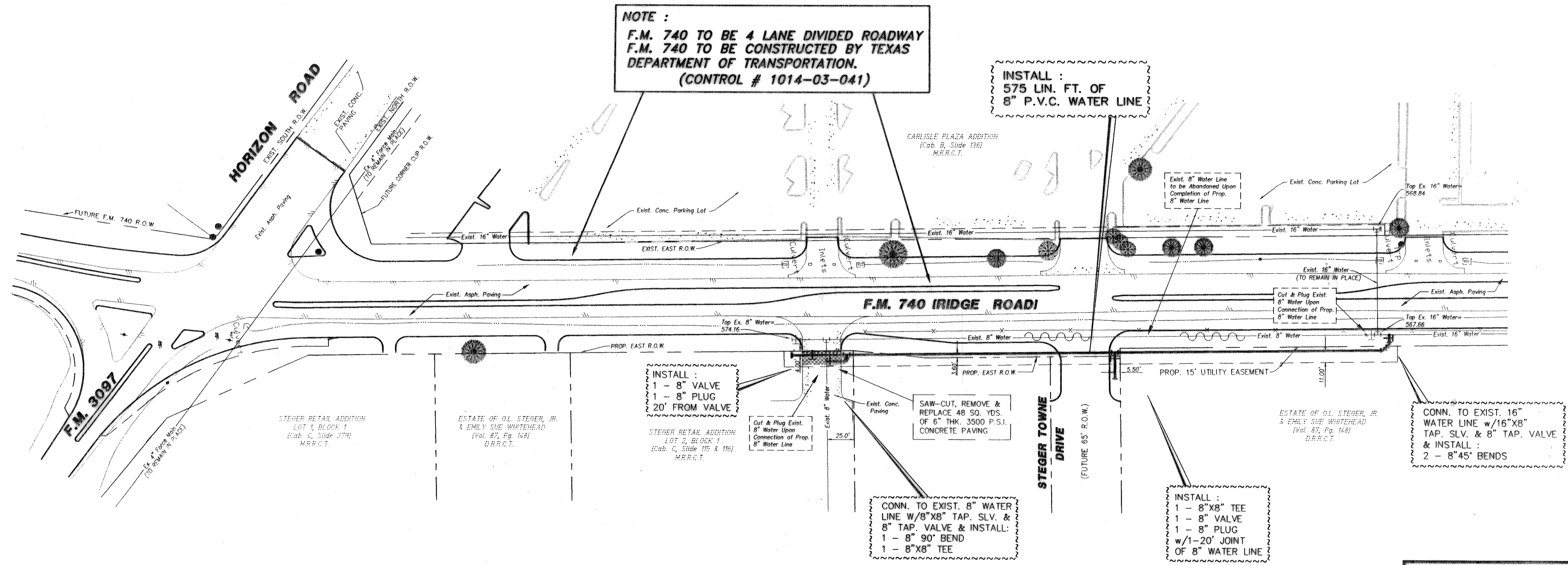

**WATER LINE RELOCATION**  
**F.M. 740 (IRIDGE ROAD)**  
**ROCKWALL, TEXAS**

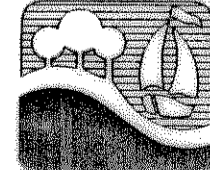

**CITY OF ROCKWALL**  
 "THE NEW HORIZON"

REVISION NO.	REMARKS	DATE

DESIGNED: B.W.H.	THE SEAL APPEARING ON THIS DOCUMENT WAS AUTHORIZED BY W.L. DOUPHRATE II TEXAS P.E. NO. 60102 ON 7/10/96
DRAWN: ACAD	
JOB NO.	

DATE: 5/1/96	SHEET NO. 1 OF 1
--------------	------------------

