

SURVEY CONTROL PROVIDED BY
 ARS ENGINEERS, INC.
 5910 N. CENTRAL EXPY, SUITE 1000
 DALLAS, TX 75206
 (214) 739-3152

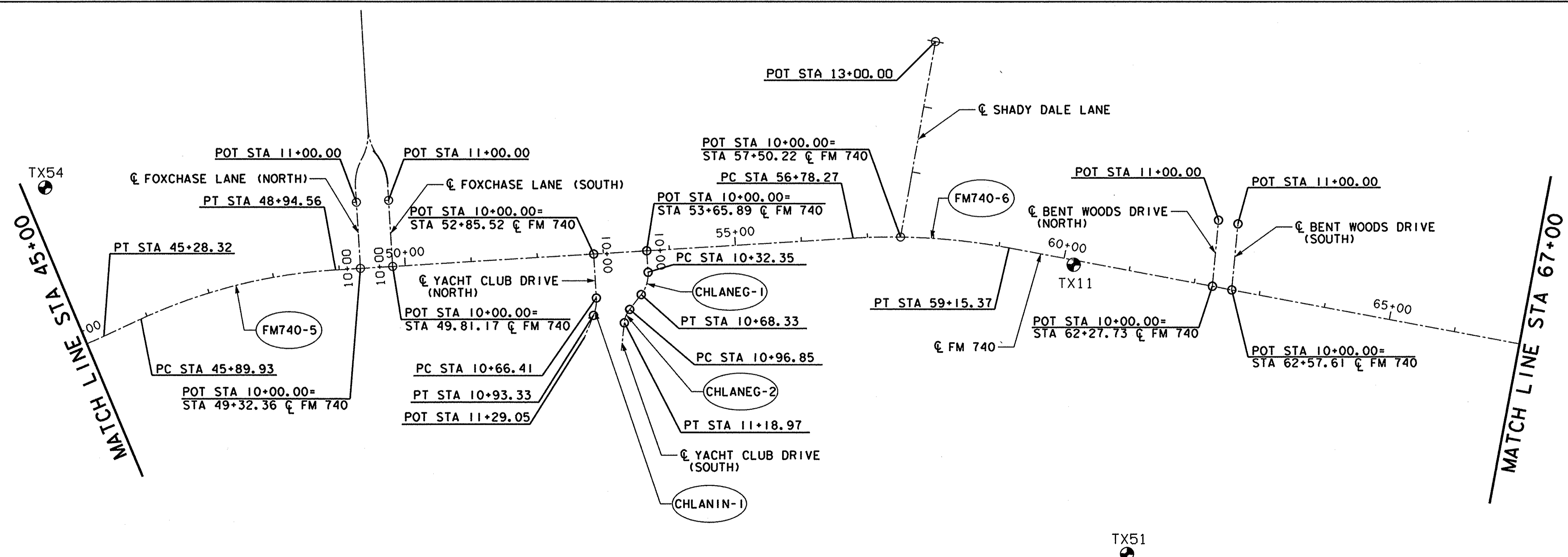

THE SEAL APPEARING ON THIS DOCUMENT WAS AUTHORIZED BY KENNETH A. ROBERTS, P.E. 55446 ON AUGUST 24, 2009

FIRM REGISTRATION NO. F-761

RECORD DRAWINGS AUGUST 13, 2010
 THIS RECORD DOCUMENT HAS BEEN PREPARED BASED ON INFORMATION PROVIDED BY OTHERS. THE CONSULTANT HAS NOT VERIFIED THE ACCURACY AND/OR COMPLETENESS OF THIS INFORMATION AND SHALL NOT BE RESPONSIBLE FOR ANY ERRORS OR OMISSIONS THAT MAY BE INCORPORATED AS A RESULT OF ERRONEOUS INFORMATION PROVIDED BY OTHERS.

FM 740

FM 740 HORIZONTAL ALIGNMENT AND CONTROL POINT DATA

HORIZON ROAD TO WELLINGTON LANE

HUITT-ZOLLARS Huitt-Zollars, Inc. Reg. No. F-761
 3131 McKinney Avenue, Suite 600
 Dallas, Texas 75204-2489
 Phone (214) 871-3311 Fax (214) 871-0757

CITY OF ROCKWALL, TEXAS

DESIGN	DRAWN	APPR.	SCALE	DATE	PROJECT NO.	NO.
HZI	HZI	KAR	1"=100'	AUGUST 2009	01-3713-01	4

NOTE:
 1. ALL BEARINGS ARE BASED ON THE TEXAS STATE PLANE COORDINATE SYSTEM, NORTH CENTRAL ZONE, NAD 83. ALL DISTANCES AND COORDINATES ARE ADJUSTED TO SURFACE USING THE TXDOT DALLAS COUNTY COMBINED SURFACE ADJUSTMENT FACTOR OF 1.000136506.

USER: THERESSA
 SCALE: SCALE=100.000000
 FILE: I:\BL\8781\FULL.LBL

I:\p\proj\101371301\dgn\371301\THC01.dgn
 8/13/2010
 10:58:37

I:\p\proj\101371301\dgn\371301\THC01.dgn
 8/13/2010
 10:58:37