

CITY OF ROCKWALL, TEXAS

CONSTRUCTION PLANS FOR: SECTION II

F.M. 552 WATER LINE IMPROVEMENTS

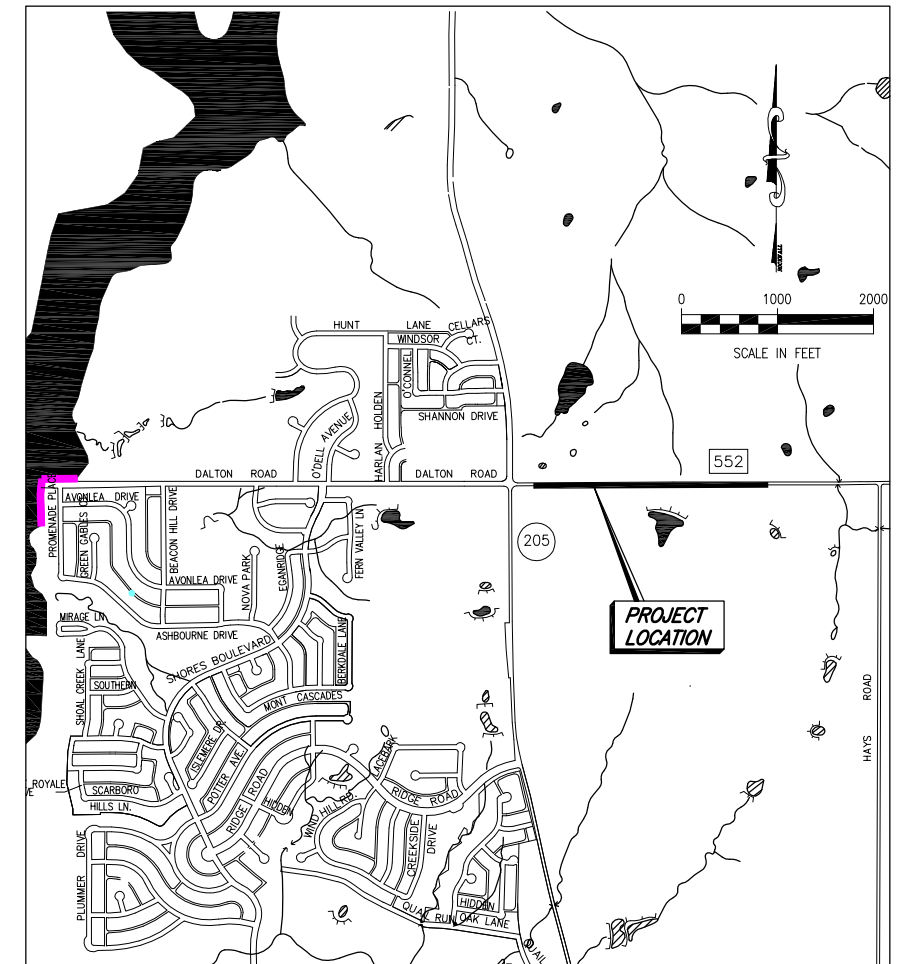

COUNCIL MEMBERS

BILL CECIL, MAYOR
MATT SCOTT, MAYOR PRO-TEM
TIM McCALLUM
STEPHEN STRAUGHAN
BOB COTTI
CLIFF SEVIER
MARGO NIELSEN

CITY MANAGER

JULIE COUCH

ASSISTANT CITY MANAGER

RICHARD CROWLEY

CITY ENGINEER

CHUCK TODD, P.E.

This record drawing is a compilation of the sealed engineering drawing for this project; modified by addenda, change orders and information furnished by the contractor. The information shown on the record drawings that was provided by the contractor or others not associated with the design engineer cannot be verified for accuracy or completeness. This original sealed drawings are on file at the offices of Birkhoff, Hendricks & Conway, L.L.P.

BY PAC DATE 08/22/07

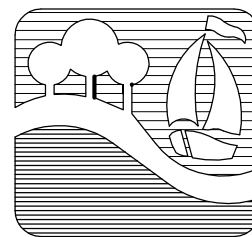

BIRKHOFF, HENDRICKS & CONWAY, L.L.P.
CONSULTING ENGINEERS
Dallas, Texas

JULY, 2006

LOCATION MAP

SHEET INDEX

SHEET NO.

SHEET DESCRIPTION

1	COVER SHEET AND LOCATION MAP
2	PLAN- PROFILE STA. 1+83.57 TO STA. 5+00
3	PLAN- PROFILE STA. 5+00 TO STA 10+00
4	PLAN- PROFILE STA. 10+00 TO STA 15+00
5	PLAN- PROFILE STA. 15+00 TO STA 20+00
6	PLAN- PROFILE STA. 20+00 TO STA 25+00
7	PLAN- PROFILE STA. 25+00 TO STA 26+61.83
8	DETAILS

THESE DOCUMENTS ARE FOR
BIDDING, CONSTRUCTION,
AND PERMIT PURPOSES.

DATE: _____

