

CALL BEFORE YOU DIG!
 TEXAS ONE CALL PARTICIPANTS REQUEST
 48 HOURS NOTICE BEFORE YOU DIG, DRILL,
 OR BLAST - STOP CALL

Texas One Call System
 1-800-DIG-TESS

UTILITY LOCATION NOTE:
 The location of existing utilities shown on these plans are approximate and based on existing plans and data furnished by utility companies. It is the responsibility of the contractor to verify the location and depth of all existing utilities that may conflict with construction. Call 1-800-344-8377 two working days prior to construction for on site locations. Any damage to existing utilities shall be repaired at contractor's expense, at no additional cost.

NOTE:
 1. SEE DRAINAGE PROFILE SHEETS FOR LINE "A"
 2. CONTRACTOR TO INSTALL CITY FURNISH INLET MARKERS "NO DUMPING" ON ALL INLETS

1. N 7026291.357 E 2594699.299 ELEV= 583.650 MON
2. N 7026304.738 E 2594701.100 ELEV= 583.119 CIRST

RECORD DRAWING
 THIS DRAWING IS A COMPILATION OF A COPY OF THE SEALED ENGINEERING DRAWING FOR THIS PROJECT, MODIFIED BY ADDENDA, CHANGE ORDERS AND INFORMATION FURNISHED BY THE CONTRACTOR. THE INFORMATION SHOWN ON THIS RECORD DRAWING THAT WAS PROVIDED BY THE CONTRACTOR OR OTHERS NOT ASSOCIATED WITH THE DESIGN ENGINEER CANNOT BE VERIFIED FOR ACCURACY OR COMPLETENESS. THE ORIGINAL SEALED DRAWINGS ARE ON FILE AT THE OFFICE OF E.J.E.S., INC., TPBE FIRM REGISTRATION NO. 2488

James Allen
 James Allen, P.E., TX License No. 65929 Date: JULY 26, 2019

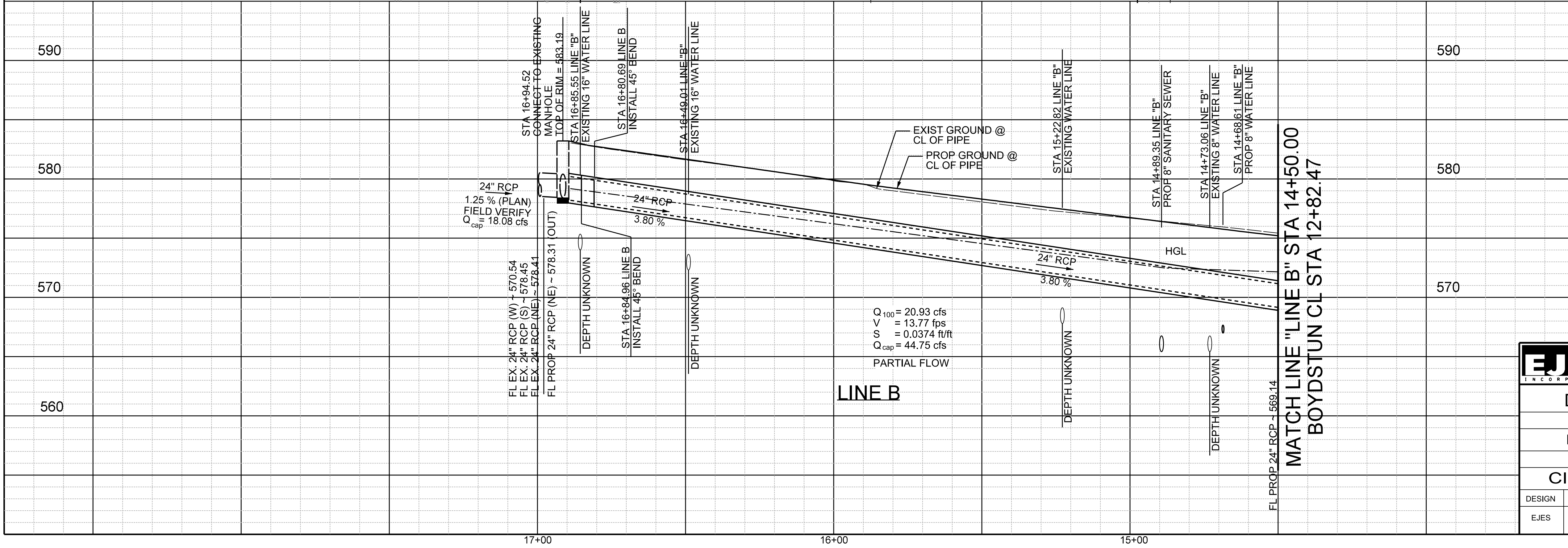
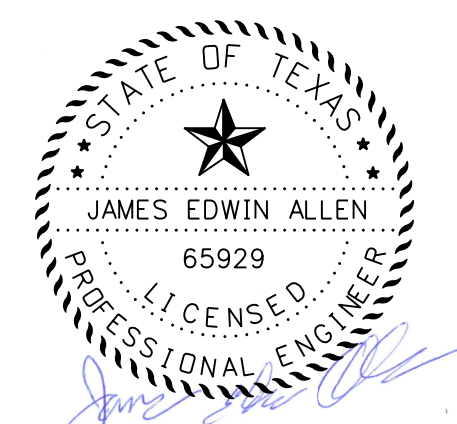

EJES
 INCORPORATED
 12655 N Central Expy, Suite # 500, Dallas, Texas 75243.
 Tel # 214-343-1210, Fax # 214-343-3885
 FIRM REGISTRATION No: F-2488

DRAINAGE PLAN & PROFILE
 E. BOYDSTUN AVE.
 FROM S. GOLIAD ST TO S. CLARK ST
 PUBLIC WORKS DEPARTMENT
 CITY OF ROCKWALL, TEXAS

DESIGN	DRAWN	DATE	SCALE	NOTES	FILE	SHEET NO.
EJES	EJES	MAY 2017	1"=20' H 1"=5' V			50