

Downtown Rockwall
 streetscape improvements
 PHASE 2
 rockwall, texas

STORM SEWER CURVE DATA

| C1 | C2 | C3 |
|-------------|-------------|-------------|
| Δ=45°29'10" | Δ=35°53'47" | Δ=34°35'41" |
| T=16.77' | T=12.96' | T=12.46' |
| L=31.76' | L=25.06' | L=24.15' |
| R=40.00' | R=40.00' | R=40.00' |

BENCH MARK LIST

| | |
|-------|--|
| BM# 1 | "+" SET IN BOX ON CURB INLET ON NORTHWEST CORNER OF ALAMO ST. AND GOLIAD ST. ELEV=574.54 |
| BM# 2 | "+" SET IN BOX ON BACK OF CURB ON SOUTH SIDE OF A CURB RETURN TO A PARKING LOT ON EAST SIDE OF FANNIN ST. ±7 FEET SOUTH OF OLIVE ST. ELEV=573.63 |
| BM# 3 | "+" SET IN BOX ON SOUTH WEST CORNER OF GOLIAD ST. AND KAUFMAN ST. ±40 FEET WEST OF ¼ OF GOLIAD ST. AND ±25 FEET SOUTH OF ¼ OF KAUFMAN ST. ELEV=587.41 |
| BM# 4 | "+" SET IN BOX ON NORTH EAST CORNER OF N. FANNIN ST. AND KAUFMAN ST. ±15 FEET NORTH OF ¼ OF KAUFMAN ST. AND ±30 FEET EAST FROM ¼ OF KAUFMAN ST. ELEV=578.80 |
| BM# 5 | "+" SET IN BOX ON NORTH WEST CORNER OF WASHINGTON ST. ON GOLIAD ST. ±40 FEET WEST OF ¼ OF GOLIAD ST. AND ±25 FEET NORTH OF ¼ OF WASHINGTON ST. ELEV=595.39 |
| BM# 6 | "+" SET IN BOX SOUTH EAST CORNER OF WASHINGTON ST. AND FANNIN ST. ±22 FEET OF ¼ OF FANNIN ST. AND ±45 FEET SOUTH OF ¼ OF WASHINGTON ST. ELEV=580.69 |

sheet location KEY MAP

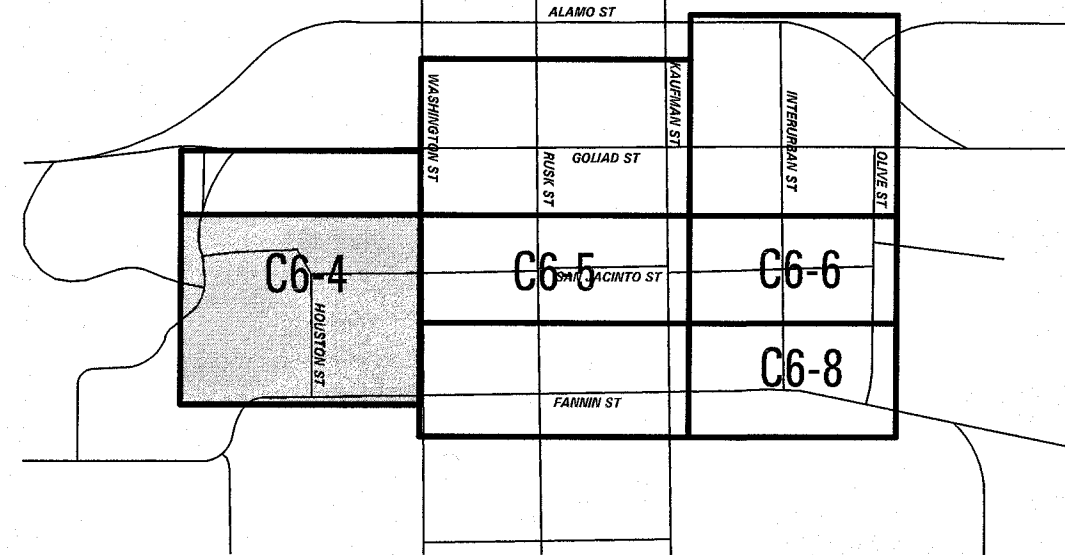

LEGEND

| | | | |
|------|--------------------------|--------|---------------------------------|
| B. | BOLLARD | FL. | FLOOD LIGHT |
| EM | ELECTRIC METER | FP | FLAG POLE |
| PP | POWER POLE | TS | TRAFFIC SIGN |
| LS | LIGHT STANDARD | W | 1/2-INCH IRON ROD |
| WM | WATER METER | W/P | W/PACHECO KOCH CAP SET |
| WV | WATER VALVE | (C.M.) | CONTROLLING MONUMENT |
| ICV | IRRIGATION CONTROL VALVE | --- | PROPERTY LINE |
| FH | FIRE HYDRANT | X | FENCE |
| CL | CLEANOUT | OH | OVERHEAD UTILITY LINE |
| MH | MANHOLE | E | UNDERGROUND ELECTRIC LINE |
| TSC | TRAFFIC SIGNAL CONTROL | T | UNDERGROUND TELEPHONE LINE |
| TSP | TRAFFIC SIGNAL POLE | C | UNDERGROUND CABLE LINE |
| TELE | TELEPHONE BOX | 6"W | UNDERGROUND WATER LINE |
| | | 6"SS | UNDERGROUND SANITARY SEWER LINE |

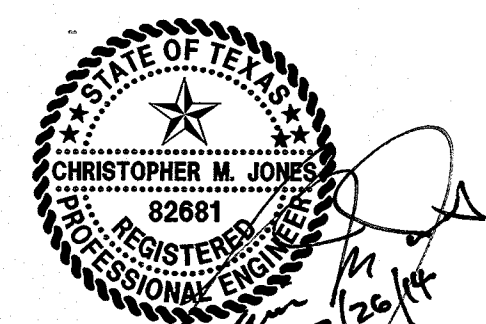
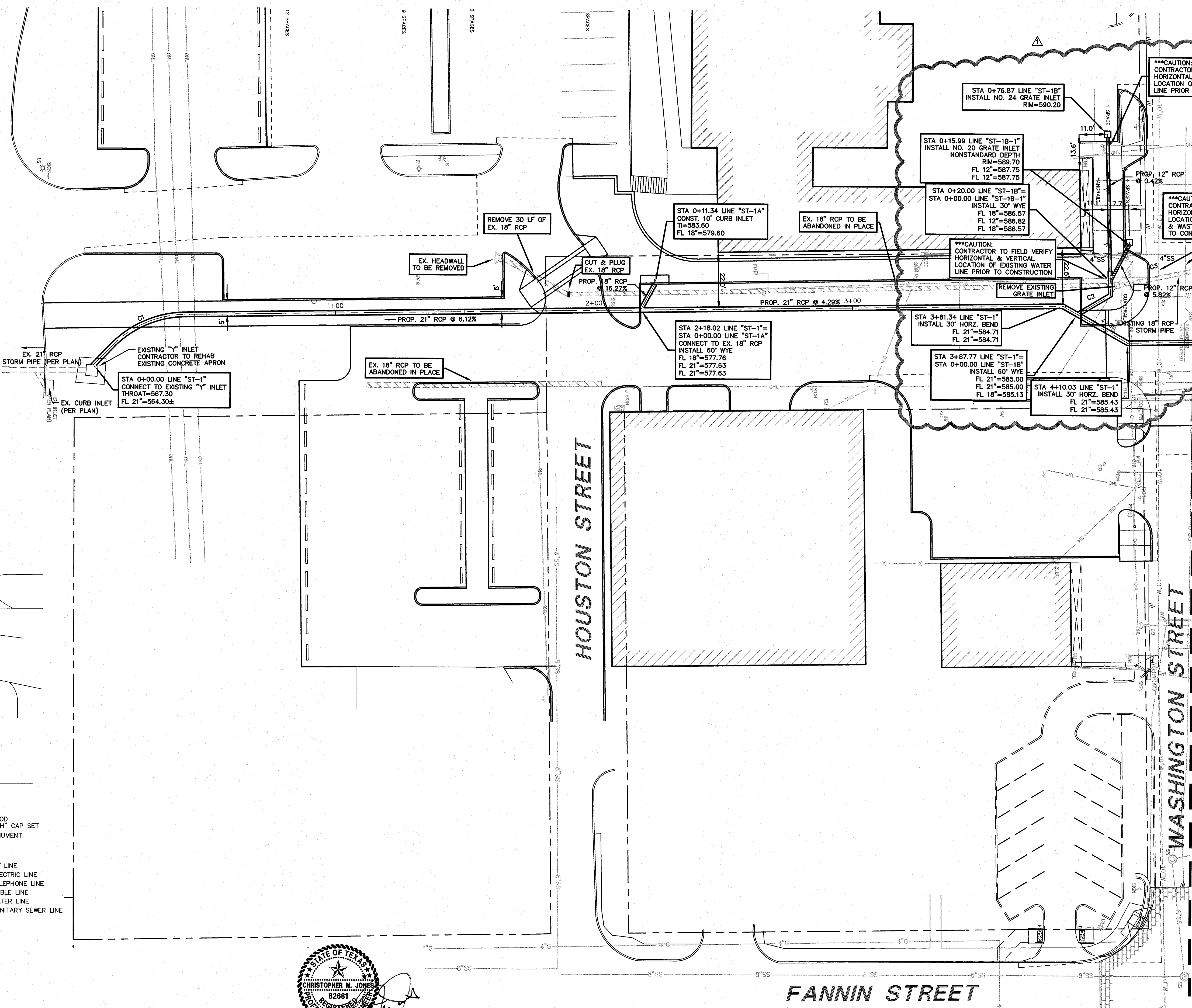

THE SEAL APPEARING ON THIS DOCUMENT WAS AUTHORIZED BY CHRISTOPHER M. JONES, P.E. 82681 ON 02/26/2014. ALTERATION OF A SEALED DOCUMENT WITHOUT PROPER NOTIFICATION TO THE RESPONSIBLE ENGINEER IS AN OFFENSE UNDER THE TEXAS ENGINEERING PRACTICE ACT.

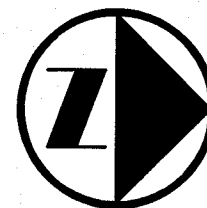
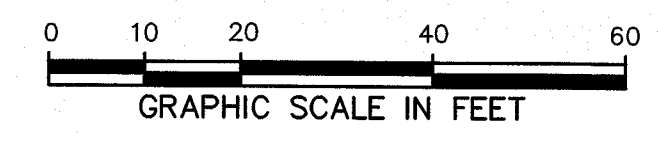

submittals / revisions

| no. | date | detail |
|-----|---------|---------------|
| 1 | 4/10/14 | RFI'S 24 & 65 |

la terra studio, inc.

12024
 Its project number
 02.26.2014
 date
 JHB
 drawn by
 CMJ
 checked by

registration

sheet title
STORM DRAINAGE PLAN
 sheet number
C6-4