

MATCH LINE - SHEET C3-3 STA. 4+07.54

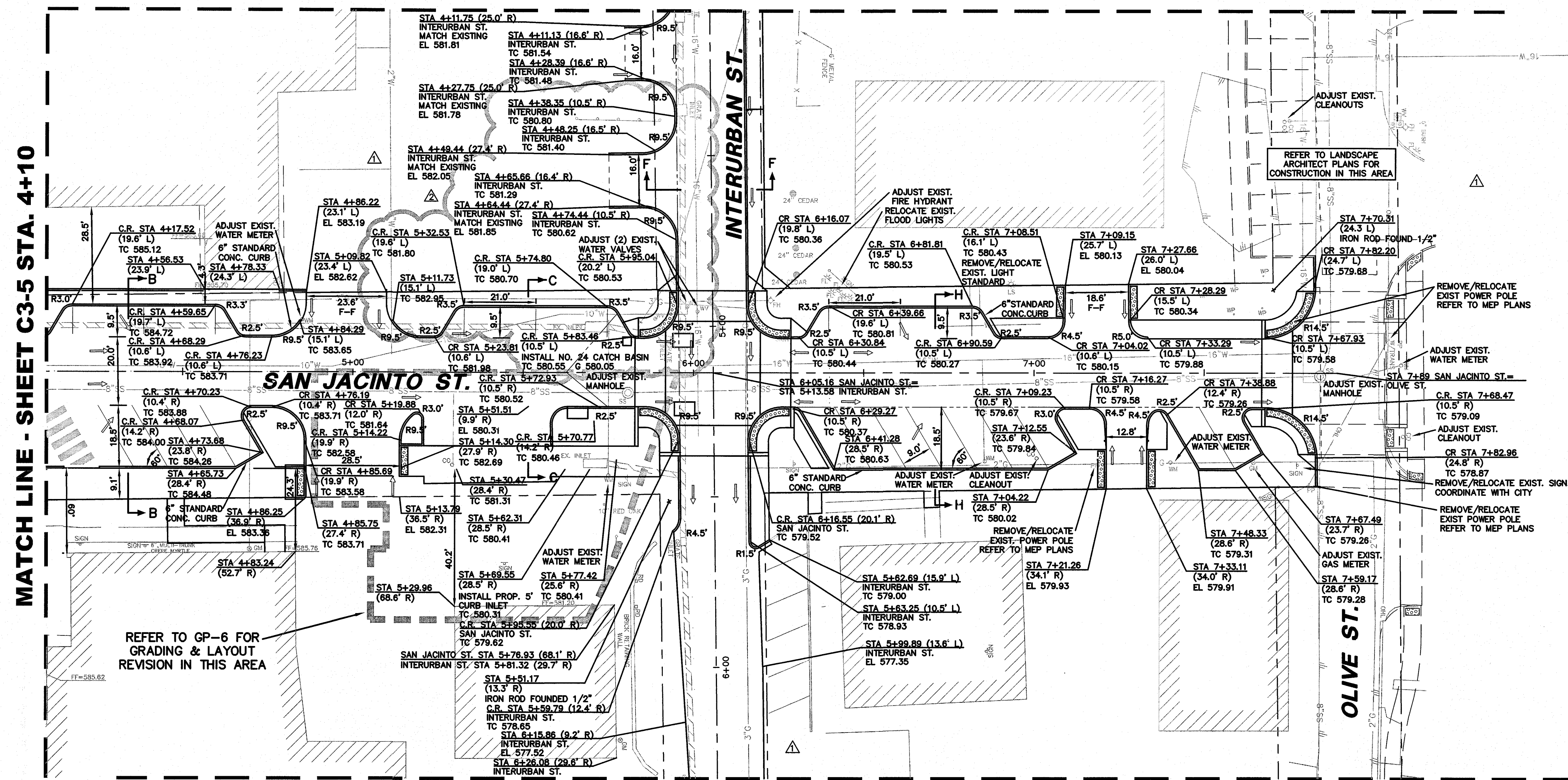

MATCH LINE - SHEET C3-8 STA. 6+32.54

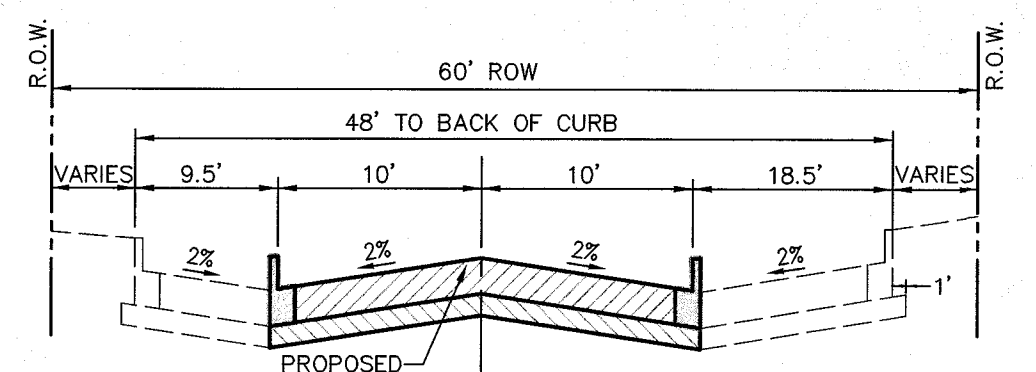
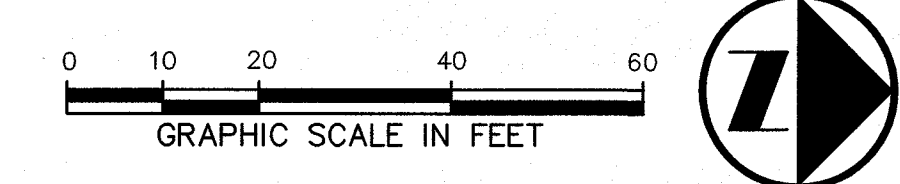

TYPICAL SECTION "B"
SAN. JACINTO STREET
STA. 3+80 - STA. 5+20

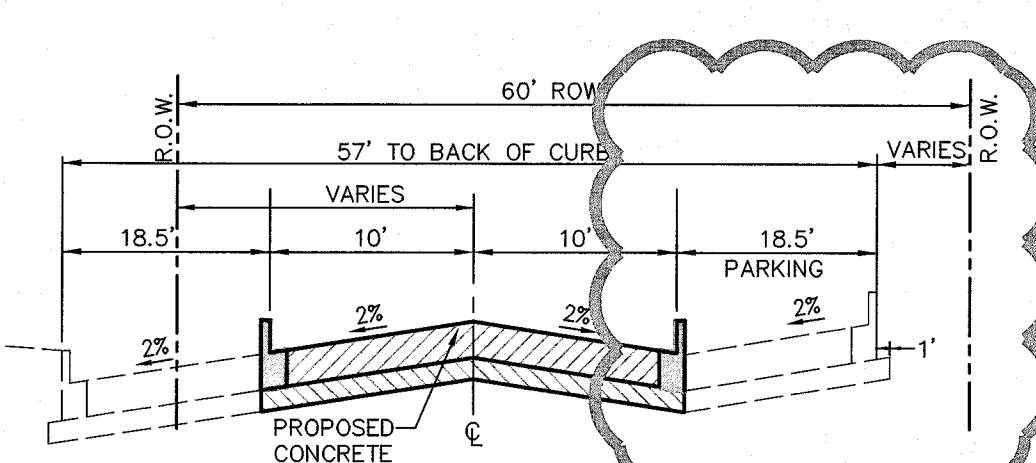

TYPICAL SECTION "C"
SAN. JACINTO STREET
STA. 5+20 - STA. 5+75

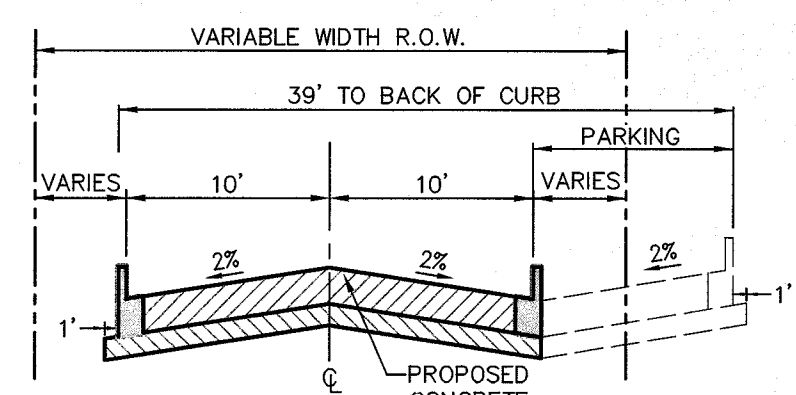

TYPICAL SECTION "F"
INTERURBAN STREET
STA. 3+14 - STA. 5+64

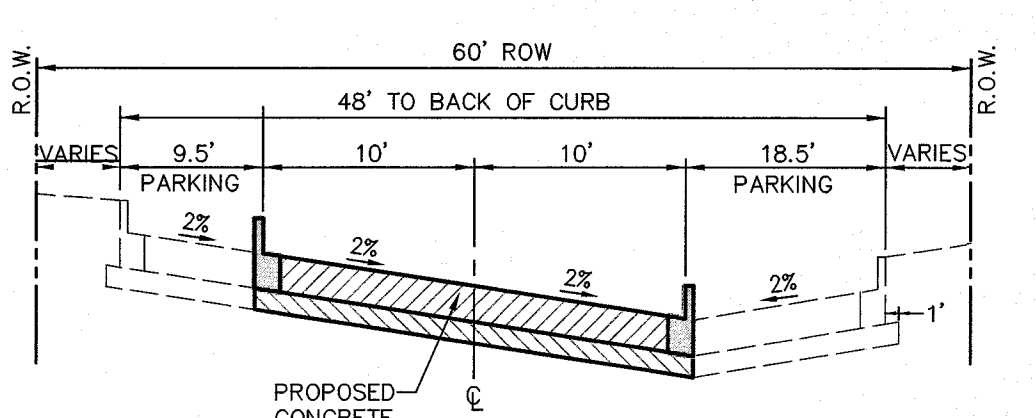

TYPICAL SECTION "H"
SAN. JACINTO STREET
STA. 6+30 - STA. 7+68

LEGEND

B.	BOLLARD	TSP.	TRAFFIC SIGNAL POLE
EM	ELECTRIC METER	TEL	TELEPHONE BOX
PP.	POWER POLE	FL	FLOOD LIGHT
LS.	LIGHT STANDARD	FP.	FLAG POLE
WM.	WATER METER	SIGL.	TRAFFIC SIGN
WV.	WATER VALVE	IRS	1/2-INCH IRON ROD
ICV.	IRRIGATION CONTROL VALVE	(C.M.)	W/PACHECO KOCH" CAP SET
FH.	FIRE HYDRANT	---	CONTROLLING MONUMENT
CL.	CLEANOUT	---	PROPERTY LINE
MH.	MANHOLE	---	FENCE
TSC.	TRAFFIC SIGNAL CONTROL	---	OVERHEAD UTILITY LINE
		---	PROPOSED FENCE

BENCH MARK LIST

BM# 1	"+" SET IN BOX ON CURB INLET ON NORTHWEST CORNER OF ALAMO ST. AND GOULD ST.	ELEV=574.54
BM# 2	"+" SET IN BOX ON BACK OF CURB ON SOUTH SIDE OF A CURB RETURN TO A PARKING LOT ON EAST SIDE OF FANNIN ST. ±7 FEET SOUTH OF ½ OF OLIVE ST.	ELEV=573.63
BM# 3	"+" SET IN BOX ON SOUTH WEST CORNER OF GOULIAS ST. AND KAUFMAN ST. ±40 FEET WEST OF ½ OF GOULD ST. AND ±25 FEET SOUTH OF ½ OF KAUFMAN	ELEV=587.41
BM# 4	"+" SET IN BOX ON NORTH EAST CORNER OF N. FANNIN ST. AND KAUFMAN ST. ±15 FEET NORTH OF ½ OF KAUFMAN ST. AND ±30 FEET EAST FROM ½ OF KAUFMAN ST.	ELEV=578.80
BM# 5	"+" SET IN BOX ON NORTH WEST CORNER OF WASHINGTON ST. ON GOULD ST. ±40 FEET WEST OF ½ OF GOULD ST. AND ±25 FEET NORTH OF ½ OF WASHINGTON ST.	ELEV=595.39
BM# 6	"+" SET IN BOX SOUTH EAST CORNER OF WASHINGTON ST. AND FANNIN ST ±22 FEET OF ½ OF FANNIN ST. AND ±45 FEET SOUTH OF ½ OF WASHINGTON ST.	ELEV=580.69

NOTES:

- CONTRACTOR SHALL ADJUST ALL EXISTING VALVES, METERS, CLEANOUTS AND MANHOLES TO PROPOSED GRADE UNLESS OTHERWISE NOTED WITHIN THE CONSTRUCTION AREA. FOR ADJUSTMENT/REMOVAL OF STORM SEWER APPURTENANCES SEE SHEETS C6-4, C6-5, C6-6 AND C6-9.
- CONTRACTOR SHALL REMOVE OR RELOCATE ALL EXISTING MAIL BOXES, LIGHT STANDARDS (REFER TO MEP PLANS), UTILITY "WARNING" SIGNS AND TRAFFIC SIGNS WITHIN THE CONSTRUCTION AREA. CONTRACTOR SHALL ALSO COORDINATE THESE ITEMS WITH THE APPROPRIATE OWNER AND/OR PUBLIC ENTITY. CONTRACTOR SHALL COORDINATE THE REMOVAL OR RELOCATION OF POWER POLES WITH ONCOR AND THE ELECTRICAL ENGINEER.

NOTE: CONTRACTOR TO MATCH EXISTING PAVEMENT AT ALL SAWCUT LINES

ALL DIMENSIONS ARE TO BACK-OF-CURB UNLESS OTHERWISE NOTED.

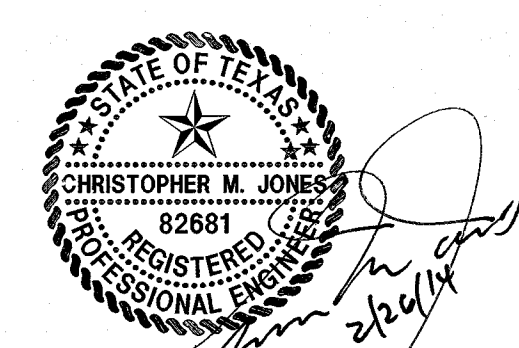

THE SEAL APPEARING ON THIS DOCUMENT WAS AUTHORIZED BY CHRISTOPHER M. JONES, P.E. 82681 ON 02/26/2014. ALTERATION OF A SEALED DOCUMENT WITHOUT PROPER NOTIFICATION TO THE RESPONSIBLE ENGINEER IS AN OFFENSE UNDER THE TEXAS ENGINEERING PRACTICE ACT.

sheet location
KEY MAP

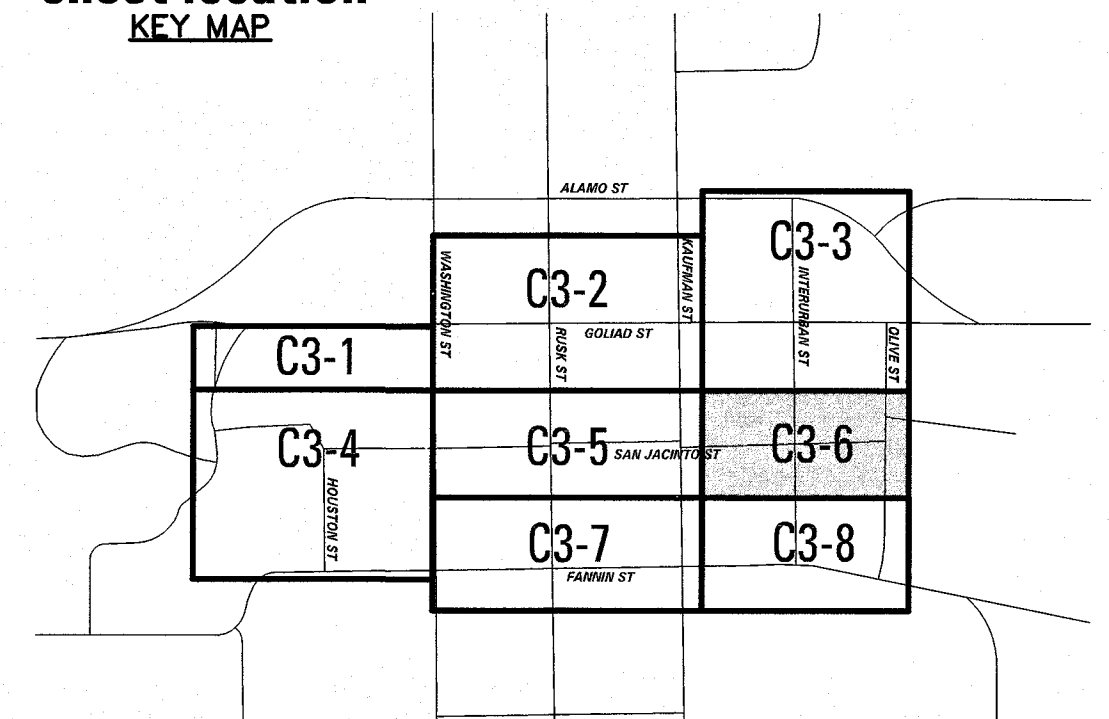

submittals / revisions

no.	date	detail
1	7/11/14	LASI #7
2	6/3/15	RFI's 178 & 180

la terra studio, inc.
 12024
 Its project number
 02.26.2014
 date
 JHB
 drawn by
 CMJ
 checked by
 registration

sheet title
ROAD PLAN
 sheet number
C3-6