



submittals / revisions

no.	date	detail
▲	06/17/14	RFI #97
▲	09/30/14	RFI #123
▲	02/26/15	RFI #163

la terra studio, inc.

12024
its project number
02.26.2014
date
rac; bhm
drawn by
mtb
checked by

registration



sheet title

Site Details
sheet number

SD-3

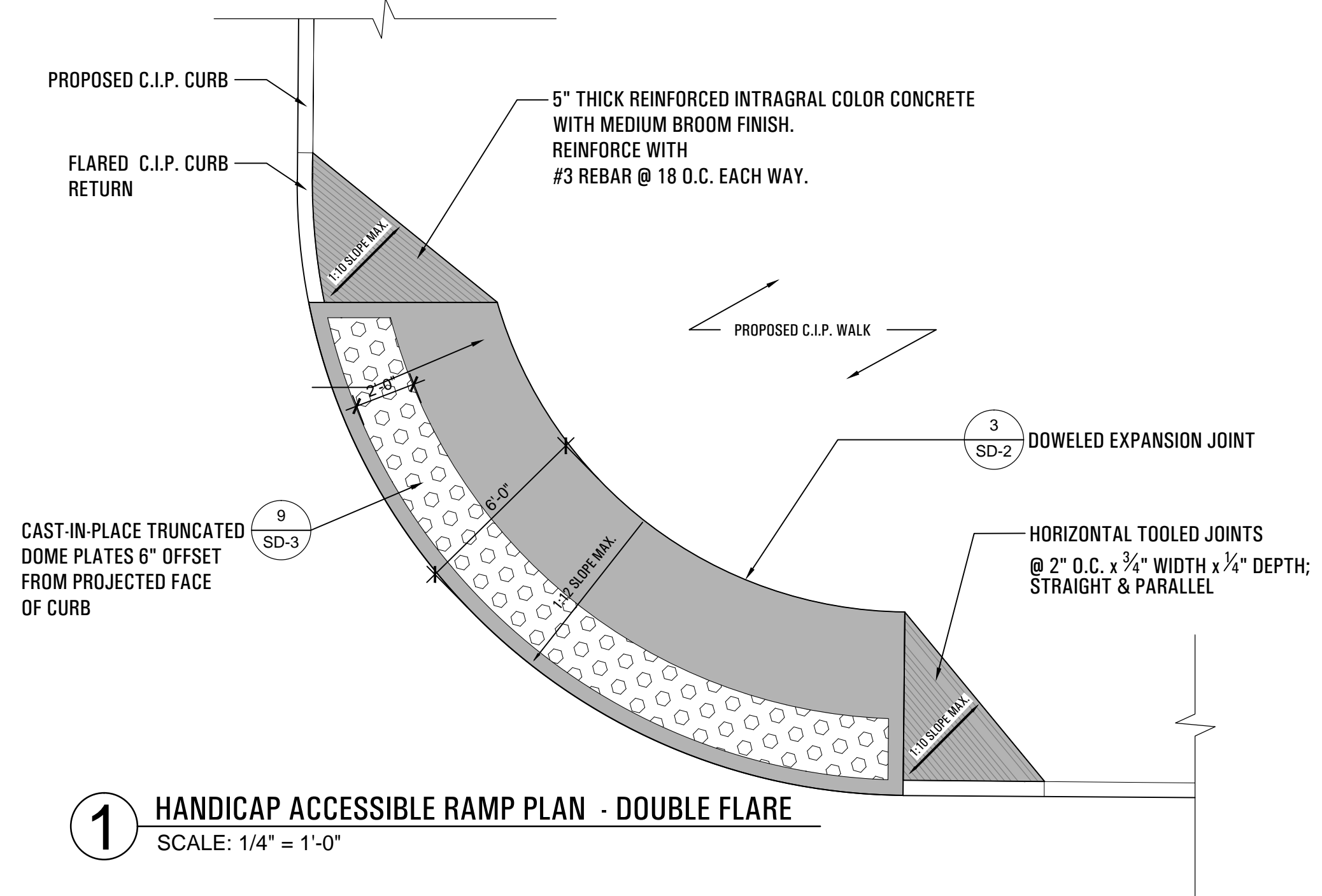

1 HANDICAP ACCESSIBLE RAMP PLAN - DOUBLE FLARE
SCALE: 1/4" = 1'-0"

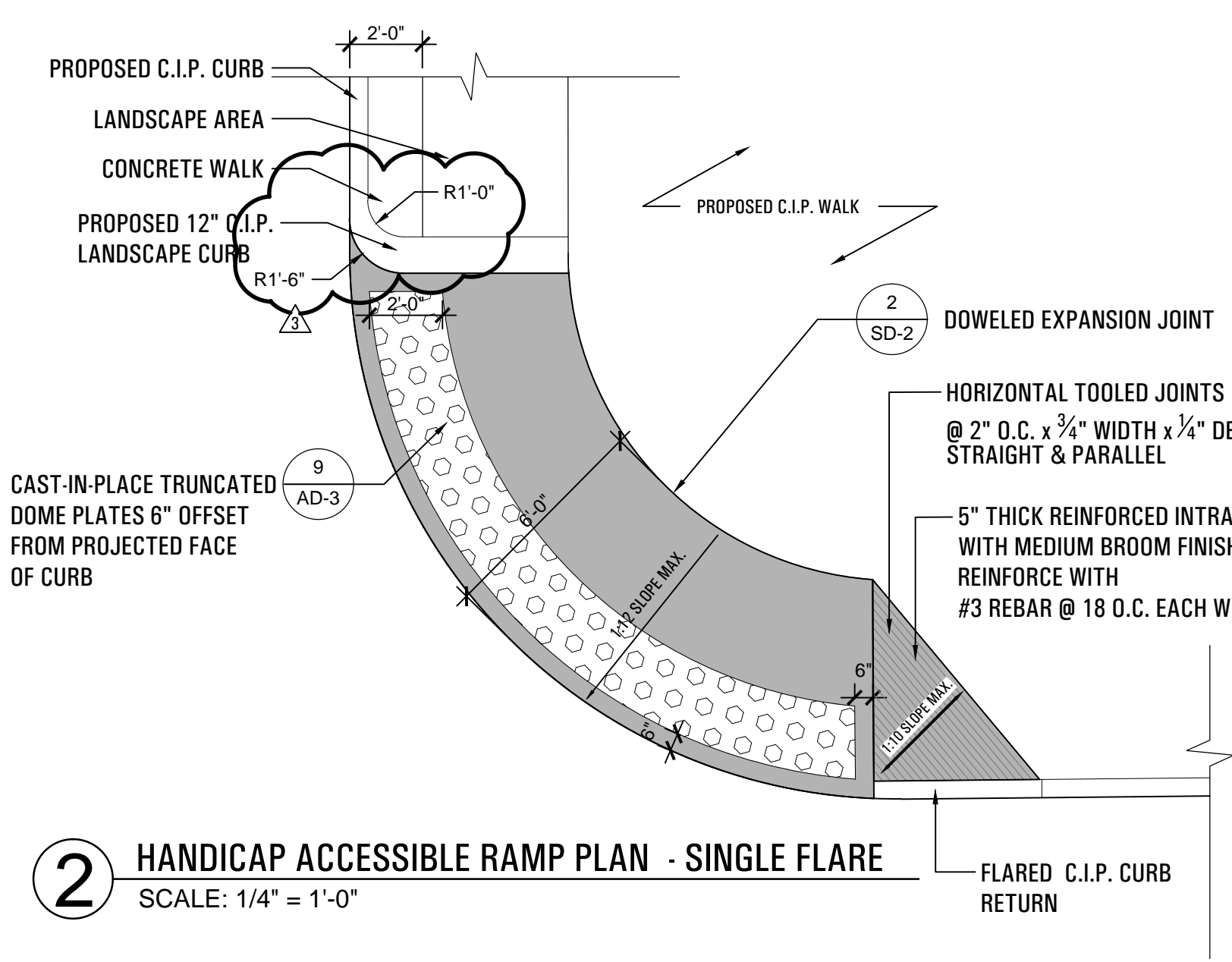

2 HANDICAP ACCESSIBLE RAMP PLAN - SINGLE FLARE
SCALE: 1/4" = 1'-0"

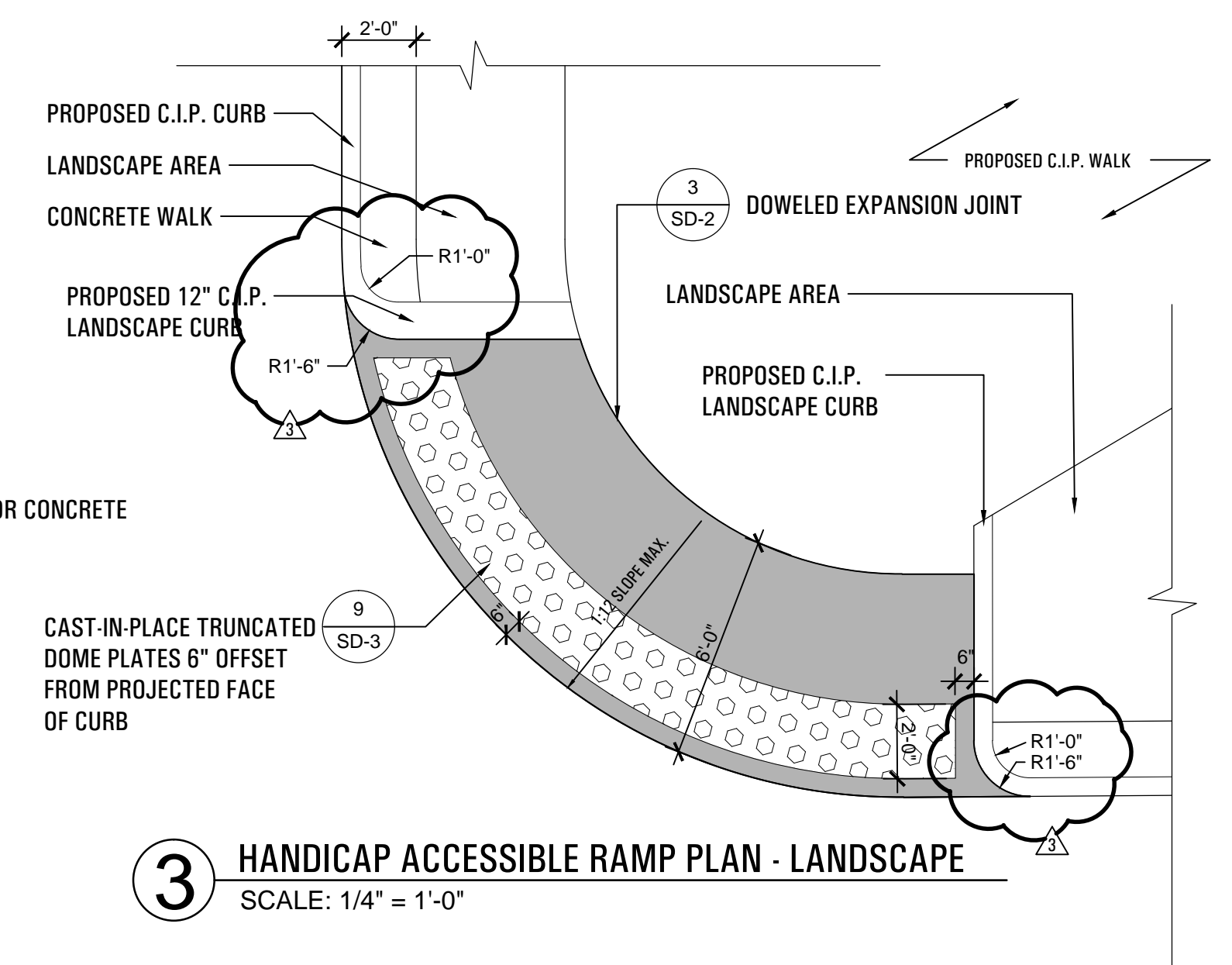

3 HANDICAP ACCESSIBLE RAMP PLAN - LANDSCAPE
SCALE: 1/4" = 1'-0"

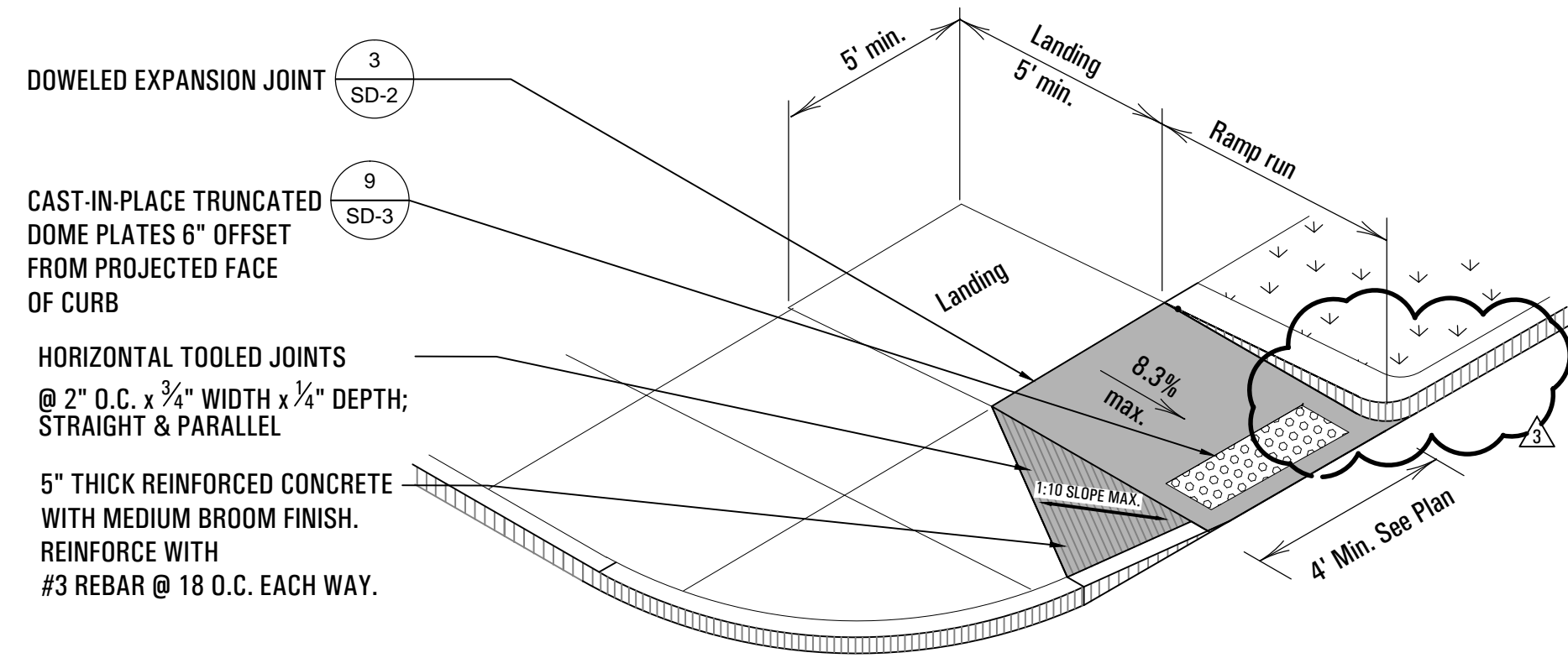

4 PERPENDICULAR CURB RAMP
SCALE: 1/4" = 1'-0"

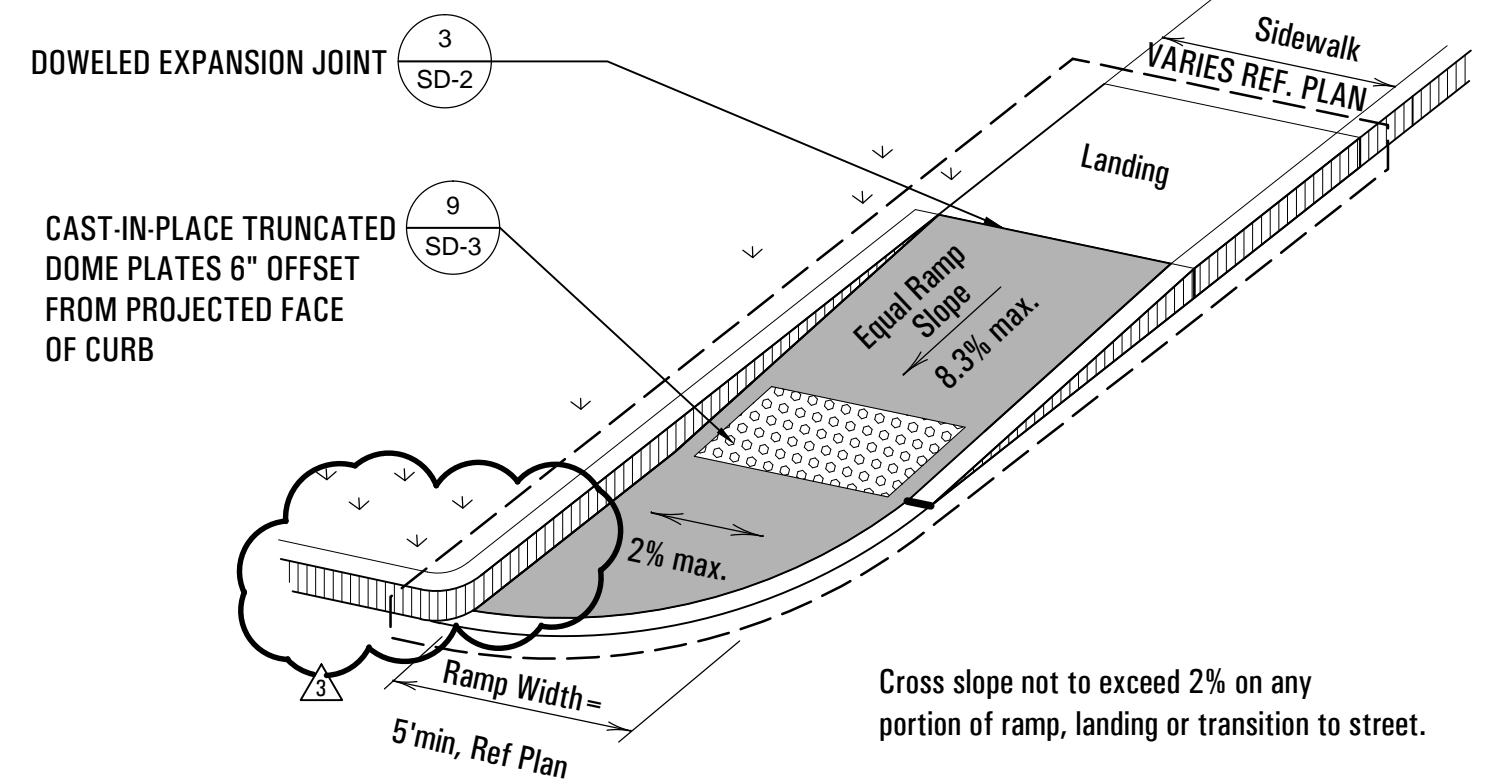

5 DIRECTION RAMP WITHIN RADIUS (Sidewalk adjacent to curb)
SCALE: 1/4" = 1'-0"

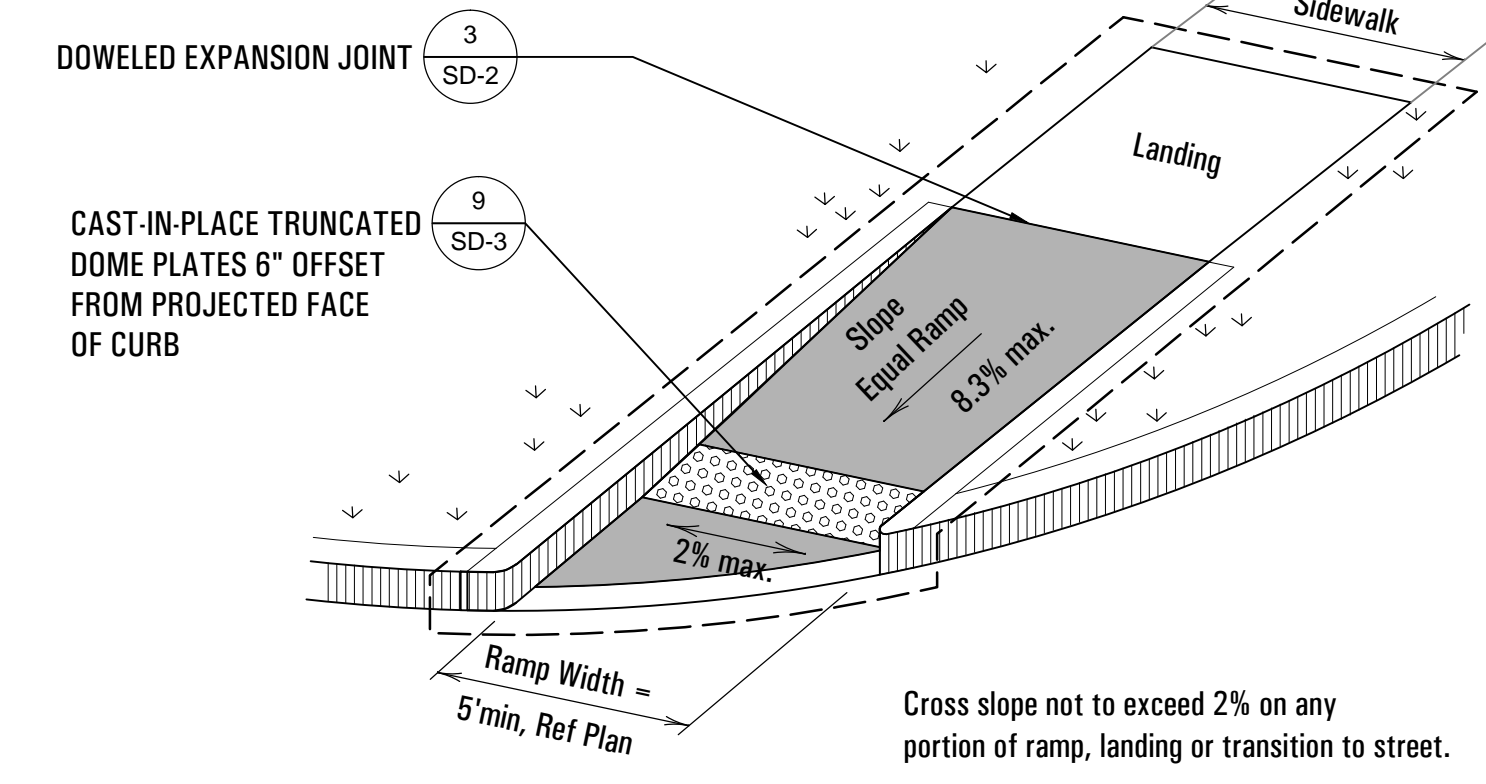

6 DIRECTION RAMP WITHIN RADIUS (Sidewalk set back from curb)
SCALE: 1/4" = 1'-0"

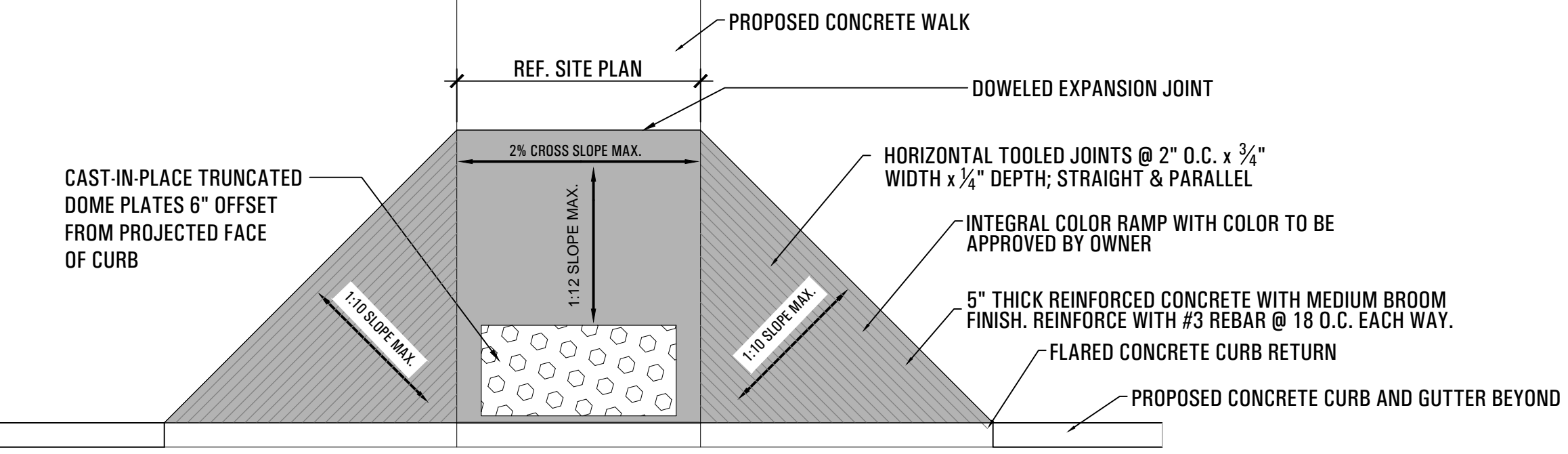

7 FLARED RAMP PLAN
SCALE: 3/8" = 1'-0"

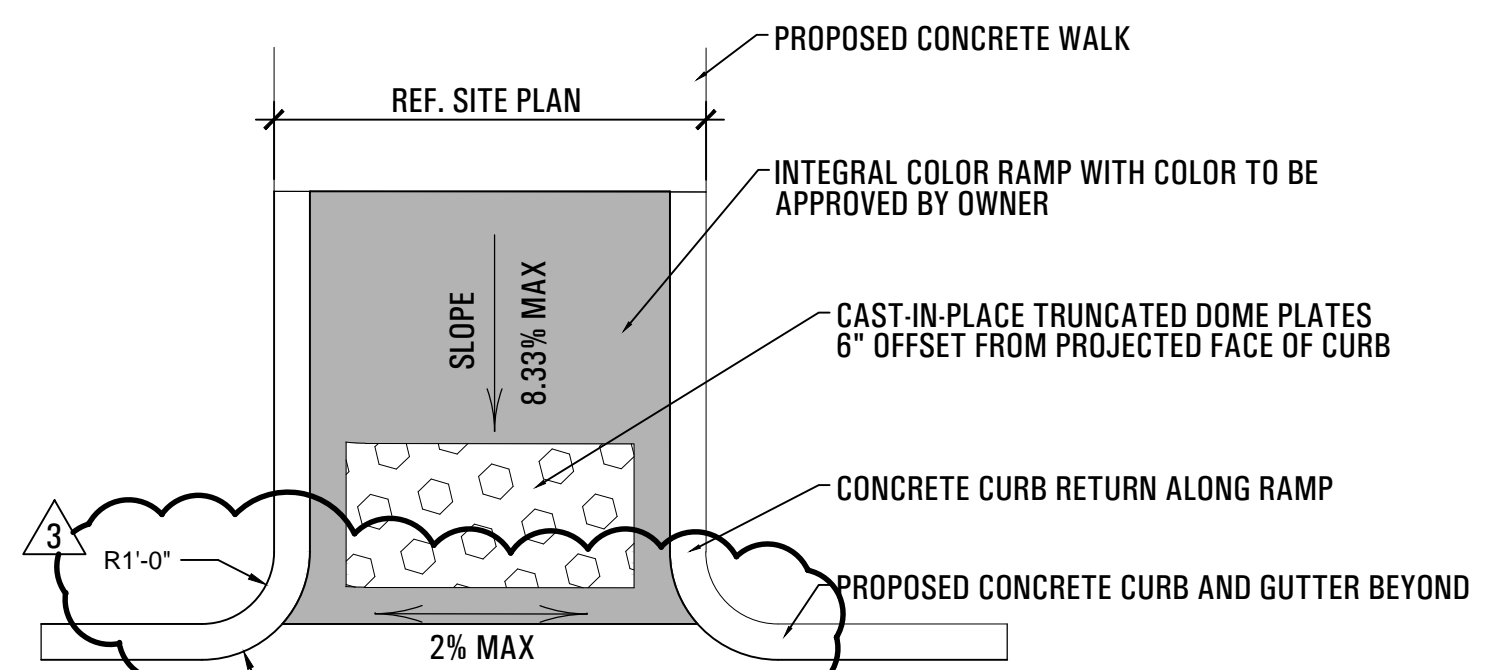

8 PERPENDICULAR DIRECTIONAL RAMP PLAN
SCALE: 3/8" = 1'-0"

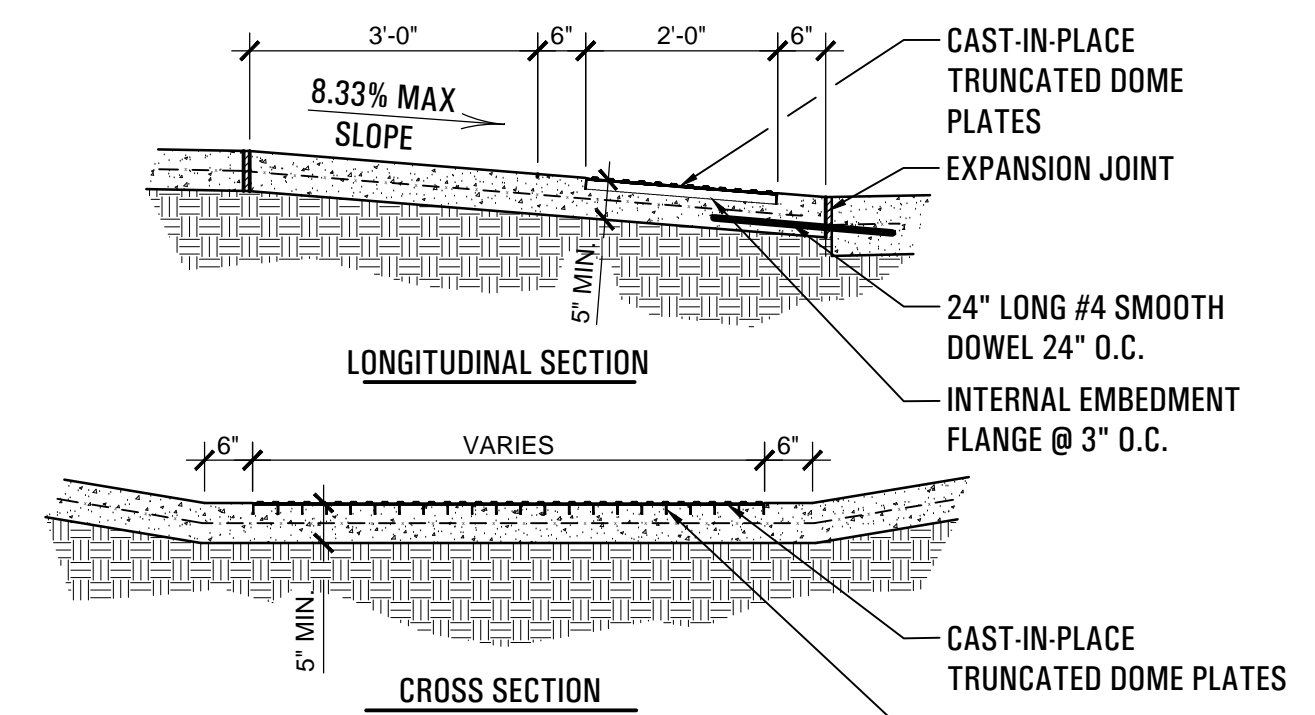

9 CAST-IN-PLACE TRUNCATED DOME PLATES
SCALE: 1/2" = 1'-0"

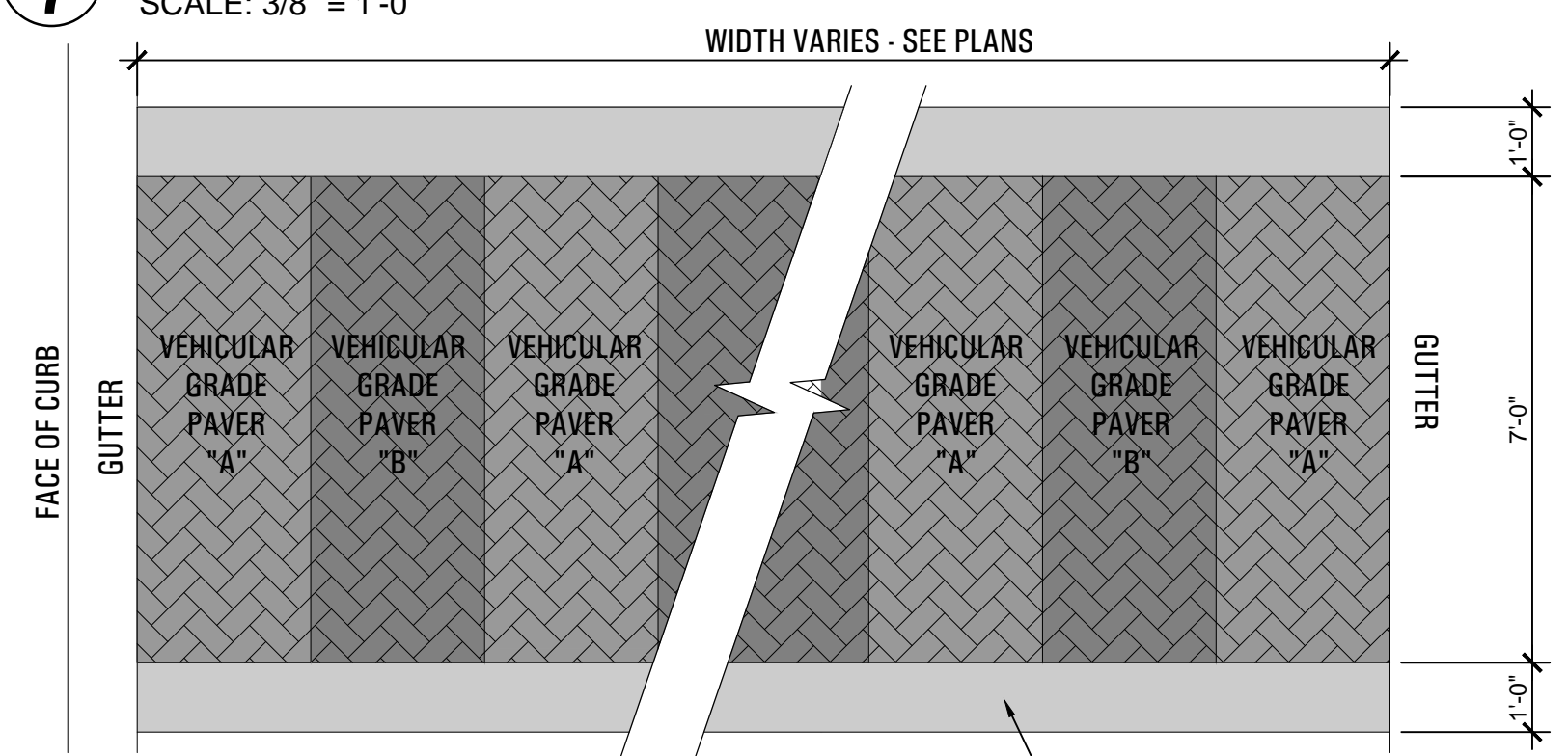

10 PEDESTRIAN CROSSWALK
SCALE: 3/8" = 1'-0"

NOTE:
VEHICULAR GRADE PAVERS TO BE MANUFACTURED BY PACIFIC CLAY PRODUCTS
PAVER "A" TO BE RED FLASH BEAR PATH HEAVY VEHICULAR PAVER
PAVER "B" TO BE DARK IRON SPOT BEAR PATH HEAVY VEHICULAR PAVER

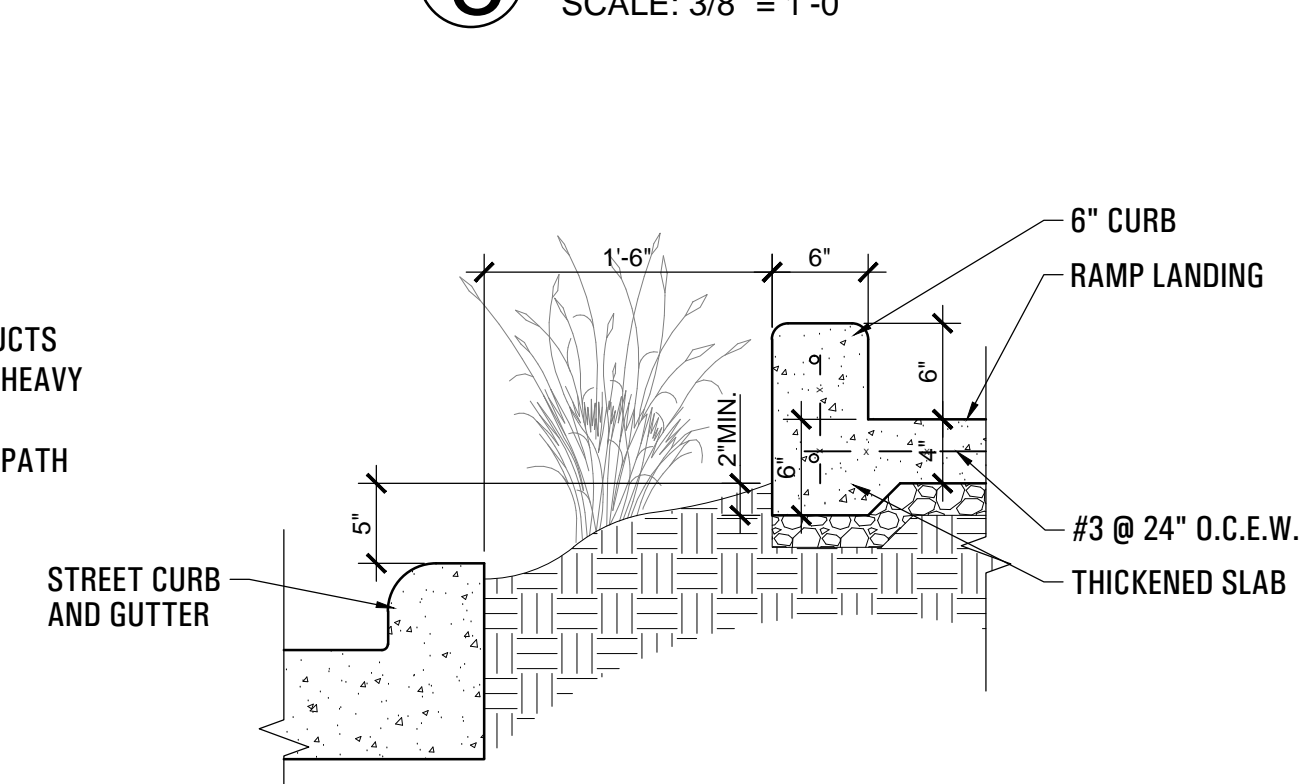

11 FANNIN ST. CURB TRANSITION
SCALE: 1" = 1'-0"

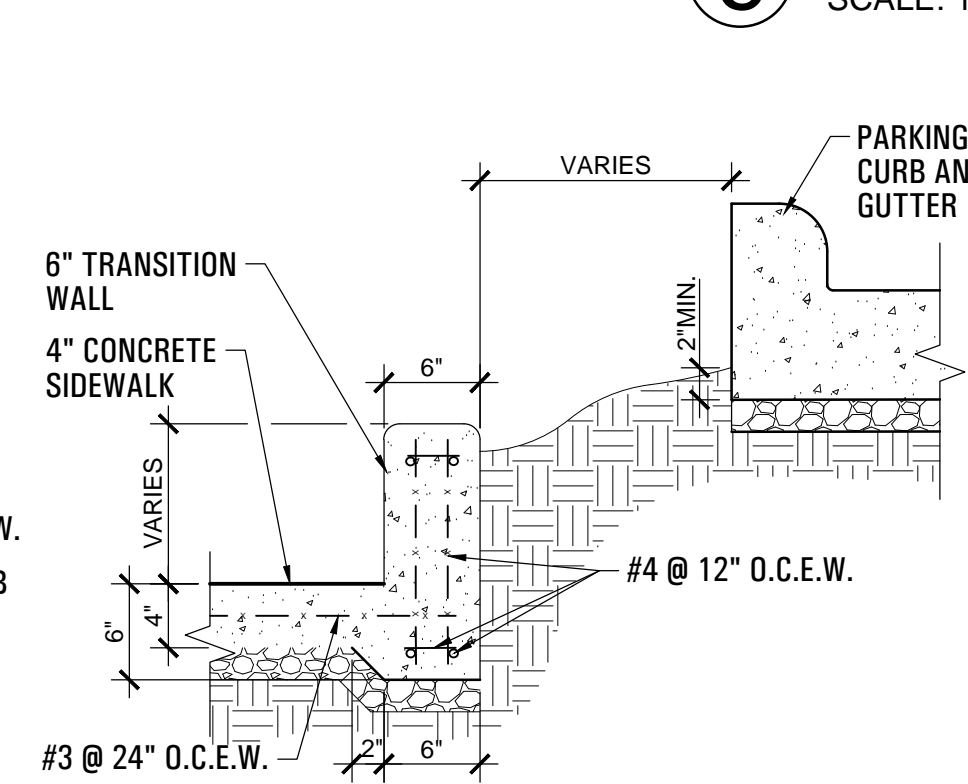

12 FANNIN ST. TRANSITION WALL
SCALE: 1" = 1'-0"

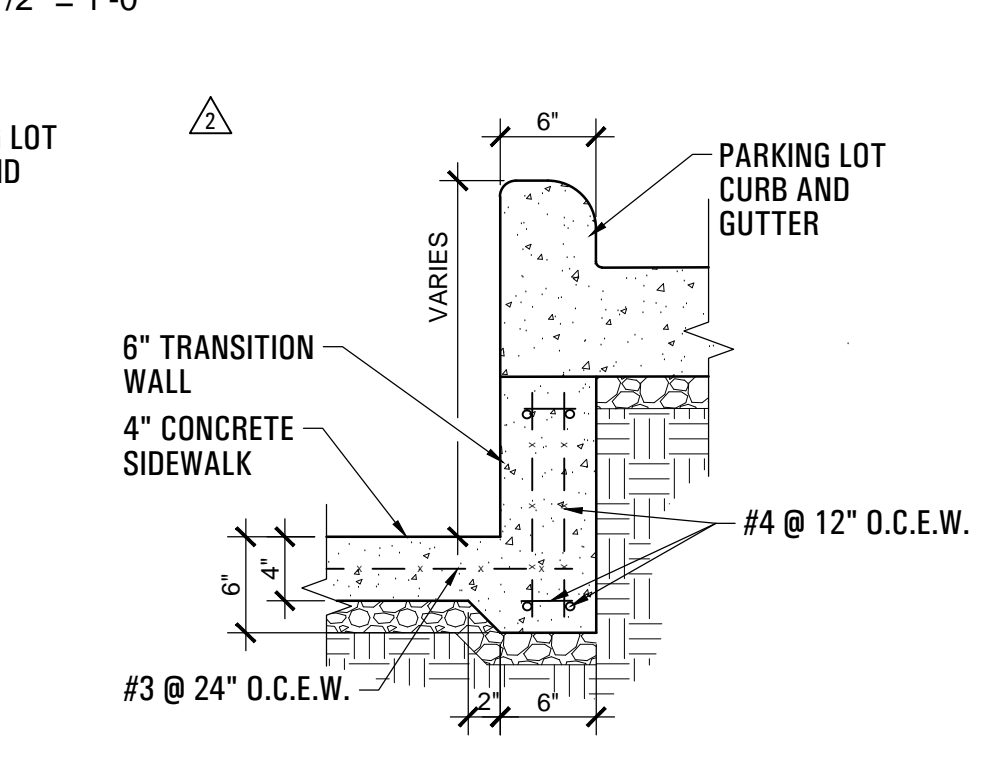

13 WASHINGTON ST. TRANSITION WALL
SCALE: 1" = 1'-0"