



submittals / revisions  
 no. date detail  
 7/11/14 LAST #7

la terra studio, inc.  
 12024  
 Its project number  
 02.26.2014  
 date  
 JHB  
 drawn by  
 CMJ  
 checked by  
 registration

sheet title  
**ROAD PLAN**  
 sheet number  
**C3-6**

**MATCH LINE - SHEET C3-3 STA. 4+07.54**

**MATCH LINE - SHEET C3-8 STA. 6+32.54**

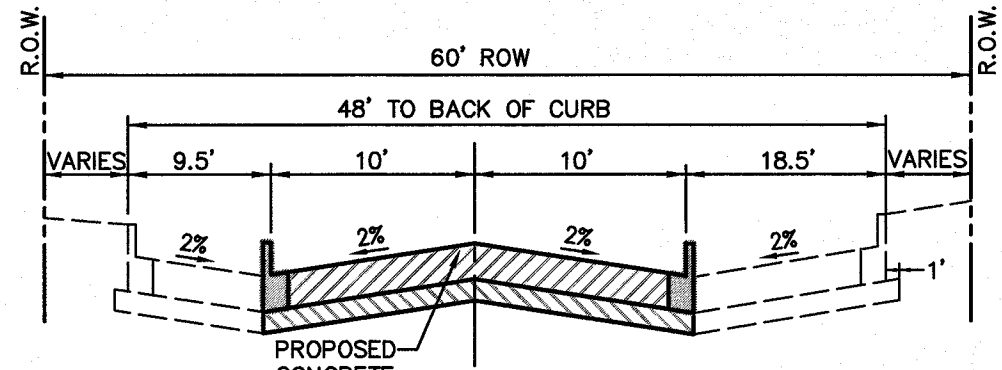
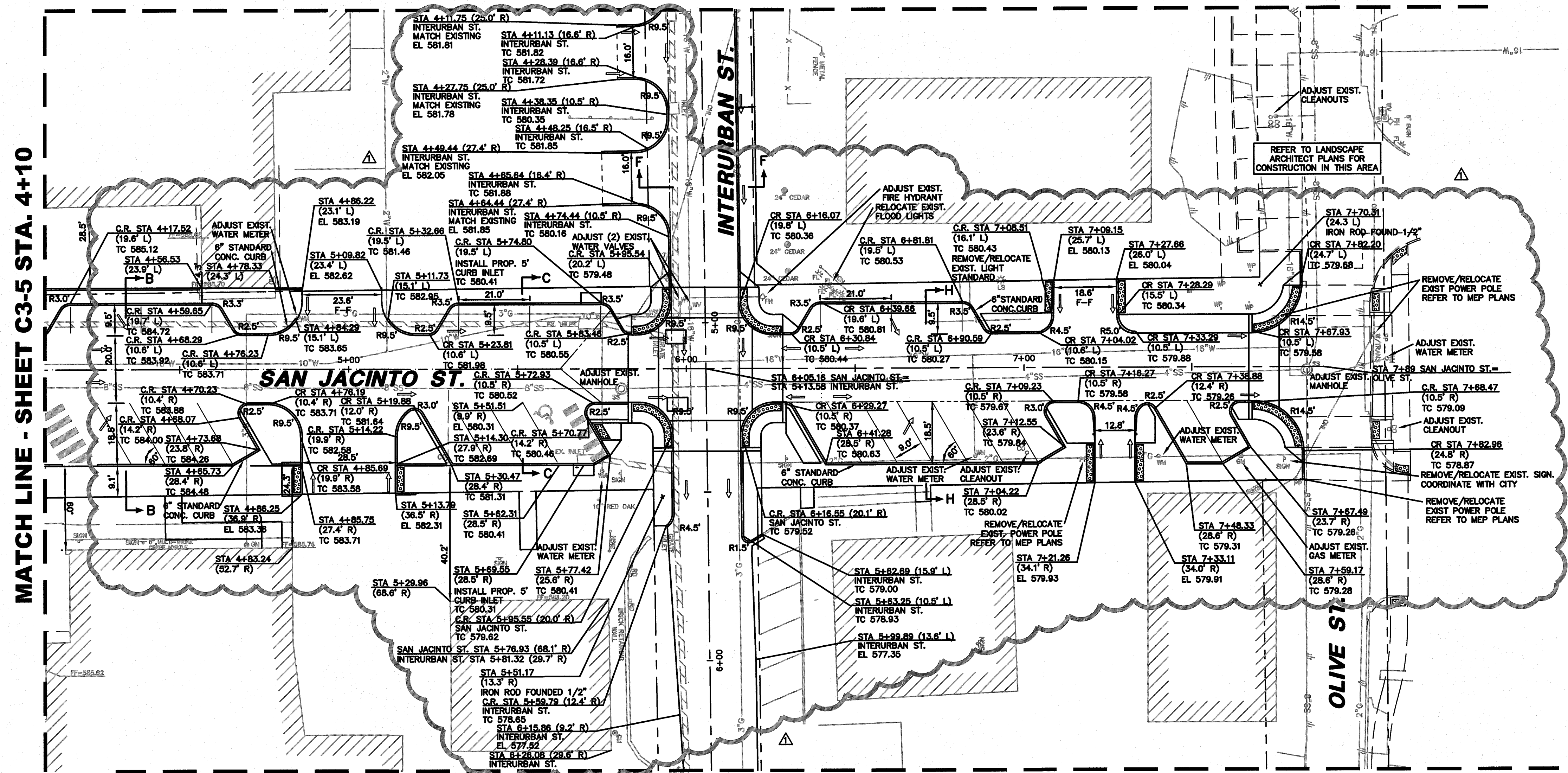

**TYPICAL SECTION "B"**  
**SAN JACINTO STREET**  
**STA. 3+80 - STA. 5+20**

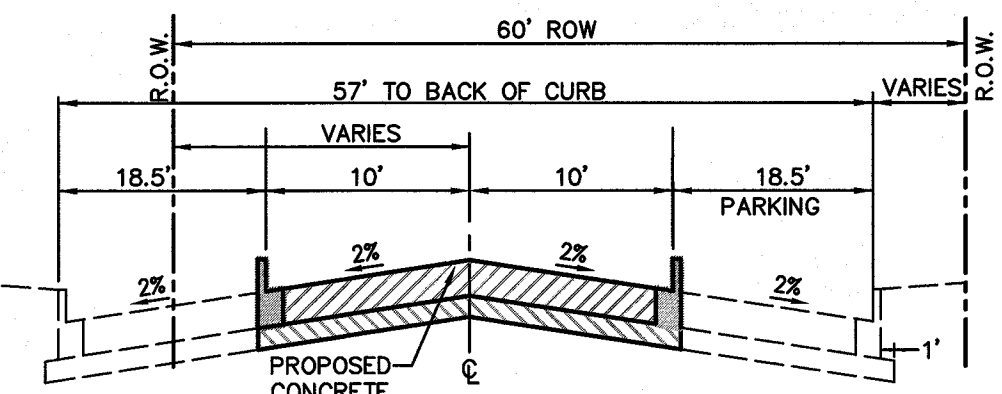

**TYPICAL SECTION "C"**  
**SAN JACINTO STREET**  
**STA. 5+20 - STA. 5+75**

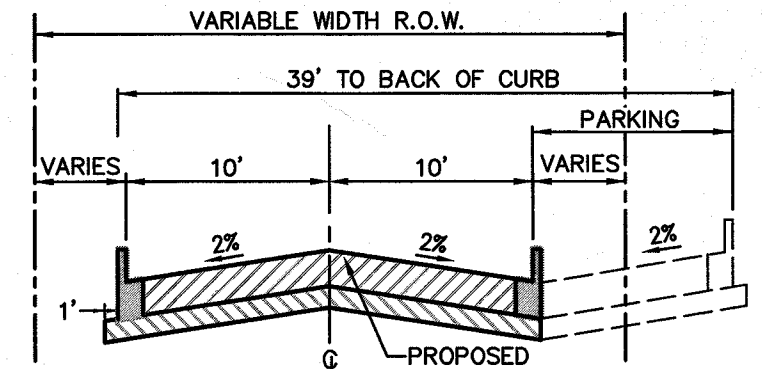

**TYPICAL SECTION "F"**  
**INTERURBAN STREET**  
**STA. 3+14 - STA. 5+64**

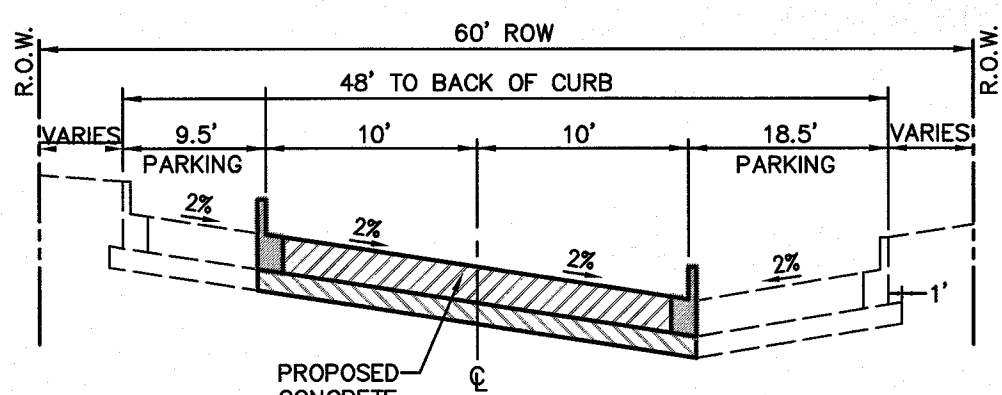

**TYPICAL SECTION "H"**  
**SAN JACINTO STREET**  
**STA. 6+30 - STA. 7+68**

**LEGEND**

B.	BOLLARD	TS*	TRAFFIC SIGNAL POLE
EM	ELECTRIC METER	TEL	TELEPHONE BOX
PP	POWER POLE	FL	FLOOD LIGHT
LS	LIGHT STANDARD	FP	FLAG POLE
WM	WATER METER	TS	TRAFFIC SIGN
WV	WATER VALVE	IRS	1/2-INCH IRON ROD
ICV	IRRIGATION CONTROL VALVE	W/P	W/PACHECO KOCH" CAP SET
PH	FIRE HYDRANT	(C.M.)	CONTROLLING MONUMENT
CO	CLEANOUT	---	PROPERTY LINE
MH	MANHOLE	-X-	FENCE
TSC	TRAFFIC SIGNAL CONTROL	OH	OVERHEAD UTILITY LINE
		-X-	PROPOSED FENCE

**BENCH MARK LIST**

BM# 1	"+" SET IN BOX ON CURB INLET ON NORTHWEST CORNER OF ALAMO ST. AND GOJARD ST. ELEV=574.54
BM# 2	"+" SET IN BOX ON BACK OF CURB ON SOUTH SIDE OF A CURB RETURN TO A PARKING LOTON EAST SIDE OF FANNIN ST. ±7 FEET SOUTH OF OLIVE ST. ELEV=573.63
BM# 3	"+" SET IN BOX ON SOUTH WEST CORNER OF GOJARD ST. AND KAUFMAN ST. ±40 FEET WEST OF E OF GOJARD ST. AND ±25 FEET SOUTH OF E OF KAUFMAN ELEV=587.41
BM# 4	"+" SET IN BOX ON NORTH EAST CORNER OF N. FANNIN ST. AND KAUFMAN ST. ±15 FEET NORTH OF E OF KAUFMAN ST. AND ±30 FEET EAST FROM E OF KAUFMAN ST. ELEV=578.80
BM# 5	"+" SET IN BOX ON NORTH WEST CORNER OF WASHINGTON ST. ON GOJARD ST. ±40 FEET WEST OF E OF GOJARD ST. AND ±25 FEET NORTH OF E OF WASHINGTON ST. ELEV=595.39
BM# 6	"+" SET IN BOX SOUTH EAST CORNER OF WASHINGTON ST. AND FANNIN ST ±22 FEET OF E OF FANNIN ST. AND ±45 FEET SOUTH OF E OF WASHINGTON ST. ELEV=580.69

**NOTES:**  
 1. CONTRACTOR SHALL ADJUST ALL EXISTING VALVES, METERS, CLEANOUTS AND MANHOLES TO PROPOSED GRADE UNLESS OTHERWISE NOTED WITHIN THE CONSTRUCTION AREA. FOR ADJUSTMENT/REMOVAL OF STORM SEWER APPURTENANCES SEE SHEETS C6-4, C6-5, C6-6 AND C6-9.  
 2. CONTRACTOR SHALL REMOVE OR RELOCATE ALL EXISTING MAIL BOXES, LIGHT STANDARDS (REFER TO MEP PLANS), UTILITY "WARNING" SIGNS AND TRAFFIC SIGNS WITHIN THE CONSTRUCTION AREA. CONTRACTOR SHALL ALSO COORDINATE THESE ITEMS WITH THE APPROPRIATE OWNER AND/OR PUBLIC ENTITY. CONTRACTOR SHALL COORDINATE THE REMOVAL OR RELOCATION OF POWER POLES WITH ONCOR AND THE ELECTRICAL ENGINEER.

NOTE: CONTRACTOR TO MATCH EXISTING PAVEMENT AT ALL SAWCUT LINES

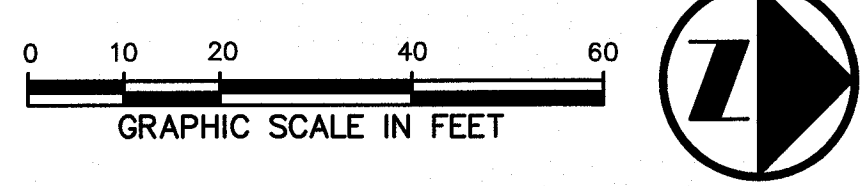

sheet location  
 KEY MAP

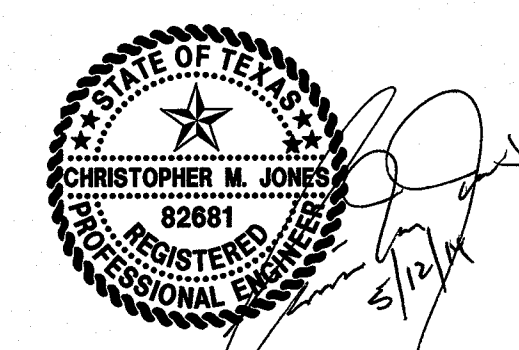
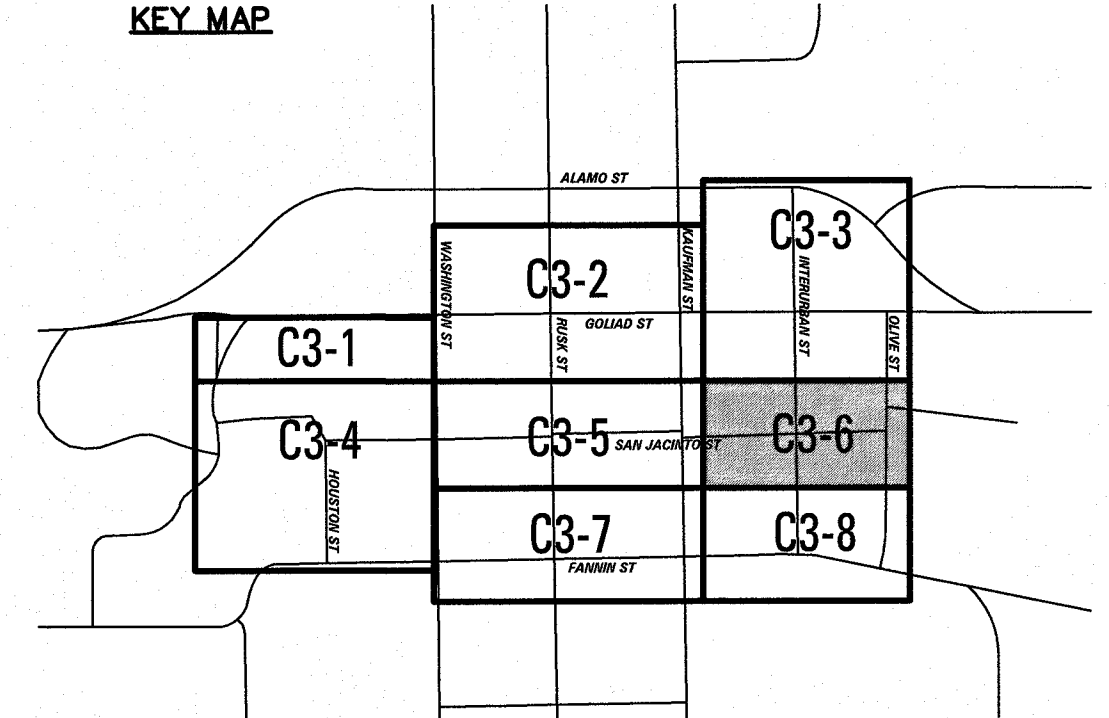

THE SEAL APPEARING ON THIS DOCUMENT WAS AUTHORIZED BY CHRISTOPHER M. JONES, P.E. 62881 ON 05/12/14. ALTERATION OF A SEALED DOCUMENT WITHOUT PROPER NOTIFICATION TO THE RESPONSIBLE ENGINEER IS AN OFFENSE UNDER THE TEXAS ENGINEERING PRACTICE ACT.