

CHARLES W. JONES SURVEY
ABSTRACT NO. 127

MABLE DALTON
VOLUME 46, PAGE 85

CHARLES W. JONES SURVEY
ABSTRACT NO. 127

MIKE N. NABORS, et ux
VOLUME 233, PAGE 451
(HERITAGE HEIGHTS ADDITION, LOT 1, BLOCK C)

CHARLES W. JONES SURVEY
ABSTRACT NO. 127

DAVID B. & TERRI D. GRANBERRY
VOLUME 1925, PAGE 309
(HERITAGE HEIGHTS ADDITION, LOT 1, BLOCK B)

MATCH LINE STA. 8+00
N 16313.8150, E 8992.4568

MATCH LINE STA. 13+00
N 16267.7674, E 9490.3319

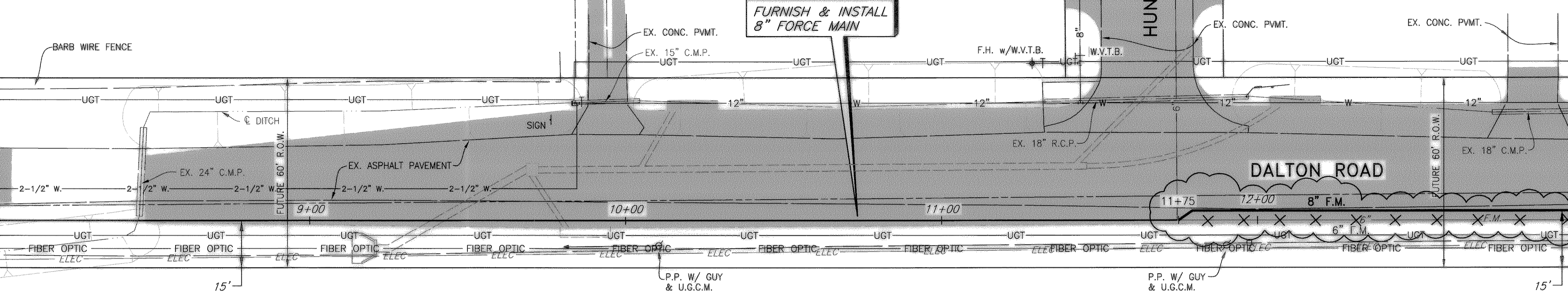

LEGEND
[Symbol] FUTURE PAVEMENT BY OTHERS
[Symbol] EXISTING ASPHALT PAVEMENT

T.B.M.
STA. 11+96.31, 38.97' LT.
N 16316.1170, E 9390.6695
"O" CUT ON TOP HEADWALL @
HUNT LANE.
ELEV. 495.03

B.M.
N. 16472.1670, E. 7124.5835
ALUMINUM DISC FOUND IN SOUTH
RIGHT-OF-WAY LINE OF DALTON RD.,
1,087.66 FEET WEST OF CENTERLINE
OF PROPOSED ACCESS ROAD.
ELEV. 443.29

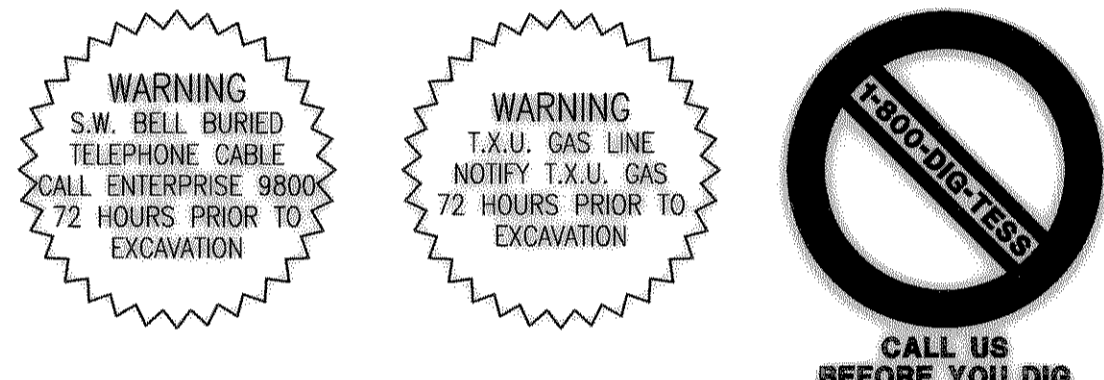

SHORES NORTH, PHASE V ADDITION

THOMAS DEAN SURVEY
ABSTRACT NO. 69

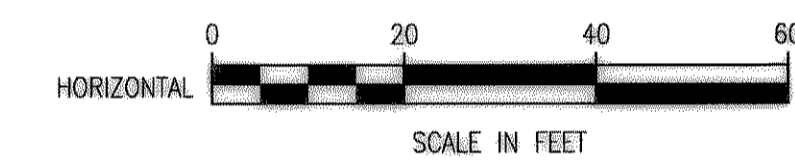

These plans and related specifications were prepared for construction of this specific project only. Reuse of these documents is not permitted without written authorization of Birkhoff, Hendricks, & Conway, L.L.P.

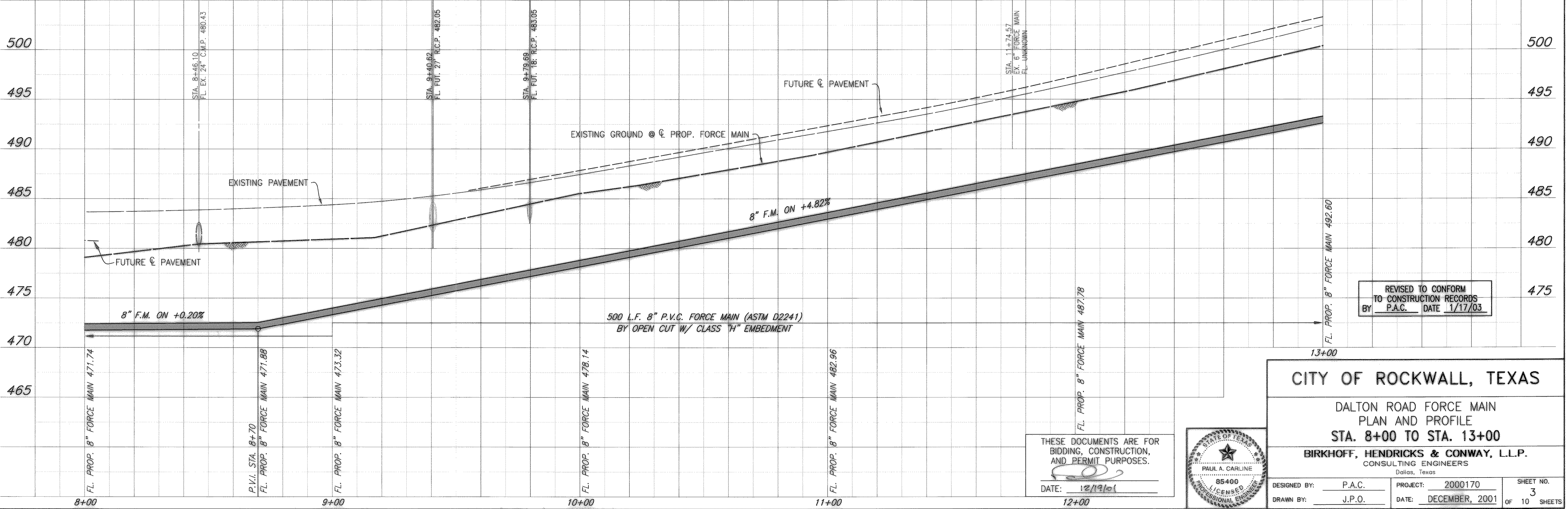

REVISED TO CONFORM TO CONSTRUCTION RECORDS BY P.A.C. DATE 1/17/03

CITY OF ROCKWALL, TEXAS
DALTON ROAD FORCE MAIN
PLAN AND PROFILE
STA. 8+00 TO STA. 13+00
BIRKHOFF, HENDRICKS & CONWAY, L.L.P.
CONSULTING ENGINEERS
Dallas, Texas

| | | |
|---------------------|----------------------|--------------|
| DESIGNED BY: P.A.C. | PROJECT: 2000170 | SHEET NO. 3 |
| DRAWN BY: J.P.O. | DATE: DECEMBER, 2001 | OF 10 SHEETS |

THESE DOCUMENTS ARE FOR BIDDING, CONSTRUCTION, AND PERMIT PURPOSES.
DATE: 12/19/01

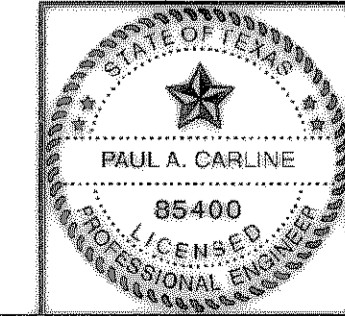

Revised: 12/19/2001 JPO H:\Projects\Rockwall\2000170\Plans\Sheets\2000170-303.dwg Master 170