

NOTES:

- 1. APPROVED WELDED WIRE FABRIC IN SHEETS MAY BE USED IN LIEU OF DEFORMED REINFORCING BARS.
- 2. THE WIRE FABRIC SHALL BE SUPPORTED BY APPROVED BAR CHAIRS ON 38" CENTERS.
- 3. THE SIZE OF THE WIRE FABRIC SHALL BE 12 x 12-W4 WITH A NOMINAL DIAMETER OF 0.225 INCHES AND A NOMINAL WEIGHT OF 0.136 LBS./LIN. FT.

1/2" DOWEL EXPANSION JOINT WITH EXPANSION JOINT FILLER EVERY 117' (MAX.) AND AT ALL RADI POINTS

NOTES:

- 1. ALL HONEYCOMB IN BACK OF CURB TO BE TROWEL - PLASTERED BEFORE POURING SIDEWALK.
- 2. LUG MAY BE FORMED BY SHAPING SUBGRADE TO APPROXIMATE DIMENSIONS SHOWN.
- 3. FOR SIDEWALKS AGAINST EXISTING CURB. KEYWAY SHALL BE REPLACED WITH 6" LONG #3 BARS DRILLED 4" INTO EXISTING BACK CURB AND EPOXY GROUTED ON 24" CENTERS.
- 4. PAYMENT FOR KEYWAY SUBSIDIARY TO SIDEWALK LUG PAY ITEM.
- 5. PAYMENT FOR EXCAVATION, BORROW, AND COMPACTION IS SUBSIDIARY TO CONCRETE PAY ITEM.
- 6. LIME STABILIZATION OR SELECT BORROW MATERIAL FOR SUBGRADE IS REQUIRED WHEN SOIL P.I. IS GREATER THAN 18. LIMITS OF SUBGRADE STABILIZATION ARE MINIMUM REQUIRED.
- 7. BACKFILL FOR SIDEWALK SUBGRADE SHALL BE LIME STABILIZED SOIL OR SELECT BORROW MATERIAL HAVING A P.I. NOT LESS THAN 10 NOR GREATER THAN 18.
- 8. SIDEWALK BACKFILL AND SUBGRADE SHALL BE COMPACTED IN LIFTS NOT TO EXCEED 6 INCHES TO 95% OF ASTM D698 DENSITY WITH A MOISTURE WITHIN -2% TO +4% OF OPTIMUM MOISTURE.
- 9. 1/2" EXPANSION JOINTS SHALL BE PROVIDED AT STREET EXPANSION JOINTS AND AT A MAXIMUM 40 FOOT SPACING IN LINE WITH STREET SAW JOINTS: A TOOL MARKED GROOVE SHALL BE PROVIDED IN LIME WITH INTERMEDIATE STREET SAW JOINTS.

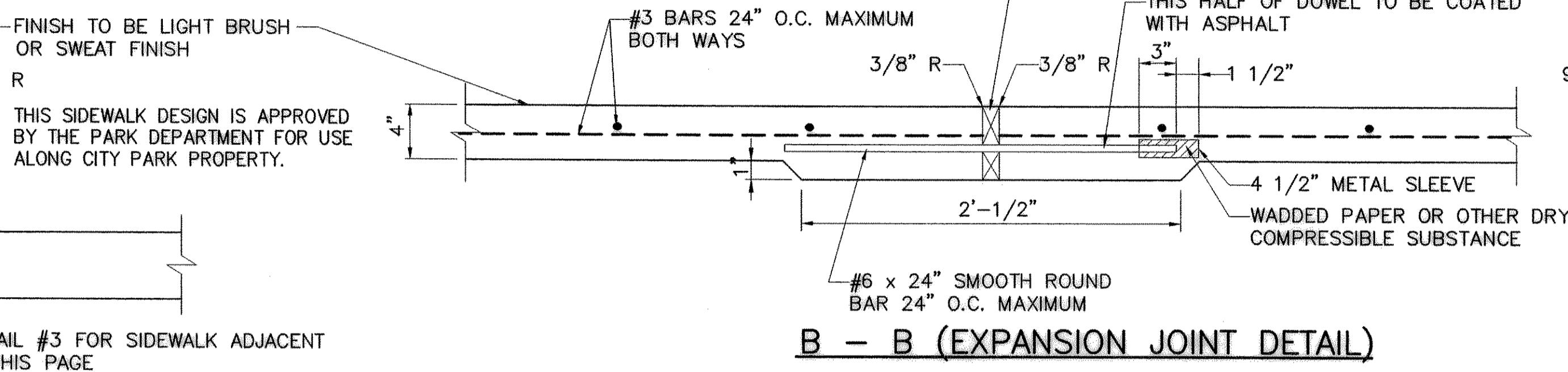
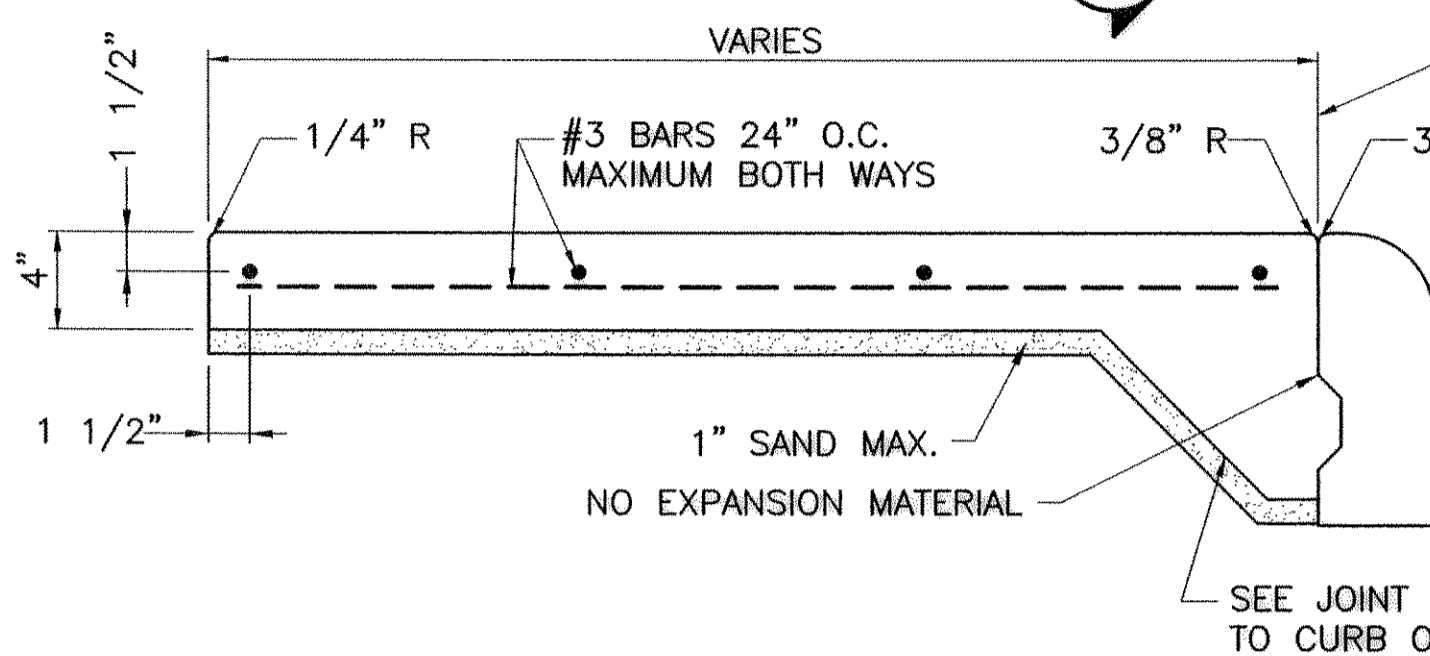
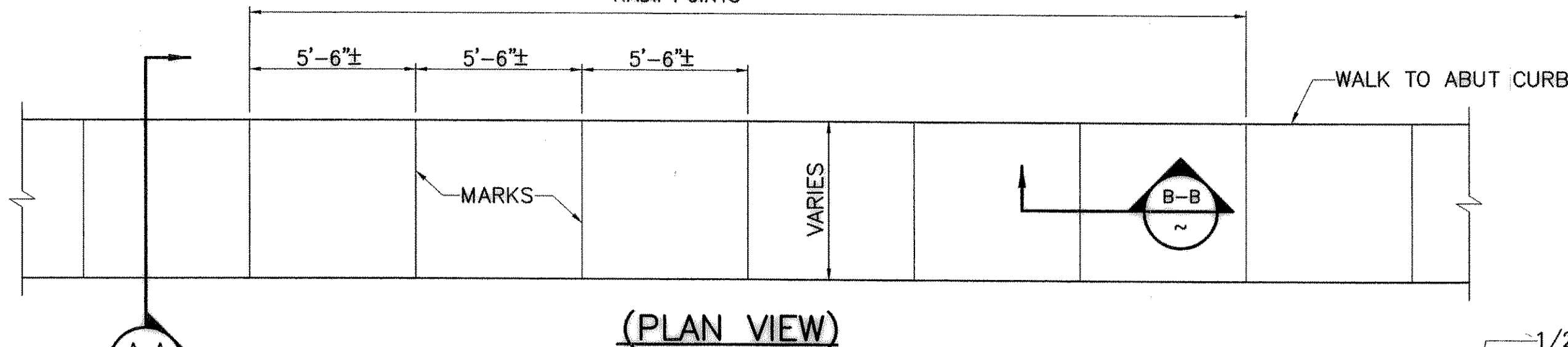

SIDEWALK AND HIKE AND BIKE TRAIL ADJACENT TO CURB DETAILS

NOT TO SCALE

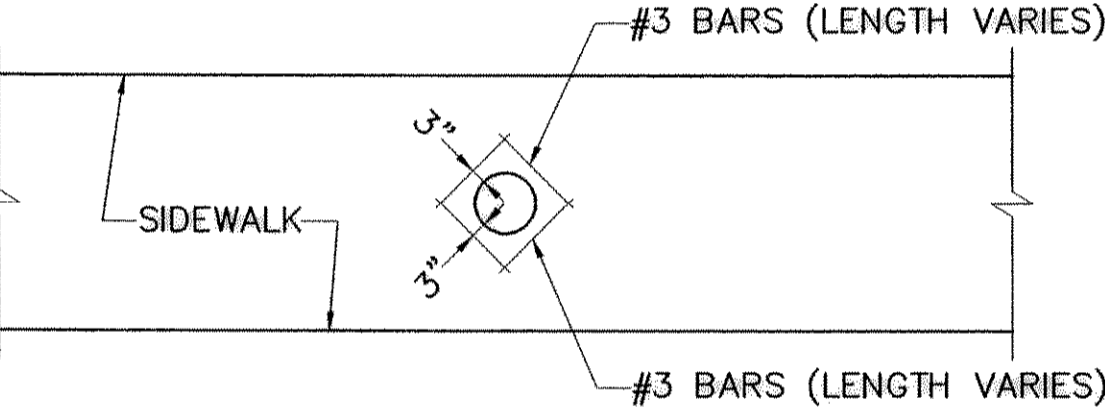
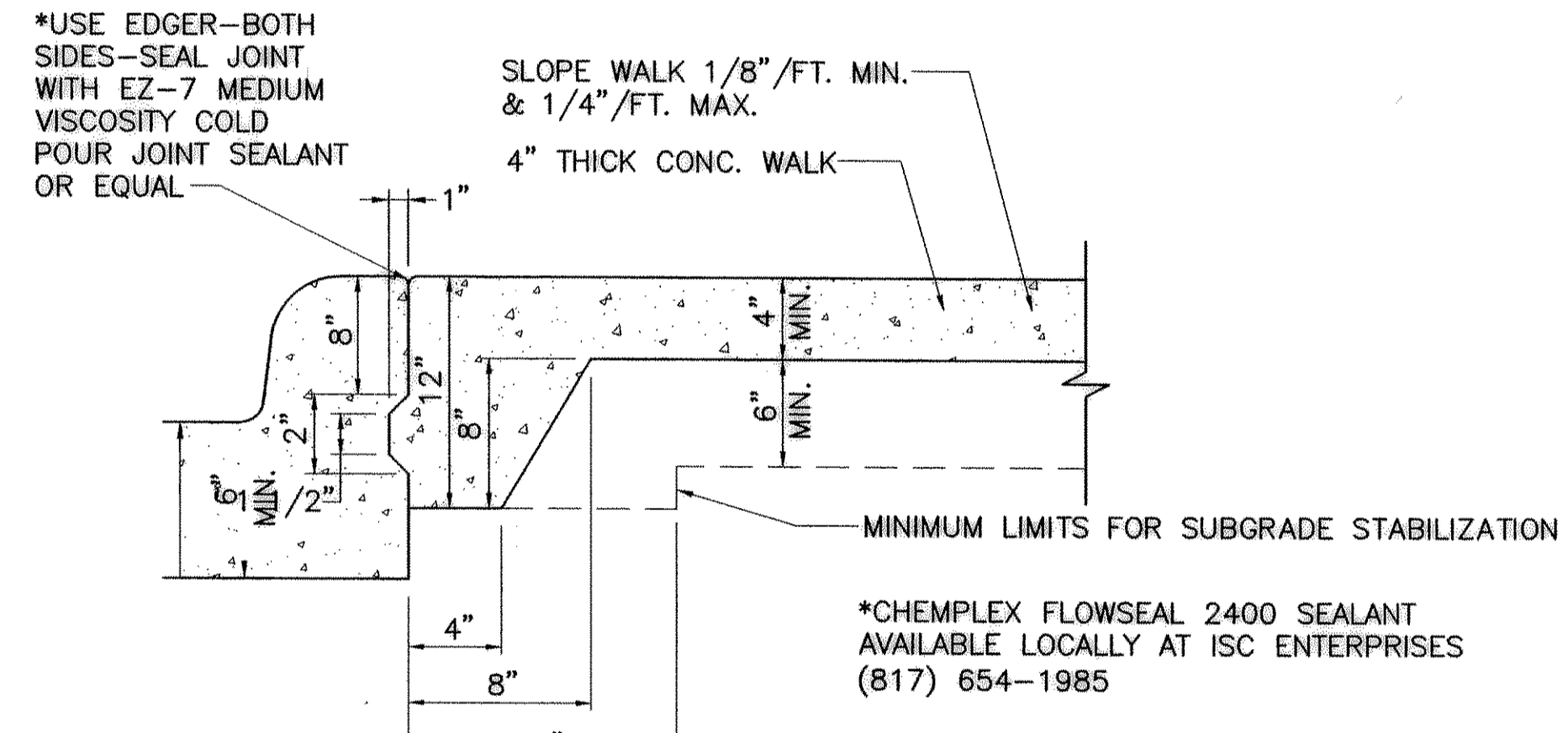

NOT TO SCALE

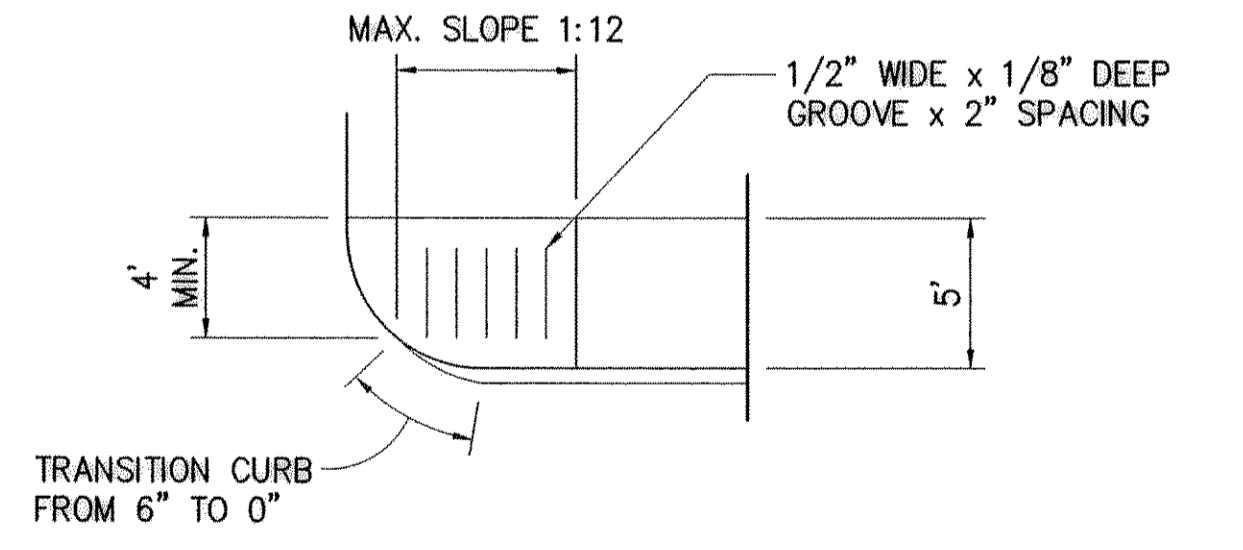

NOTE: SURFACE ON CONCRETE SHALL HAVE ROUGH FINISH AND BE DYED TO 1/4" DEEP WITH COLOR APPROVED BY CITY ENGINEER.

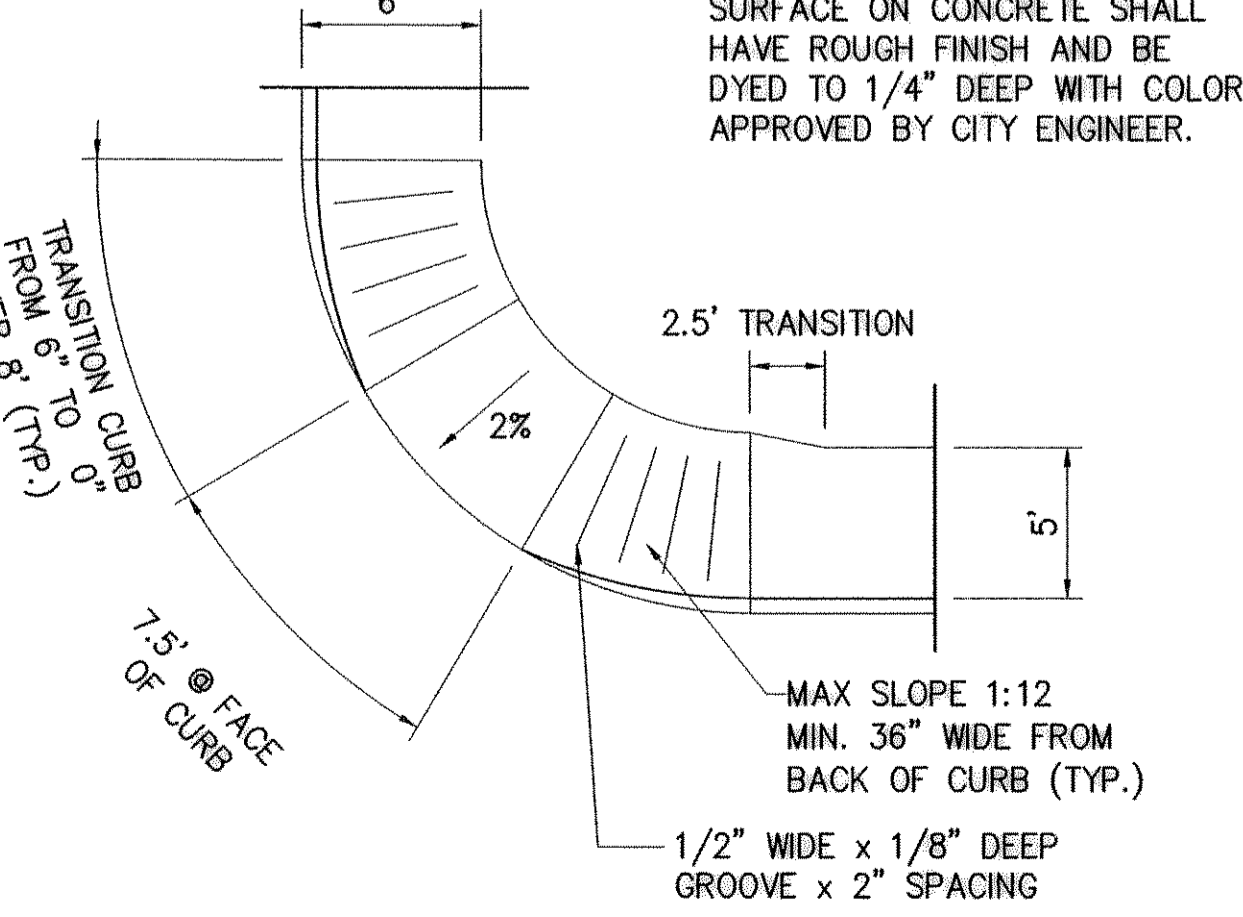

NOT TO SCALE

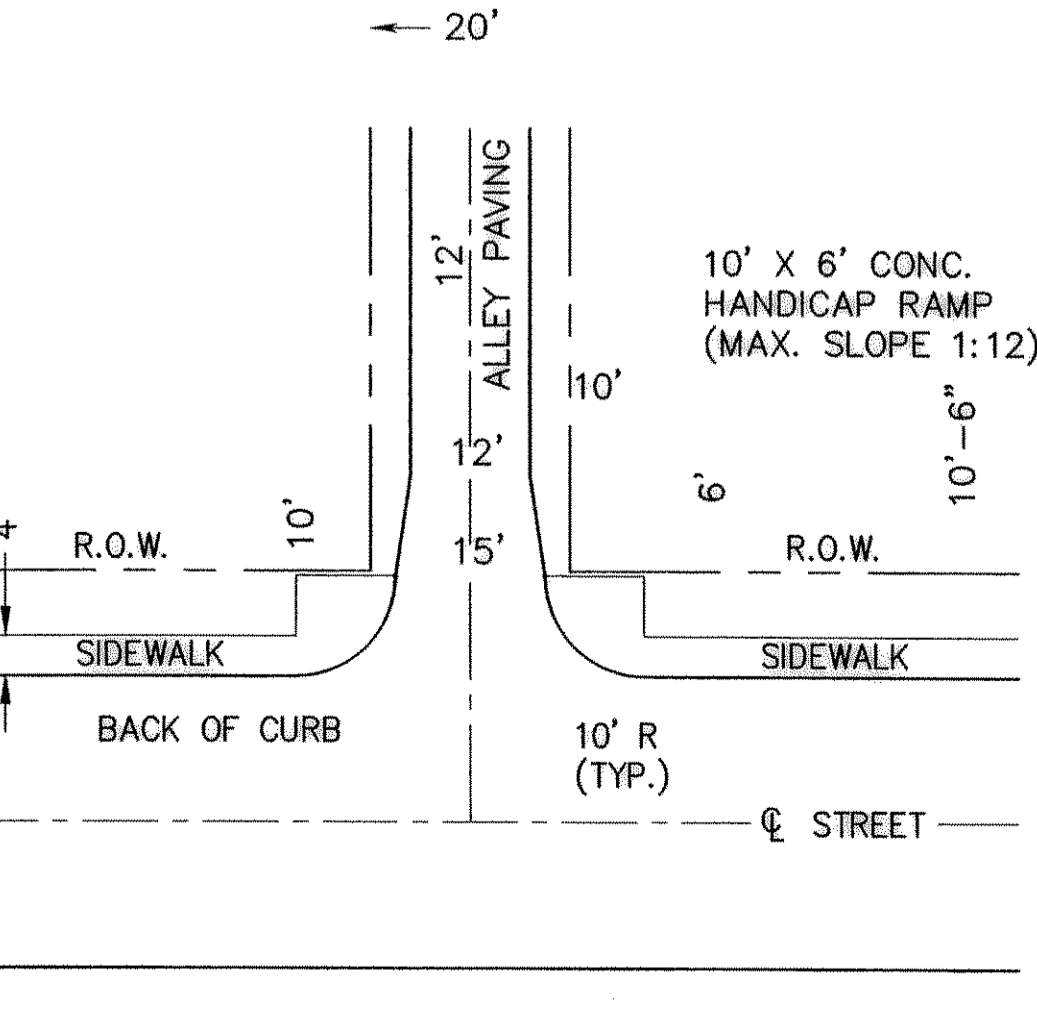

NOT TO SCALE

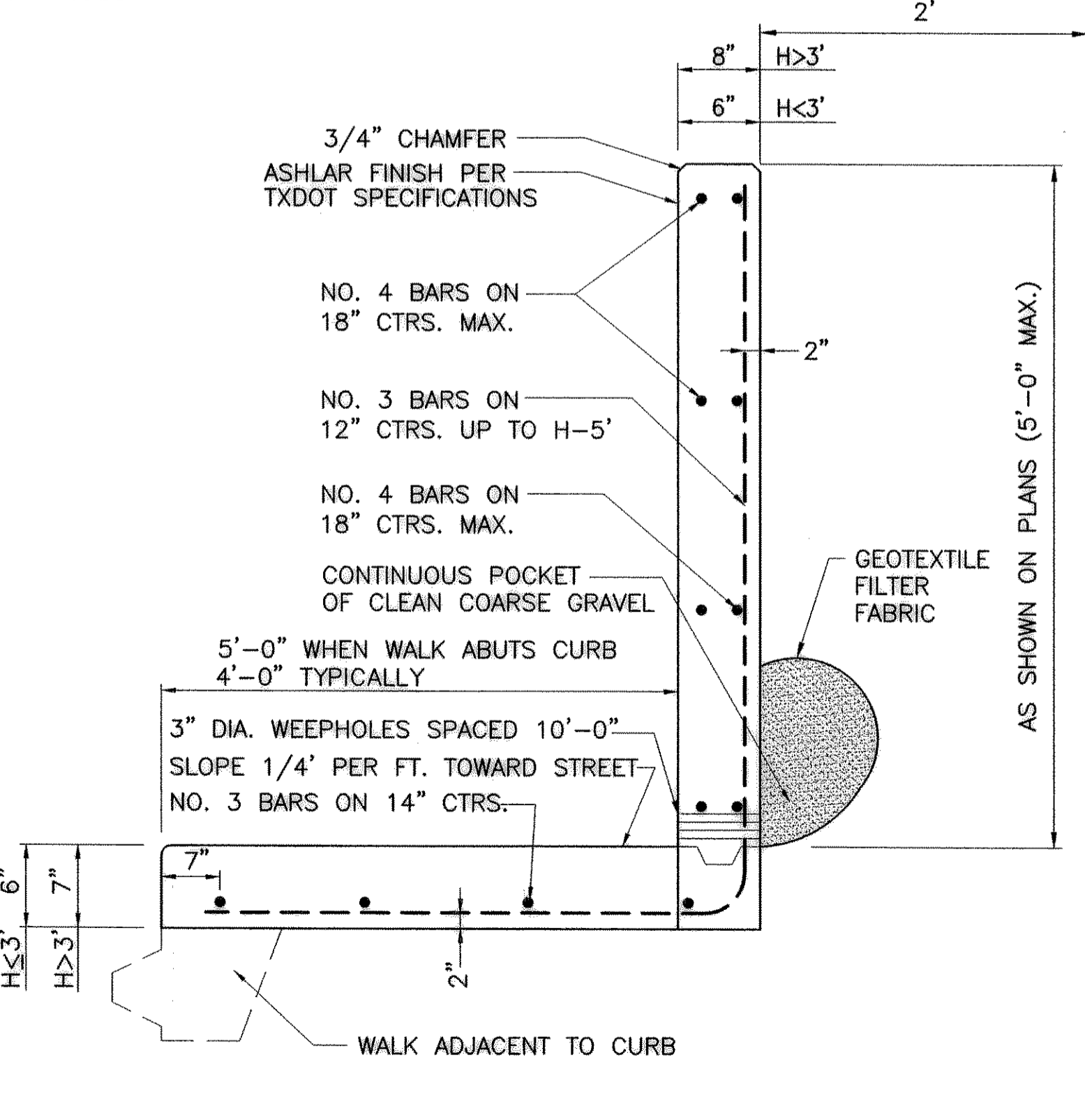

COMBINATION CANTILEVER & WALK, WALL GREATER THAN H-5'-0" REQUIRES SPECIAL ENGINEERING ANALYSIS

RECORD DRAWING
BASED ON INFORMATION SUPPLIED BY THE CONTRACTOR
TO: TRICIA H. HATLEY
DATE: JANUARY 7, 2003

THIS DOCUMENT WAS ORIGINALLY SIGNED, SEALED AND DATED BY:
ENGINEER: TRICIA H. HATLEY
TEXAS REGISTRATION NO.: 83282
DATE: APRIL 5, 2002

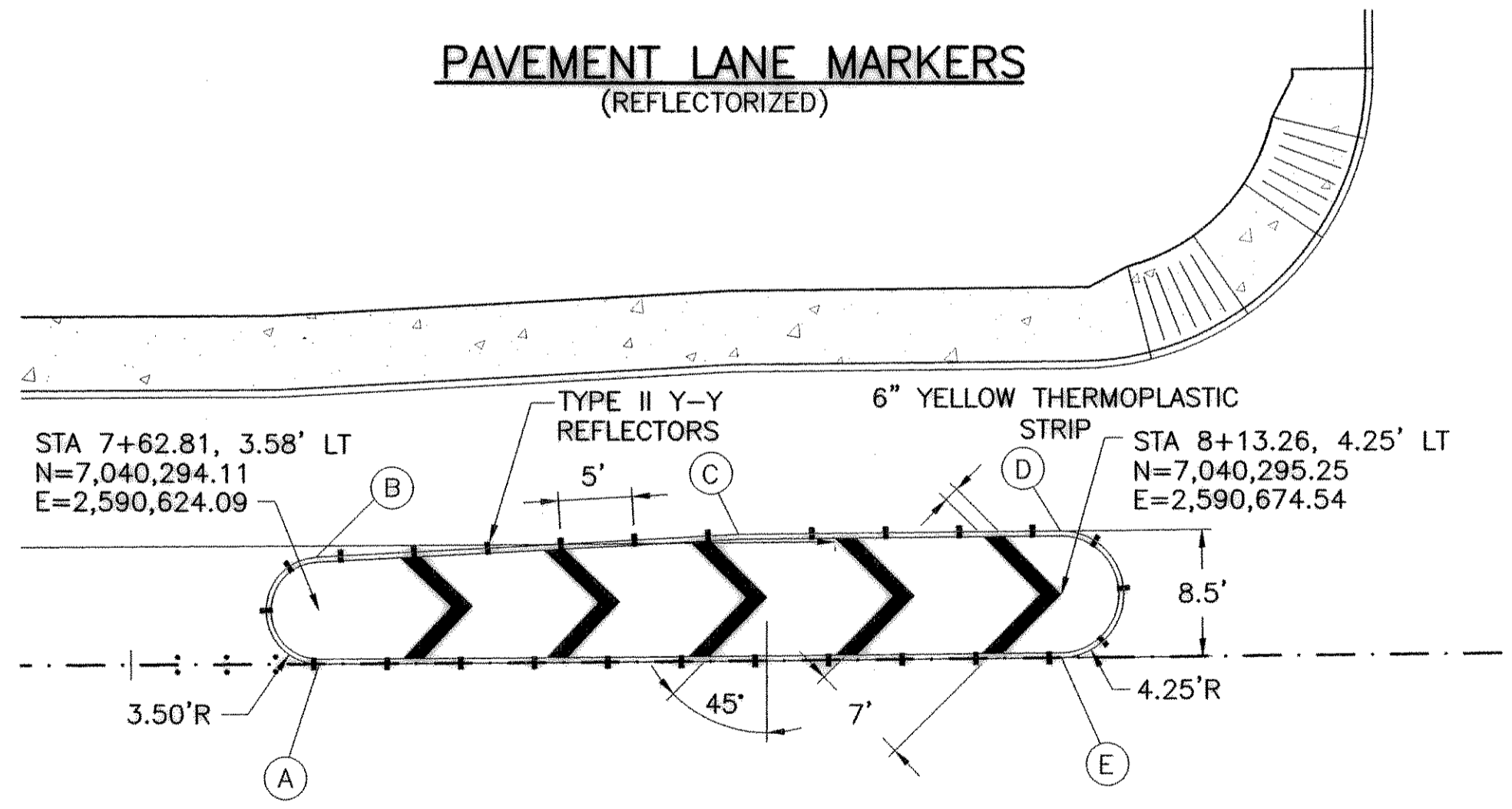
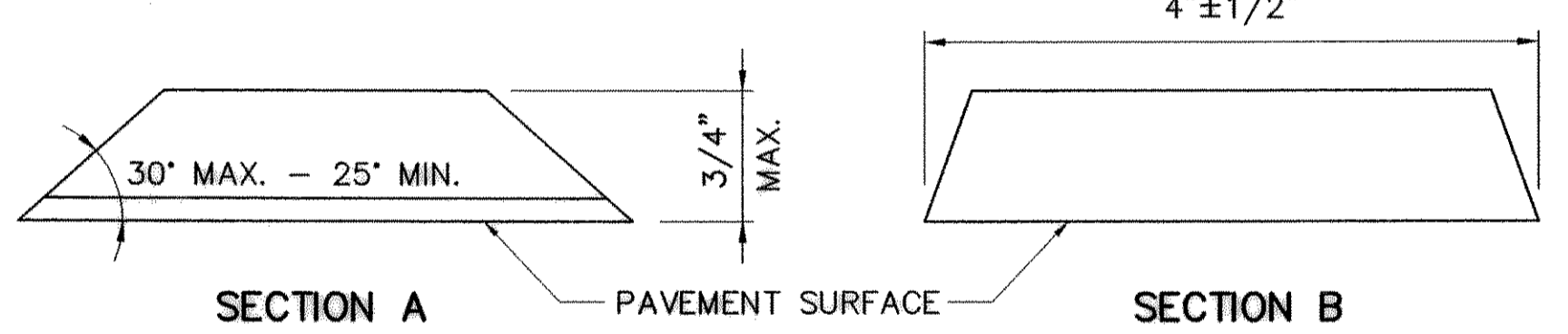
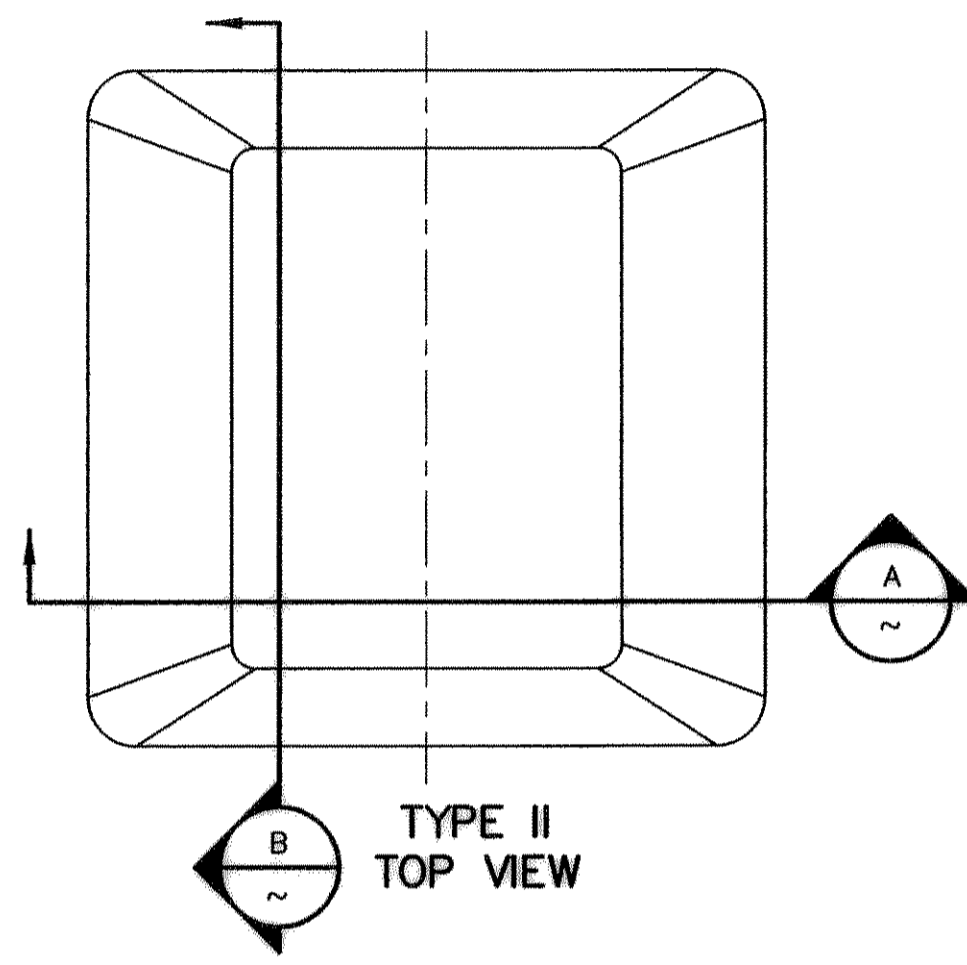

POINT	NORTHING	EASTING
(A)	7,040,290.53	2,590,624.12
(B)	7,040,297.69	2,590,623.89
(C)	7,040,299.30	2,590,652.60
(D)	7,040,299.50	2,590,674.50
(E)	7,040,291.00	2,590,674.58

SCALE: 1"=10'

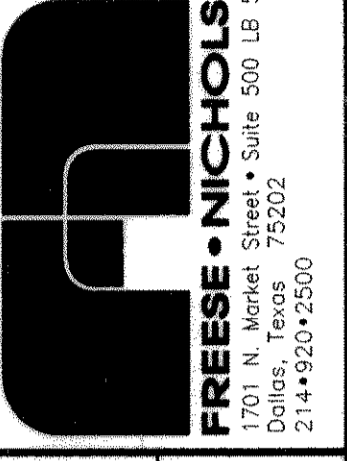
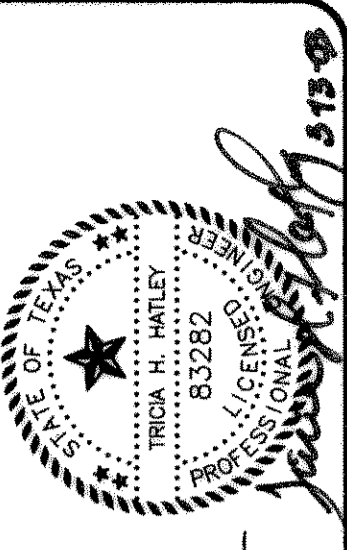

CITY OF ROCKWALL
DALTON ROAD RECONSTRUCTION
PAVING DETAILS

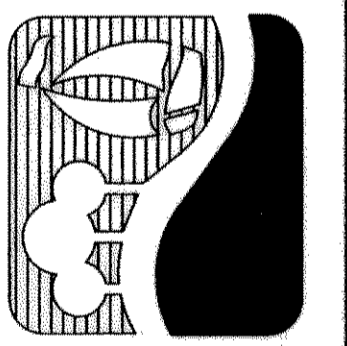

PROJECT NO.	FILE	DATE	DESIGNED	DRAWN	REVISION	CHECKED
R0K01364	Pave-dtl82	01-29-2002	KRU/SDH	LMR		THH
NO.	REVISION	BY	DATE	VERIFIED	SCALE	

Bar is one inch on original drawing. If not one inch on this sheet, adjust scale.

SHEET PDTL2

SEQ. 12 OF 19

RECORD DRAWINGS