

XREF: ROCKWALL_2003120_V.V

BLOCKS: ROCKWALL_2003120_V.V

SCALE: 1"=20'

H:\ROCKWALL\2003120\PLAN-SHEETS\2003120-STW10.DWG

08/25/04 R.L.

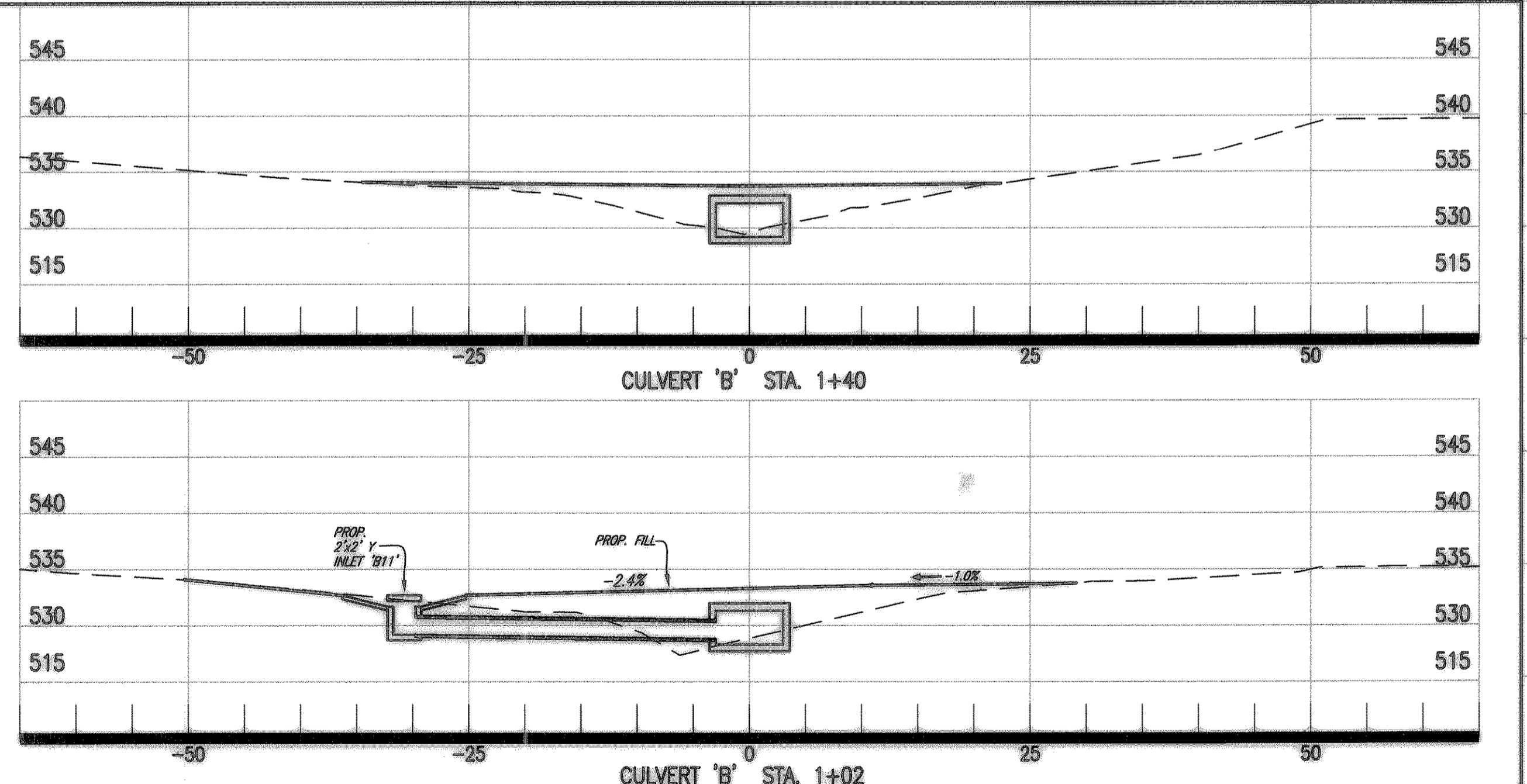
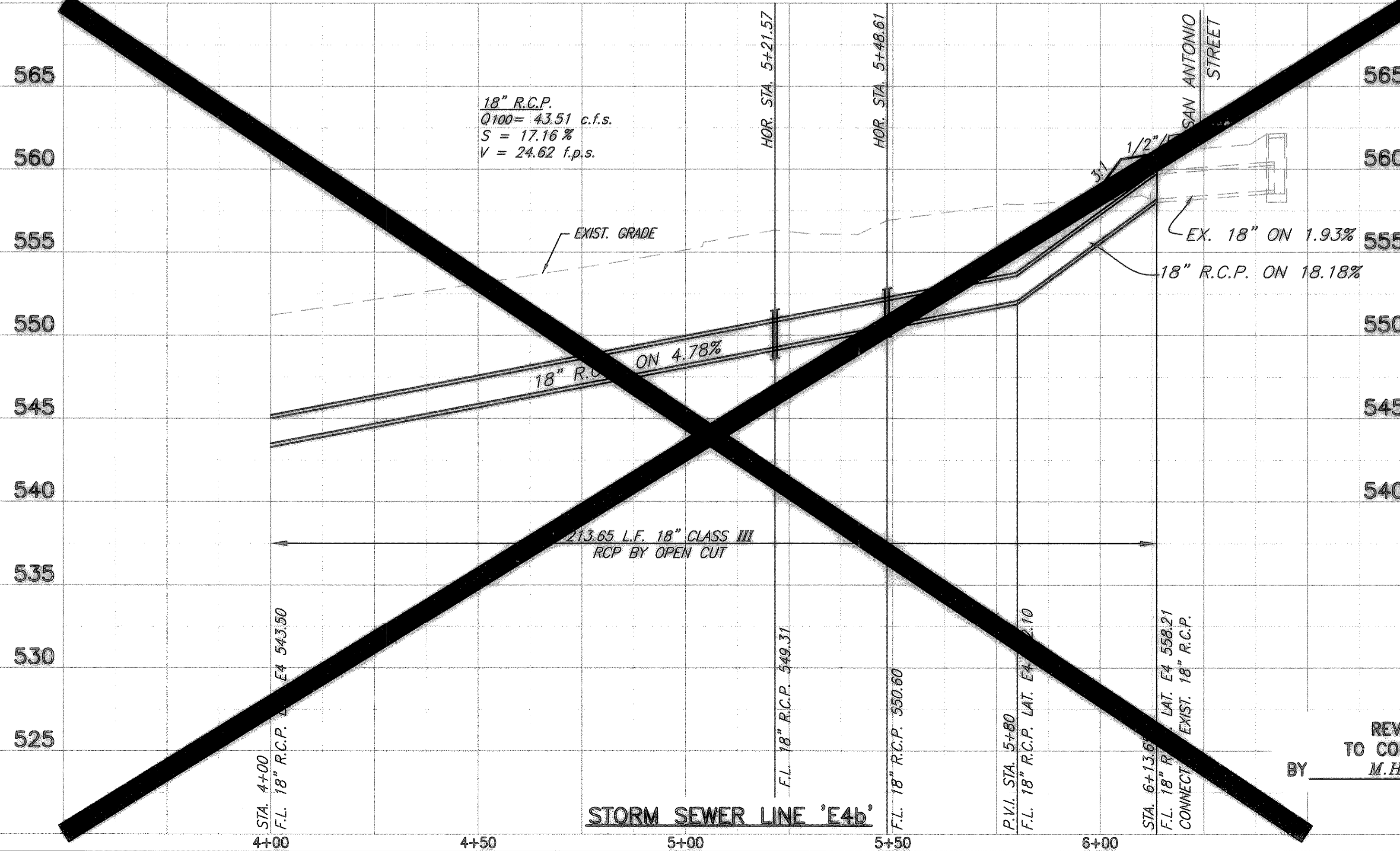
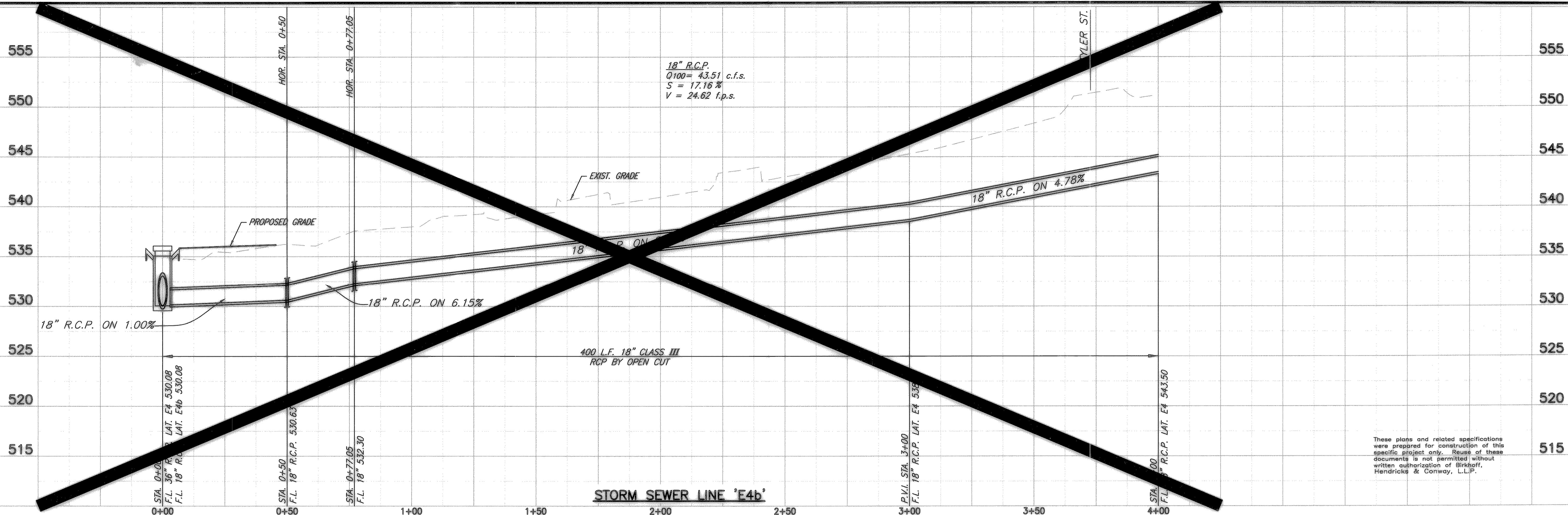

18" R.C.P.
 $Q_{100} = 43.51$ c.f.s.
 $S = 17.16\%$
 $V = 24.62$ f.p.s.

18" R.C.P.
 $Q_{100} = 43.51$ c.f.s.
 $S = 17.16\%$
 $V = 24.62$ f.p.s.

08/25/05 **FIELD CHANGE NO. 3**

REVISED TO CONFORM
 TO CONSTRUCTION RECORDS
 BY M.H. DATE 12/04/2006

THESE DOCUMENTS ARE FOR
 BIDDING, CONSTRUCTION,
 AND PERMIT PURPOSES.
 DATE: 8/6/04

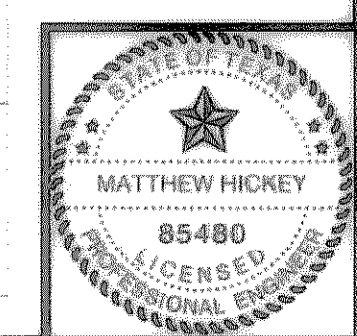

CITY OF ROCKWALL, TEXAS
CLARK/KAUFMAN ST.-STORM SEWER 'E'
PROFILE SHEET 10
LATERALS 'E4b'
 BIRKHOFF, HENDRICKS & CONWAY, L.L.P.
 CONSULTING ENGINEERS
 Dallas, Texas

DESIGNED BY: <u>M.H.</u>	PROJECT: <u>2003-120</u>	SHEET NO. <u>77</u>
DRAWN BY: <u>R.J.L.</u>	DATE: <u>AUGUST, 2004</u>	OF <u>X</u> SHEETS