

**LEGEND**

■ CONSTRUCT REINFORCED CONC. SIDEWALK

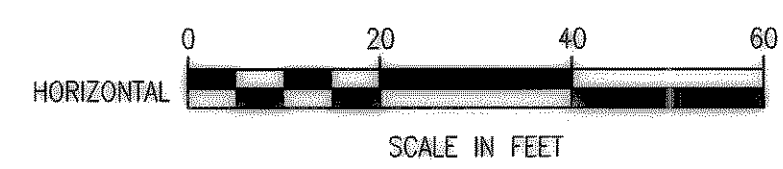
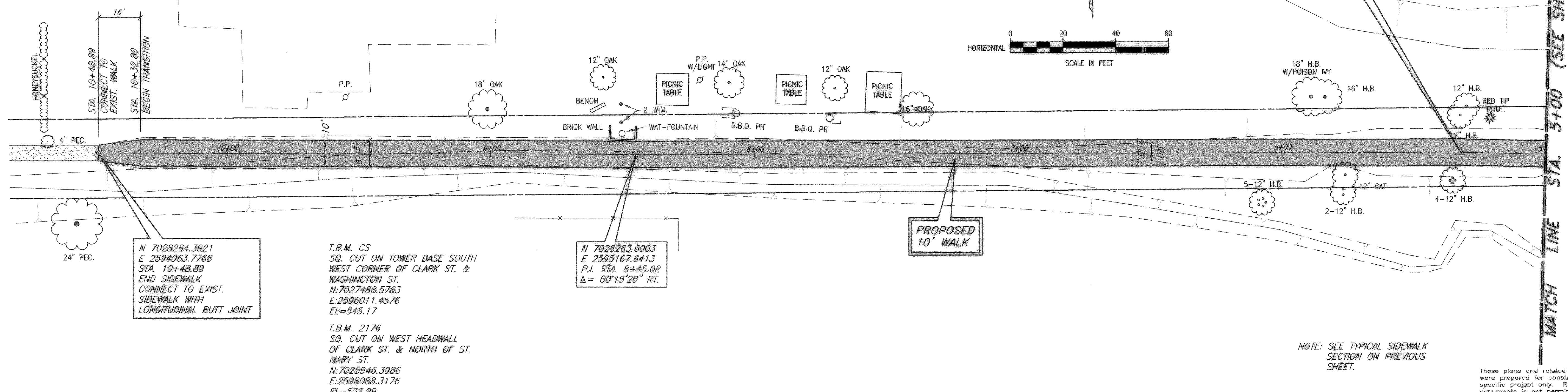

N 7028264.3921  
E 2594963.7768  
STA. 10+48.89  
END SIDEWALK  
CONNECT TO EXIST.  
SIDEWALK WITH  
LONGITUDINAL BUTT JOINT

T.B.M. CS  
SQ. CUT ON TOWER BASE SOUTH  
WEST CORNER OF CLARK ST. &  
WASHINGTON ST.  
N:7027488.5763  
E:2596011.4576  
EL=545.17

T.B.M. 2176  
SQ. CUT ON WEST HEADWALL  
OF CLARK ST. & NORTH OF ST.  
MARY ST.  
N:7025946.3986  
E:2596088.3176  
EL=533.99

N 7028263.6003  
E 2595167.6413  
P.I. STA. 8+45.02  
Δ = 00°15'20\"/>

PROPOSED  
10' WALK

N 7028263.7804  
E 2595480.2968  
P.I. STA. 5+32.37  
Δ = 01°36'03\"/>

NOTE: SEE TYPICAL SIDEWALK  
SECTION ON PREVIOUS  
SHEET.

These plans and related specifications  
were prepared for construction of this  
specific project only. Reuse of these  
documents is not permitted without  
written authorization of Birkhoff,  
Hendricks & Conway, L.L.P.

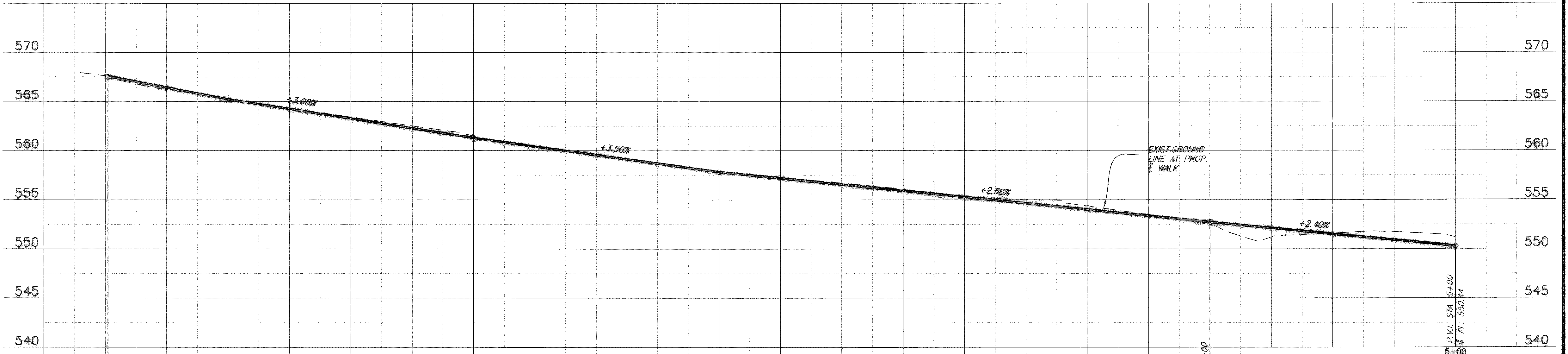

08/06/04 LBS H:\ROCKWALL\2003120\PLAN-SHEETS\2003120-10-WALK-PP2.DWG SCALE: 1"=20' BLOCKS: ROCKWALL\2003120\XREF: ROCKWALL\2003120\X

REVISED TO CONFORM  
TO CONSTRUCTION RECORDS  
BY M.H. DATE 12/04/2006

THESE DOCUMENTS ARE FOR  
BIDDING, CONSTRUCTION,  
AND PERMIT PURPOSES.  
*Matthew Hickey*  
DATE: 8/26/06

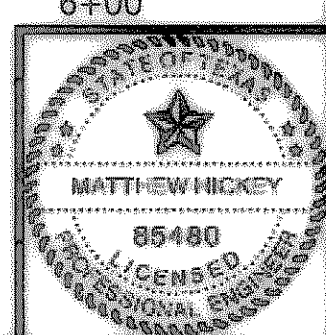

<b>CITY OF ROCKWALL, TEXAS</b>	
<b>INTERURBAN-SIDEWALK (ALTERNATE BID)</b>	
<b>PLAN AND PROFILE</b>	
<b>STA 5+00 TO STA. 10+48.89</b>	
<b>BIRKHOFF, HENDRICKS &amp; CONWAY, L.L.P.</b>	
CONSULTING ENGINEERS Dallas, Texas	
DESIGNED BY: <u>M.H.</u>	PROJECT: <u>2003-120</u>
DRAWN BY: <u>R.J.L.</u>	DATE: <u>AUGUST, 2004</u>
SHEET NO. <b>33</b> OF <b>X</b> SHEETS	