

08/16/04 R.L. H:\ROCKWALL\2003120\PLAN-SHEETS\2003120-RuskP1.DWG SCALE: 1"=20' BLOCKS: ROCKWALL\2003120\X.Y. SHEETS: ROCKWALL\2003120\X.Y. XREF: ROCKWALL\2003120\X.Y.

N 7027757.6592
 E 2595862.2572
 RUSK WEST STA. -1+64
 END PVMT. IMPROVMENT
 19 L.F. FULL DEPTH
 H.M.A.C. SAW CUT

N 7027761.6586
 E 2596130.0623
 RUSK EAST STA. 1+03.83
 END PVMT. IMPROVMENT
 23 L.F. FULL DEPTH
 H.M.A.C. SAW CUT

T.B.M. CS
 SQ. CUT ON TOWER BASE SOUTH
 WEST CORNER OF CLARK ST. &
 WASHINGTON ST.
 N:7027488.5763
 E:2596011.4576
 EL=545.17

T.B.M. 2176
 SQ. CUT ON WEST HEADWALL
 OF CLARK ST. & NORTH OF ST.
 MARY ST.
 N:7025946.3986
 E:2596088.3176
 EL=533.99

These plans and related specifications
 were prepared for construction of this
 specific project only. Reuse of these
 documents is not permitted without
 written authorization of Birkhoff,
 Hendricks & Conway, L.L.P.

- LEGEND**
- CONSTRUCT H.M.A.C. PAVEMENT
 - CONSTRUCT REINF. CONC. CURB & GUTTER
 - CONSTRUCT REINF. CONC. SIDEWALK
 - CONSTRUCT BRICK PAVERS
 - CONSTRUCT REINF. CONC. DRIVEWAY
 - CONSTRUCT GRAVEL DRIVEWAY
 - PROPOSED TREEWELL
 - 5.36 PROPOSED CONTOURS
 - 5.36.2- PROPOSED CONTOURS

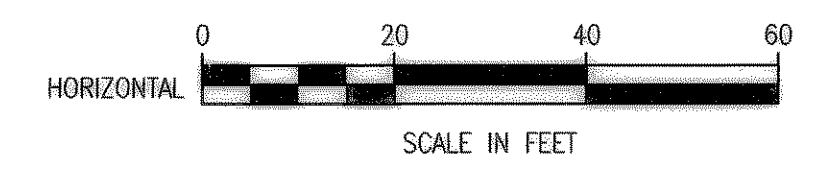

NOTE:
 REFER TO COORDINATE/DIMENSION
 SHEETS FOR CLARK ST. GEOMETRIC
 LAYOUT OF PROPOSED ROADWAY.

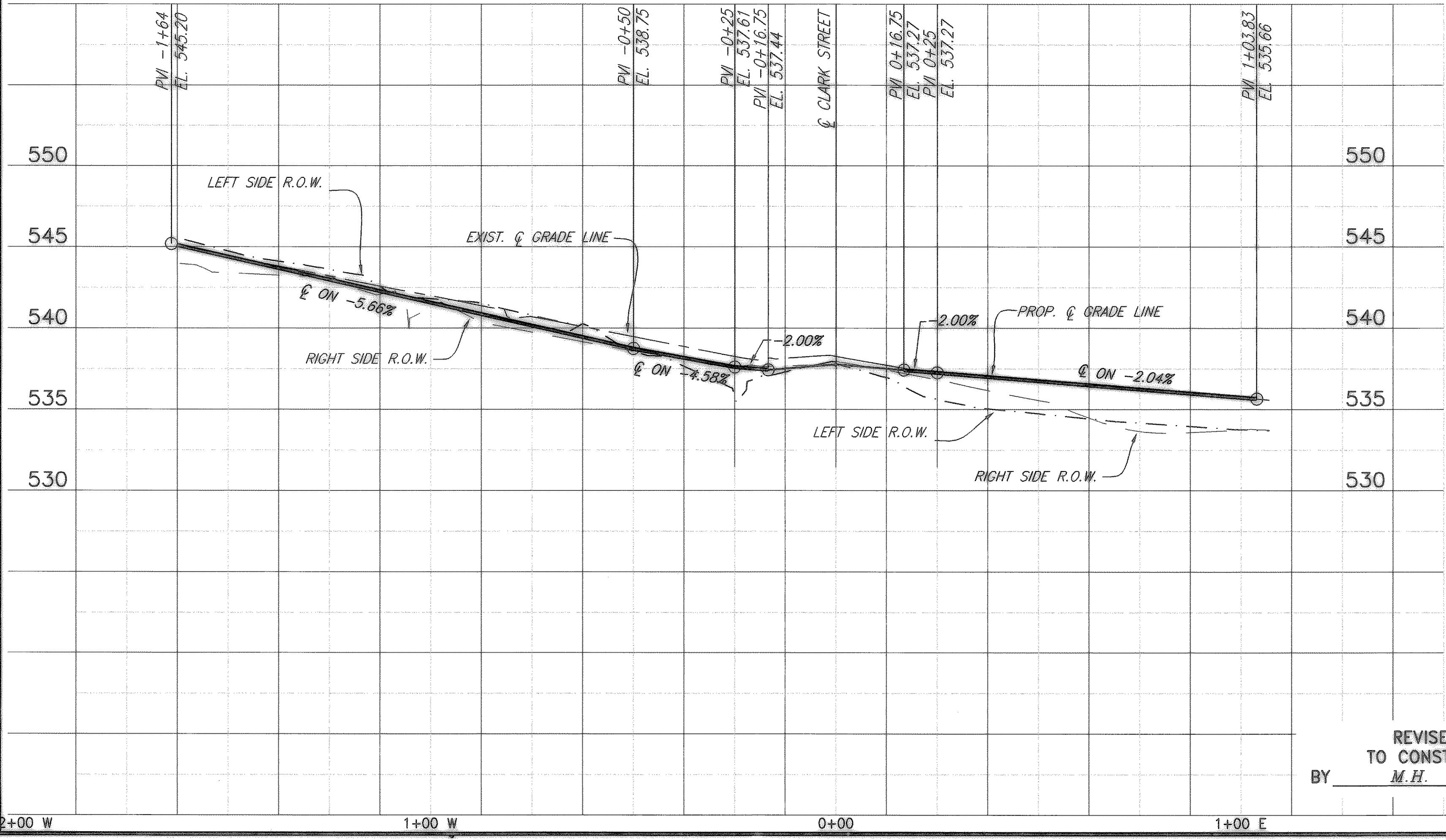
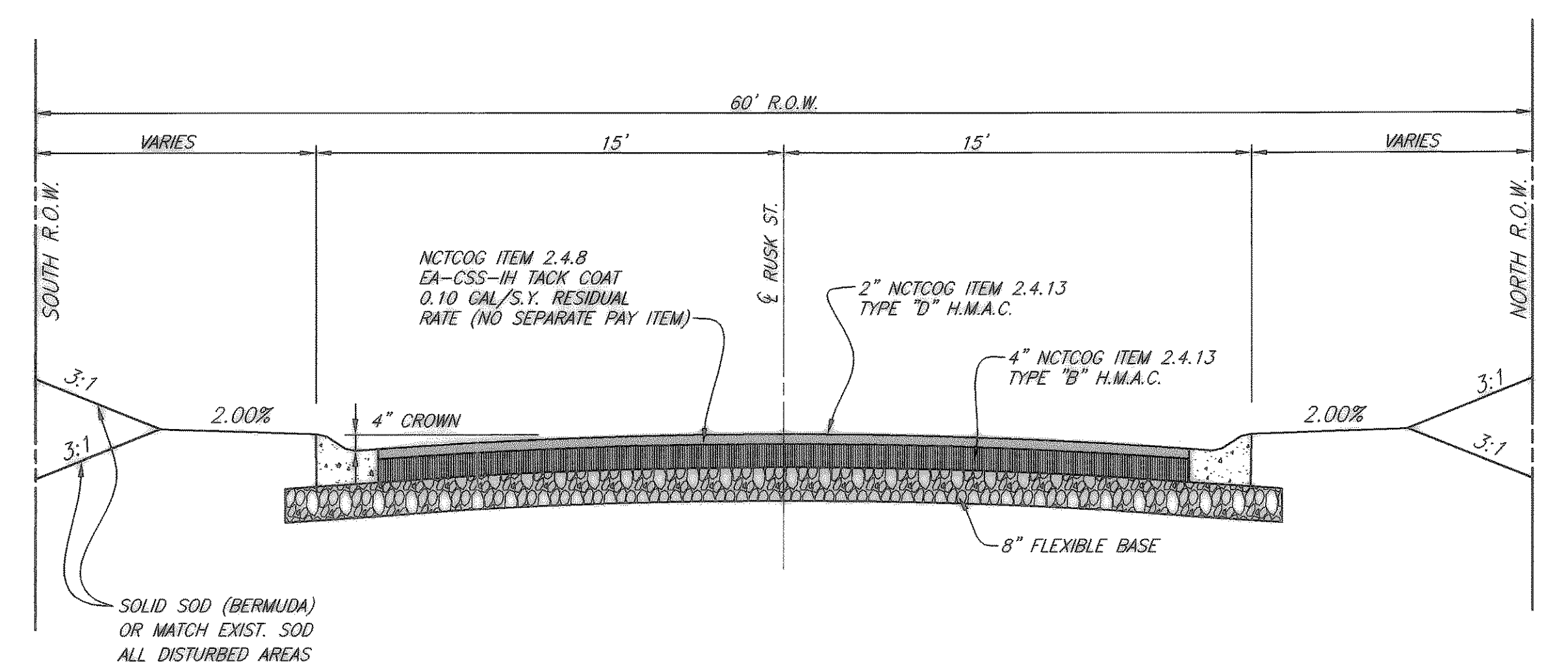
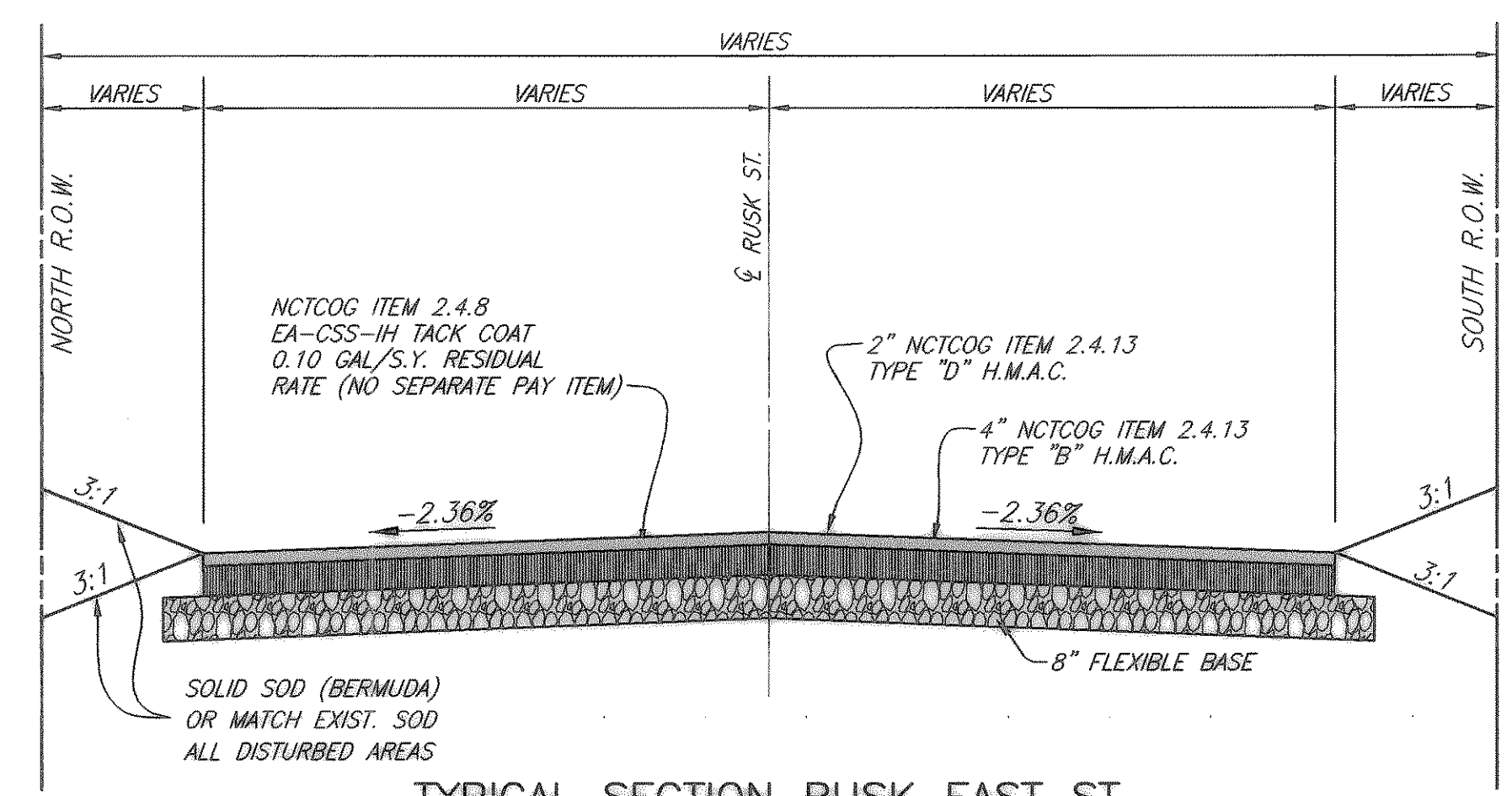
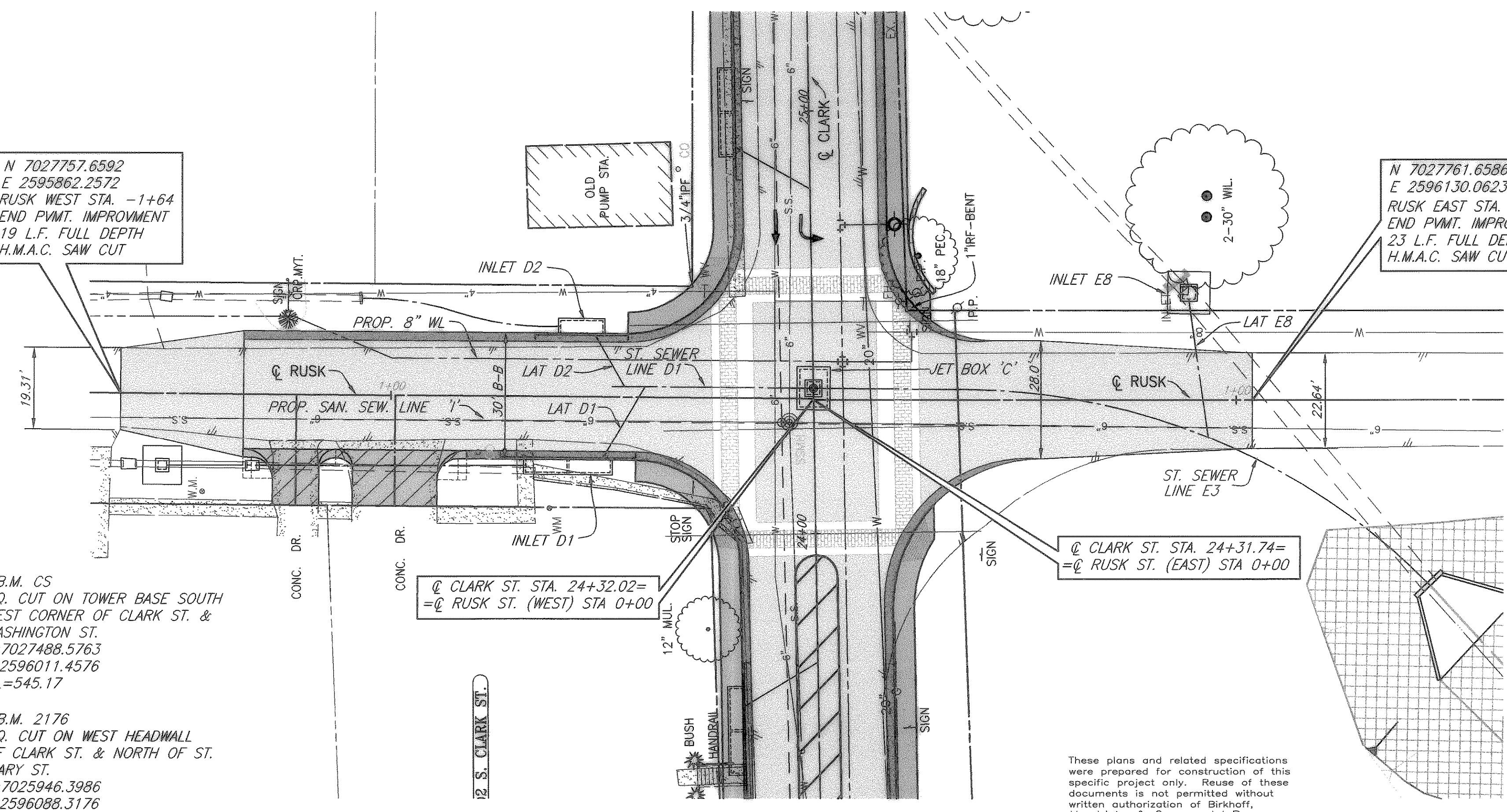

REVISED TO CONFORM
 TO CONSTRUCTION RECORDS
 BY M.H. DATE 12/04/2006

THESE DOCUMENTS ARE FOR
 BIDDING, CONSTRUCTION,
 AND PERMIT PURPOSES.
 DATE: 8/6/04

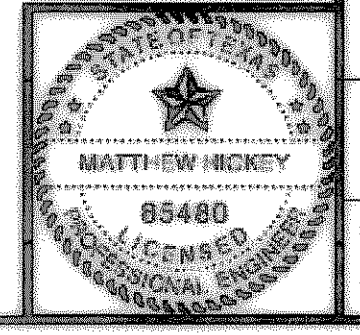

CITY OF ROCKWALL, TEXAS
RUSK STREET - PAVING
PLAN AND PROFILE
STA -1+64 WEST TO STA. 1+03.83 EAST
BIRKHOFF, HENDRICKS & CONWAY, L.L.P.
 CONSULTING ENGINEERS
 Dallas, Texas

DESIGNED BY: M.H. PROJECT: 2003-120 SHEET NO. 29
 DRAWN BY: R.J.L. DATE: AUGUST, 2004 OF X SHEETS