

05/19/04 GC H:\ROCKWALL\2003120\PLAN-SHEETS\2003120-HRP\DWG SCALE: 1"=20' BLOCKS: ROCKWALL\2003120\XREF: ROCKWALL\2003120\X

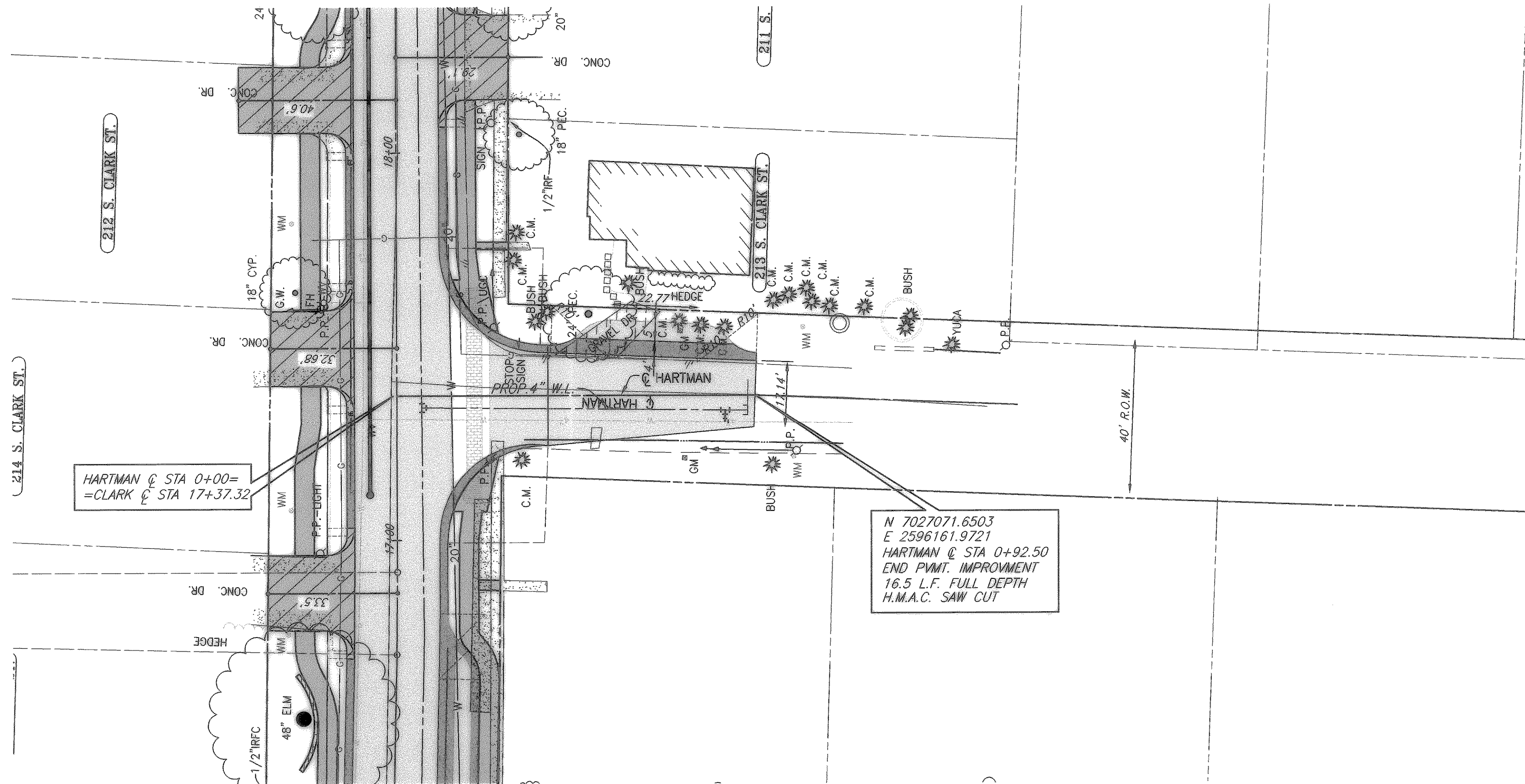

- LEGEND**
- CONSTRUCT H.M.A.C. PAVEMENT
  - CONSTRUCT REINF. CONC. CURB & GUTTER
  - CONSTRUCT REINF. CONC. SIDEWALK
  - CONSTRUCT BRICK PAVERS
  - CONSTRUCT REINF. CONC. DRIVEWAY
  - CONSTRUCT GRAVEL DRIVEWAY
  - PROPOSED TREEWELL
  - 534 PROPOSED CONTOURS
  - 534.2- PROPOSED CONTOURS

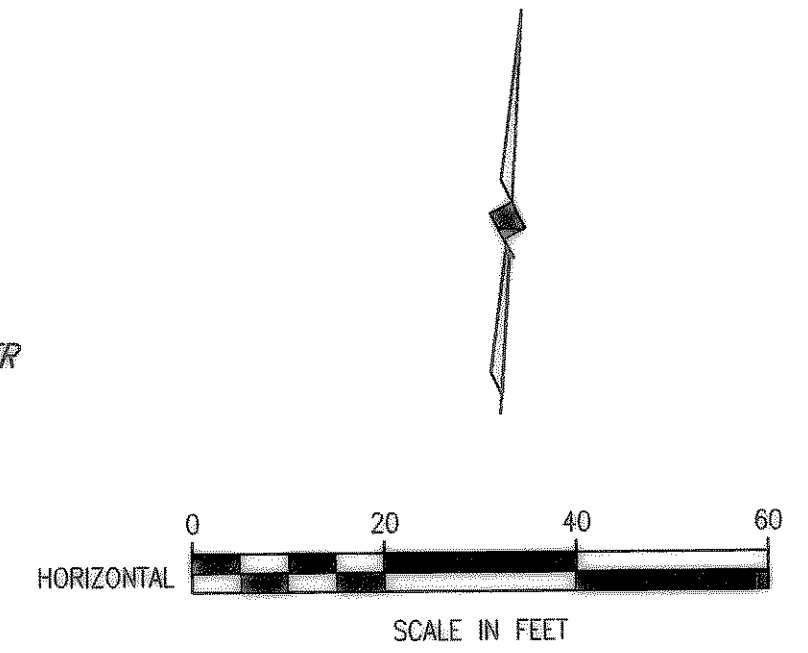

**NOTE:**  
REFER TO COORDINATE/DIMENSION SHEETS FOR CLARK ST. GEOMETRIC LAYOUT OF PROPOSED ROADWAY.

T.B.M. 2176  
SQ. CUT ON WEST HEADWALL OF CLARK ST. & NORTH OF ST. MARY ST.  
N:7025946.3986  
E:2596088.3176  
EL=533.99

T.B.M. 2884  
SQ. CUT IN INLET EAST OF CLARK ST. & SOUTH OF BOYDSTUN ST.  
N:7025217.8375  
E:2596128.8878  
EL=537.38

These plans and related specifications were prepared for construction of this specific project only. Reuse of these documents is not permitted without written authorization of Birkhoff, Hendricks & Conway, L.L.P.

N 7027071.6503  
E 2596161.9721  
HARTMAN @ STA 0+92.50  
END PVMT. IMPROVMENT  
16.5 L.F. FULL DEPTH  
H.M.A.C. SAW CUT

HARTMAN @ STA 0+00=  
=CLARK @ STA 17+37.32

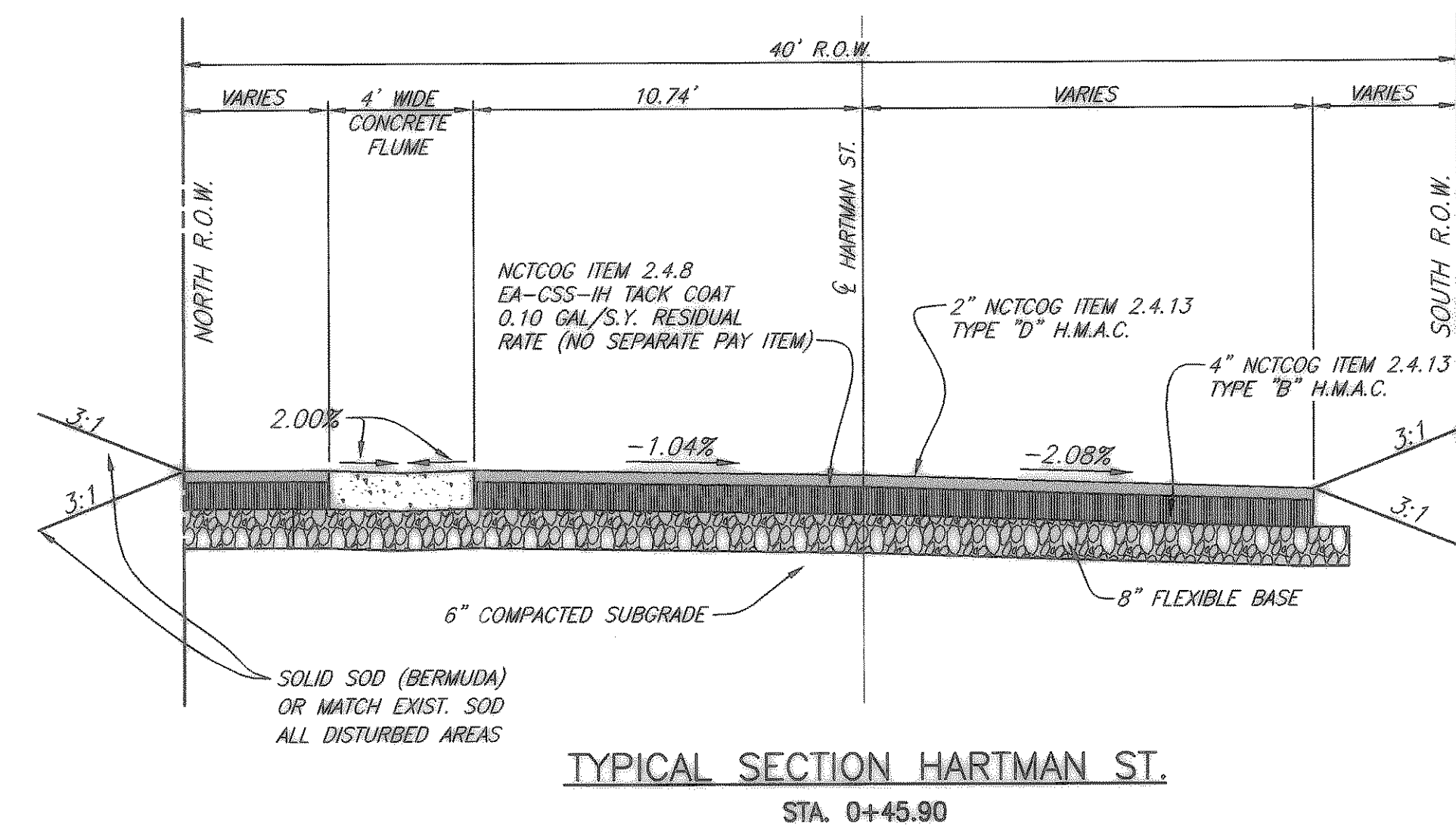
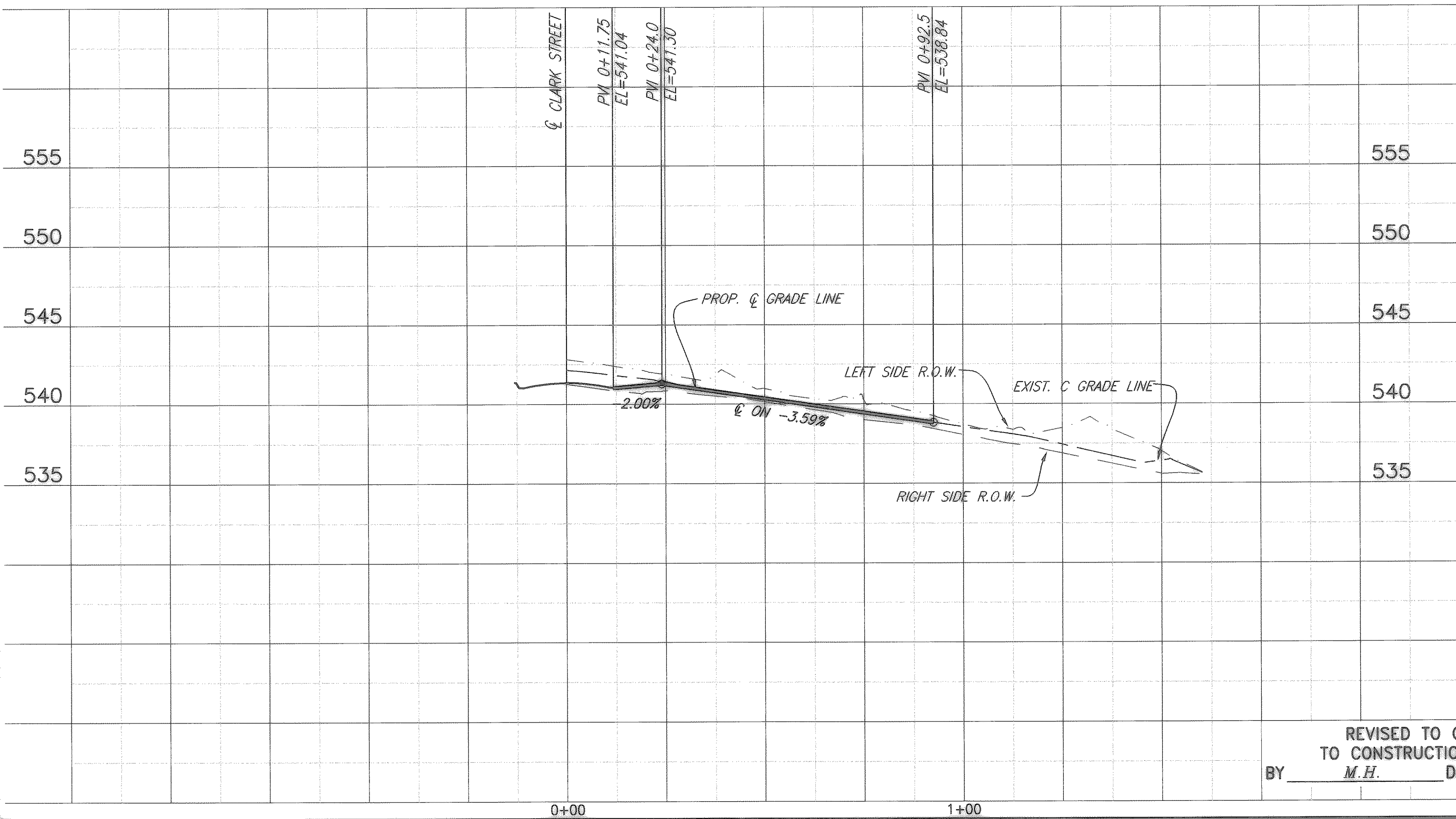

**CITY OF ROCKWALL, TEXAS**

**HARTMAN STREET -PAVING**  
PLAN AND PROFILE  
STA 0+00 TO STA. 0+92.50

**BIRKHOFF, HENDRICKS & CONWAY, L.L.P.**  
CONSULTING ENGINEERS  
Dallas, Texas

DESIGNED BY: M.H. PROJECT: 2003-120 SHEET NO. 26  
DRAWN BY: R.J.L. DATE: AUGUST, 2004 OF X SHEETS

THESE DOCUMENTS ARE FOR BIDDING, CONSTRUCTION, AND PERMIT PURPOSES.  
DATE: 8/20/04

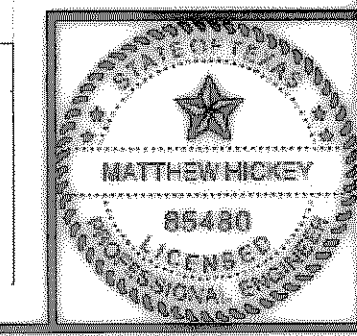

REVISED TO CONFORM TO CONSTRUCTION RECORDS  
BY M.H. DATE 12/04/2006