

8/25/04 R.L.
 H. ROCKWALL \2003120\PLAN-SHEETS\2003120TY-A.DWG
 SCALE: 1"=4'
 BLOCKS: ROCKWALL \2003120\X.DWG
 XREF: ROCKWALL \2003120\X.DWG

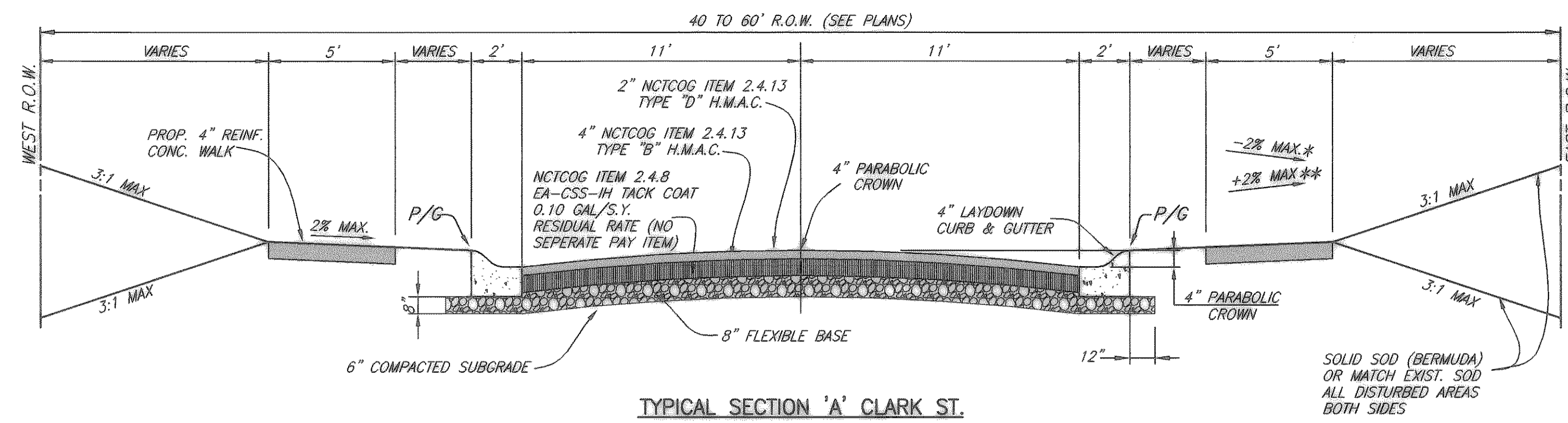

TYPICAL SECTION 'A' CLARK ST.

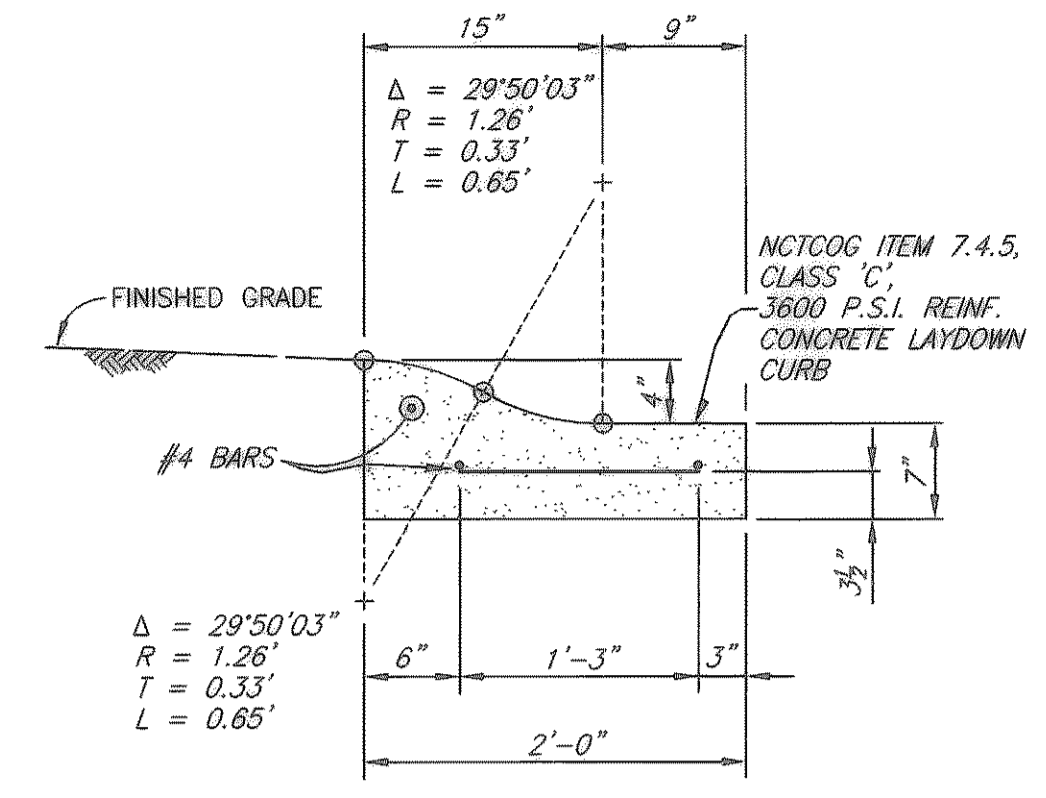

LAYDOWN CURB & GUTTER

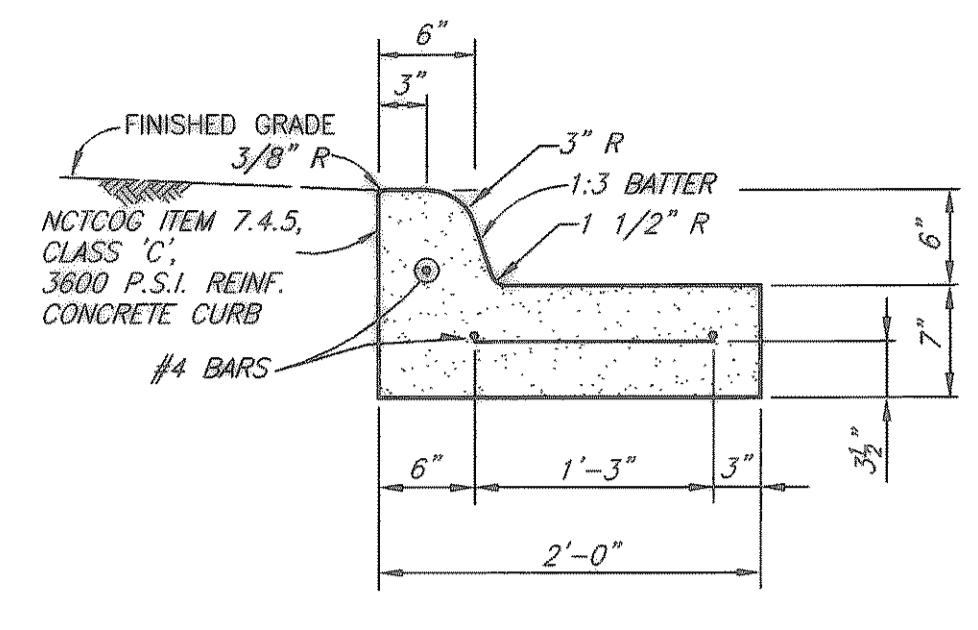

STANDARD CURB & GUTTER

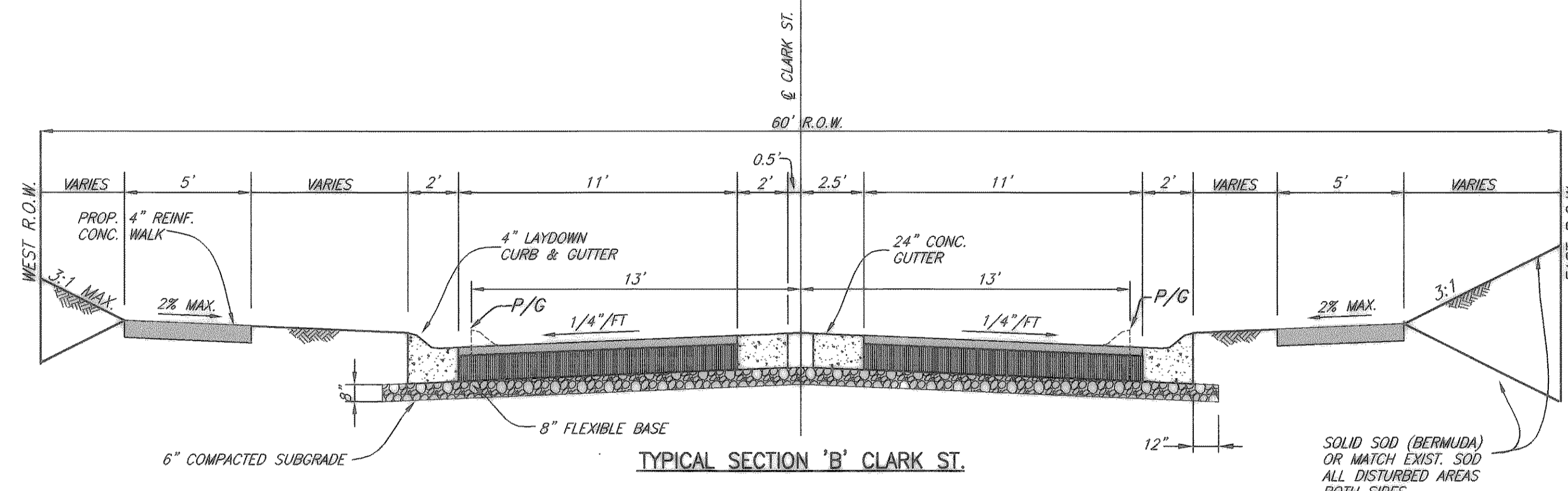

TYPICAL SECTION 'B' CLARK ST.

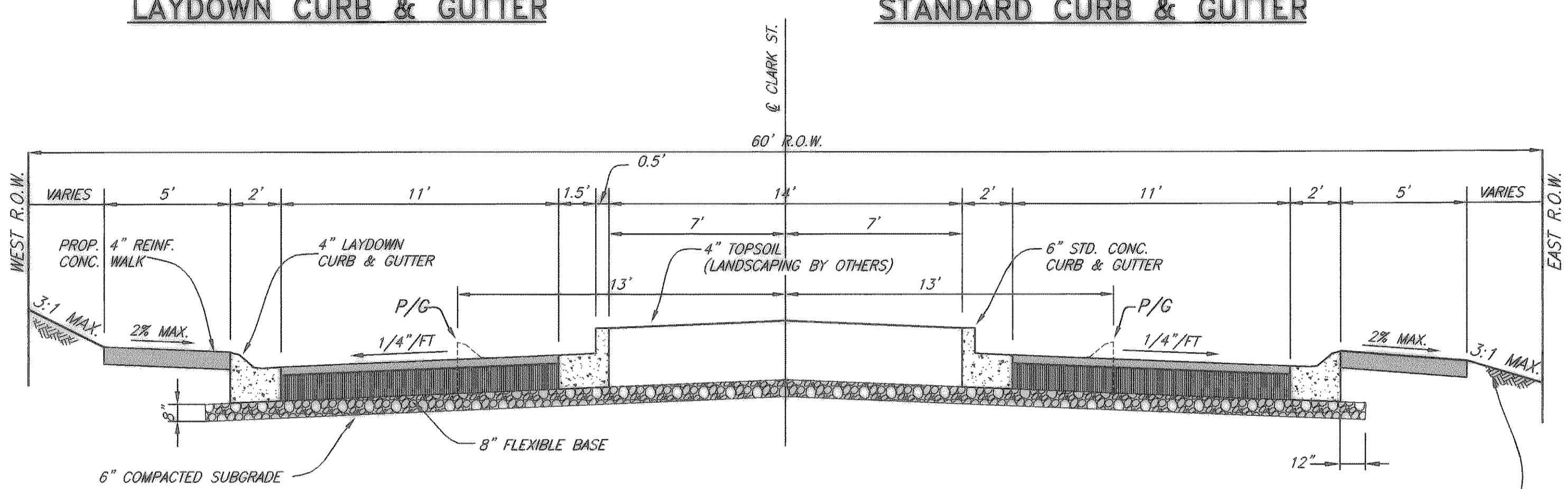

TYPICAL SECTION 'D' CLARK ST.

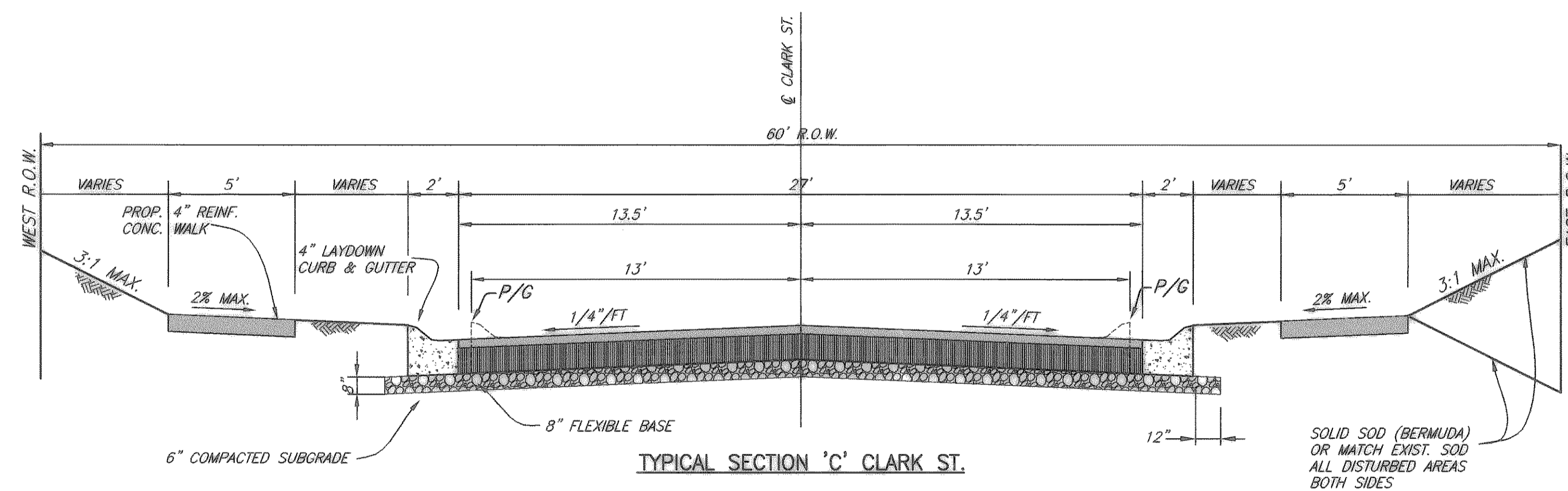

TYPICAL SECTION 'C' CLARK ST.

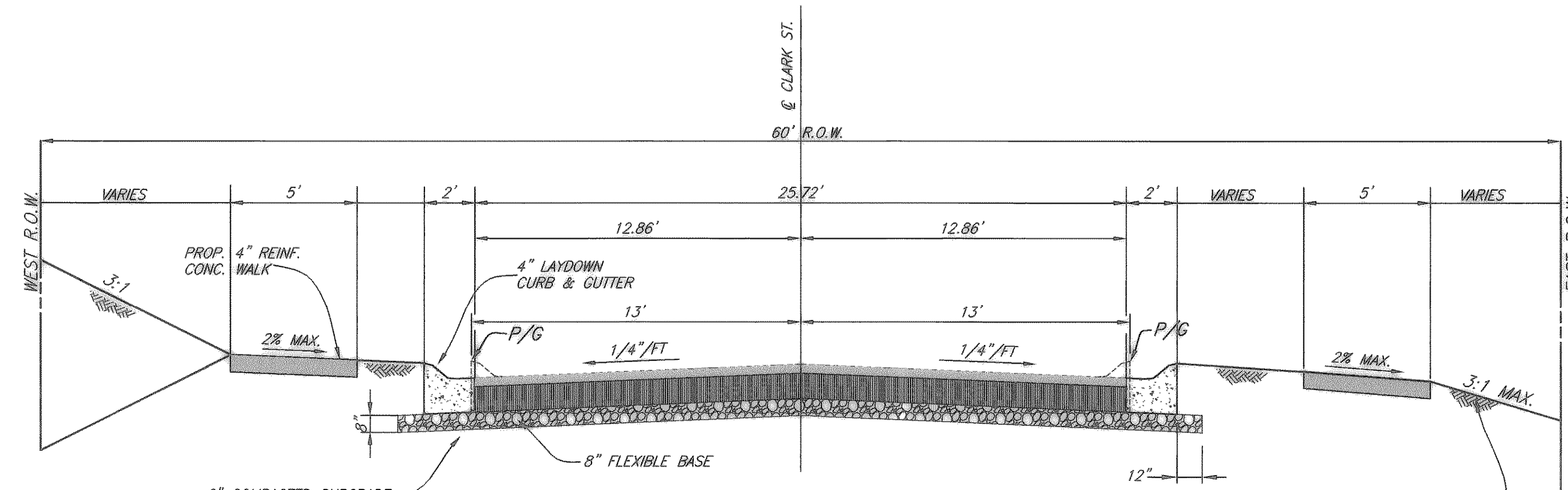

TYPICAL SECTION 'E' CLARK ST.

P/G = PROFILE GRADE

NOTE:

- 1.-8" FLEXIBLE BASE SHALL BE NCTCOG ITEM 2.1.3. (b) (MODIFIED) COMPACTED TO A MINIMUM OF 95% MODIFIED PROCTOR DENSITY (ASTM D1557). THE N.C.T.C.O.G. FLEXIBLE BASE SHALL BE MODIFIED ACCORDING TO THE FOLLOWING
 MODIFIED N.C.T.C.O.G. GRADATION
 PASSING 1-3/4" SIEVE.....100%
 PASSING NO. 4 SIEVE.....35+55%
 PASSING NO. 40 SIEVE.....15+30%
 - 2.-FLEXIBLE BASE SHALL BE ON A 6" COMPACTED SUBGRADE COMPACTED BETWEEN 95 PROCTOR (ASTM D698) AT A MOISTURE CONTENT BETWEEN 0 AND +4% POINTS OF OPTIMUM.
 - 3.-A PRIME COAT SHALL BE REQUIRED BETWEEN THE COMPACTED FLEX BASE AND TYPE B H.M.A.C. AND A TACK COAT SHALL BE REQUIRED BETWEEN THE TYPE B & TYPE D H.M.A.C. NO SEPARATE PAY ITEM WILL BE MADE FOR THE PRIME AND THE TACK COATS.
 - 4.-CONTRACTOR SHALL REFER TO THE STORM WATER POLLUTION PREVENTION PLAN FOR LOCATIONS OF AREAS TO BE SOLID SODDED OR HYDROMULCHED.
- * -2% CROSS SLOPE FROM EAST BACK OF CURB THROUGH EAST EDGE OF PROPOSED SIDEWALK (STA. 5+80 TO 14+60) (STA. 15+00 TO STA. 27+00).
- ** +2% CROSS SLOPE FROM EAST BACK OF CURB THROUGH EAST EDGE OF PROPOSED SIDEWALK (STA. 0+00 TO STA. 5+80) (STA. 11+60 TO 15+00; STA. 27+00 TO 33+70).

These plans and related specifications were prepared for construction of this specific project only. Reuse of these documents is not permitted without written authorization of Birkhoff, Hendricks & Conway, L.L.P.

CITY OF ROCKWALL, TEXAS
 CLARK STREET-STORM SEWER
 TYPICAL SECTIONS

BIRKHOFF, HENDRICKS & CONWAY, L.L.P.
 CONSULTING ENGINEERS
 Dallas, Texas

REVISED TO CONFORM
 TO CONSTRUCTION RECORDS
 BY M.H. DATE 12/04/2006

THESE DOCUMENTS ARE FOR
 BIDDING, CONSTRUCTION,
 AND PERMIT PURPOSES.
 DATE: 1/6/04

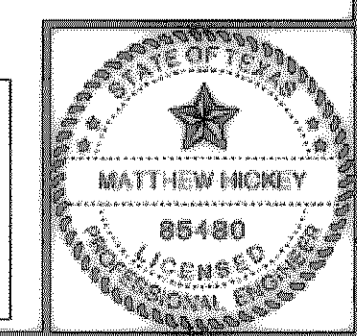

DESIGNED BY: M.H.	PROJECT: 2003-120	SHEET NO. 2
DRAWN BY: B.H.C.	DATE: AUGUST, 2004	OF X SHEETS