

BM #1  
 SQUARE CUT IN CENTER OF HEADWALL (2~10'X10' BOX CULVERT), 1400 FT ± EAST OF S.H. 205 AND 35 FT. ± SOUTH OF CENTERLINE OF FM 276.  
 ELEVATION: 528.02

BM #2  
 SQUARE CUT IN TOP OF HEADWALL ON EAST SIDE OF TOWNSEND DRIVE 30 FT. ± NORTH FROM CENTERLINE OF ACCESS GATE FOR EASTSIDE PUMP STATION (CITY OR ROCKWALL).  
 ELEVATION: 540.14

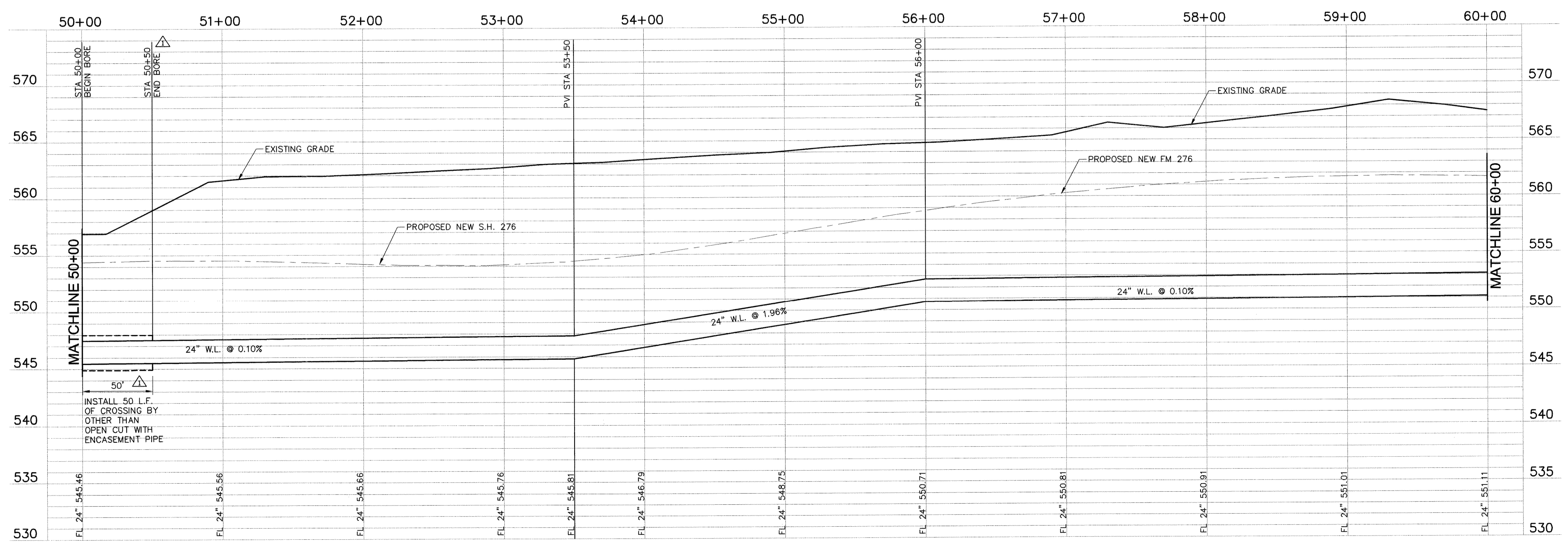

RECORD DRAWING  
 (ALL REVISIONS ARE BASED UPON CITY AND CONTRACTOR NOTES AND COMMENTS)

CITY OF HEATH  
 24" WATER TRANSMISSION LINE - PROJECT "B"  
 STA 50+00 TO 60+00

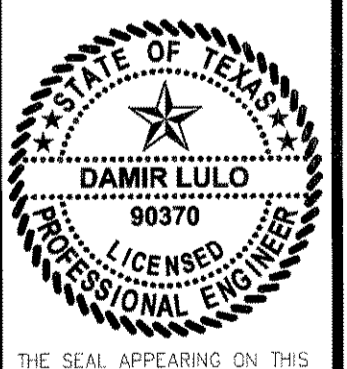

THE SEAL APPEARING ON THIS DOCUMENT WAS AUTHORIZED BY DAMIR LULO, P.E. NO. 90370 ON 1/12/04

SCALE: 1" = 40'  
 1" = 5'  
 IF SHEET IS IN 11"X17" FORMAT, DIMENSIONS ARE AT 1/2 OF NOTED SCALE.

PROJECT No.: 02150  
 DATE: JAN 2004  
 DESIGNED: DL  
 DRAWN: FMI  
 CHECKED: JTM

SHEET  
**B6**  
 TOTAL SHEETS: 27

BY: \_\_\_\_\_  
 DATE: \_\_\_\_\_  
 REVISION: \_\_\_\_\_  
 No. \_\_\_\_\_

**FREEMAN-MILLICAN, Inc.**  
 ENGINEERS - ARCHITECTS - PLANNERS  
 9600 FOREST LN. DALLAS, TX 75243-5055