

NOTE:  
ALL PROPOSED DRIVE APPROACHES SHALL BE 12' WIDE & EXTENDED TO ROW. LANE EXCEPT AS NOTED ON PLANS. DRIVES SHALL BE CONSTRUCTED OF 6" 3000 P.S.I. CONCRETE REINFORCED W/ #3 BARS 24" O.C. BOTH WAYS.

NOTE:  
ALL RADIUS ON DRIVES WILL BE 5' EXCEPT AS NOTED ON PLANS.

NOTE:  
ALL UNDERGROUND UTILITIES TO BE RELOCATED OR ADJUSTED TO NEW PAVEMENT OR PARKWAY GRADE PRIOR TO ANY PAVEMENT CONSTRUCTION.

NOTE:  
ALL EXISTING DRAINAGE PIPES TO BE REMOVED & SALVAGED EXCEPT AS NOTED ON THE STORM SEWER DESIGN PLANS.

NOTE:  
POWER POLES & TELEPHONE BOXES TO BE RELOCATED BY OTHERS PRIOR TO CONSTRUCTION.

NOTE:  
ALL CONSTRUCTION SHALL MEET CITY OF ROCKWALL SPECIFICATIONS.

NOTE:  
EXISTING ASPHALT PAVEMENT SHALL REMAIN IN PLACE EXCEPT AS NOTED ON PLANS.

NOTE:  
STREET CONSTRUCTION - 24" CURB & GUTTER 3000 P.S.I. CONCRETE (6" HIGH CURB) W/ 5" LAMBS SURFACE COURSE BETWEEN PROP. GUTTER & EXIST. PAVEMENT OR 6" STABILIZED LIME SUBGRADE W/ 2 MIL. OF 7% LIME.

**LEGEND:**

- POWER POLE
- TELEPHONE BOX
- TELEPHONE M.H.
- GAS METER
- FIRE HYDRANT
- WATER METER
- WATER VALVE
- SEWER M.H.

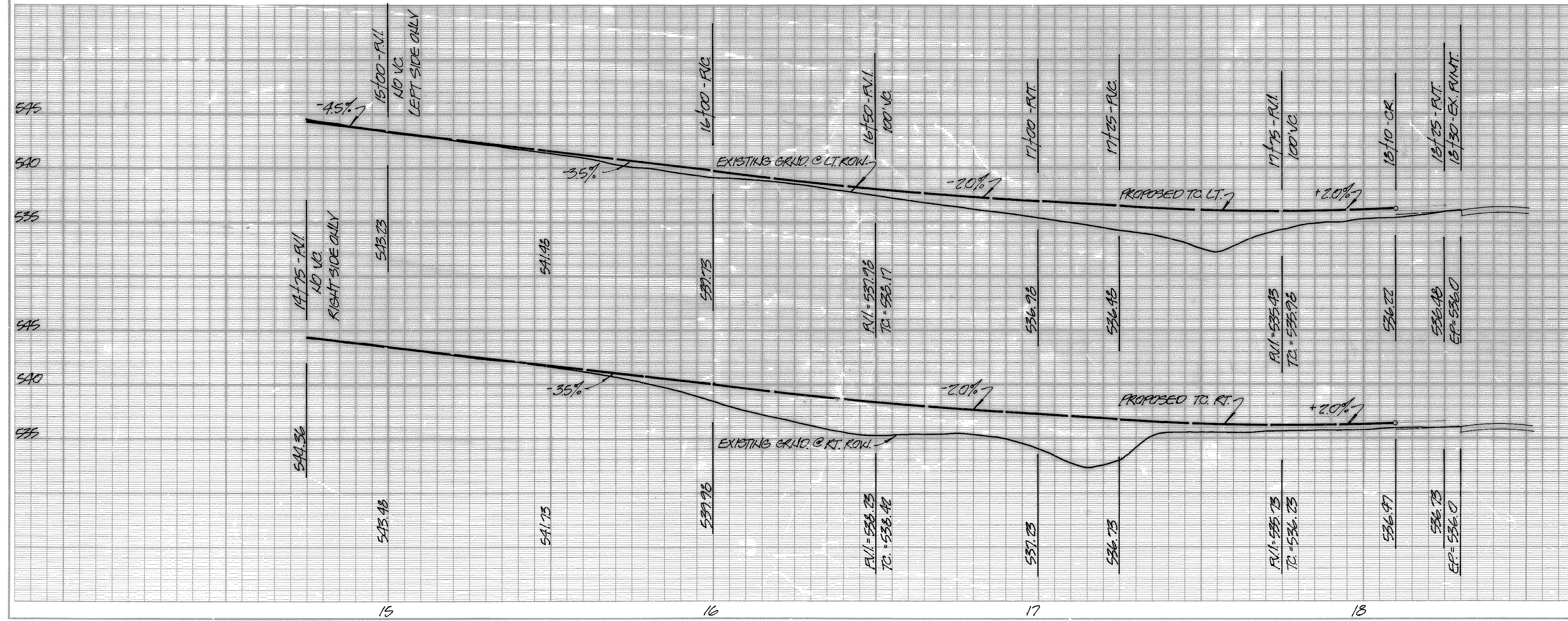
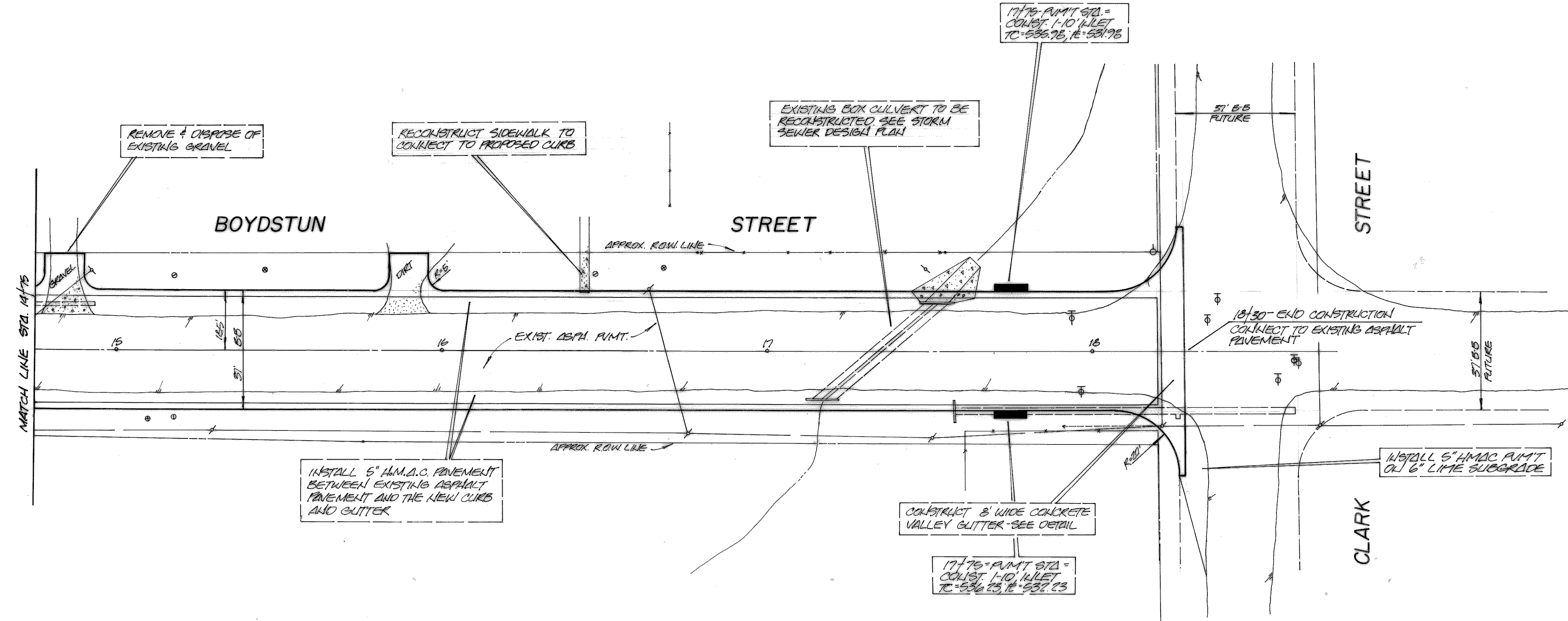

BENCH MARK:  
SET NAIL IN 7th PP. W. OF BOYDSTON & W. OF COLIAD  
ELEV. = 539.81

SCALE: 1" = 20' H.  
1" = 6' V.

REVISION NO.	REMARKS	DATE
<b>PAVING IMPROVEMENTS</b> BOYDSTON STREET		
CITY OF ROCKWALL, TEXAS 205 W. RUSK STREET 214-722-1111		
DESIGNED: W.L.D.	SCALE: NOTED	
DRAWN: W.L.D.	APPROVED: <i>[Signature]</i>	
JOB NO. 87001	DATE: 3-87	SHEET NO. 14