

NOTE: ALL PROPOSED DRIVE APPROACHES SHALL BE 12' WIDE & EXTENDED TO ROW LINE EXCEPT AS NOTED ON PLANS. DRIVES SHALL BE CONSTRUCTED OF 6" 3000 P.S.I. CONCRETE REINFORCED W/ #5 BARS 24" O.C. BOTH WAYS

NOTE: ALL RADIUS ON DRIVES WILL BE 5' EXCEPT AS NOTED ON PLANS

NOTE: ALL UNDERGROUND UTILITIES TO BE RELOCATED OR ADJUSTED TO NEW PAVEMENT OR PARKWAY GRADE. PRIOR TO ANY PAVEMENT CONSTRUCTION

NOTE: ALL EXISTING DRAINAGE PIPES TO BE REMOVED & SALVAGED EXCEPT AS NOTED ON THE STORM SEWER DESIGN PLANS.

NOTE: POWER POLES & TELEPHONE BOXES TO BE RELOCATED BY OTHERS PRIOR TO CONSTRUCTION

NOTE: ALL CONSTRUCTION SHALL MEET CITY OF ROCKWALL SPECIFICATIONS

NOTE: CONTRACTOR SHALL MAINTAIN ONE LANE REMAINING OPEN FOR TRAFFIC AT ALL TIMES

NOTE: EXISTING ASPHALT PAVEMENT SHALL REMAIN IN PLACE EXCEPT AS NOTED ON PLANS

NOTE: STREET CONSTRUCTION - 24" CURB & GUTTER (3000 P.S.I. CONCRETE w/ 6" HIGH CURB) w/ 5" H.M.A.C. SURFACE COURSE BETWEEN PROPOSED GUTTER & EXIST. PAVEMENT ON 6" STABILIZED LIME SUBGRADE w/ 4 MIN. OF 7% LIME.

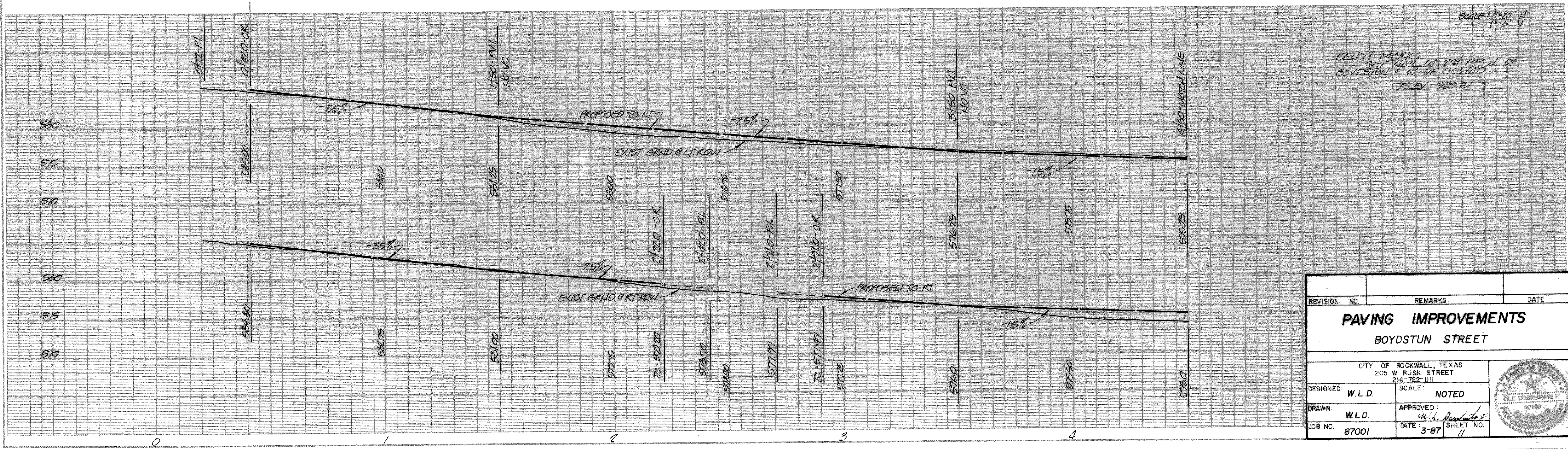
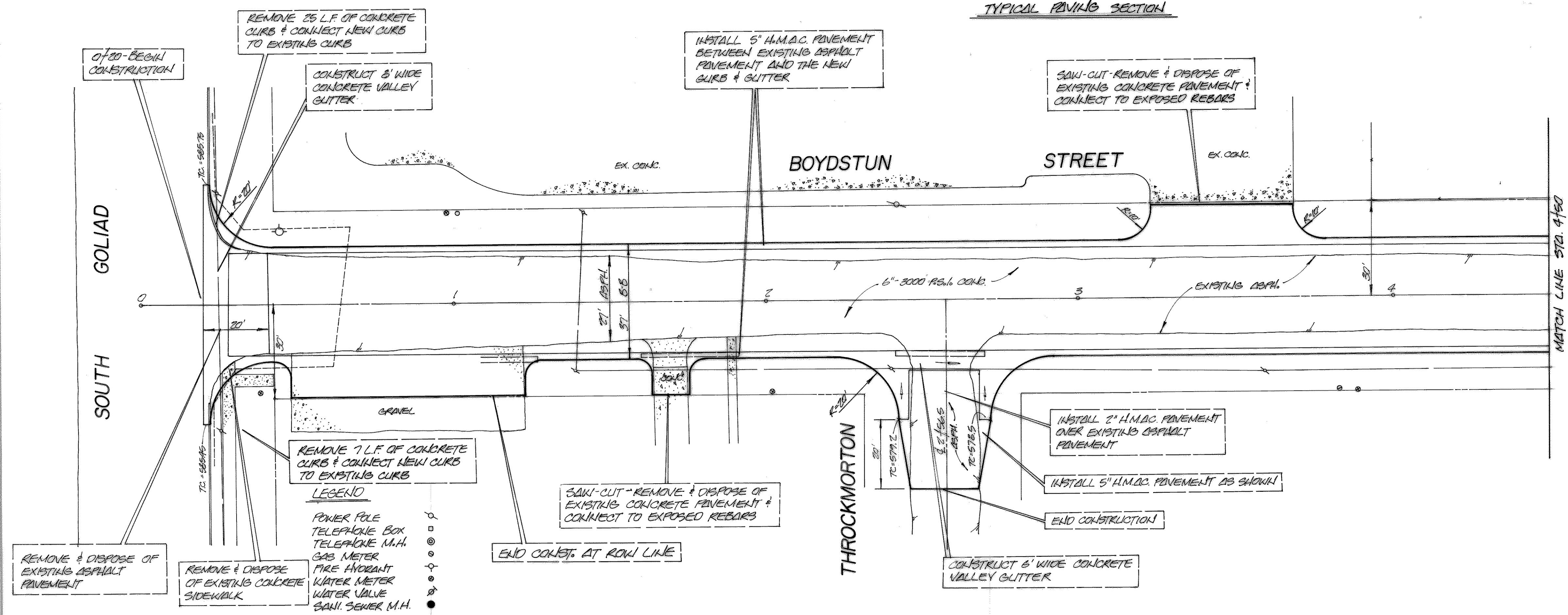

REVISION NO.	REMARKS	DATE
<b>PAVING IMPROVEMENTS</b> BOYDSTUN STREET		
CITY OF ROCKWALL, TEXAS 205 W RUSK STREET 214-782-1111		
DESIGNED: W.L.D.	SCALE: NOTED	
DRAWN: W.L.D.	APPROVED: <i>W.L. Dougherty</i>	
JOB NO. 87001	DATE 3-87	SHEET NO. 11