

- NOTE: CONTRACTOR SHALL MAINTAIN ONE LANE OF TRAFFIC FLOW AT ALL TIMES
- NOTE: CONTRACTOR TO LOCATE & VERIFY ALL EXISTING UTILITIES PRIOR TO CONSTRUCTION
- NOTE: ALL UTILITY CONSTRUCTION SHALL MEET CITY OF ROCKWALL SPECIFICATIONS
- NOTE: RECONNECT ALL EXISTING SANI. SEWER LATERALS TO PROPOSED 6" R.V.C. SEWER MAIN
- NOTE: CONTRACTOR TO LOCATE & VERIFY ELEVATIONS OF EXISTING SEWER MAINS PRIOR TO CONSTRUCTION

LEGEND
 POWER POLE
 TELEPHONE BOX
 TELEPHONE M.H.
 GAS METER
 FIRE HYDRANT
 WATER METER
 WATER VALVE
 SANI SEWER M.H.

PLUG EXISTING 4" CLAY MAIN IN M.H. AFTER COMPLETION OF PROPOSED 6" R.V.C. MAIN

PLUG EXISTING 4" CLAY MAIN IN M.H. AFTER COMPLETION OF PROPOSED 6" R.V.C. MAIN

BENCH MARK SET IN W. OF BOYDSTUN & N. OF COLLIS ELEV. = 559.91

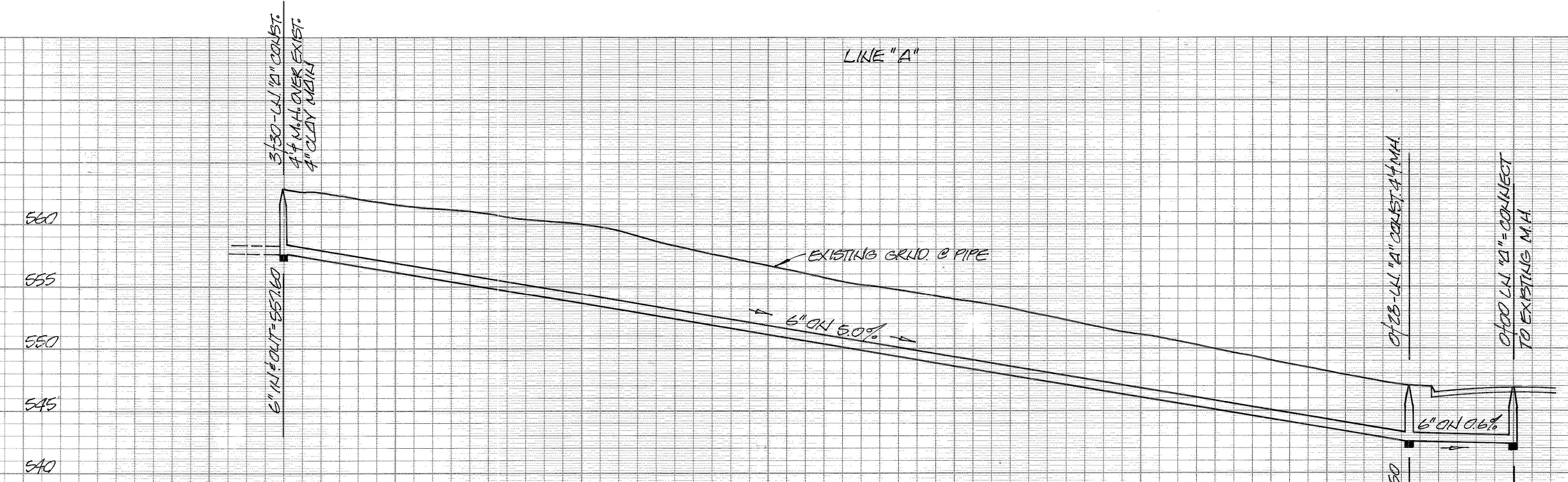

REVISION NO.	REMARKS	DATE
UTILITY IMPROVEMENTS BOYDSTUN STREET		
CITY OF ROCKWALL, TEXAS 205 W. RUSK STREET 214-722-1111		
DESIGNED: W.L.D.	SCALE: NOTED	
DRAWN: W.L.D.	APPROVED: <i>W.L. Doughter</i>	
JOB NO. 87001	DATE 3-87	SHEET NO. 17

