

**LINE "B"**

SCALE : 1" = 20' HORZ  
1" = 2.5' VERT.

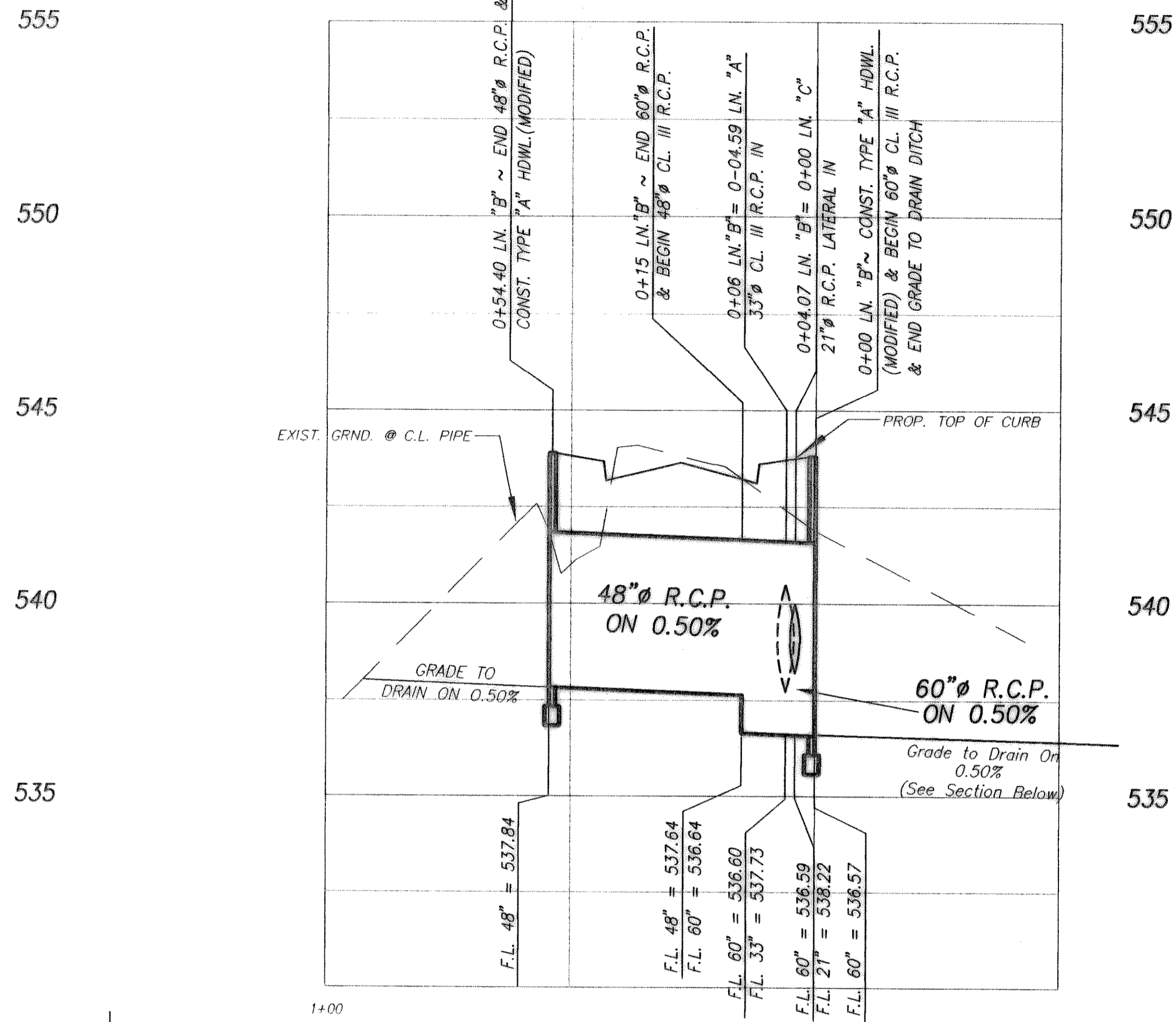

**LINE "C"**

SCALE : 1" = 20' HORZ  
1" = 2.5' VERT.

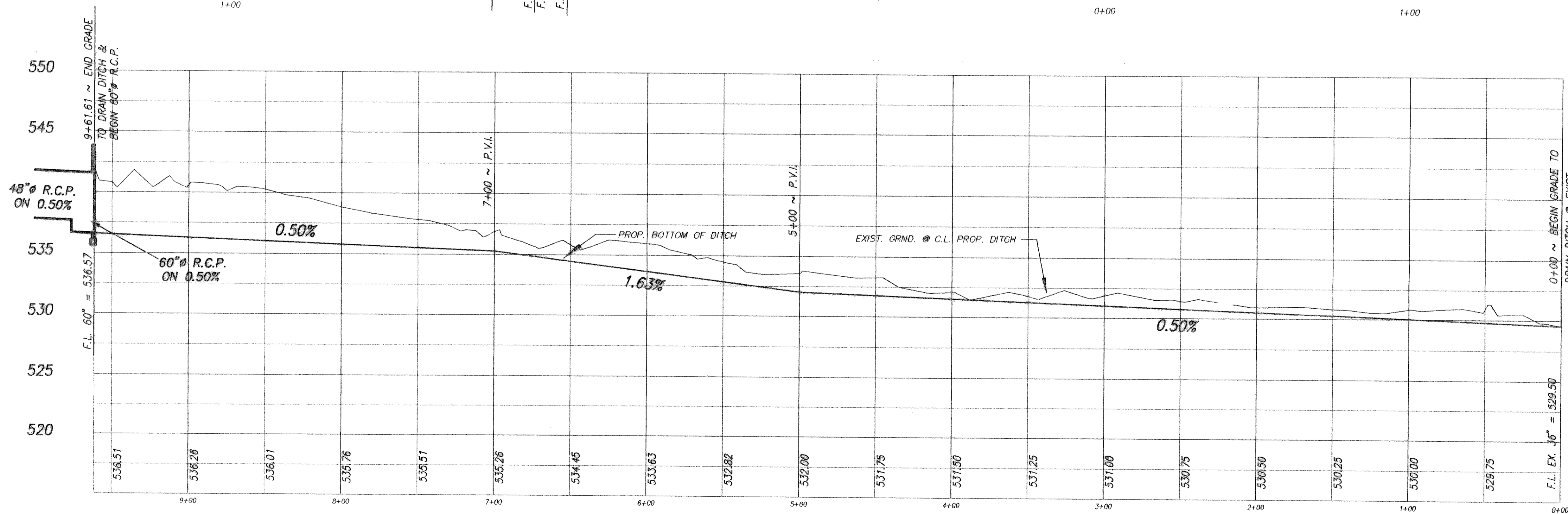
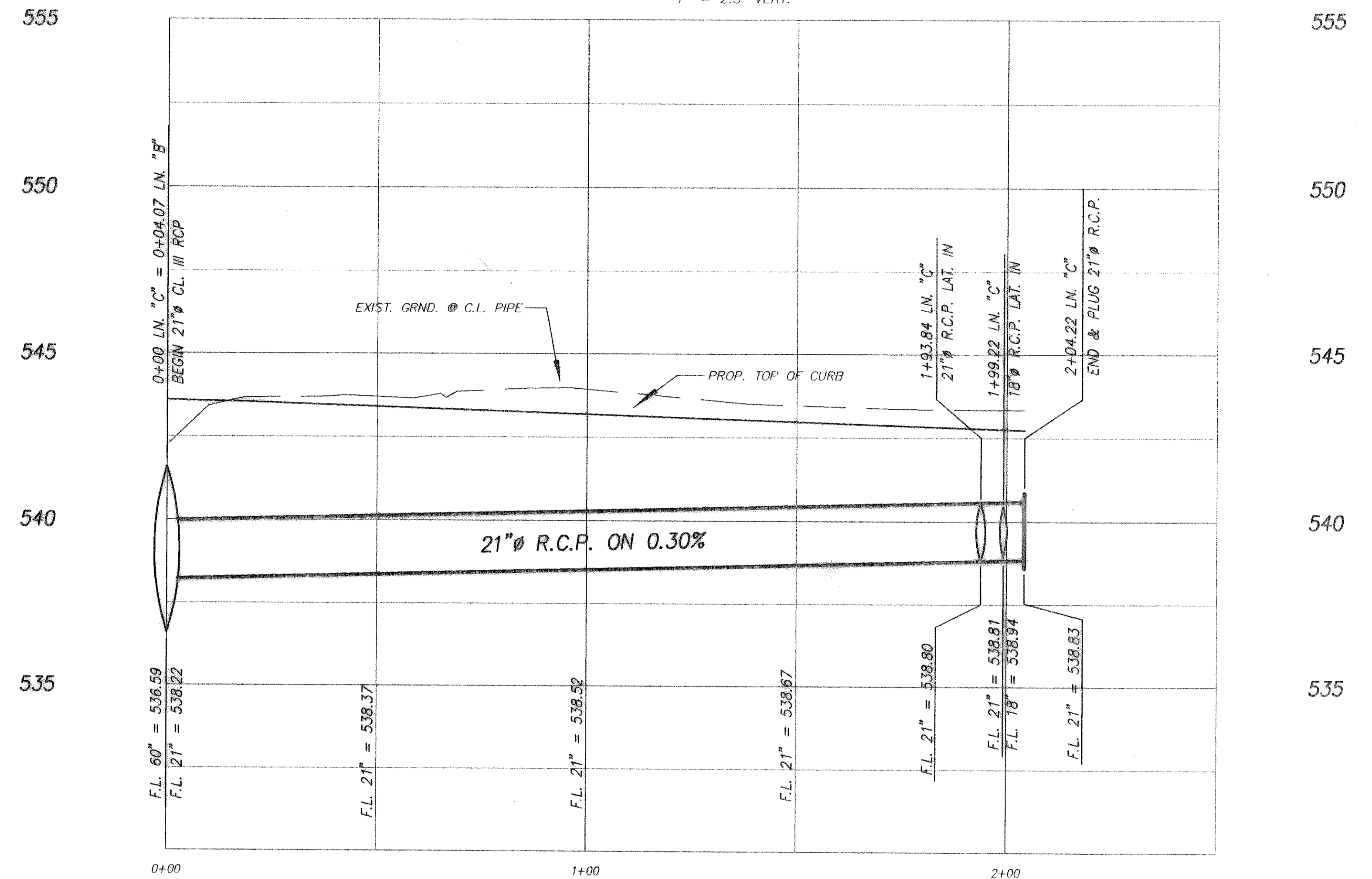

SCALE : 1" = 40' HORZ  
1" = 5' VERT.

B.M. NO. 1 ~ 60D NAIL SET IN POWER POLE ON THE EAST SIDE OF THROCKMORTON & APPROX. 141.4 FEET NORTH OF CENTER INTERSECTION OF BOURN & THROCKMORTON. ELEV. = 574.10

B.M. NO. 2 ~ 60D NAIL SET IN POWER POLE ON THE SOUTH SIDE OF BOURN STREET & APPROX. 232.3 FEET EAST OF CENTER INTERSECTION OF PETERS COLONY & BOURN STREET. ELEV. = 551.50

**STORM DRAINAGE PROFILES**  
**BOURN STREET**  
**ROCKWALL, TEXAS**  
**CITY OF ROCKWALL**  
"THE NEW HORIZON"

REVISION NO.	REMARKS	DATE

DESIGNED: B.W.H.  
DRAWN: ACAD  
JOB NO. 60102 ON 10/0/96  
DATE: 5/15/96  
SHEET NO. 17 of 28

