

- LEGEND**
- POWER POLE
  - TELEPHONE BOX
  - TELEPHONE M.H.
  - GAS METER
  - FIRE HYDRANT
  - WATER METER
  - WATER VALVE
  - SEWER M.H.

CV#1  
 $\Delta = 26^{\circ}45'00''$   
 $R = 150.0'$   
 $T = 35.66'$   
 $L = 70.03'$

CV#2  
 $\Delta = 26^{\circ}45'00''$   
 $R = 150.0'$   
 $T = 35.66'$   
 $L = 70.03'$

- NOTE:** CONTRACTOR SHALL MAINTAIN ONE LANE OF TRAFFIC FLOW AT ALL TIMES
- NOTE:** RECONNECT ALL EXISTING SEWER LATERALS TO PROPOSED 6" R.V.C. SEWER MAIN
- NOTE:** CONTRACTOR TO LOCATE & VERIFY ALL EXISTING UTILITIES PRIOR TO CONSTRUCTION
- NOTE:** CONTRACTOR TO LOCATE & VERIFY ELEVATION OF EXISTING SEWER MAINS PRIOR TO CONSTRUCTION
- NOTE:** ALL UTILITY CONSTRUCTION SHALL MEET CITY OF ROCKWALL SPECIFICATIONS

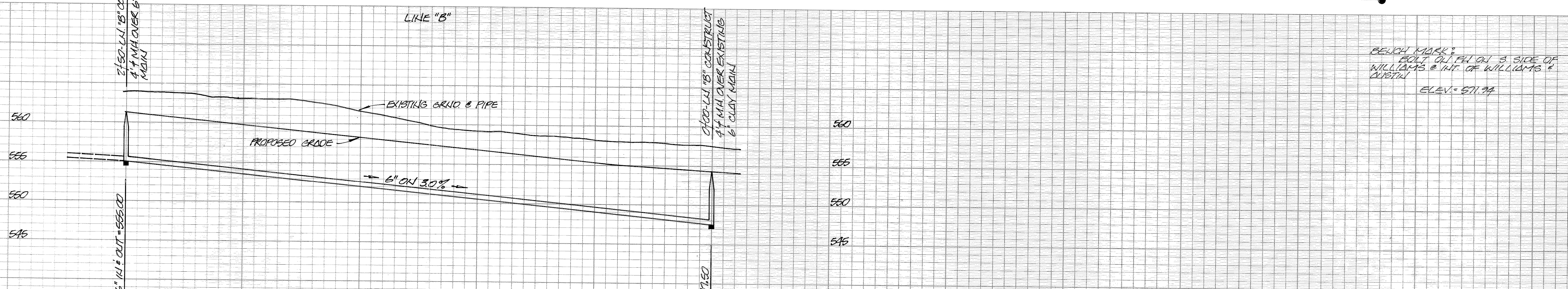

**BENCH MARK:**  
 BOLT ON FH ON S. SIDE OF WILLIAMS & INT. OF WILLIAMS & AUSTIN  
 ELEV. = 571.94

REVISION NO.	REMARKS	DATE
<b>UTILITY IMPROVEMENTS</b> AUSTIN STREET		
CITY OF ROCKWALL, TEXAS 205 W. RUSK STREET 214-722-1111		
DESIGNED: W.L.D.	SCALE: NOTED	
DRAWN: W.L.D.	APPROVED: <i>W.L. Douphrate</i>	
JOB NO. 87004	DATE 3-87	40

