

NOTE: ALL PROPOSED DRIVE APPROACHES SHALL BE 12' WIDE & EXTENDED TO ROW LINE EXCEPT AS NOTED ON PLANS. DRIVE SHALL BE CONSTRUCTED OF 6" 3000 P.S.I. CONCRETE REINFORCED W/ #3 BARS 24" O.C. BOTH WAYS

NOTE: ALL RADI ON DRIVE WILL BE 5' EXCEPT AS NOTED ON PLANS

NOTE: ALL UNDERGROUND UTILITIES TO BE RELOCATED OR ADJUSTED TO NEW PAVEMENT OR PARKWAY GRADE PRIOR TO ANY PAVEMENT CONSTRUCTION.

NOTE: ALL EXISTING DRAINAGE PIPES TO BE REMOVED & SOLICIDED EXCEPT AS NOTED ON THE STORM SEWER DESIGN PLANS.

NOTE: POWER POLES & TELEPHONE BOXES TO BE RELOCATED BY OTHERS PRIOR TO CONSTRUCTION

NOTE: ALL CONSTRUCTION SHALL MEET CITY OF ROCKWALL SPECIFICATIONS

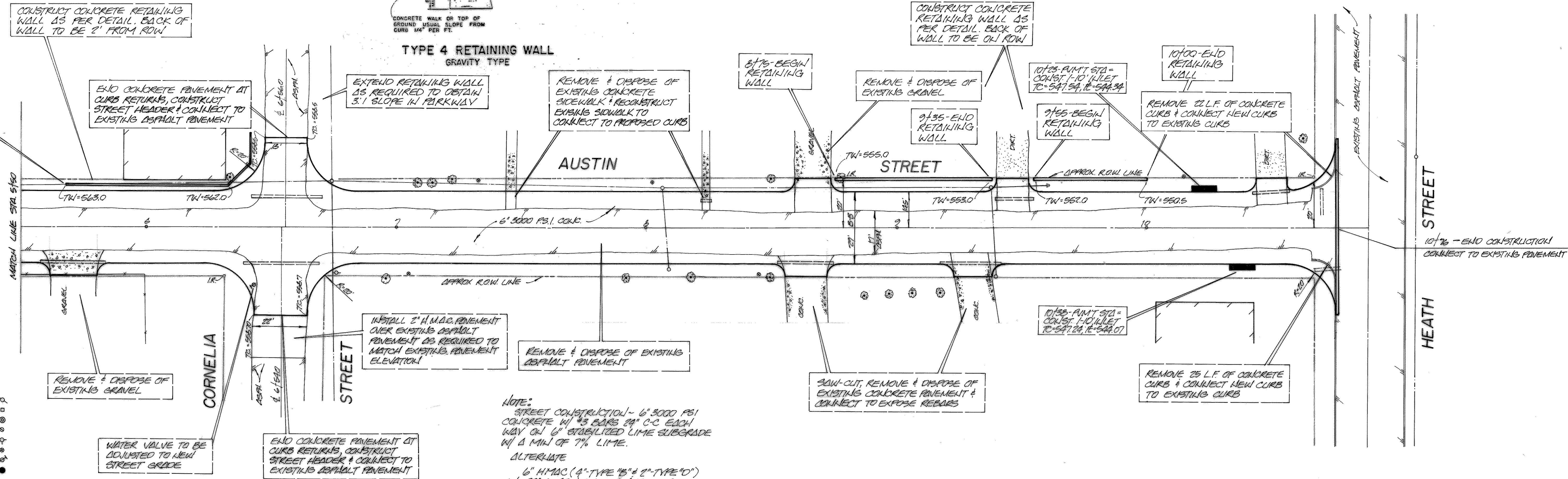

LEGEND

POWER POLE
TELEPHONE BOX
TELEPHONE M.H.
GAS METER
FIRE HYDRANT
WATER METER
WATER VALVE
STORM SEWER M.H.

NOTE: STREET CONSTRUCTION - 6" 3000 P.S.I. CONCRETE W/ #3 BARS 24" O.C. EACH WAY ON 6" STABILIZED LIME SUBGRADE W/ A MIN. OF 7% LIME.

ALTERNATE
6" H.M.A.C. (4" TYPE "B" & 2" TYPE "D") W/ 24" CURB & GUTTER (3000 P.S.I. CONCRETE - 6" HIGH CURB) ON 8" OF STABILIZED LIME SUBGRADE W/ A MIN. OF 8% LIME.

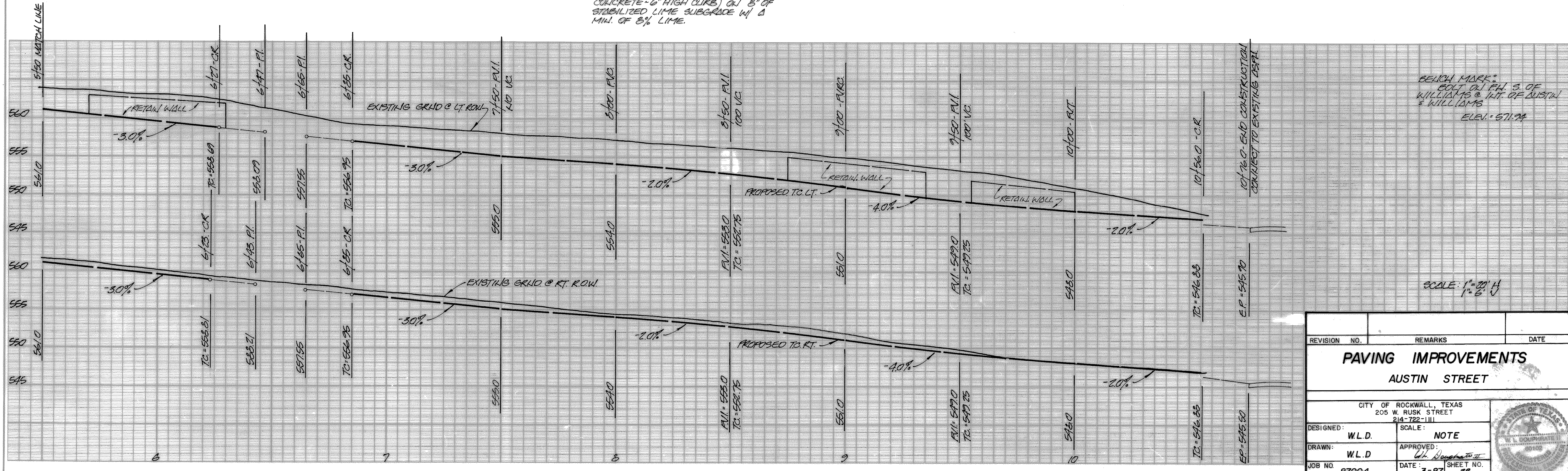

REVISION NO.	REMARKS	DATE
PAVING IMPROVEMENTS		
AUSTIN STREET		
CITY OF ROCKWALL, TEXAS 205 W. RUSK STREET 214-722-1111		
DESIGNED: W.L.D.	SCALE: NOTE	
DRAWN: W.L.D.	APPROVED: <i>W.L.D.</i>	
JOB NO. 87004	DATE 3-87 SHEET NO. 38	