

NOTE:
ALL PROPOSED DRIVE APPROACHES SHALL BE 12' WIDE & EXTENDED TO ROW LINE EXCEPT AS NOTED ON PLANS. DRIVES SHALL BE CONSTRUCTED OF 6" 3000 P.S.I. CONCRETE REINFORCED W/ #5 BARS 24" O.C. BOTH WAYS

NOTE:
ALL RATCH ON DRIVE WILL BE 5' EXCEPT AS NOTED ON PLANS

NOTE:
ALL UNDERGROUND UTILITIES TO BE RELOCATED OR ADJUSTED TO NEW PAVEMENT OR PARKWAY GRADE PRIOR TO ANY PAVEMENT CONSTRUCTION.

NOTE:
ALL EXISTING DRAINAGE PIPES TO BE REMOVED & SALVAGED EXCEPT AS NOTED ON THE STORM SEWER DESIGN PLANS.

NOTE:
POWER POLES & TELEPHONE BOXES TO BE RELOCATED BY OTHERS PRIOR TO CONSTRUCTION

NOTE:
ALL CONSTRUCTION SHALL MEET CITY OF ROCKWALL SPECIFICATIONS

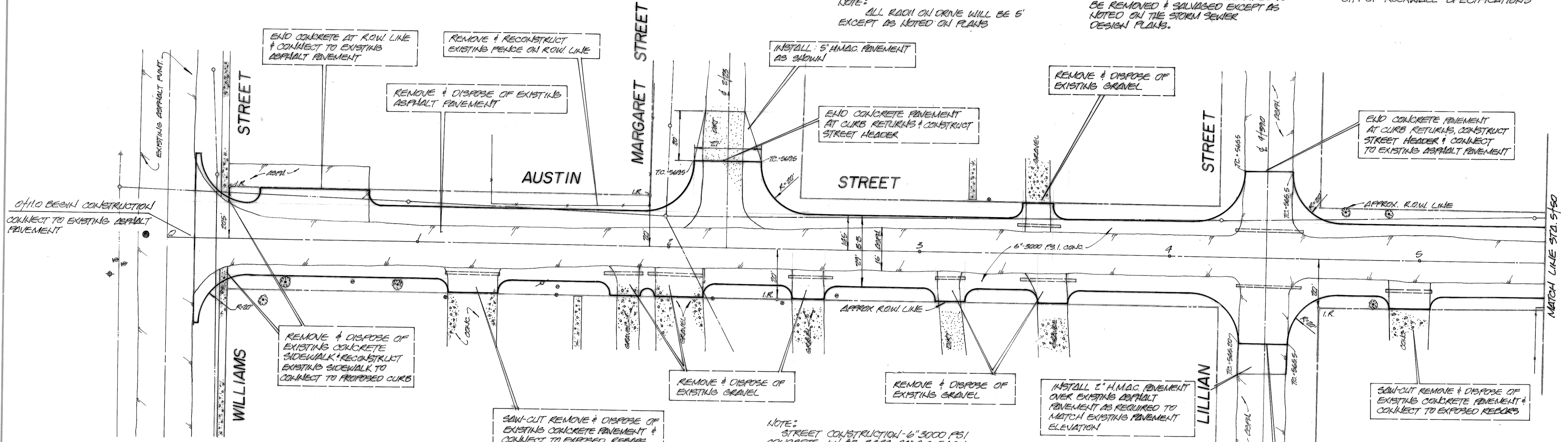

- LEGEND**
- POWER POLE
 - TELEPHONE BOX
 - TELEPHONE M.H.
 - GAS METER
 - FIRE HYDRANT
 - WATER METER
 - WATER VALVE
 - SEWER M.H.

NOTE:
STREET CONSTRUCTION - 6" 3000 PSI CONCRETE W/ #5 BARS 24" O.C. EACH WAY ON 6" STABILIZED LIME SUBGRADE W/ 3 MIN. OF 7% LIME

ALTERLITE - 6" H.M.A.C. (4" TYPE "B" & 2" TYPE "D") W/ 24" CURB & GUTTER (3000 PSI CONCRETE - 6" HIGH CURB) ON 8" STABILIZED LIME SUBGRADE W/ 3 MIN. OF 8% LIME.

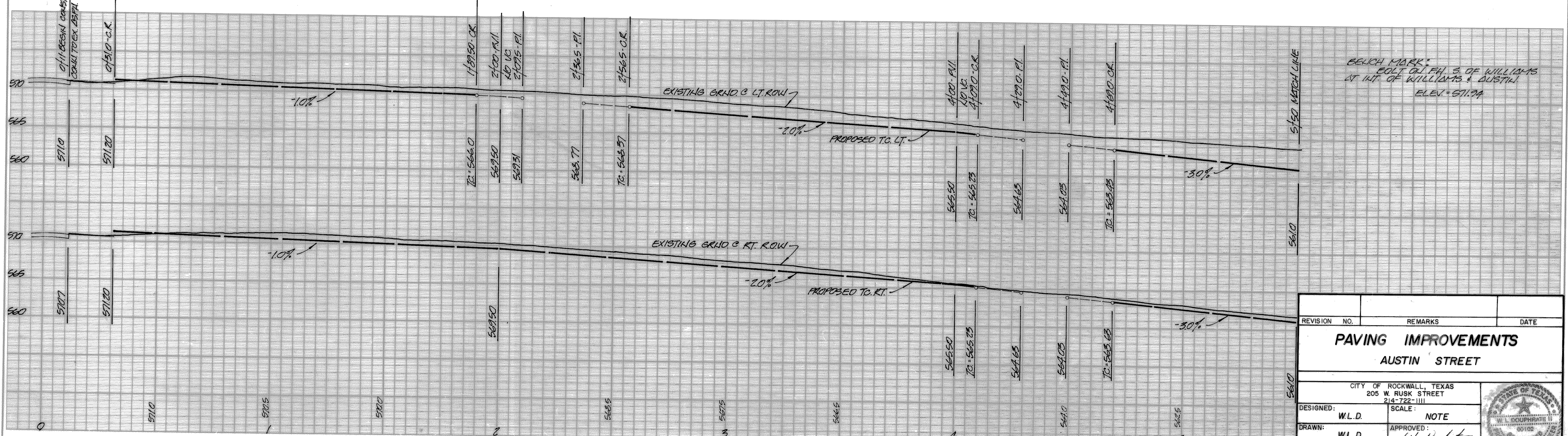

REVISION NO.	REMARKS	DATE
PAVING IMPROVEMENTS AUSTIN STREET		
CITY OF ROCKWALL, TEXAS 205 W. RUSK STREET 214-722-1111		
DESIGNED: W.L.D.	SCALE: NOTE	
DRAWN: W.L.D.	APPROVED: <i>W.L. Douphrate II</i>	
JOB NO. 87004	DATE: 3-87	SHEET NO. 37