

\\usdallfp002\PM\4328\Airport-Road\CADD\Sheet\Airport-Road\_Record Drawings\_8-3-10\10\_TCF\_04.dgn  
8/7/2012

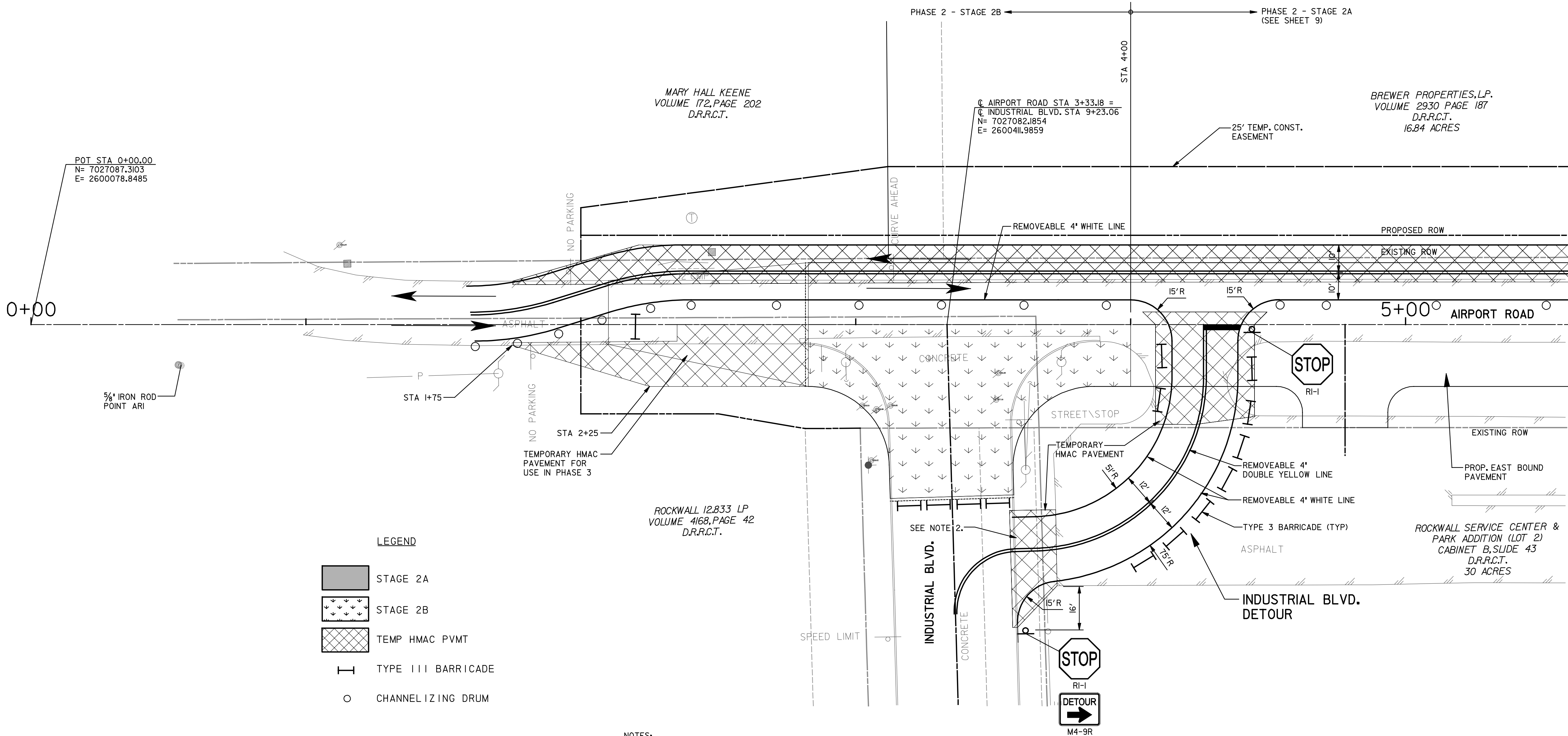

NOTES:

1. CONSTRUCT DETOUR AND SHIFT TRAFFIC OVER TO DETOUR BEFORE BEGINNING PHASE 2 - STAGE 2B CONSTRUCTION.
2. REMOVE 43 LF OF CURB ON INDUSTRIAL BLVD. FOR DETOUR CONNECTION. REPLACE THE CURB & GUTTER AFTER DETOUR IS NO LONGER REQUIRED AND THE TEMPORARY PAVEMENT FOR THE DETOUR HAS BEEN REMOVED. RESTORE PARKWAY TO ORIGINAL CONDITION.
3. AFTER DETOUR HAS BEEN REMOVED, REPAIR EXISTING PARKING LOT AS REQUIRED TO RESTORE PAVEMENT TO ORIGINAL OR BETTER CONDITION. USE PAVEMENT SECTION SHOWN FOR PARKING LOT MODIFICATIONS ON SHEET 16 FOR ALL PATCHING WORK.

RECORD DRAWING

This drawing is a compilation of the original sealed engineering drawing and modifications by addenda, change orders and information furnished by the contractor. Information shown that was provided by the contractor and others not associated with the design engineer cannot be verified for accuracy or completeness. Original sealed drawing is on file at the office of AECOM Technical Services, Inc., TBPE REG. NO. F-3580

ORIGINAL DRAWING  
SEALED & SIGNED BY

T.H. Gaertner, P.E.

TX NO. 37124

NO.	REVISION	BY	DATE
AIRPORT ROAD			
PHASING & TRAFFIC CONTROL PLAN CONSTRUCTION PHASE 2 - STAGE 2B DETOUR			
City of Rockwall, Texas			
AECOM			
AECOM TECHNICAL SERVICES, INC. 16000 DALLAS PARKWAY, SUITE 350 DALLAS TEXAS 75248 WWW.AECOM.COM TBPE REG. NO. F-3580			
Unit	PW-DAL	Scales HORIZ AS SHOWN VERT AS SHOWN	Date 8/2/2012
Designed	THG	Checked THG	Project No. 60004153
Drawn	JJ	Approved THG	Sheet 10 of 26