

\\usdall1fp002\PM\4328\A\Report-Road\CADD\Sheet\A\Airport-Road_Record Drawings_8-3-10\06_Advance Warning.dgn
8/7/2012

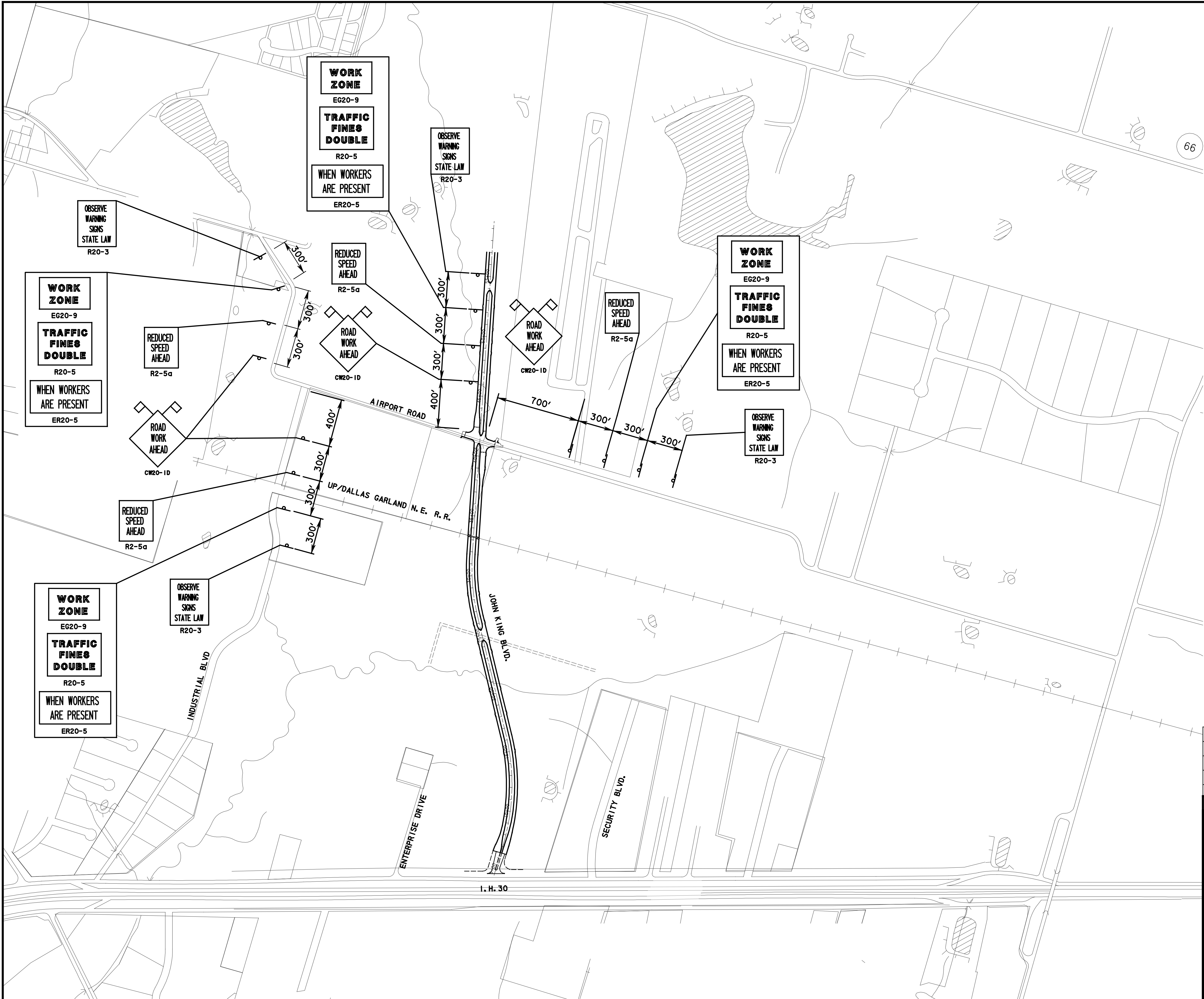

RECORD DRAWING
This drawing is a compilation of the original sealed engineering drawing and modifications by addenda, change orders and information furnished by the contractor. Information shown that was provided by the contractor and others not associated with the design engineer cannot be verified for accuracy or completeness. Original sealed drawing is on file at the office of AECOM Technical Services, Inc., TBPE REG. NO. F-3580

ORIGINAL DRAWING
SEALED & SIGNED BY
T.H. Gaertner, P.E.
TX NO. 37124

NO.	REVISION	BY	DATE

AIRPORT ROAD

ADVANCE WARNING SIGNS LAYOUT



AECOM
AECOM TECHNICAL SERVICES, INC.
16000 DALLAS PARKWAY, SUITE 350
DALLAS TEXAS 75248
WWW.AECOM.COM
TBPE REG. NO. F-3580

Unit	PW-DAL	Scales	Horz AS SHOWN Vert AS SHOWN	Date	8/2/2012
Designed	THG	Checked	THG	Project No.	60004153
Drawn	FG	Approved	THG	Sheet	6 of 26