

PLAN SURVEYED BY DATE
 PLOTTED BY
 NOTE BOOK NO. CHECKED BY
 RT. OF WAY CHECKED BY

PROFILE SURVEYED BY DATE
 PLOTTED BY
 NOTE BOOK NO. CHECKED BY
 STRUCTURE NOTATIONS CH-7-D

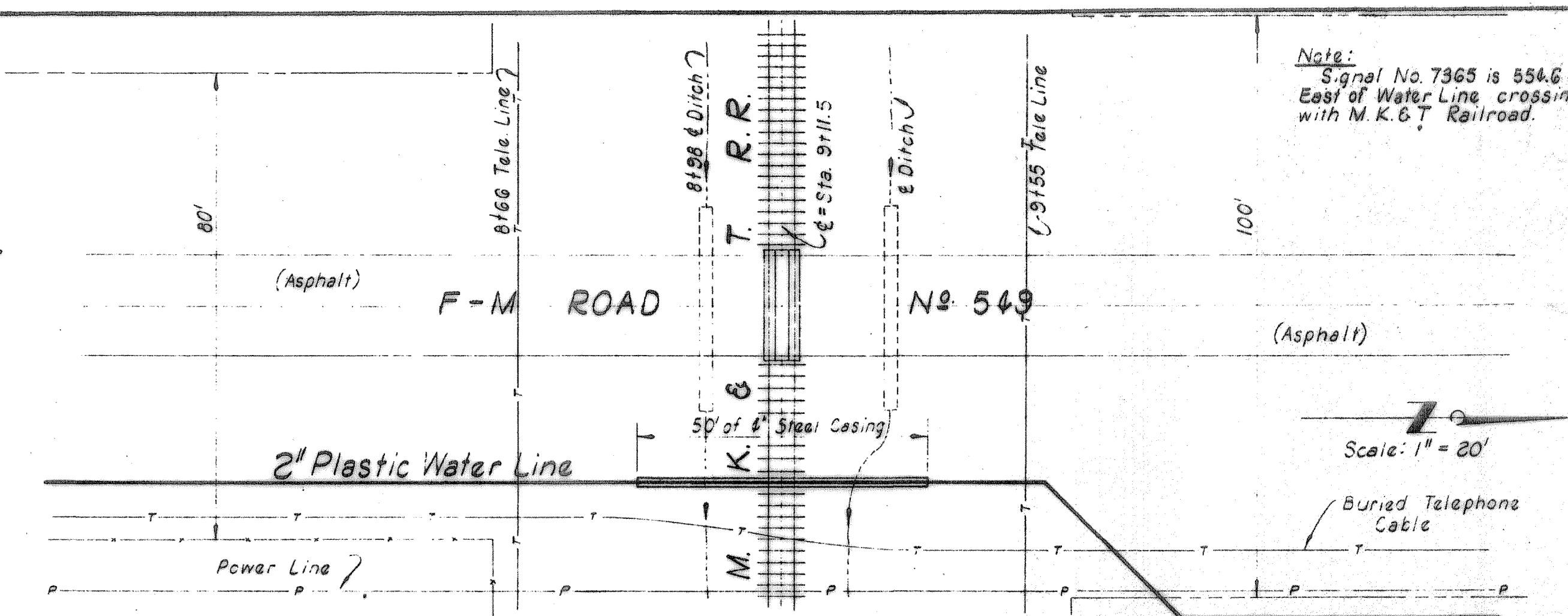
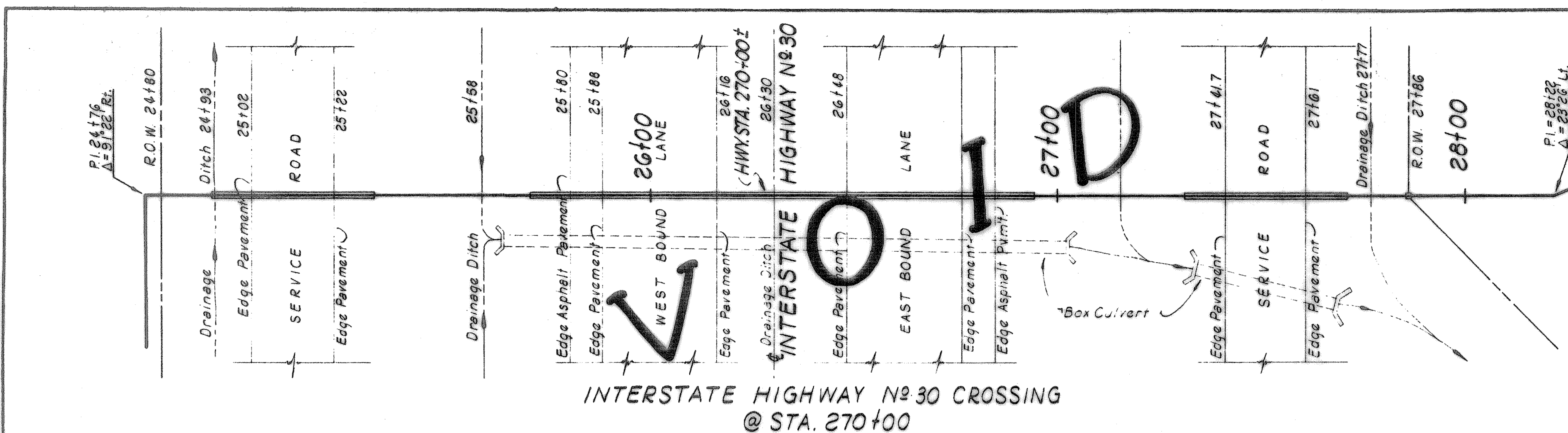

Note:
 Signal No. 7365 is 554.6 ft.
 East of Water Line crossing
 with M. K. & T. Railroad.

Scale: 1" = 20'

INTERSTATE HIGHWAY No. 30 CROSSING
 @ STA. 270+00

NOT PART OF THIS CONTRACT

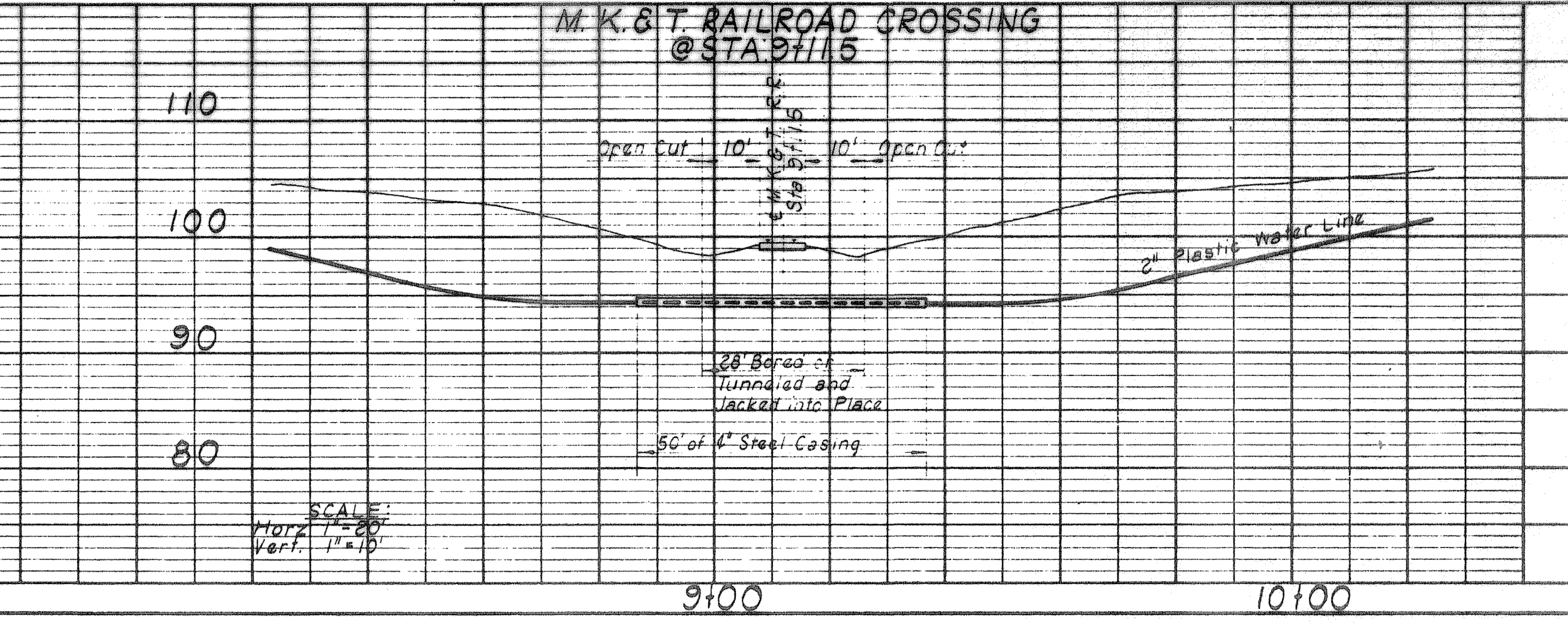
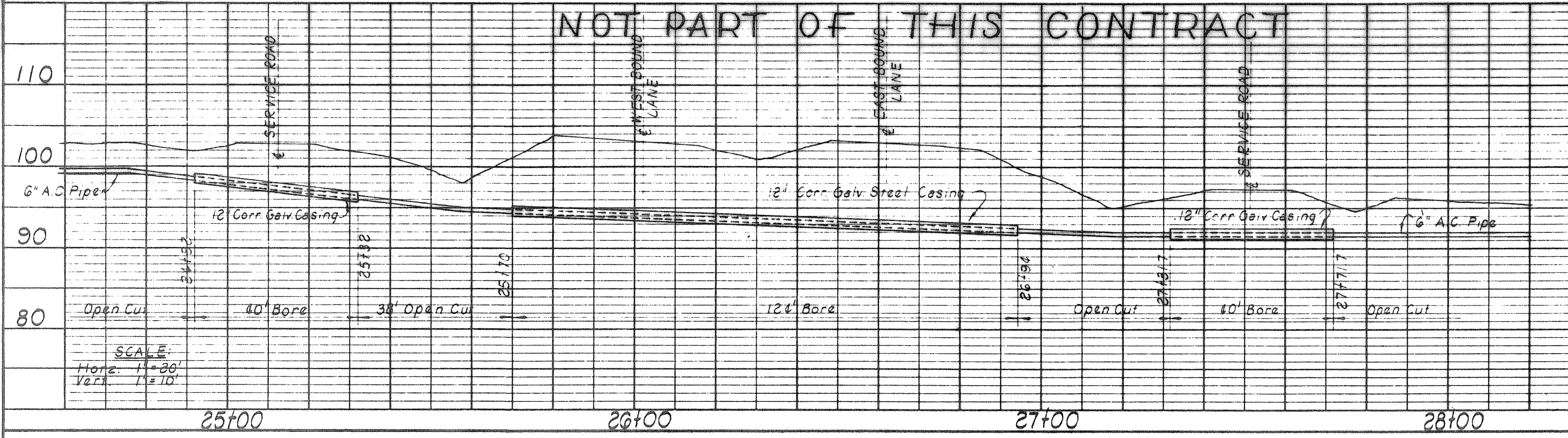

SCALE:
 Horiz. 1" = 20'
 Vert. 1" = 10'

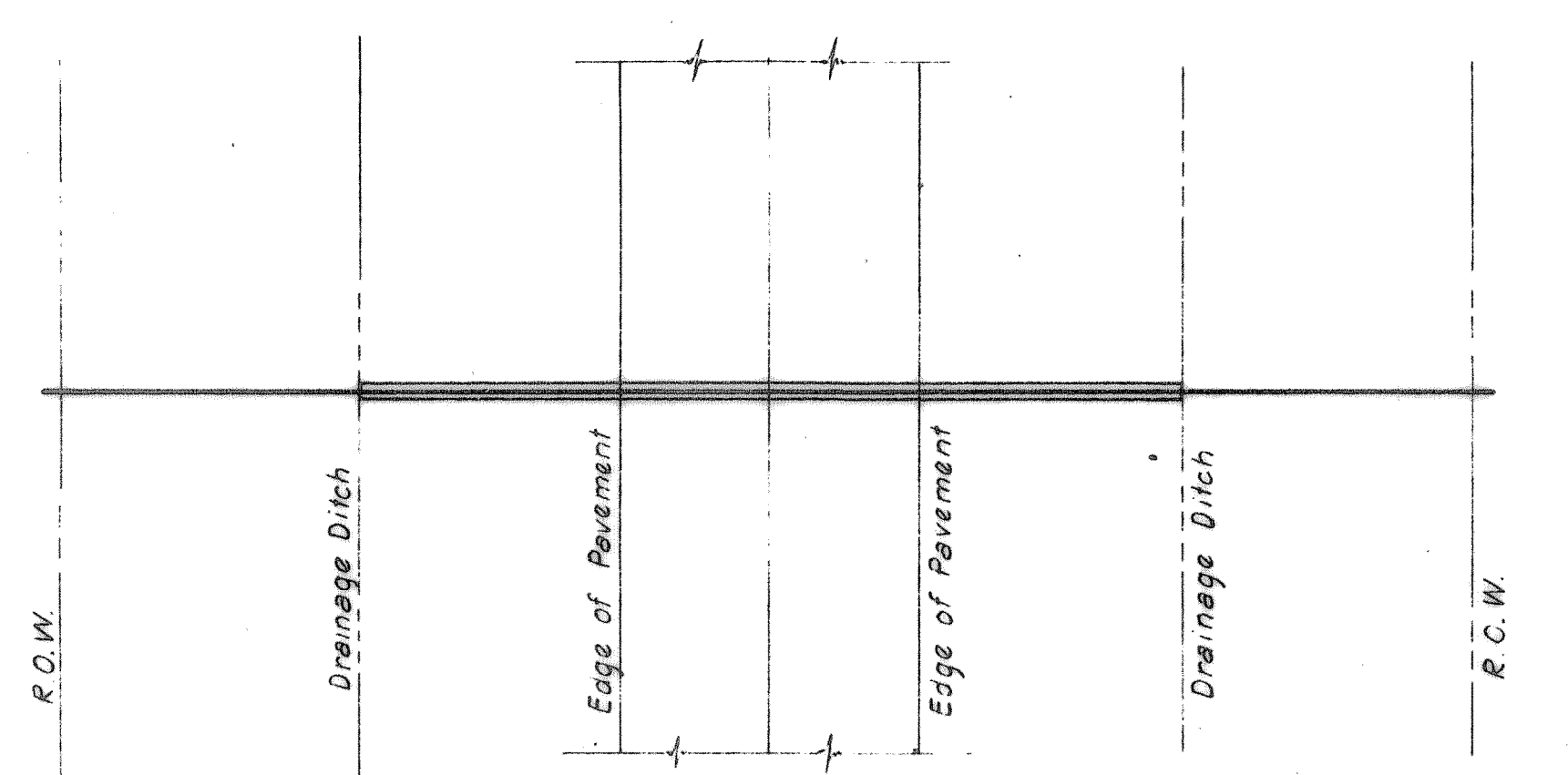

TYPICAL HIGHWAY CROSSING DETAIL
 No SCALE

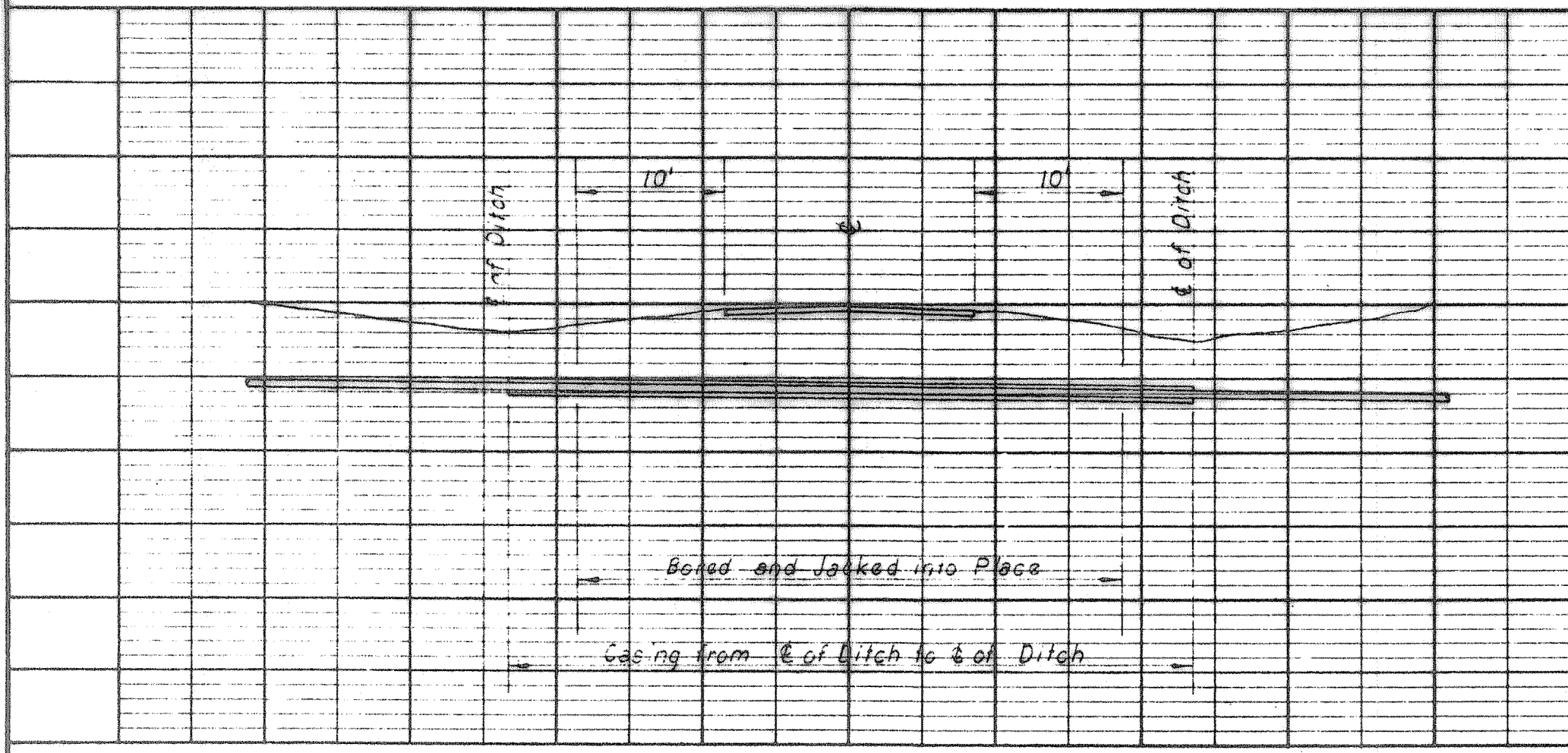

Water Line	Highway	Highway Station	Size Pipe	Size Casing	Length Casing	Length Bored	Sheet Number
Line A	State Hwy 276	46+00	1"	2"	80'	40'	2
"	"	77+80	1"	2"	80'	40'	2
"	F.M. 549	107+52	6"	12"	80'	40'	3
Line C	State Hwy 276	94+33	2"	4"	90'	-	3
Line A	"	156+10	1"	2"	80'	40'	3
"	"	189+45	1"	2"	80'	40'	3
"	"	194+57	1"	2"	80'	40'	3
"	"	289+33	6"	8"	80'	40'	5
"	F.M. 548	240+57	1"	2"	60'	40'	5
"	"	215+36	1"	2"	60'	40'	6
"	"	164+22	1"	2"	60'	40'	6
"	"	28+92	1"	2"	60'	40'	6
"	"	116+29	1"	2"	60'	40'	6
"	"	68+92	1 1/2"	3"	60'	40'	7
Line B	State Hwy 276	310+00	1"	2"	80'	40'	5
"	F.M. 549	81+05	1 1/2"	3"	60'	40'	8
Line D	F.M. 549	10+102	1 1/2"	3"	60'	40'	8
Line E	F.M. 551	62+91	1 1/2"	3"	60'	40'	9
"	"	96+37	1"	2"	60'	40'	9
"	"	123+63	1"	2"	60'	40'	9
"	"	173+35	1"	2"	60'	40'	10
"	F.M. 1143	159+50	3"	6"	60'	40'	10
"	State Hwy 276	245+82	3"	6"	90'	-	10
Line G	State Hwy 276	338+11	3"	6"	80'	40'	11
"	F.M. 1142	12+25	3"	6"	60'	40'	11
"	"	39+55	1 1/2"	3"	60'	40'	11
Line A	State Hwy 276	146+60	6"	12"	90'	-	3
Line A-2	F.M. 1143	47+51.8	1 1/2"	3"	60'	40'	11
Line H	F.M. 549	41+75	6"	12"	60'	40'	12

HIGHWAY CROSSING SCHEDULE

JANUARY, 1968

BLACKLAND WATER SUPPLY CORP.
 ROCKWALL COUNTY, TEXAS
 WATER DISTRIBUTION SYSTEM
 CROSSING DETAILS

DESIGNED: D.L.D.
 DRAWN: C.D.G.
 TRACED: J.P.H.
 CHECKED: R.L.N.

FREESE, NICHOLS & ENDRESS
 CONSULTING ENGINEERS
 FORT WORTH, TEXAS

DATE: Dec. 1963
 SCALE: As Shown
 Sheet No. of 22 14