

INSTALL: 1" IRRIGATION WATER SERVICE W/ 1" METER IN R.O.W. & BACKFLOW PREVENTION DEVICE ON PRIVATE PROPERTY. REPAIR SIDEWALK AS REQUIRED.

INSTALL: 1" DOMESTIC WATER SERVICE WITH 1" METER IN R.O.W. & BACKFLOW PREVENTION DEVICE (AT METER). REPAIR SIDEWALK AS REQUIRED.

ABANDON EXISTING WATER METER & RELOCATE

REMOVE & REPLACE WALK AS REQUIRED TO INSTALL SEWER

BORE UNDER EXIST APPROACH TO INSTALL 4" PRIVATE FORCE MAIN

REMOVE & REPLACE WALK AS REQUIRED TO INSTALL SEWER

!!!! CAUTION !!!!
 TEXAS ONE 1-800-245-4545
 ATMOS 1-800-344-8377
 SW BELL 1-800-233-2133
 ONCOR 1-800-395-0440
 48 HRS PRIOR TO CONSTRUCTION

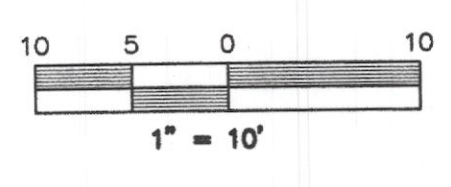
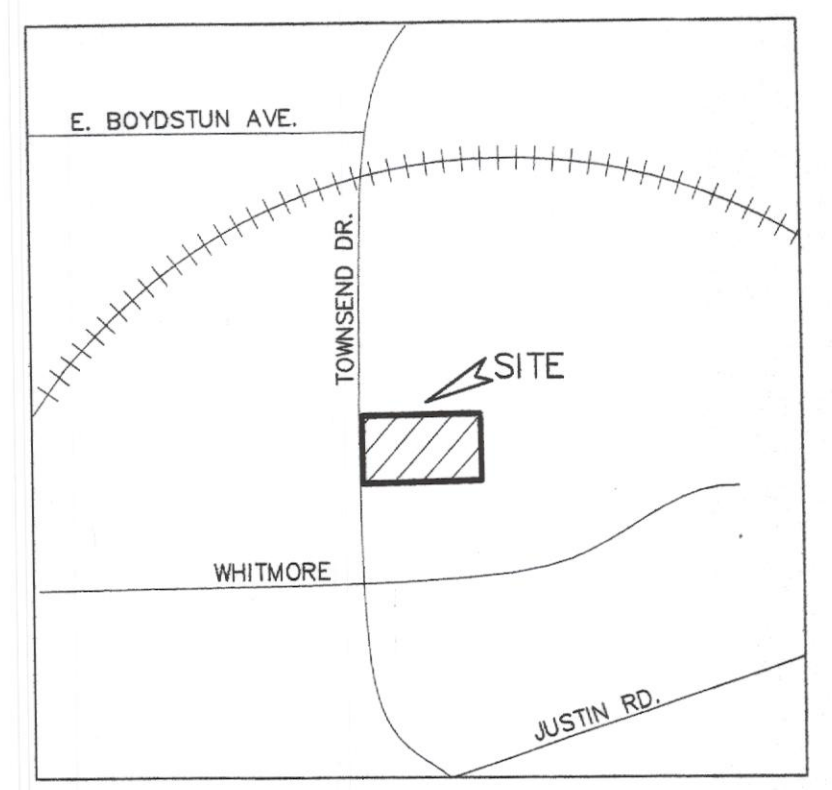

VICINITY MAP NOT TO SCALE

LEGEND

- = PROPERTY LINE
- EXIST. or EX. = EXISTING
- ⊕ = CENTERLINE
- EX. SS --- = EXISTING SANITARY SEWER LINE
- EX. W --- = EXISTING WATER LINE
- ⊕ FH = EXISTING FIRE HYDRANT
- ⊕ WM = EXISTING WATER METER
- ⊕ PP = EXISTING POWER POLE
- ⊕ LP = EXISTING LIGHT POLE
- T = EX. WATER VALVE
- ⊕ = EXISTING STORM MANHOLE
- ⊕ = EXISTING SS MANHOLE
- ⊕ FH = PROPOSED FIRE HYDRANT
- EXIST. or EX. = EXISTING
- PROP. = PROPOSED
- LS = LANDSCAPE
- RCP = REINFORCED CONCRETE PIPE
- min = MINIMUM
- max = MAXIMUM

NOTE:
 ENTIRE FORCE MAIN IS PRIVATE ALL THE WAY TO THE MANHOLE AND WILL BE MAINTAINED, REPAIRED, AND REPLACED (ALONG WITH THE LIFT STATION) BY THE PROPERTY OWNER

WARNING:
 PRIOR TO THE BEGINNING OF ANY CONSTRUCTION OR CONSTRUCTION STAKING, IT SHALL BE THE CONTRACTOR'S RESPONSIBILITY TO CONTACT THE CIVIL ENGINEER TO ENSURE THAT ALL PARTIES ARE IN POSSESSION OF THE MOST CURRENT SET OF CONSTRUCTION DOCUMENTS.

NOTE:
 THE CONTRACTOR SHALL BE RESPONSIBLE FOR FIELD VERIFYING THE LOCATION OF ALL EXISTING UTILITIES AND EASEMENTS PRIOR TO START OF OPERATIONS. CONTRACTOR WILL NOTIFY THE OWNER'S REPRESENTATIVE OF ANY DISCREPANCIES PRIOR TO STARTING THE WORK. EXISTING UTILITIES AND UNDERGROUND FACILITIES INDICATED ON THESE PLANS HAVE BEEN LOCATED FROM REFERENCE INFORMATION. IT SHALL BE THE RESPONSIBILITY OF THE CONTRACTOR TO VERIFY BOTH THE HORIZONTAL AND VERTICAL LOCATION OF ALL EXISTING UTILITIES AND UNDERGROUND FACILITIES PRIOR TO START OF CONSTRUCTION. TAKE THE NECESSARY PRECAUTIONS IN ORDER TO PROTECT ALL FACILITIES ENCOUNTERED. THE CONTRACTOR SHALL PRESERVE AND PROTECT ALL EXISTING UTILITIES FROM DAMAGE DURING CONSTRUCTION.

- NOTES:**
- 1) ALL WORK MUST CONFORM TO CITY OF ROCKWALL & NCTCOG STANDARDS AND DETAILS 3rd EDITION.
 - 2) ALL WORK IN PUBLIC RIGHT-OF-WAY SHALL CONFORM TO CITY OF ROCKWALL STANDARDS AND DETAILS
 - 3) SEE PLAT FOR ALL INFORMATION REGARDING EASEMENTS, PROPERTY LINES, ETC.
 - 4) ALL WATER & SEWER SERVICES MUST BE APPROVED & PERMITTED BY THE CITY OF ROCKWALL.
 - 5) NO PERMANENT STRUCTURES (INCLUDING LIGHT POLES AND INLETS) MAY BE PLACED WITHIN A PUBLIC UTILITY EASEMENT. BACKFLOW PREVENTION DEVICES MUST BE PLACED ON PRIVATE PROPERTY (NOT IN AN EASEMENT)
 - 6) PRIVATE UTILITIES TO BE MAINTAINED, REPAIRED, AND REPLACED BY PROPERTY OWNER.

RELEASED FOR CONSTRUCTION
 ALL RESPONSIBILITY FOR ADEQUACY OF DESIGN REMAINS WITH THE DESIGN ENGINEER. THE CITY OF ROCKWALL, IN REVIEWING AND RELEASING PLANS FOR CONSTRUCTION, ASSUMES NO RESPONSIBILITY FOR ADEQUACY OR ACCURACY OF DESIGN.

BENCHMARK:
 X FOUND AT SW CORNER OR PROPERTY CITY OF ROCKWALL MONUMENT COORDINATES:
 N 7024552.27
 E 2596514.76
 ELEV=559.9

ONLY DRAWINGS STAMPED "RELEASED FOR CONSTRUCTION" BY THE CITY OF ROCKWALL TO BE USED FOR CONSTRUCTION.



CASE # SP2013-008

UTILITY PLAN

CORRIGAN LAW OFFICE

805 Townsend Dr.
 CORRIGAN LAW OFFICE ADDITION
 LOT 1, BLK A, 0.31 ACRES
 City of Rockwall, Rockwall County, Texas

DWR
 BRIAN CORRIGAN
 815 Townsend, Suite 109
 Rockwall, TX 75087
 972-722-5300

prepared by
MONK CONSULTING ENGINEERS
 1200 W. State Street, Garland Texas 75040
 972 272-1763 Fax 972 272-8761

© 2013 Monk Consulting Engineers, Inc., All Rights Reserved
 REG. NO.: F-2567

date: 8/19/13 scale: 1"=10' sheet: C102