

LINE A

Given Input Data:
 Shape Rectangular
 Solving for Depth of Flow
 Height 36.0000 in
 Width 216.0000 in
 Flowrate 270.2000 cfs
 Slope 0.0050 ft/ft
 Manning's n 0.0130

Computed Results:
 Depth 18.5357 in
 Area 54.0000 ft²
 Wetted Area 27.8035 ft²
 Wetted Perimeter 253.0713 in
 Perimeter 504.0000 in
 Velocity 9.7182 fps
 Hydraulic Radius 15.8205 in
 Percent Full 51.4880 %
 Full flow Flowrate 516.0802 cfs
 Full flow velocity 9.5570 fps

LINE B

Given Input Data:
 Shape Circular
 Solving for Depth of Flow
 Diameter 24.0000 in
 Flowrate 22.0600 cfs
 Slope 0.0084 ft/ft
 Manning's n 0.0130

Computed Results:
 Depth 21.5124 in
 Area 3.1416 ft²
 Wetted Area 2.9693 ft²
 Wetted Perimeter 59.6644 in
 Perimeter 75.3982 in
 Velocity 7.4295 fps
 Hydraulic Radius 7.1663 in
 Percent Full 89.6349 %
 Full flow Flowrate 20.7338 cfs
 Full flow velocity 6.5998 fps

LINE B

Given Input Data:
 Shape Circular
 Solving for Depth of Flow
 Diameter 24.0000 in
 Flowrate 15.9700 cfs
 Slope 0.0084 ft/ft
 Manning's n 0.0130

Computed Results:
 Depth 15.8006 in
 Area 3.1416 ft²
 Wetted Area 2.1935 ft²
 Wetted Perimeter 45.4334 in
 Perimeter 75.3982 in
 Velocity 7.2807 fps
 Hydraulic Radius 6.9521 in
 Percent Full 65.8357 %
 Full flow Flowrate 20.7338 cfs
 Full flow velocity 6.5998 fps

LINE C

Given Input Data:
 Shape Circular
 Solving for Depth of Flow
 Diameter 21.0000 in
 Flowrate 6.0900 cfs
 Slope 0.0254 ft/ft
 Manning's n 0.0130

Computed Results:
 Depth 7.0219 in
 Area 2.4053 ft²
 Wetted Area 0.7049 ft²
 Wetted Perimeter 25.8966 in
 Perimeter 65.9734 in
 Velocity 8.6401 fps
 Hydraulic Radius 3.9194 in
 Percent Full 33.4377 %
 Full flow Flowrate 25.2528 cfs
 Full flow velocity 10.4989 fps

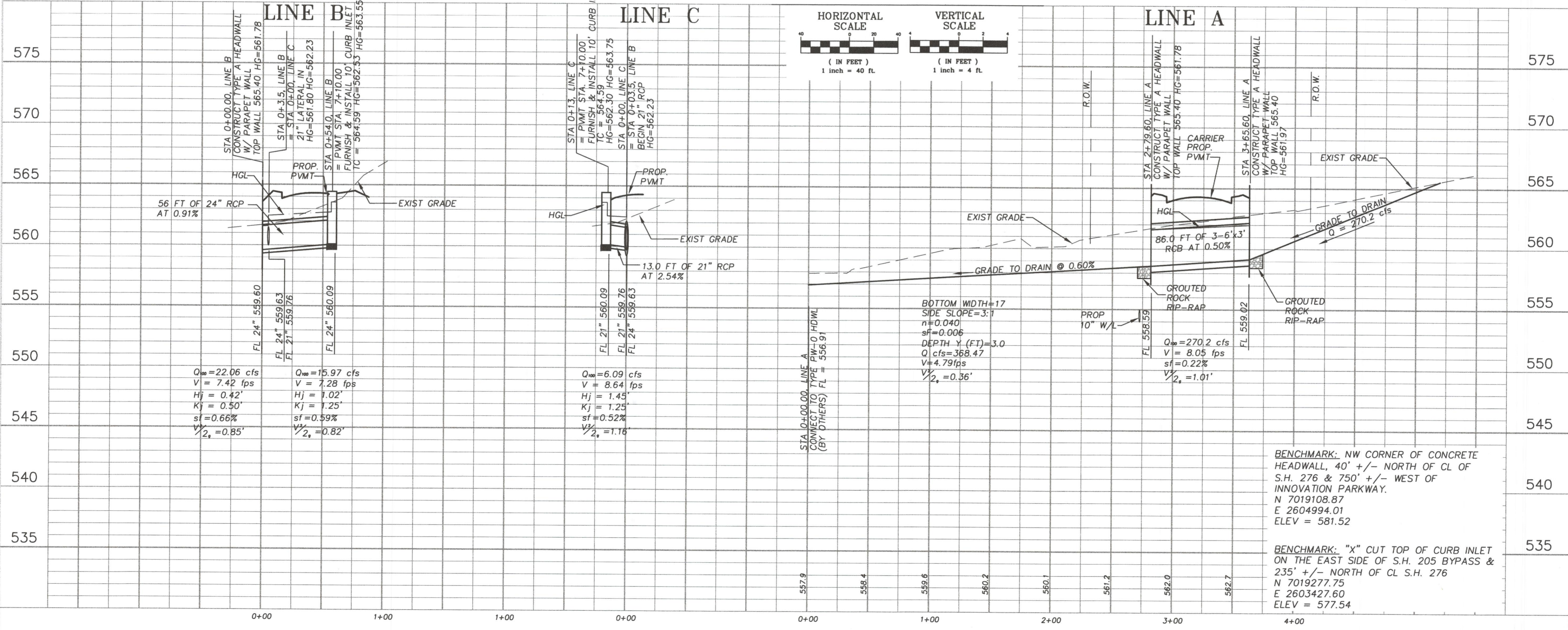
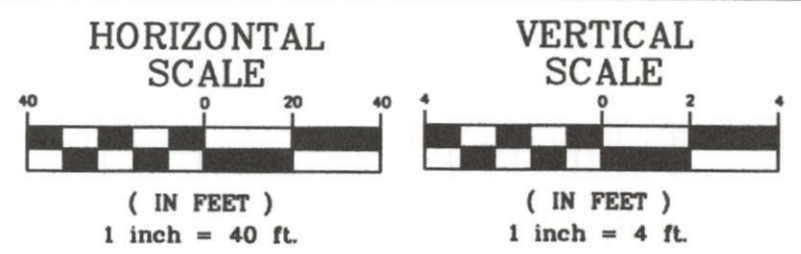
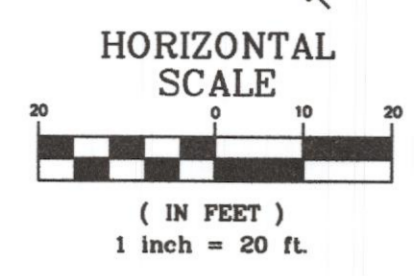
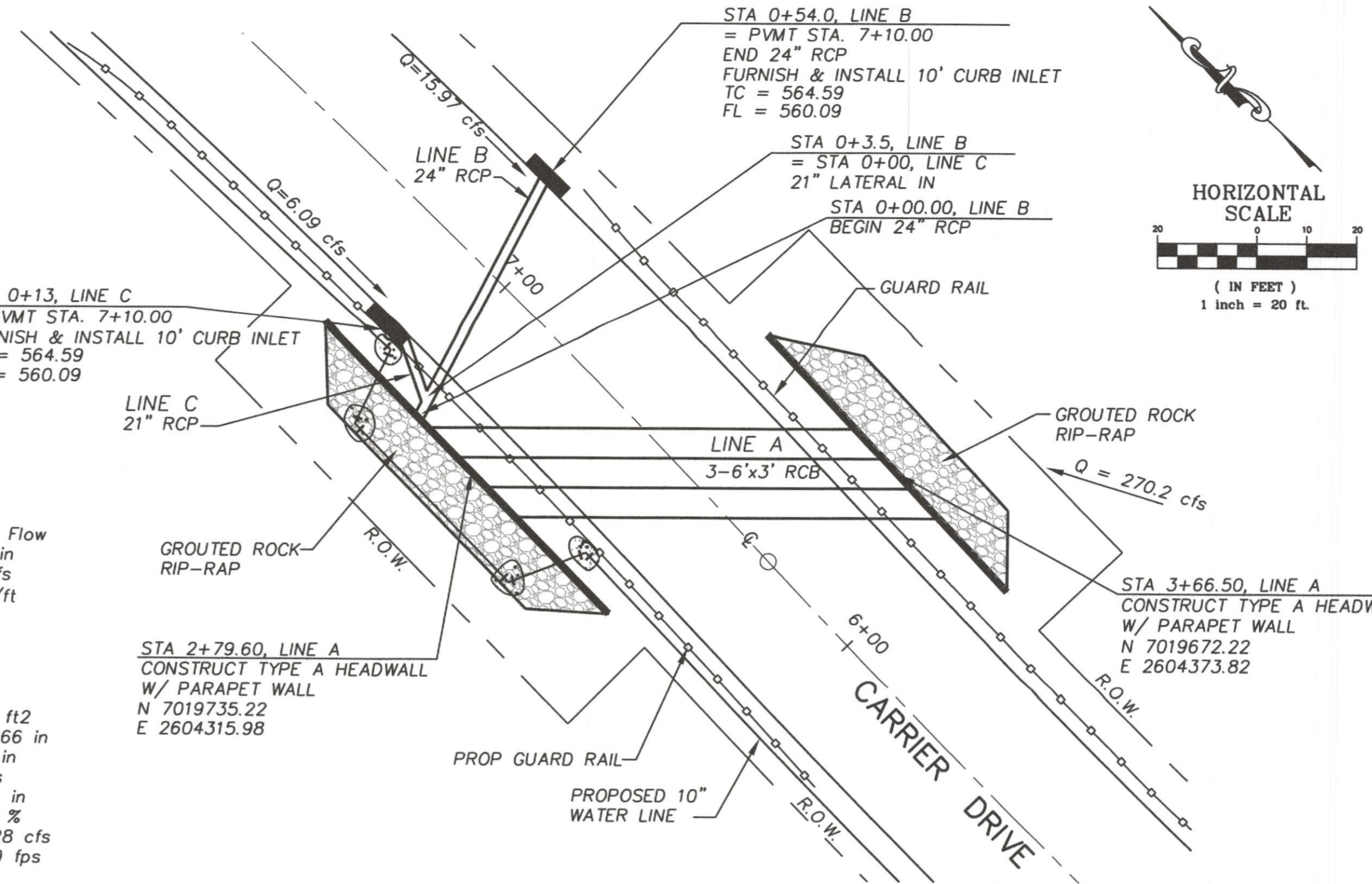

BENCHMARK: NW CORNER OF CONCRETE HEADWALL, 40' +/- NORTH OF CL OF S.H. 276 & 750' +/- WEST OF INNOVATION PARKWAY.
 N 7019108.87
 E 2604994.01
 ELEV = 581.52

BENCHMARK: "X" CUT TOP OF CURB INLET ON THE EAST SIDE OF S.H. 205 BYPASS & 235' +/- NORTH OF CL S.H. 276
 N 7019277.75
 E 2603427.60
 ELEV = 577.54



THE SEAL APPEARING ON THIS DOCUMENT WAS FORGED BY W.L. DOUPHRAE IN TEXAS P.E. NO. 60102 ON

DOUPHRAE & ASSOCIATES, INC.
 ENGINEERING - PROJECT MANAGEMENT - SURVEYING
 2235 RIDGE RD., # 200 ROCKWALL, TEXAS 75087
 PHONE: (972)771-9004 FAX: (972)771-9005

STORM DRAIN - PLAN & PROFILES
PROPOSED CARRIER DRIVE
CITY OF ROCKWALL
 ROCKWALL COUNTY, TEXAS

CHECKED	WLD.
DRAWN	RCT
DATE	04/2010
DRAWING	STM2
PROJECT	10004
	7 OF 23