

BENCHMARKS:
 BM #1 - "X" CUT ON THE PAVEMENT ON THE WEST R.O.W. LINE OF VIGOR WAY, ±13.3 FEET NORTH OF THE MOST SOUTHEASTERN PROPERTY CORNER OF LOT 1, BLOCK A, COMFORT INN & SUITES ROCKWALL TOWNE CENTER
 ELEVATION - 545.93 FEET

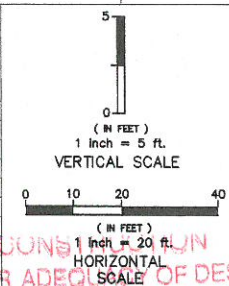

THE SEAL APPEARING ON THIS DOCUMENT WAS AUTHORIZED BY
 JUAN J. VASQUEZ, P.E. 89852, ON
 12/04/2017

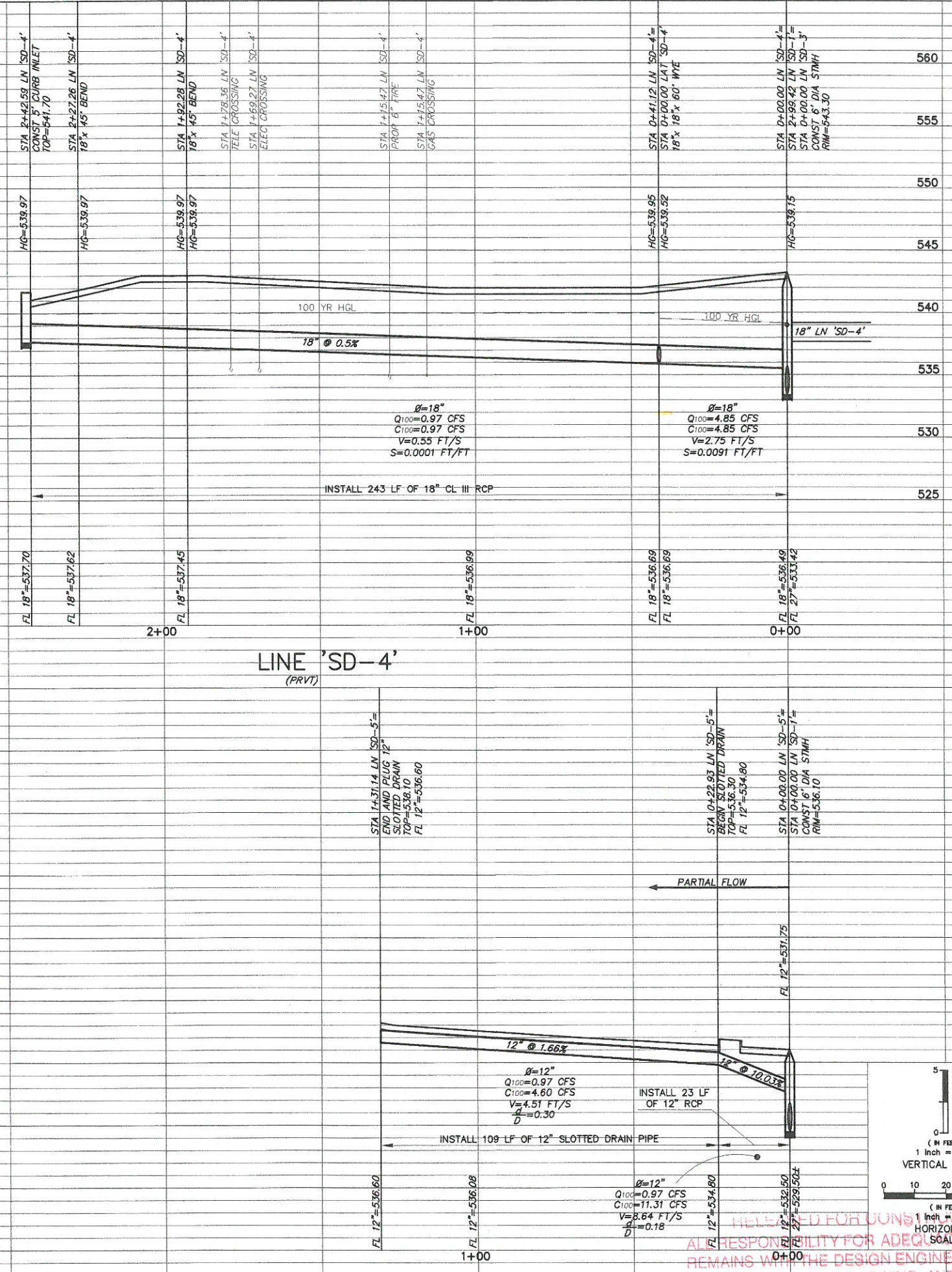

DEVELOPER:
 JAGH HOSPITALITY
 996 East I-30
 Rockwall, TX 75087

STORM SEWER PROFILES
 LOT 1, BLOCK A
 BW PLUS EXECUTIVE RESIDENCY
 ROCKWALL, TEXAS

Scale: 1" = 20'
 designed by: JUV
 drawn by: JUV
 checked by: JUV
 11-011aw/c63-3-STORM SEWER PROFILES.dwg
 date: 12/04/2017

VASQUEZ ENGINEERING, L.L.C.
 1919 S. Shiloh Road
 Suite 440, LB 44
 Garland, Texas 75042
 Ph: 972-278-2948
 TX Registration # F-12266



APP.	NO.	DATE