

SHWGROUP
ARCHITECTS | ENGINEERS | PLANNERS

CIVIL:
GLENN ENGINEERING, INC.

STRUCTURAL:
SHW GROUP LLP

MEP:
ESTES, McCLURE &
ASSOCIATES

LANDSCAPING:
GRUBBS-RAMSEY, INC.

FOOD SERVICE:
JMK DESIGNS

AQUATICS:
AQUATIC EXCELLENCE

FINAL PLANS
FOR BIDDING AND CONSTRUCTION

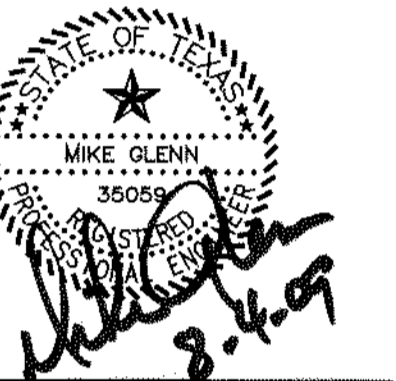

Rockwall ISD

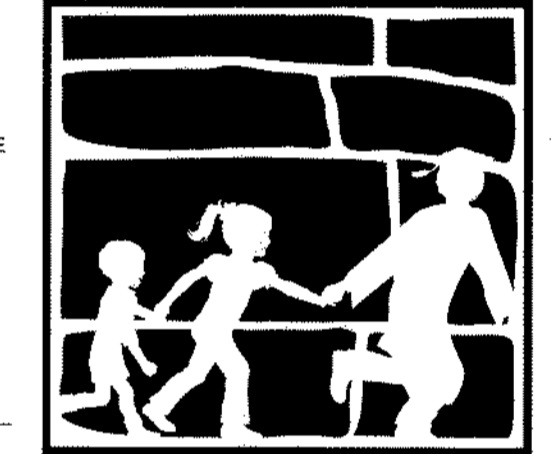

**HERMAN E. UTLEY
MIDDLE SCHOOL**

CHECKED:
File:
© 2008 SHW Group LLP

ISSUE: 08/22/2008

1	09/19/08	CITY REVISIONS #1
2	09/28/08	CITY REVISIONS #2
3	10/01/08	CITY REVISIONS #3
4	10/13/08	REVISIONS #4
5	11/18/08	GRADING REVISIONS
6	12/02/08	UTILITY REVISIONS
7	01/14/09	GRADING REVISIONS
8	02/26/09	GRADING REVISIONS
9	05/20/09	COURTYARD STORM
10	07/27/09	RECORD SET

RECORD DRAWING
This is to certify that changes and corrections have been made to conform to the contractor's record of this project.
Glenn 8.4.09
Signed Date
Glenn Engineering Corporation

MATCH LINE - CU 1.08

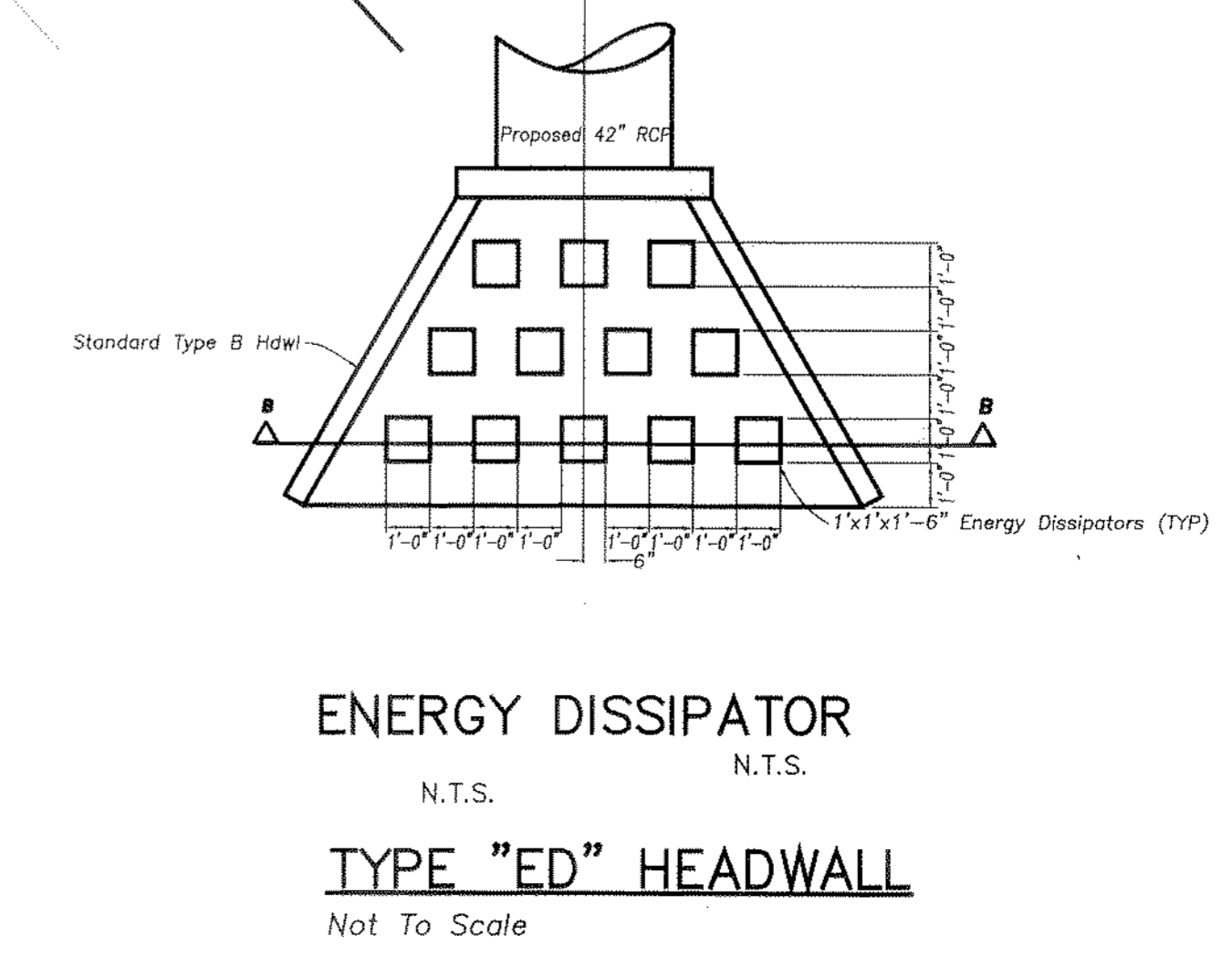
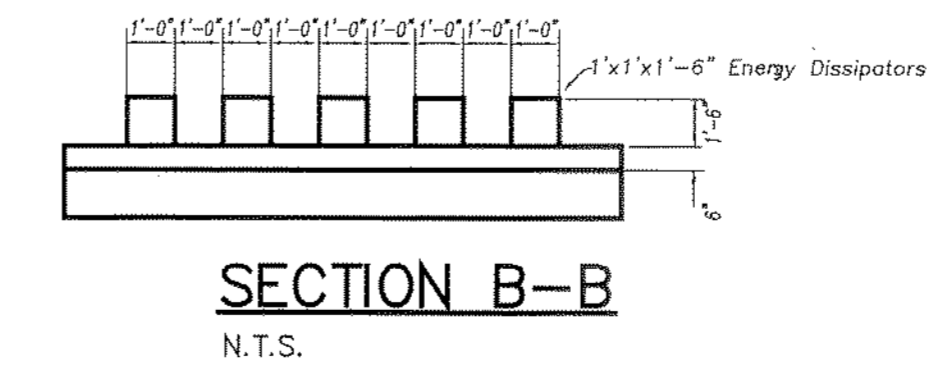
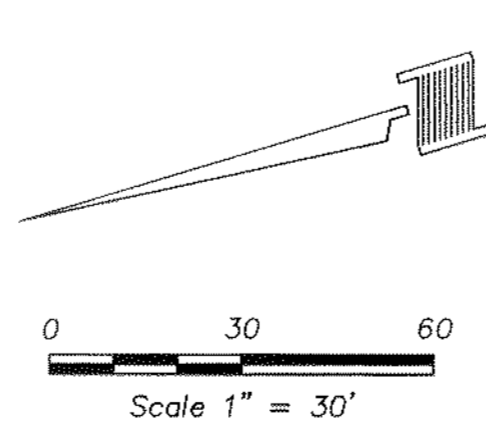
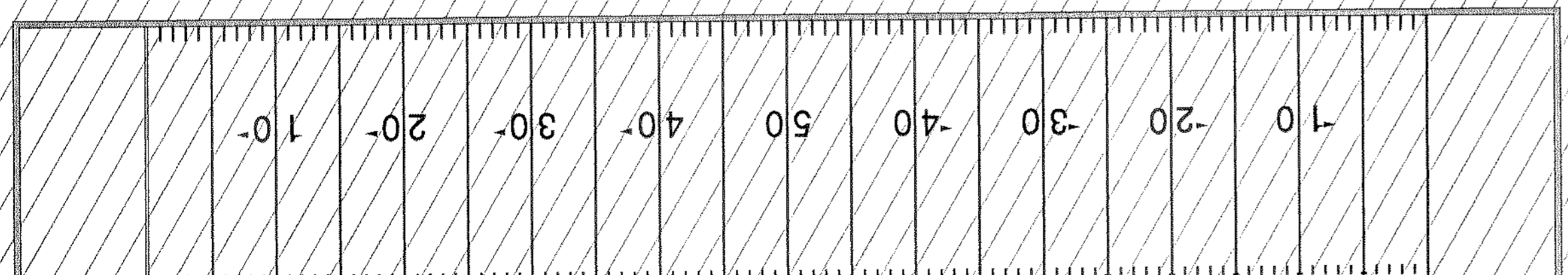
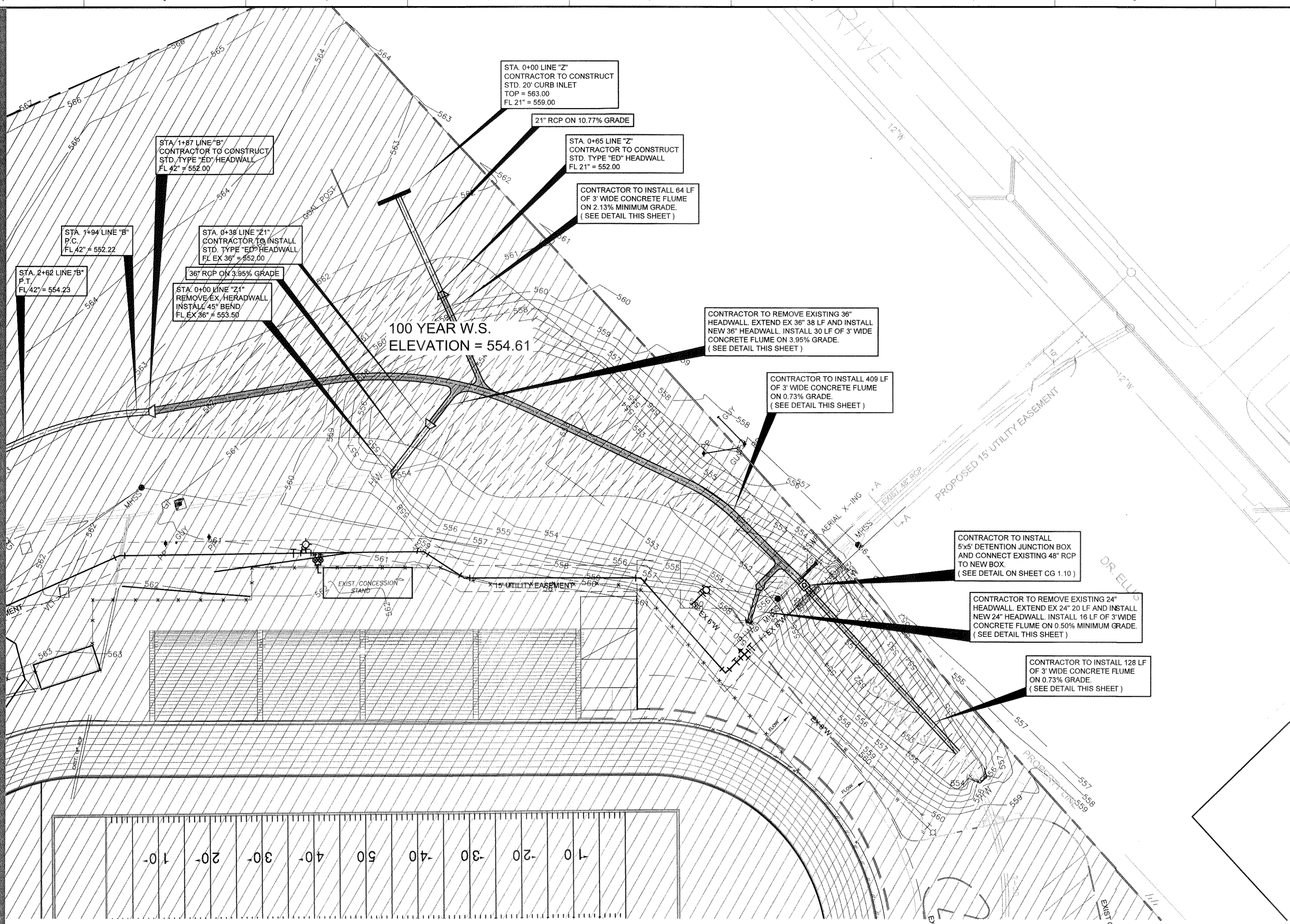

Printed: Aug 3, 2008, 1:24 PM by user: rick. Saved: 7/31/2009 by user: rick. \\shwgroup-servers\shared\cadd\2008\4107043\4107043.dwg

Sheet Title:
**VISITOR SIDE
STORM SEWER
PLAN**

CU 1.10