

SHW GROUP

ARCHITECTS | ENGINEERS | PLANNERS

CIVIL: GLENN ENGINEERING, INC.

STRUCTURAL: SHW GROUP LLP

MEP: ESTES, McCLURE & ASSOCIATES

LANDSCAPING: GRUBBS-RAMSEY, INC.

FOOD SERVICE: JMK DESIGNS

AQUATICS: AQUATIC EXCELLENCE

FINAL PLANS FOR BIDDING AND CONSTRUCTION



Rockwall ISD



HERMAN E. UTLEY MIDDLE SCHOOL

CHECKED: File: © 2008 SHW Group LLP ISSUE: 08/22/2008

1	09/19/08	CITY REVISIONS #1
2	09/28/08	CITY REVISIONS #2
3	10/01/08	CITY REVISIONS #3
4	10/13/08	REVISIONS #4
5	11/18/08	GRADING REVISIONS
6	12/02/08	UTILITY REVISIONS
7	01/14/09	GRADING REVISIONS
8	02/26/09	GRADING REVISIONS
9	05/20/09	COURTYARD STORM
10	07/27/09	RECORD SET

Sheet Title: STORM PROFILES

RECORD DRAWING

This is to certify that changes and corrections have been made to conform to the contractor's record of this project.

Signed: *Mike Glenn* Date: 8.4.09

Glenn Engineering Corporation

CU 1.13

SHW Project: 4107.043.00

LINE "B3" LINE "B2"

LINE "B" - PRIVATE

LINE "C" - PRIVATE

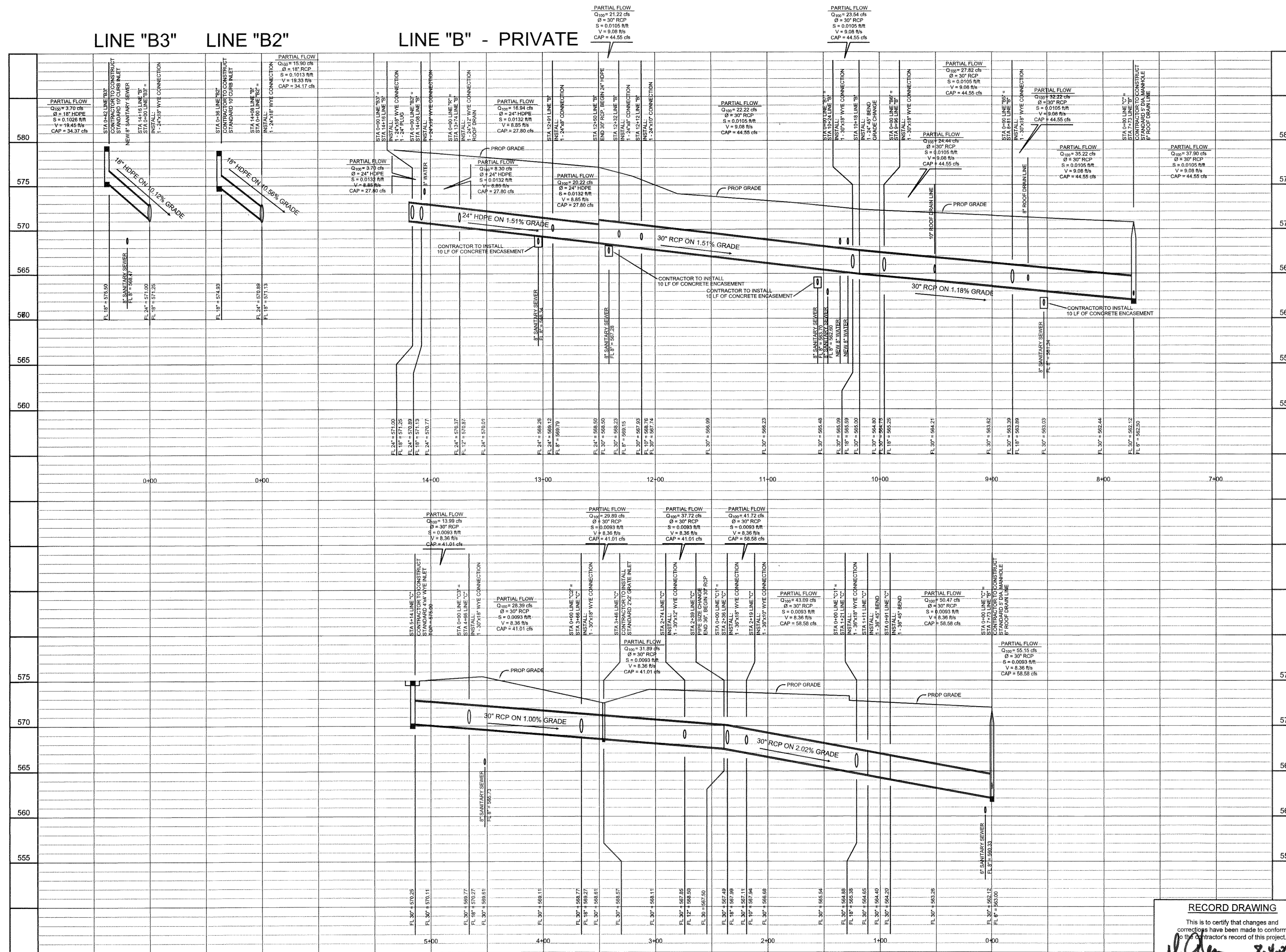

Plotfile: Aug 3, 2009, 1:23 PM by user: rck... Saved: 7/12/2009 by user: rck... \\bbs\pco-dwg\ROCKWALL\UTLEY\2008 ADDITIONS\BID SET\2008 UTLEY-SCH\HAT-REV3.dwg