

# DEVELOPMENT PLANS FOR THE PRESERVE - PHASE 2 CITY OF ROCKWALL, COLLIN COUNTY, TEXAS

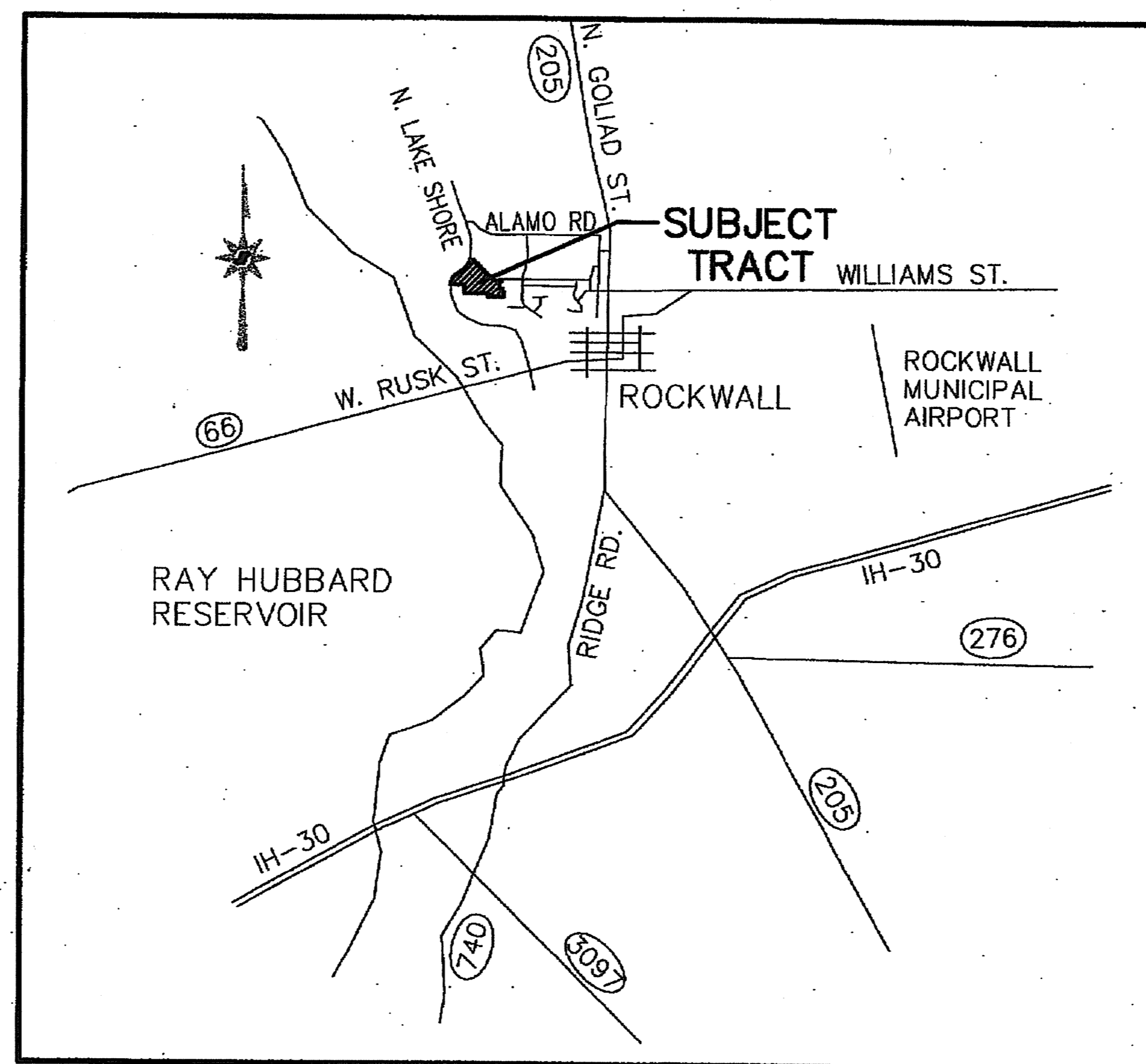

**LOCATION MAP**  
( N. T. S. )  
MAPSCO PAGE 20C-K&L

INDEX of SHEETS	
Sheet No.	Title
1	Cover Sheet
2, 3	Final Plat (Winkelmann)
4	
5	Paving Details
6-14	Paving Plan & Profile
15-16	Lot Grading Plan
17	Drainage Area Map
18-21	Storm Sewer Plan & Profile
22	Water & Sanitary Sewer Plan
23-26	Sanitary Sewer Profiles
27	Erosion Control Plan (Winkelmann)
S1.1	Retaining Wall Details

Information shown on these plans was furnished by the Contractor. All responsibility for the accuracy belongs to the Contractor.

**"AS BUILT"**  
Information shown on these plans was furnished by the Contractor. All responsibility for the accuracy belongs to the Contractor.

**piars**  
ENGINEERING  
730 E. Park Blvd., Suite 210 Plano, TX 75074  
(972) 422-0077 Fax (972) 422-0075

**RECORD DRAWINGS**

NOTE:  
THESE PLANS HAVE BEEN REVISED TO CONFORM WITH CONSTRUCTION RECORDS PROVIDED TO SPIARS ENGINEERING, INC. BY CONTRACTOR AND CITY STAFF AFTER AS-BUILTS WERE ORIGINALLY SUBMITTED TO THE CITY OF ROCKWALL BY OTHERS. MODIFICATIONS TO PAVING, PAD AND UTILITY ELEVATIONS, AS REFLECTED ON THESE PLANS, WERE VERIFIED BY FIELD SURVEY PERFORMED IN DECEMBER, 2006.

**C&P Engineering, Ltd.**  
1801 Gateway Blvd., Suite 101  
Richardson, Texas 75080  
972.644.2800  
fax 972.644.2817  
info@c-pengineering.com

• engineering • surveying  
• construction management  
• traffic • planning

The Seal Appearing On This Document Was Authorized By  
*Grant M. Woodfin*  
90361, On 2.8.07

**Shaddock Developers**  
2400 Dallas Parkway  
Suite 560  
Plano, Texas 75093  
(972) 985-5505

January 2007