

- NOTES**
- Bearing are referenced to Stone Creek Phase I (Vol. G, Pg. 359-365).
 - All lot lines are radial or perpendicular to the street unless otherwise noted by bearing.
 - 1/2" iron rods with "CORWIN ENGR. INC." caps set at all boundary corners, block corners, points of curvature, points of tangency, and angle points in public right-of-way unless otherwise noted.
 - B.L. - Building Line.
U.E. - Utility Easements.
C.M. - Controlling Monument.
D.E. - Drainage Easement
F.F. - Finish Floor
V.A.M.S. - Visibility, Maintenance & Sidewalk Easement
BFE - Base Flood Elevation
S.E. - Sidewalk Easement
 - All open spaces, drainage areas and other common areas shall be maintained by the Homeowners Association.

SET CONCRETE MONUMENT
CITY OF ROCKWALL GRID
SYSTEM COORDINATES

X	Y
2594346.796	7037982.289
ELEV = 540.20	

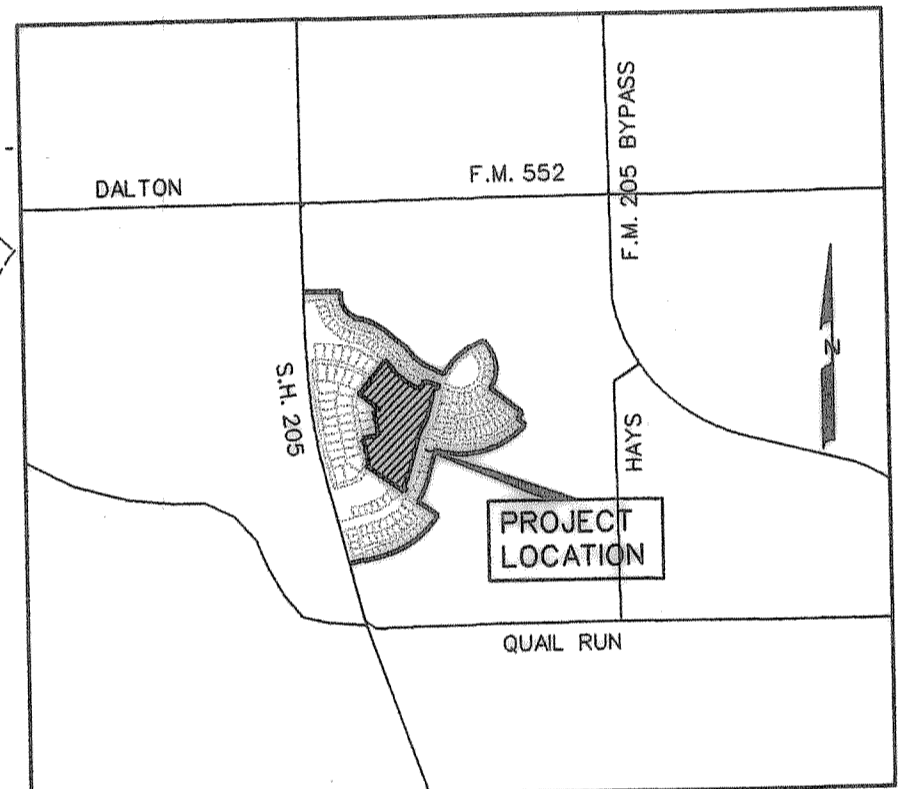
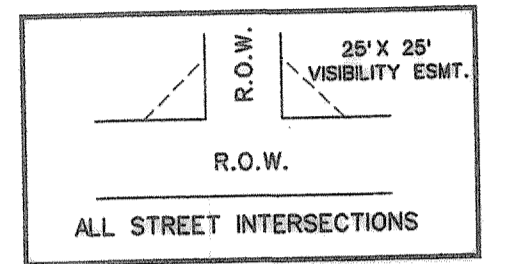

FINAL PLAT
OF
**STONE CREEK
PHASE III**
OUT OF THE
W.T. DEWEESE SURVEY, ABSTRACT NO. 71
S. KING SURVEY, ABSTRACT NO. 131

IN THE
CITY OF ROCKWALL
ROCKWALL COUNTY, TEXAS
OWNERS
STONE CREEK 80/100' POD, LTD.
8214 WESTCHESTER DRIVE, SUITE 710
DALLAS, TEXAS 75219
214-522-4945

PREPARED BY
CORWIN ENGINEERING, INC.
200 W. BELMONT, SUITE E
ALLEN, TEXAS 75013
972-396-1200

AUGUST 2012 SCALE 1" = 100'

FILED FOR RECORD
ROCKWALL COUNTY CLERK
SHELL MILLER
DEPUTY
12 OCT 11 PM 12:18

