

- NOTES**
- Bearing are referenced to 21.857 acre tract, as described in Clerks File No. 2012-467951, in the Deed Records of Rockwall County, Texas.
 - All lot lines are radial or perpendicular to the street unless otherwise noted by bearing.
 - 1/2" iron rods with "CORWIN ENGR. INC." caps set at all boundary corners, block corners, points of curvature, points of tangency, and angle points in public right-of-way unless otherwise noted.
 - B.L. - Building Line.
U.E. - Utility Easements.
C.M. - Controlling Monument.
D.E. - Drainage Easement
W.E. - Water line Easement
S.S.E. - Sanitary Sewer Easement
V.A.M.S. - Visibility, Maintenance & Sidewalk Easement
H.O.A. - Homeowners Association
- Street Name Change
 - All open spaces, drainage areas and other common areas shall be maintained by the Homeowners Association.
 - No building permits will be issued until all public improvements are accepted by the City.

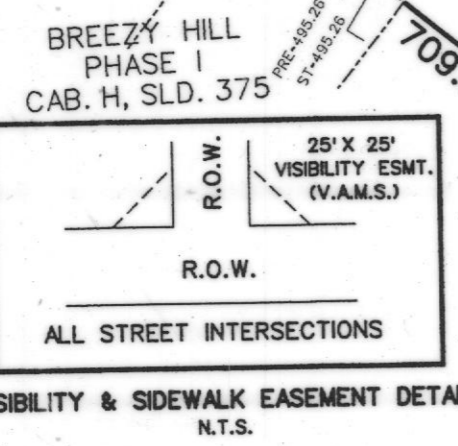

CURVE TABLE

CURVE NO.	DELTA	RADIUS	LENGTH	TANGENT	CHORD	BEARING
1.	20°54'47"	200.00'	73.00'	36.91'	72.60'	S46°38'45"W
2.	20°10'05"	640.00'	225.28'	113.82'	224.12'	N70°05'46"W
3.	03°06'26"	600.00'	32.54'	16.27'	32.54'	S87°59'47"E
4.	02°52'05"	650.00'	32.54'	16.27'	32.54'	N88°06'57"W
5.	18°56'40"	575.00'	190.12'	95.94'	189.26'	S80°04'40"E
6.	173°26'20"	60.00'	195.37'	94.15'	186.19'	N08°50'05"E
7.	17°07'58"	625.00'	186.89'	119.80'	119.80'	N08°50'05"E
8.	17°07'58"	475.00'	142.03'	71.55'	141.51'	N08°50'05"E
9.	16°34'12"	785.00'	227.02'	114.31'	226.23'	S78°53'26"E
10.	18°56'40"	415.00'	137.22'	69.24'	136.59'	S80°04'40"E
11.	178°51'14"	50.00'	158.08'	99.99'	99.99'	N44°02'54"W
12.	15°57'42"	625.00'	174.11'	87.62'	173.55'	S78°35'11"E

LINE TABLE

LINE NO.	BEARING	DISTANCE
1.	N 00°27'00" E	50.07'
2.	N 44°38'27" W	21.25'

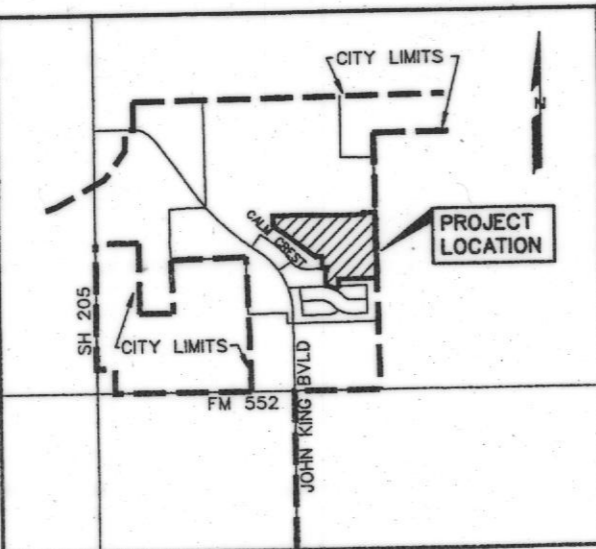

FINAL PLAT OF BREEZY HILL PHASE III

71 LOTS, BEING 48.250 ACRES
SITUATED IN THE
J. STRICKLAND SURVEY, ABSTRACT NO. 187
IN THE
**CITY OF ROCKWALL
ROCKWALL COUNTY, TEXAS**
PREPARED BY
CORWIN ENGINEERING, INC.
200 W. BELMONT, SUITE E
ALLEN, TEXAS 75013
972-396-1200
OWNERS
CITY OF ROCKWALL
385 S. GOLIAD
ROCKWALL, TEXAS 75087

BH AMC, LTD **BH PHASE III SF, LTD.**
8214 WESTCHESTER DRIVE, SUITE 710 8214 WESTCHESTER DRIVE, SUITE 710
DALLAS, TEXAS 75225 DALLAS, TEXAS 75225
214-522-4945 214-522-4945

TOTAL LOTS 71
TOTAL ACRES 48.247

CITY OF ROCKWALL GRID SYSTEM COORDINATES

X	Y
2598182.74	7042666.83
ELEV = 525.0	

JEANETTE HUGHES
VOL. 1953, PG. 21

C. KENT SMITH
VOL. 140, PG. 757

