



These guidelines are to be followed when a building, facility, residential subdivision, or multi-family dwelling units, within the City of Rockwall, is provided with an approved, entry and exit access control/security gate for vehicular traffic and/or pedestrian traffic.

All access control criteria for the purposes of these guidelines and any other guidelines or requirements of the Fire Marshal Division shall conform to the 2015 International Fire Code, as adopted and amended by the City of Rockwall.

These guidelines do not replace, nor supersede any codes and/or ordinances adopted by the City of Rockwall, or determinations and positions of the Rockwall Fire Marshal Division.

General Requirements for Manually Operated Security Gates

- 1) Gates shall not obstruct fire apparatus access roads in any manner. The minimum widths and clearances established shall be maintained at all times.
- 2) Manual gates shall open utilizing the Knox padlock that conforms to the Rockwall Fire Department Knox security key.

Power Operated Security Gate

- 3) Gates shall not obstruct fire apparatus access roads in any manner. The minimum widths and clearances established shall be maintained at all times.
- 4) Gates shall open using the Knox dual gate key switch that conforms to the Rockwall Fire Department and Rockwall Police Department Knox security key.
- 5) The Knox key switch must meet the following criteria:
 - a) Be mounted at the access control pedestal.
 - b) Be a dual key switch.
 - c) Be equipped with one external lamp assembly with a red globe and one flasher unit to be mounted to top of enclosure and wired to 115 volts and clearly visible from the entry side of the gate.
 - d) Shall override all other opening systems.
- 6) When activated the gate shall operate at a minimum of one foot per second and remain open.
- 7) A manual back-up system shall be accessible on the entry side of the gate to allow access through the gate in the event of a power failure, or other failure of the electromechanical system.
 - a) On swing gates and barrier arms, this system shall be designed:
 - i. To open manually by one person removing the Knox padlock and/or pin that is secured in the gate arm.
 - ii. Knox padlock shall be clearly visible and easily accessible from the entry side of the gate.
 - b) On slide gate, this system shall be designed:
 - i. Open manually by one person utilizing an approved single manual release.
 - ii. The manual release device shall be within 10 feet of the gate in a location that is clearly visible and is easily accessible from the entry side of the gate.
 - iii. Manual release device shall be located in a fire department approved box. See manual release box requirements below.



General Requirements Manual Release Box

- 8) Manual release box shall comply with the following:
 - a) Red in color.
 - b) Clearly labeled.
 - c) Located within 10 feet of the gate, clearly visible and easily accessible.
 - d) Designed to accept the Knox padlock.

Pedestrian Walkway Security Gates. Any security gates that interfere with fire department access around the perimeter of a structure shall comply with the following.

- 9) Security gates may be installed across pedestrian walkways provided they are designed to comply with one of the following:
 - a) Open electromechanically with the use of a Knox dual gate key switch that conforms to the Rockwall Fire Department and Rockwall Police Department Knox security key. In the event of a power failure, or other failure of the electromechanical system, a fail-safe system must automatically unlock the gate to allow free entry and exit.
 - b) Open manually using a Knox padlock.
 - c) Open manually utilizing an alternate approved method.

Inspection Requirements

- 10) Fire Lane Unobstructed. The fire lane shall have a clear width of 24-feet.
- 11) Manual mode Verified.
- 12) Emergency Ingress System tested.

Submittal Requirements

- 13) Construction plans shall contain sufficient detail to enable the plan reviewer to accomplish a complete review.
- 14) Sequence of operation details shall be submitted that is a written description of the operation of the Access-Control/Delayed Egress System in normal mode, loss of power mode, activation of a fire protection system and manual modes.
- 15) Please upload the following documents when submitting your permit online:
 - a) Construction Plans
 - b) Equipment Specifications
 - c) Sequence of operation details



Examples of approved equipment

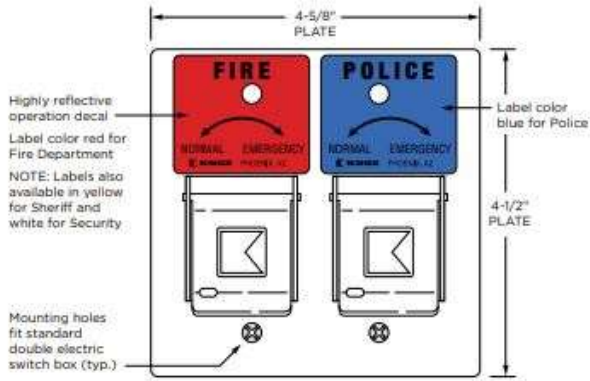

EXTERIOR USE